

F.A.P. RTE.	SECTION	COUNTY	TOTAL SHEETS	SHEET NO.
363	06-00339-00-TL	KANE	33	21
STA.		TO STA.		
FED. ROAD DIST. NO. 7		ILLINOIS FED. AID PROJECT		

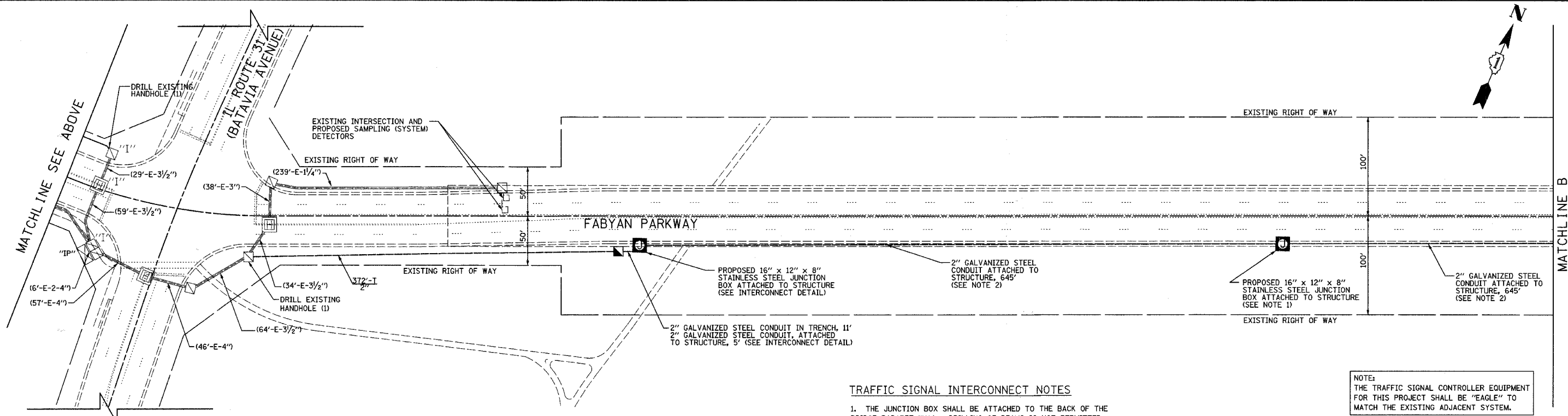

INTERCONNECT PLAN LEGEND

	EXISTING	PROPOSED
CONTROLLER HANDHOLE	☒	☒
HEAVY DUTY HANDHOLE	☒	☒
DOUBLE HANDHOLE	☒	☒
G.S. CONDUIT IN TRENCH OR PUSHED	—	—
DETECTOR LOOP SYSTEM	S	S
INTERSECTION UNIT DUCT	I	IP
COMMON TRENCH	CT	CT

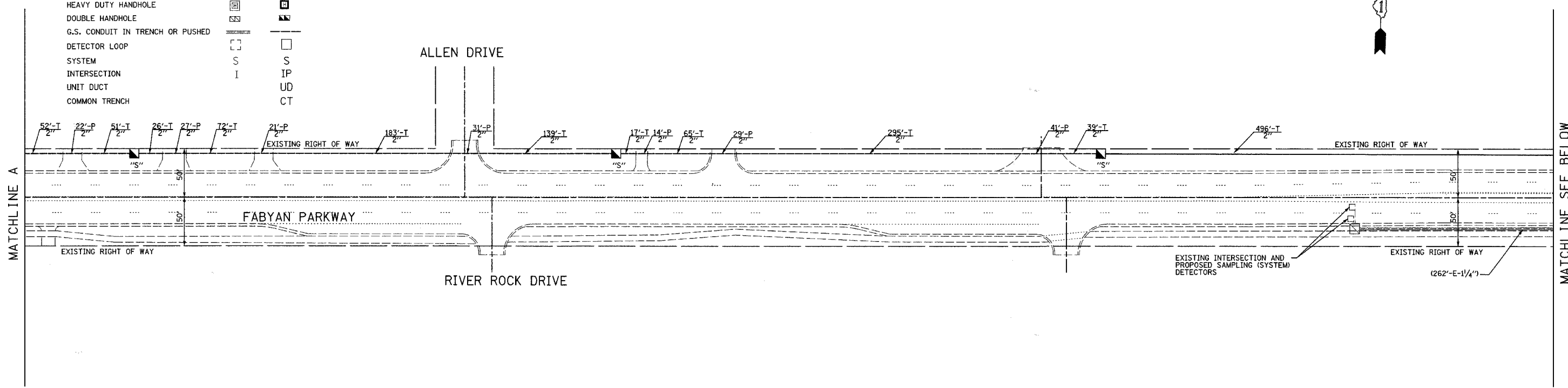

TRAFFIC SIGNAL INTERCONNECT NOTES

1. THE JUNCTION BOX SHALL BE ATTACHED TO THE BACK OF THE BRIDGE PARAPET WALL. DRILLING OF BEAMS IS NOT PERMITTED.
2. THE CONDUIT SHALL BE ATTACHED TO THE BRIDGE PARAPET WALL. DRILLING OF BEAMS IS NOT PERMITTED.

RESTORATION OF WORK AREA.
 RESTORATION OF THE TRAFFIC SIGNAL WORK AREA SHALL BE INCIDENTAL TO THE RELATED PAY ITEM SUCH AS FOUNDATION, CONDUIT, HANDHOLE, TRENCH AND BACKFILL, ETC., AND NO EXTRA COMPENSATION SHALL BE ALLOWED. ALL ROADWAY SURFACES SUCH AS SHOULDER, MEDIAN, SIDEWALKS, PAVEMENT, ETC. SHALL BE REPLACED IN KIND. ALL DAMAGE TO MOWED LAWNS SHALL BE REPLACED WITH AN APPROVED SALT TOLERANT SOD, AND ALL DAMAGE TO UNMOWED FIELDS SHALL BE SEEDED IN ACCORDANCE WITH STANDARD SPECIFICATIONS 252 AND 250 RESPECTIVELY.

NOTE:
 THE TRAFFIC SIGNAL CONTROLLER EQUIPMENT FOR THIS PROJECT SHALL BE "EAGLE" TO MATCH THE EXISTING ADJACENT SYSTEM.

REVISIONS	
NAME	DATE

KANE COUNTY DIVISION OF TRANSPORTATION

INTERCONNECT PLAN
 FABYAN PARKWAY
 WESTERN AVENUE TO KIRK ROAD
 SHEET 2 OF 5

SCALE: 1" = 50'
 DATE: 12/14/2007

DRAWN BY: CEC
 DESIGNED BY: BRD/JSH
 CHECKED BY: JJE