

STATE OF ILLINOIS
DEPARTMENT OF TRANSPORTATION
DIVISION OF HIGHWAYS
PLANS FOR PROPOSED
STREET IMPROVEMENT
S.T.U. FUNDS
CITY OF FAIRFIELD
WAYNE COUNTY
SECTION 06-00045-00-BR
N.E. SEVENTH ST. AND PARK ROAD (FAU ROUTE 8694)
PROPOSED STRUCTURE NO. 096-6011
PROJECT NO. M-5022(9)
JOB NO. C-97-006-08

INDEX OF SHEETS

- 1 COVER SHEET
- 2 SUMMARY OF QUANTITIES & DECORATIVE LIGHT DETAILS
- 3 TYPICAL SECTION, ENTRANCE DETAILS & PAVEMENT MARKING
- 4 PLAN & PROFILE
- 5-6 CROSS SECTIONS
- 7 PAVEMENT FINISHED ELEVATIONS
- 8-15 CULVERT PLANS

- STANDARDS:
- 420001-07 PAVEMENT JOINTS
 - 420601-05 24" PCC PAVEMENT
 - 420701-02 PAVEMENT FABRIC
 - 424001-05 CURB RAMPS FOR SIDEWALKS
 - 515001-02 NAME PLATE FOR BRIDGE
 - 602301-01 INLET-TYPE A
 - 602306-01 INLET-TYPE B
 - 604001-02 FRAME & LIDS-TYPE 1
 - 604051-02 FRAME & GRATE-TYPE 11
 - 606001-03 CONC CURB-TYPE B & COMBO CONC. CURB & GUTTER
 - 701901 TRAFFIC CONTROL DEVICES
 - BLR 21-7 TRAFFIC CONTROL
 - BLR 22-5 TRAFFIC CONTROL
 - 720011 METAL POSTS
 - 630001-07 SPBGR
 - 720001 SIGN PANELS
 - 720006-01 SIGN PANELS
 - 780001-01 TYP. PAVEMENT MARKINGS
 - 701801-03 SIDEWALK CLOSURE

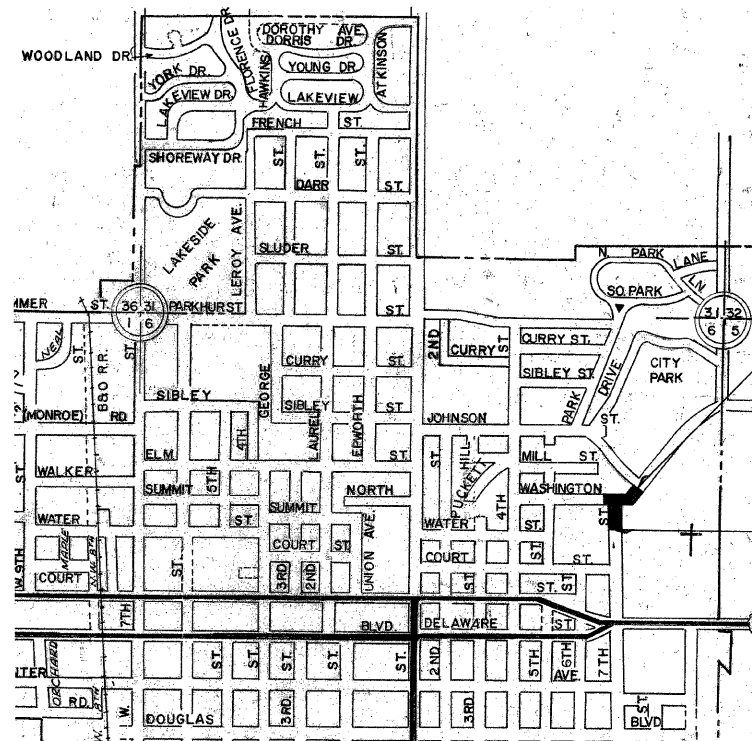

SECTION 06-00045-00-BR
ENDS STA. 5+01.3

STA. 3+34-PROPOSED REINFORCED CONCRETE
BOX CULVERT (TRIPLE 10'-0" X 8'-6" X 116'-11 1/4")
30'-0" RDWY, SKEW = 60° L.F.
PROPOSED STR. NO. 096-6011
EXISTING STR. NO. 096-6006

SECTION 06-00045-00-BR
BEGINS STA. 0+80

CONTRACT NO. 95526

FUNCTIONAL CLASS: URBAN - MINOR ARTERIAL
ADT = 3750
DESIGN SPEED = 30 MPH

LOCATION MAP
APPROXIMATE SCALE: 1 INCH = 1,000 FEET
NET LENGTH = 421.3 FEET = 0.08 MILES

TOLL FREE JOINT UTILITY LOCATING
INFORMATION FOR EXCAVATORS (J.U.L.I.E.)
TELEPHONE NO. 1-800-892-0123

CONNOR & CONNOR, INC.
PROFESSIONAL DESIGN FIRM #184-000832

Michael Ross
REGISTERED PROFESSIONAL ENGINEER # 31350
ILLINOIS LICENSE EXPIRES NOVEMBER 30, 2009

APPROVED December 3, 2007
Sara Hutchcraft
LOCAL AGENCY REPRESENTATIVE

PASSED 1-02, 2008
Maurice E. Kroll
DISTRICT SEVEN ENGINEER
OF LOCAL ROADS & STREETS

RELEASING FOR BID BASED ON LIMITED REVIEW
1-02, 2008
Christ M. Reed
DEPUTY DIRECTOR OF HIGHWAYS
REGION FOUR ENGINEER
STATE OF ILLINOIS
DEPARTMENT OF TRANSPORTATION