

RTE.	SECTION	COUNTY	TOTAL SHEETS	SHEET NO.
T.R. 256	06-11116-00-BR	MACON	14	4
STA. 8+67.32		TO STA. 21+14.18		
FED. ROAD DIST. NO.	ILLINOIS	PROJECT:	BROS-115(63)	
CONTRACT NO. 95530				

NOTE:
FOR TIE POINTS & BENCHMARK LOCATION, SEE SHEET 3 OF 14.

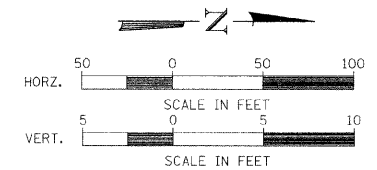
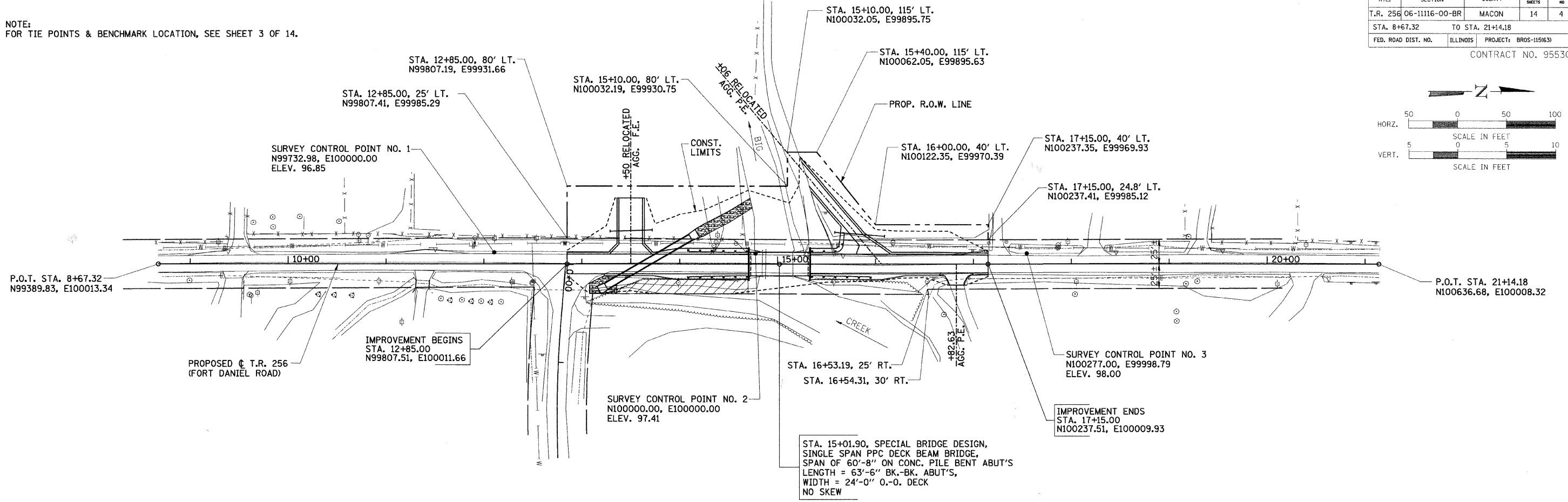

PLAN	DATE	BY
SURVEYED		
ALIGNED		
CHECKED		
PT. OF WAY CHECKED		
PAID FILE NAME		

PROFILE	DATE	BY
SURVEYED		
GRADES CHECKED		
BLK. NOTED		
STRUCTURE NOTATIONS CHECKED		

- SHOULDER WIDENING FOR GUARDRAIL TERMINALS**
- ① STA. 13+73.7, 12' RT. & LT.
 - ② STA. 13+97.7, 16' RT. & LT.
 - ③ STA. 14+70.15, 16' RT. & LT.
 - ④ STA. 15+33.65, 16' RT.
 - ⑤ STA. 16+06.0, 16' RT.
 - ⑥ STA. 16+30.0, 12' RT.

- PROPOSED STRUCTURE LAYOUT**
- | | |
|---------------------------------------------------------------|----------------------------------------------------------------|
| SOUTH ABUTMENT | NORTH ABUTMENT |
| BK. OF S. ABUT. STA. 14+70.15
N99992.66, E100010.91 | BK. OF N. ABUT. STA. 15+33.65
N100056.16, E100010.66 |
| ☐ S. ABUT. STA. 14+71.40
N99993.91, E100010.91 | ☐ N. ABUT. STA. 15+32.40
N100054.91, E100010.66 |
| FRONT FACE OF S. ABUT. STA. 14+72.65
N99995.16, E100010.90 | FRONT FACE OF N. ABUT. STA. 15+31.15
N100053.66, E100010.67 |

HORIZONTAL LAYOUT