

F.A.S. RTE.	F.A.P. RTE.	SECTION	COUNTY	TOTAL SHEETS	SHEET NO.
2905	726	113B-1, 113B-2	WILLIAMSON	87	1

STATE OF ILLINOIS
DEPARTMENT OF TRANSPORTATION
DIVISION OF HIGHWAYS

**PROPOSED
HIGHWAY PLANS**

FAS 2905/FAP 726 (IL 37)
SECTION 113B-1 SN 100-0090
113B-2 SN 100-0091

WILLIAMSON COUNTY

C-99-065-02 *BRS-*

PROJECT: *BRF-000S (583)*

**STRUCTURE REPLACEMENTS ON
IL 37 OVER BURLINGTON NORTHERN /SANTA FE RAILROAD
AND IL 37 OVER LITTLE SALINE CREEK**

D-99-017-03



LOCATION OF SECTION INDICATED THUS: - [shaded box] -

FOR INDEX OF SHEETS, SEE SHEET NO. 2
FOR SUMMARY OF QUANTITIES, SEE SHEET NO. 3 & 4

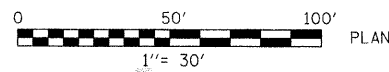
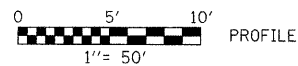
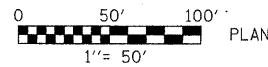

SN 100-0027
TRAFFIC DATA

2005 ADT = 5900
13.3% TRUCKS
POSTED SPEED = 55 MPH

SN 100-0028
TRAFFIC DATA

2006 ADT = 5020
10.1% TRUCKS
POSTED SPEED = 55 MPH

PROPOSED BRIDGE ON IL 37 OVER
BURLINGTON NORTHERN/SANTA FE RAILROAD
STRUCTURE NO 100-0090
C. STR. STA 376+46
3-SPAN W33 BRIDGE;
175'-0" BK TO BK ABUTS; 21°-38' SKEW
EXIST STR NO 100-0027

PROPOSED BRIDGE ON IL 37 OVER
LITTLE SALINE CREEK
STRUCTURE NO 100-0091
C. STR. STA 531+81.00
SINGLE SPAN
60" WEB PLATE GIRDER BRIDGE
119'-0" BK TO BK ABUTS; 30° SKEW
EXIST STR NO 100-0028

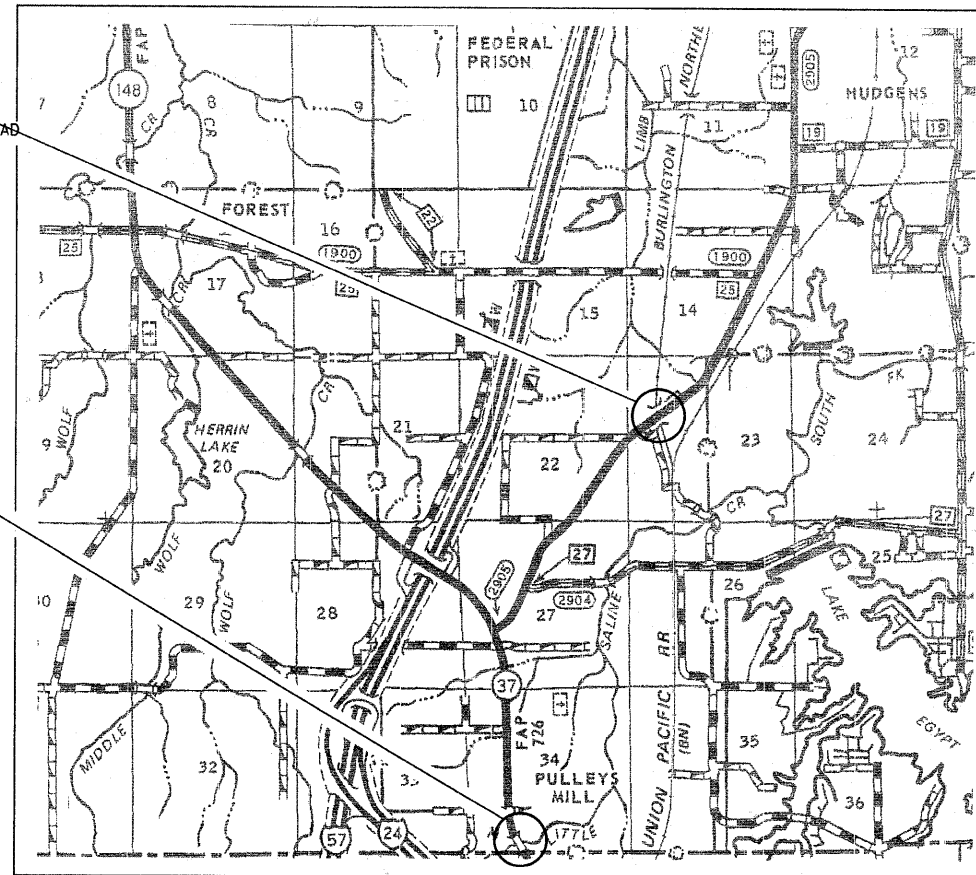

GROSS LENGTH OF PROJECT = 1580 FT

SN 100-0090
ROADWAY LENGTH = 775 FT
BRIDGE LENGTH = 175 FT
NET LENGTH OF PROJECT = 950 FT

SN 100-0091
ROADWAY LENGTH = 511 FT
BRIDGE LENGTH = 119 FT
NET LENGTH OF PROJECT = 630 FT

SOUTHERN TOWNSHIP

FULL SIZE PLANS HAVE BEEN PREPARED USING STANDARD
ENGINEERING SCALES. REDUCED SIZED PLANS WILL NOT
CONFORM TO STANDARD SCALES. IN MAKING MEASUREMENTS
ON REDUCED PLANS, THE ABOVE SCALES MAY BE USED.

J.U.L.I.E.
JOINT UTILITY LOCATION INFORMATION FOR EXCAVATION
1-800-892-0123

CONTRACT NO. 98777

STATE OF ILLINOIS
DEPARTMENT OF TRANSPORTATION
DIVISION OF HIGHWAYS

SUBMITTED Dec 6 20 07

Max C. Lamic
DEPUTY DIRECTOR OF HIGHWAYS, REGION ENGINEER

February 1, 20 08
Eric E. Harsh
INTERIM ENGINEER OF DESIGN AND ENVIRONMENT

February 1, 20 08
Christina M. Reed
DIRECTOR OF HIGHWAYS, CHIEF ENGINEER

**PRINTED BY THE AUTHORITY
OF THE STATE OF ILLINOIS**