

TOP OF BEAM ELEVATIONS
(For Fabrication Only)

LOCATION	BEAM 1	BEAM 2	BEAM 3	BEAM 4	BEAM 5	BEAM 6
☉ Brg. E. Abut.	540.409	540.533	540.624	540.600	540.461	540.288
☉ Pier 1	540.638	540.770	540.870	540.854	540.723	540.559
☉ Splice 1	540.691	540.825	540.927	540.913	540.783	540.621
☉ Splice 2	540.837	540.981	541.093	541.089	540.970	540.818
☉ Pier 2	540.841	540.987	541.101	541.099	540.981	540.831
☉ Brg. W. Abut.	540.857	541.012	541.134	541.140	541.031	540.890

FRAMING PLAN

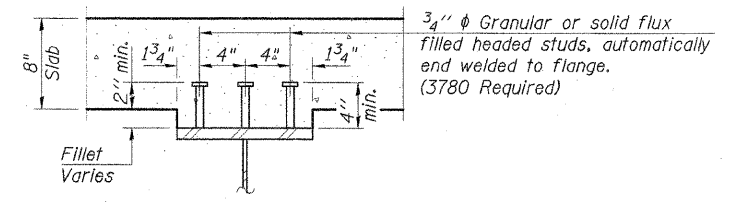

SECTION A-A

- NOTES:**
- All stringers shall be AASHTO M270, Grade 50 steel (N.T.R.).
 - Load carrying components designed "N.T.R." shall conform to the supplemental requirements for notch toughness (Zone 2).
 - All cross frames or diaphragms shall be installed as steel is erected and secured with erection pins and bolts except as otherwise noted. Individual cross frames or diaphragms at supports may be temporarily disconnected to install bearing anchor rods.

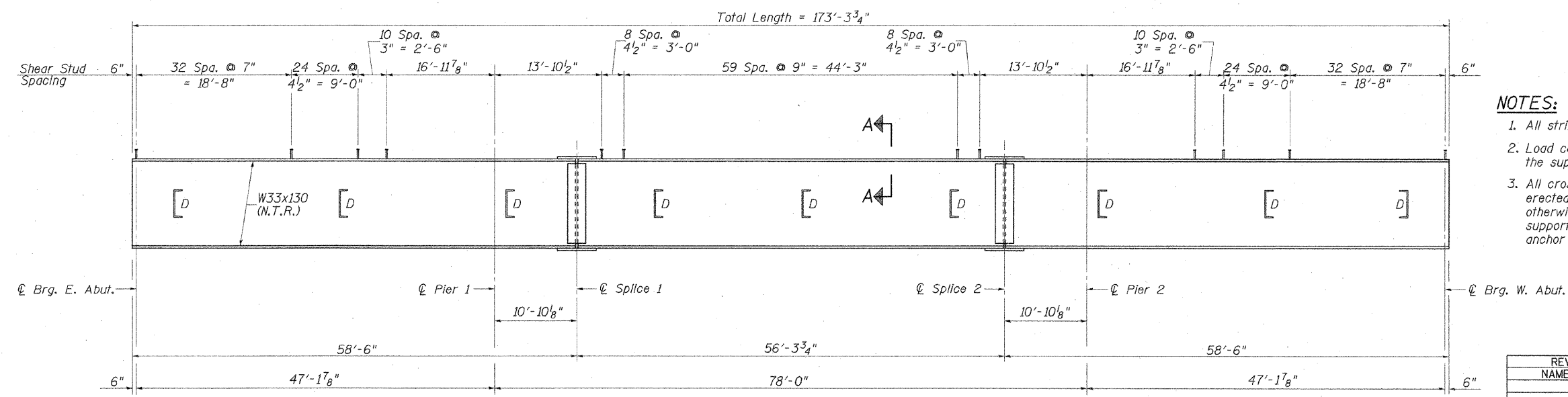

BEAM ELEVATION

REVISIONS	
NAME	DATE

CMT
CRAWFORD MURPHY & TILLY, INC.
CONSULTING ENGINEERS
SPRINGFIELD, IL ■ AURORA, IL ■ ST. LOUIS, MO
ROCKFORD, IL ■ PEORIA, IL ■ CHICAGO, IL

ILLINOIS DEPARTMENT OF TRANSPORTATION
FRAMING PLAN & ELEVATION
F.A.S. ROUTE 2905 (IL. RTE. 37)
ILLINOIS ROUTE 37 OVER
BN/SF RAILROAD
SECTION 113B-1 STA. 376+46.00
STR. NO. 100-0090 - WILLIAMSON COUNTY
SCALE: NONE DRAWN BY: GLD
DATE: 12/14/07 CHECKED BY: WLB

L:\IDOT\060660\SL\1000090\060660.dwg, sheets\FRAMING.dgn 12/22/2007