

**BILL OF MATERIAL**

Bar	No.	Size	Length	Shape
h21 (E)	116	#6	23'-0"	—
p21 (E)	20	#7	23'-5"	—
s21 (E)	38	#4	10'-9"	□
u21 (E)	8	#6	10'-8"	U
u22 (E)	58	#6	8'-5"	U
v22 (E)	96	#6	29'-7"	—
Structure Excavation		Cu. Yd.	197	
Concrete Structures		Cu. Yd.	114.3	
Concrete Encasement		Cu. Yd.	3.5	
Reinforcement Bars, Epoxy Coated		Pound	10,370	
Furnishing Steel Piles, HP 12x63		Foot	338	
Driving Piles		Foot	338	
Test Pile Steel HP12x63		Each	1	
Pile Shoes		Each	10	

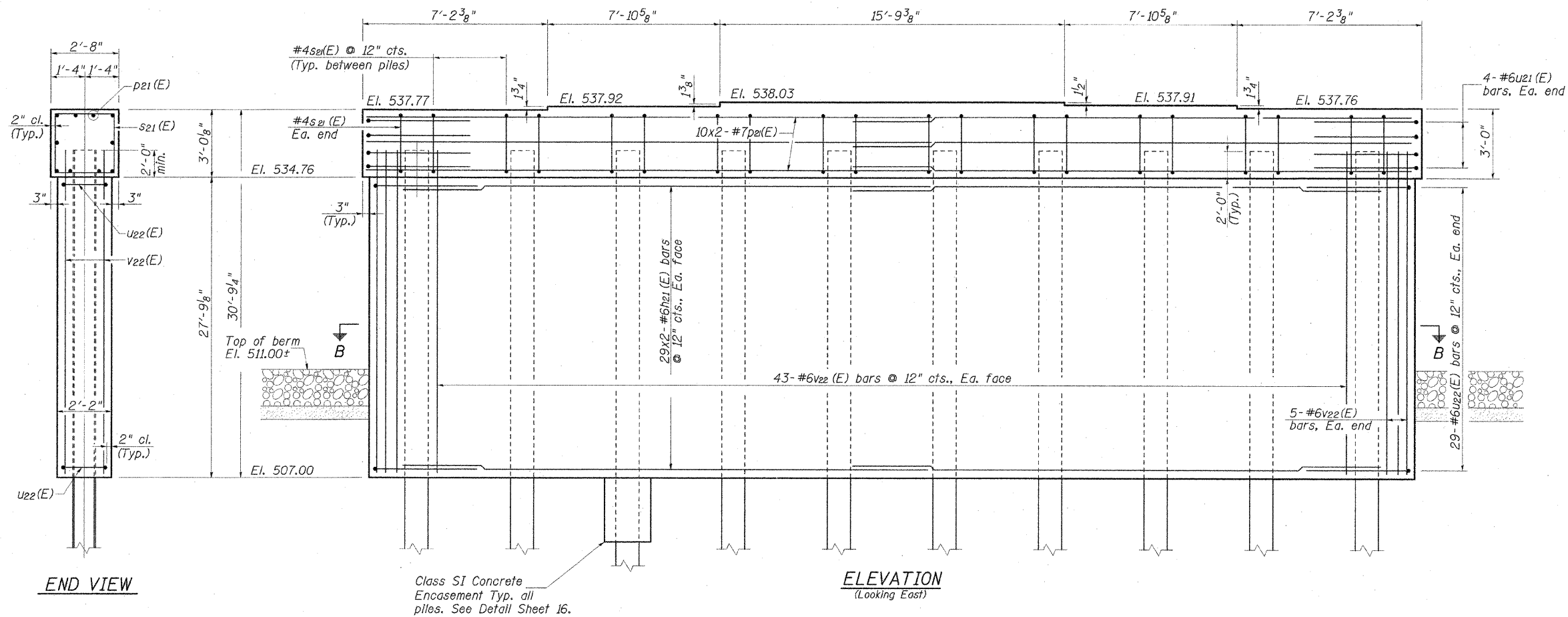

**MIN. BAR LAP**

#6 bar = 2'-7"  
#7 bar = 3'-5"

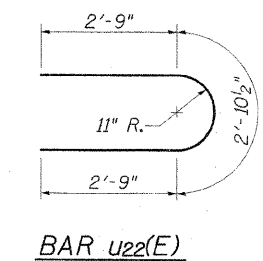
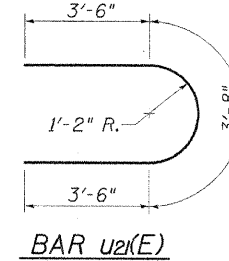
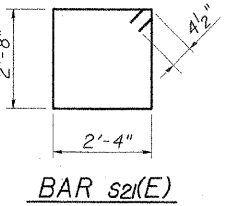

**NOTES**

1. Pour steps monolithically with cap.
2. Space reinforcement in cap to miss anchor bolts.
3. See Sheet 16 of 18 for steel H-pile details.

**PILE DATA**

PILE TYPE AND SIZE:	HP 12x63 with Metal Shoes
NOMINAL REQUIRED BEARING:	497 kips
FACTORED RESISTANCE AVAILABLE:	248 kips
ESTIMATED PILE LENGTH:	37.5 Ft.
NUMBER OF PRODUCTION PILES:	9
NUMBER OF TEST PILES:	1

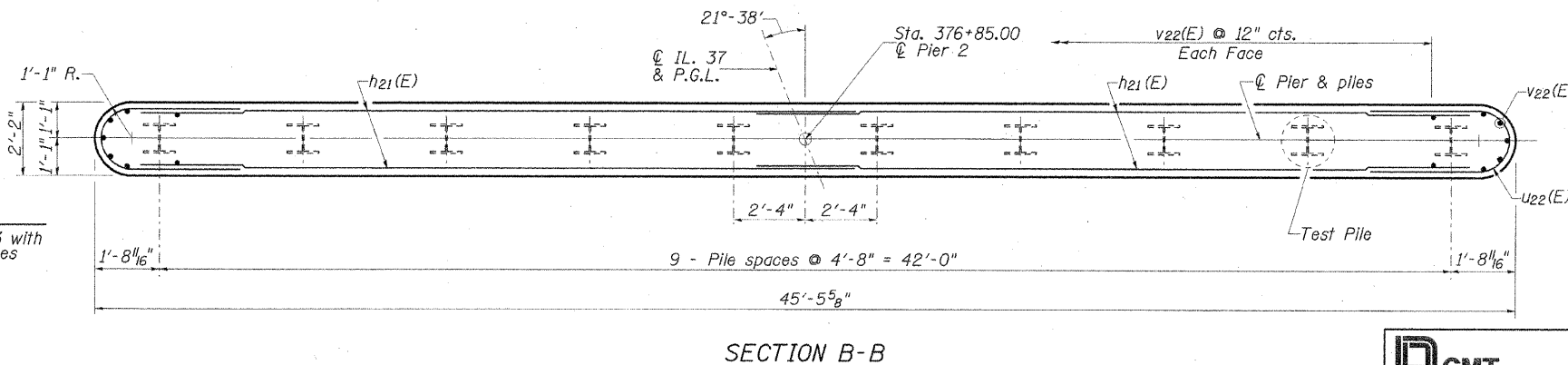

REVISIONS	
NAME	DATE

ILLINOIS DEPARTMENT OF TRANSPORTATION  
**PIER 2**  
 F.A.S. ROUTE 2905 (IL. RTE. 37)  
 ILLINOIS ROUTE 37 OVER  
 BN/SF RAILROAD  
 SECTION 113B-1 STA. 376+46.00  
 STR. NO. 100-0090 - WILLIAMSON COUNTY  
 SCALE: NONE DRAWN BY: GLD  
 DATE: 12/14/07 CHECKED BY: WLB



I:\PROJECTS\060660\SHL\000090\Drawings\Sheet 14 PIER 2.dgn  
 12/29/2007