

FEDERAL AID PROGRAM ENGINEER: CARMEN RAMOS, PE, SCHAUMBURG, IL
CONSULTANTS: ROBINSON ENGINEERING, LTD. 708-331-6700

03-07-2025 LETTING ITEM 012

STATE OF ILLINOIS
DEPARTMENT OF TRANSPORTATION

PLANS FOR PROPOSED
FEDERAL AID HIGHWAY

FAU ROUTE 1044 (TAFT DRIVE)
EAST OF UNION AVENUE TO CANAL STREET
ROADWAY RESURFACING
SECTION NO.: 22-00117-00-RS
PROJECT NO.: Y7DP(186)
VILLAGE OF SOUTH HOLLAND
COOK COUNTY
JOB NO.: C-91-046-25

TAFT DRIVE
UNION AVENUE TO CANAL STREET
2022 ADT- 3,500
POSTED SPEED LIMIT- 30 MPH
FUNCTIONAL CLASSIFICATION- MAJOR COLLECTOR

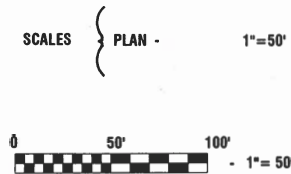

FULL SIZE PLANS HAVE BEEN PREPARED USING STANDARD
ENGINEERING SCALES, REDUCED SIZED PLANS WILL NOT
CONFORM TO STANDARD SCALES, IN MAKING MEASUREMENTS
ON REDUCED PLANS, THE ABOVE SCALES MAY BE USED.

J. U. L. I. E.
JOINT UTILITY LOCATION INFORMATION FOR EXCAVATION
1 - 800 - 892 - 0123
OR 811

BEGIN PROJECT
STA 101+04

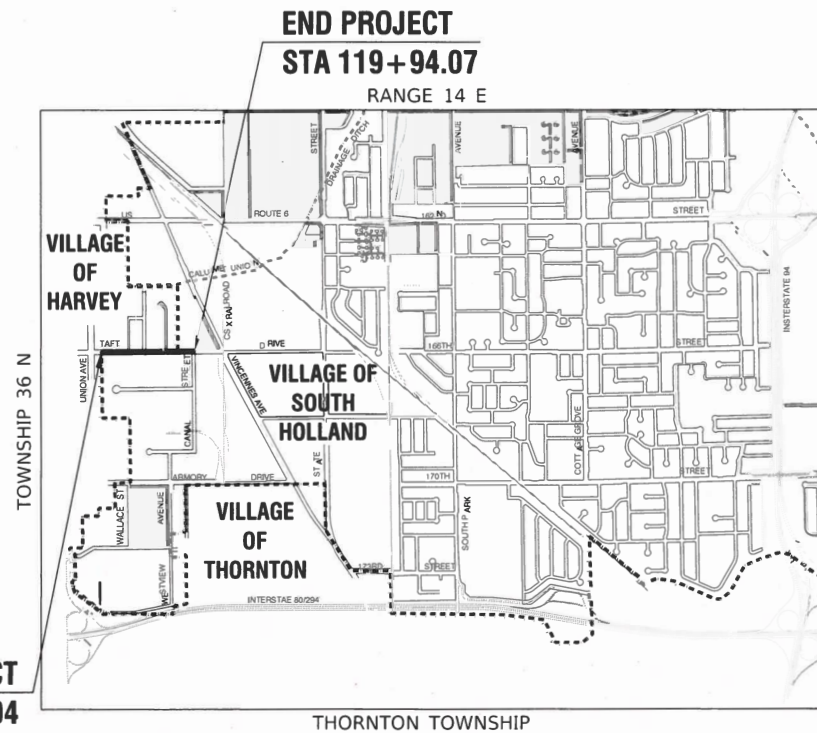

LOCATION MAP
NOT TO SCALE

GROSS LENGTH= 1,890.07 FEET = 0.36 MILES
NET LENGTH= 1,890.07 FEET = 0.36 MILES



LICENSE EXPIRES: 11/30/25
11-18-24

F.A.U. RTE.	SECTION	COUNTY	TOTAL SHEETS	SHEET NO.
1044	22-00117-00-RS	COOK	17	1
ILLINOIS CONTRACT NO. 61L20				

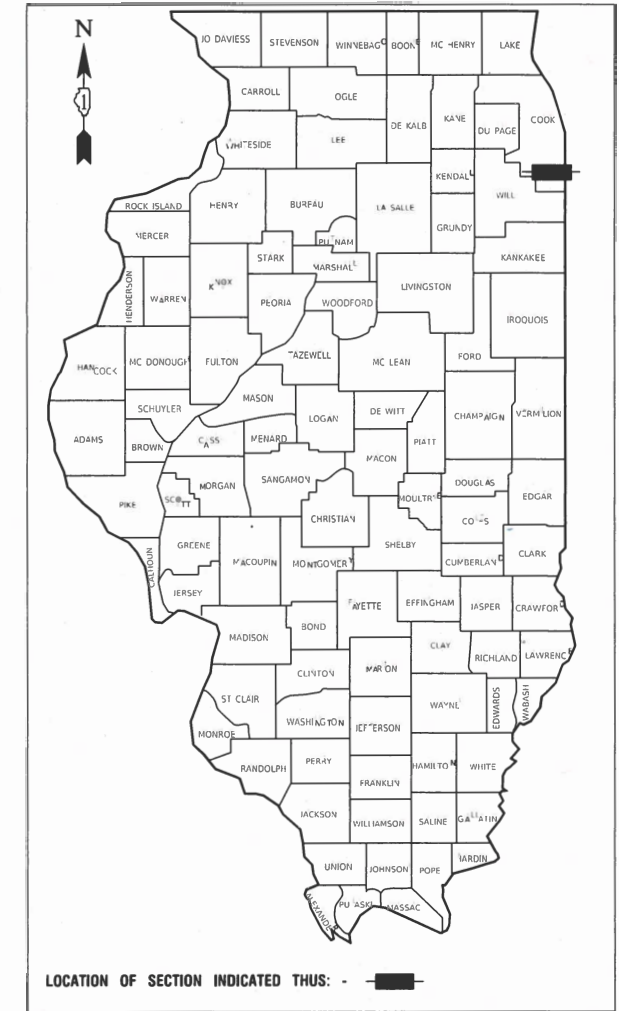

STATE OF ILLINOIS DEPARTMENT OF TRANSPORTATION	
APPROVED	11-18-2024 <i>[Signature]</i> VILLAGE OF SOUTH HOLLAND, MAYOR
PASSED	Jan 2, 2025 <i>[Signature]</i> DISTRICT 1 ENGINEER OF LOCAL ROADS & STREETS
RELEASING FOR BID BASED ON LIMITED REVIEW	1.6.2025 <i>[Signature]</i> REGIONAL ENGINEER

PRINTED BY THE AUTHORITY OF
THE STATE OF ILLINOIS

INDEX OF SHEETS

1	COVER SHEET
2	INDEX OF SHEETS, HIGHWAY STANDARDS AND GENERAL NOTES
3-5	SUMMARY OF QUANTITIES
6	TYPICAL CROSS SECTIONS
7	ALIGNMENT AND TIES
8	PROPOSED IMPROVEMENT PLAN
9	PAVEMENT MARKING AND SIGNAGE
10-11	CONSTRUCTION DETAILS
12-17	IDOT DISTRICT 1 STANDARDS

HIGHWAY STANDARDS

424001-12	PERPENDICULAR CURB RAMPS FOR SIDEWALKS
424026-04	ENTRANCE / ALLEY PEDESTRIAN CROSSINGS
442201-03	CLASS C AND D PATCHES
701001-02	OFF-ROAD OPERATIONS 2L 2W MORE THAN 15' FT
701006-05	OFF-ROAD OPERATIONS, 2L, 2W, 15' (4.5m) TO 24" (600 mm) FROM PAVEMENT EDGE
701011-04	OFF-ROAD MOVING OPERATIONS 2L 2W DAY ONLY
701301-04	LANE CLOSURE, 2L, 2W, SHORT TIME OPERATIONS
701311-03	LANE CLOSURE 2L, 2W MOVING OPERATIONS - DAY ONLY
701501-06	URBAN LANE CLOSURE, 2L, 2W, UNDIVIDED
701801-06	SIDEWALK, CORNER OR CROSSWALK CLOSURE
701901-10	TRAFFIC CONTROL DEVICES
720001-01	SIGN PANEL MOUNTING DETAILS
720006-04	SIGN PANEL ERECTION DETAILS
728001-01	TELESCOPING STEEL SIGN SUPPORT
780001-05	TYPICAL PAVEMENT MARKINGS

DISTRICT ONE DETAILS

BD-08	FRAMES AND LIDS ADJUSTMENT WITH MILLING
BD-22	PAVEMENT PATCHING FOR HMA SURFACED PAVEMENT
BD-32	BUTT JOINTS AND HMA TAPER
TC-10	TRAFFIC CONTROL AND PROTECTION FOR SIDE ROADS, INTERSECTIONS AND DRIVEWAYS
TC-13	DISTRICT ONE TYPICAL PAVEMENT MARKINGS
TC-26	DRIVEWAY ENTRANCE SIGNING

GENERAL NOTES

- ITEMS OF WORK LISTED IN THE SUMMARY OF QUANTITIES NOT SPECIFICALLY CALLED OUT ON THE PLANS SHALL BE PERFORMED AS DIRECTED BY THE ENGINEER.
- THE ROBINSON ENGINEERING, LTD. FIELD OFFICE (708-331-6700), AND THE PUBLIC WORKS DIRECTOR, AT THE VILLAGE OF SOUTH HOLLAND, SHALL BE NOTIFIED TWO (2) WORKING DAYS BEFORE CONSTRUCTION BEGINS.
- BEFORE STARTING ANY EXCAVATION THE CONTRACTOR SHALL CALL "J.U.L.I.E." AT (800) 892-0123 OR 811 AND (312) 744-7000 FOR FIELD LOCATIONS OF BURIED ELECTRIC, TELEPHONE AND GAS UTILITIES. (48 HOUR NOTIFICATION REQUIRED)
- UTILITIES INDICATED ON THE PLANS ARE PROVIDED FOR THE CONTRACTOR'S USE AND ARE BASED UPON INFORMATION AVAILABLE AT THE TIME OF THE ADVERTISEMENT FOR BIDS. THE OWNER AND ENGINEER DO NOT GUARANTEE THE ACCURACY OF UTILITY INFORMATION.
- IT SHALL BE THE CONTRACTOR'S RESPONSIBILITY TO VERIFY ALL DIMENSIONS AND CONDITIONS EXISTING IN THE FIELD PRIOR TO CONSTRUCTION AND ORDERING OF MATERIALS.
- THE THICKNESS OF HMA MIXTURE STATED IN THE SPECIFICATIONS IS THE NOMINAL THICKNESS. DEVIATIONS FROM THE NOMINAL THICKNESS WILL BE PERMITTED WHEN SUCH DEVIATIONS OCCUR DUE TO IRREGULARITIES IN THE EXISTING SURFACE OR BASE ON WHICH THE HMA SURFACE IS PLACED.
- ANY LOOSE MATERIAL DEPOSITED IN THE FLOW LINE OF DITCHES, GUTTERS OR OTHER DRAINAGE STRUCTURES SHALL BE REMOVED BY THE END OF EACH DAY BY THE CONTRACTOR.
- CLASS D PATCHING QUANTITIES FOR THIS CONTRACT SHALL BE PERFORMED AT THE DIRECTION OF THE ENGINEER AFTER PAVEMENT MILLING.
- CONTRACTOR SHALL TAKE PRECAUTION BY PRESERVING EXISTING TREES WITHIN THE RIGHT OF WAY. IF ANY DAMAGE OCCURS, TREES SHALL BE REPLACED IN KIND PER ARTICLE 201.07 REPAIR OR REPLACEMENT OF EXISTING PLANT MATERIAL REQUIREMENTS STATED HEREIN.
- ALL EQUIPMENT SHALL BE REMOVED OFF THE VILLAGE STREETS DURING ALL HOLIDAY WEEKENDS AS COORDINATED WITH THE VILLAGE.
- HMA PAVING SHALL BE PERFORMED WITH HOT JOINTS.
- THE CONTRACTOR SHALL CONTACT KALPANA KANNAN-HOSADURGA, THE DISTRICT ONE TRAFFIC CONTROL SUPERVISOR, AT KALPANA.KANNAN-HOSADURGA@ILLINOIS.GOV A MINIMUM OF 72 HOURS IN ADVANCE OF BEGINNING WORK.
- WHEN WORKING ADJACENT TO THE ROAD AND UTILIZING DAILY LANE CLOSURES, DROP-OFFS ADJACENT TO THE TRAVEL LANES SHALL BE KEPT TO A MINIMUM. DROP-OFFS GREATER THAN (OR GREATER THAN OR EQUAL TO) 12" WILL NOT BE ALLOWED AT LOCATIONS WHERE THE DROP-OFF IS LOCATED WITHIN 8 FT OF THE EDGE OF THE TRAVEL LANE. THE CONTRACTOR WILL BE REQUIRED TO PERFORM THE EXCAVATION REQUIRED FOR THE CONSTRUCTION DURING THE TIME THAT THE ADJACENT LANE IS CLOSED. AS NOTED ABOVE, PRIOR TO REOPENING THE LANE TO TRAFFIC THE CONTRACTOR SHALL PLACE SUFFICIENT MATERIAL TO REDUCE THE DROP-OFF TO LESS THAN 12". THE CONTRACTOR SHALL BE RESPONSIBLE TO DETERMINE THE AMOUNT OF WORK THAT CAN BE COMPLETED WITHIN THE TIME OF THE DAILY LANE CLOSURE. NO ADDITIONAL COMPENSATION SHALL BE ALLOWED TO COMPLY WITH THIS REQUIREMENT.
- CHANGEABLE MESSAGE SIGNS SHALL BE INSTALLED TWO WEEKS PRIOR TO ALL TRAFFIC STAGE CHANGES ON EACH APPROACH OF THE EFFECTED ROADWAY TO WARN MOTORISTS OF THE UPCOMING EVENT. THE SIGN MESSAGES SHALL BE REVISED TWO WEEKS THEREAFTER WITH MESSAGES WARNING TRAFFIC OF POTENTIAL TRAFFIC DELAYS, QUEUING AND/OR WITH MESSAGES NOTIFYING TRAFFIC TO USE ALTERNATE ROUTES. THE SIGN LOCATIONS AND MESSAGES SHALL BE DETERMINED BY THE ENGINEER.
- TEMPORARY INFORMATION SIGNS ON TEMPORARY SUPPORTS SHALL BE PROVIDED FOR ALL COMMERCIAL DRIVEWAYS THAT ARE LOCATED WITHIN A WORK AREA. THIS WORK SHALL BE PAID FOR PER DISTRICT 1 DETAIL TC-26. THESE SIGNS SHALL BE RELOCATED AS REQUIRED FOR EACH CONSTRUCTION STAGE AND SHALL BE PLACED AS DIRECTED BY THE ENGINEER. THIS SIGN RELOCATION WORK WILL NOT BE PAID FOR SEPARATELY AND SHALL BE INCLUDED IN TEH CONTRACT UNIT PRICE PER SQUARE FOOT FOR TEMPORARY INFORMATION SIGNING.
- CONTRACTOR SHALL REMOVE OR COVER ALL W21-1 (WORKERS PRESENT) AND W20-7 (FLAGGER) SIGNS WHEN WORKERS ARE NOT PRESENT OR IF THE SIGN IS NOT APPLICABLE.
- DRUMS ALONG ROADWAYS SHALL BE PLACED AS FOLLOWS: 50' C-C ALONG TANGENTS; 20' C-C ALONG TAPERS; & 10' C-C ALONG RADII/CURVES.
- EXISTING VEGETATED AREAS (TREES, SHRUBS, VEGETATIVE BUFFERS, TURF AREAS, ETC.) WHERE DISTURBANCE IS NOT OCCURRING (INCLUDING AREAS OUTSIDE THE PROJECT LIMITS) SHALL NOT BE DISTURBED TO ENSURE THAT EXISTING VEGETATION IS PRESERVED HEALTHY TO MINIMIZE SOIL EROSION AND TO ELIMINATE SOIL COMPACTION. NO MATERIALS ARE TO BE STORED OR VEHICLES DRIVEN OR PARKED WITHIN THESE UNDISTURBED AREAS AT ANY TIME.

COMMITTMENTS

NONE.

					FED 80%	FED 80%
					VILLAGE 20%	VILLAGE 20%
					ROADWAY	SAFETY
S.I.	CODE NO.	PAY ITEM	UNIT	TOTAL QUANTITY	CONSTRUCTION TYPE CODE	
					0005	0021
	20201200	REMOVAL AND DISPOSAL OF UNSUITABLE MATERIAL	CU YD	15	15	
	21101615	TOPSOIL FURNISH AND PLACE, 4"	SQ YD	741	741	
	30300001	AGGREGATE SUBGRADE IMPROVEMENT	CU YD	15	15	
	35101600	AGGREGATE BASE COURSE, TYPE B 4"	SQ YD	1,404	1,391	13
	40600290	BITUMINOUS MATERIALS (TACK COAT)	POUND	3,942	3,942	
	40600370	LONGITUDINAL JOINT SEALANT	FOOT	1,890	1,890	
	40600400	MIXTURE FOR CRACKS, JOINTS, AND FLANGEWAYS	TON	9	9	
	40600982	HOT-MIX ASPHALT SURFACE REMOVAL - BUTT JOINT	SQ YD	80	80	
	40603080	HOT-MIX ASPHALT BINDER COURSE, IL-19.0, N50	TON	736	736	
	40604060	HOT-MIX ASPHALT SURFACE COURSE, IL-9.5, MIX "D", N50	TON	655	655	
	42400200	PORTLAND CEMENT CONCRETE SIDEWALK 5 INCH	SQ FT	115		115
	42400800	DETECTABLE WARNINGS	SQ FT	40		40
	44000165	HOT-MIX ASPHALT SURFACE REMOVAL, 4"	SQ YD	5,840	5,840	
	44000200	DRIVEWAY PAVEMENT REMOVAL	SQ YD	1,406	1,406	
	44000600	SIDEWALK REMOVAL	SQ FT	115		115
	44201692	CLASS D PATCHES, TYPE II, 4 INCH	SQ YD	59	59	
	44201694	CLASS D PATCHES, TYPE III, 4 INCH	SQ YD	22	22	

* SPECIALTY ITEM

FILE NAME = 23RD706-QUAN-01 - 001	USER NAME --	DESIGNED -- MPN	REVISED --	STATE OF ILLINOIS DEPARTMENT OF TRANSPORTATION	TAFI DRIVE ROADWAY RESURFACING SUMMARY OF QUANTITIES					F.A.U RTE.	SECTION	COUNTY	TOTAL SHEETS	SHEET NO.
		CHECKED -- WPD	REVISED --							1044	22-00117-00-RS	COOK	17	3
	PLOT SCALE --	DRAWN -- BG	REVISED --							CONTRACT NO. 61L20				
	PLOT DATE -- 11-18-24	CHECKED -- AG	REVISED --											
					SCALE: NONE	SHEET NO. 3	OF 17 SHEETS	STA.	TO STA.	FED. ROAD DIST. NO. 1	ILLINOIS	FED. AID PROJECT	Y7DP(168)	

					FED 80%	FED 80%
					VILLAGE 20%	VILLAGE 20%
					ROADWAY	SAFETY
S.I.	CODE NO.	PAY ITEM	UNIT	TOTAL QUANTITY	CONSTRUCTION TYPE CODE	
					0005	0021
	48101498	AGGREGATE SHOULDERS, TYPE B 4"	SQ YD	159	159	
	60266600	VALVE BOXES TO BE ADJUSTED	EACH	3	3	
	63200310	GUARDRAIL REMOVAL	FOOT	118		118
*	66900200	NON-SPECIAL WASTE DISPOSAL	CU YD	10	10	
*	66900530	SOIL DISPOSAL ANALYSIS	EACH	1	1	
*	66901001	REGULATED SUBSTANCES PRE-CONSTRUCTION PLAN	L SUM	1	1	
*	66901003	REGULATED SUBSTANCES FINAL CONSTRUCTION REPORT	L SUM	1	1	
*	66901006	REGULATED SUBSTANCES MONITORING	CAL DA	4	4	
	67100100	MOBILIZATION	L SUM	1	1	
	70102620	TRAFFIC CONTROL AND PROTECTION, STANDARD 701501	L SUM	1	1	
	70102640	TRAFFIC CONTROL AND PROTECTION, STANDARD 701801	L SUM	1	1	
	70107025	CHANGEABLE MESSAGE SIGN	CAL DA	60	60	
	70300100	SHORT TERM PAVEMENT MARKING	FOOT	600		600
	70300150	SHORT TERM PAVEMENT MARKING REMOVAL	SQ FT	200		200
*	72000100	SIGN PANEL - TYPE 1	SQ FT	99		99
	72400100	REMOVE SIGN PANEL ASSEMBLY - TYPE A	EACH	8		8
	72400200	REMOVE SIGN PANEL ASSEMBLY - TYPE B	EACH	1		1

* SPECIALTY ITEM

FILE NAME = 23R0706-QUAN-01 - Q02

USER NAME =	DESIGNED -- MPN	REVISED --
	CHECKED -- WPD	REVISED --
PLOT SCALE =	DRAWN -- BG	REVISED --
PLOT DATE = 11-18-24	CHECKED -- APG	REVISED --

STATE OF ILLINOIS
DEPARTMENT OF TRANSPORTATION

TAFI DRIVE ROADWAY RESURFACING SUMMARY OF QUANTITIES			
SCALE:	SHEET NO. 4	OF 17 SHEETS	STA. TO STA.

FAU RTE 1044	SECTION 22-00117-00-R5	COUNTY COOK	TOTAL SHEETS 17	SHEET NO. 4
CONTRACT NO. 61L20				
FED. ROAD DIST. NO. 1 ILLINOIS FED. AID PROJECT Y7DP(186)				

					FED 80%	FED 80%
					VILLAGE 20%	VILLAGE 20%
					ROADWAY	SAFETY
S.I.	CODE NO.	PAY ITEM	UNIT	TOTAL QUANTITY	CONSTRUCTION TYPE CODE	
					0005	0021
*	72800100	TELESCOPING STEEL SIGN SUPPORT	FOOT	199		199
*	78000200	THERMOPLASTIC PAVEMENT MARKING - LINE 4"	FOOT	7,040		7,040
*	78000600	THERMOPLASTIC PAVEMENT MARKING - LINE 12"	FOOT	84		84
*	78000650	THERMOPLASTIC PAVEMENT MARKING - LINE 24"	FOOT	80		80
	X2501020	SEEDING, CLASS 2A (SPECIAL)	ACRE	0.25	0.25	
	X4021000	TEMPORARY ACCESS (PRIVATE ENTRANCE)	EACH	1	1	
	X4022000	TEMPORARY ACCESS (COMMERCIAL ENTRANCE)	EACH	16	16	
	X4810200	AGGREGATE SHOULDER REMOVAL	CU YD	18	18	
	X6030310	FRAMES AND LIDS TO BE ADJUSTED (SPECIAL)	EACH	1	1	
	Z0004530	HOT-MIX ASPHALT DRIVEWAY PAVEMENT, 8"	SQ YD	1,391	1,391	
	Z0017400	DRAINAGE & UTILITY STRUCTURES TO BE ADJUSTED	EACH	4	4	
	Z0017700	DRAINAGE & UTILITY STRUCTURES TO BE RECONSTRUCTED	EACH	1	1	
	Z0030850	TEMPORARY INFORMATION SIGNING	SQ FT	200	200	

* SPECIALTY ITEM

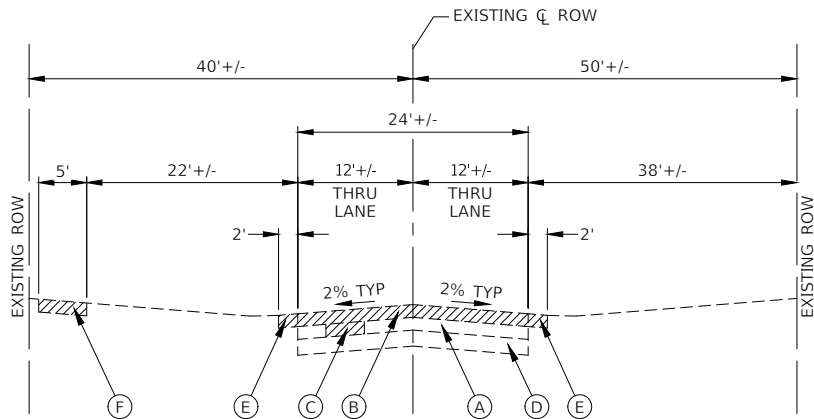

EXISTING TYPICAL SECTION
TAFT DRIVE
STA 101+04 TO STA 106+70

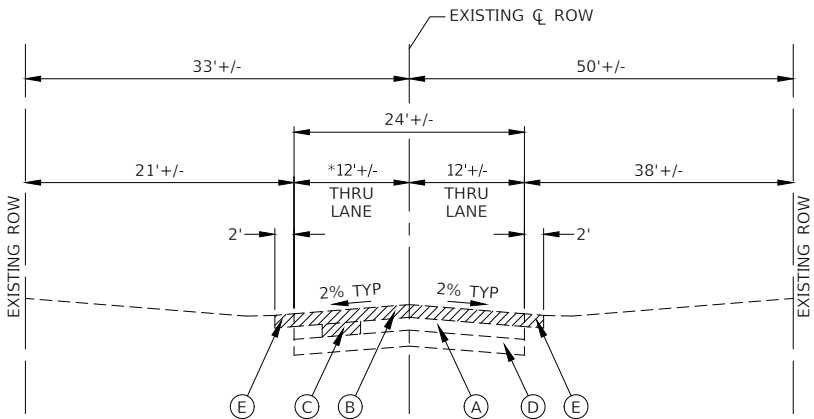

EXISTING TYPICAL SECTION
TAFT DRIVE
STA 106+70 TO STA 119+94.07

*AN ASPHALT SHOULDER VARYING FROM 0' TO 5' EXISTS ON THE NORTH SIDE OF TAFT DRIVE BETWEEN STA 110+00 AND STA 114+00 THAT SHALL BE MILLED AT THE SAME DEPTH AS THE ROADWAY.

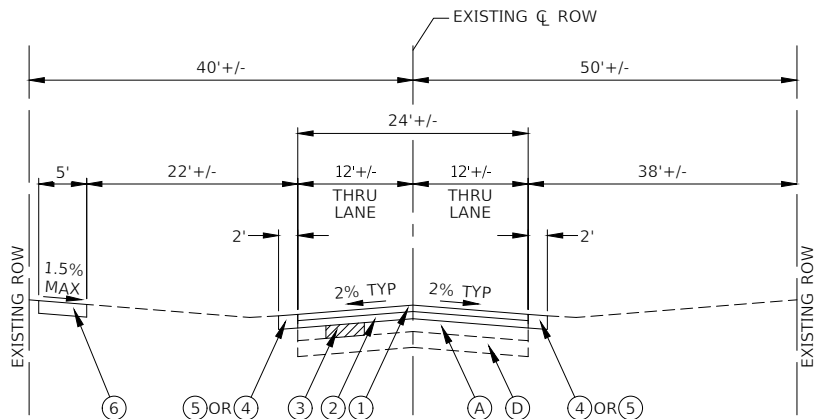

PROPOSED TYPICAL SECTION
TAFT DRIVE
STA 101+04 TO STA 106+70

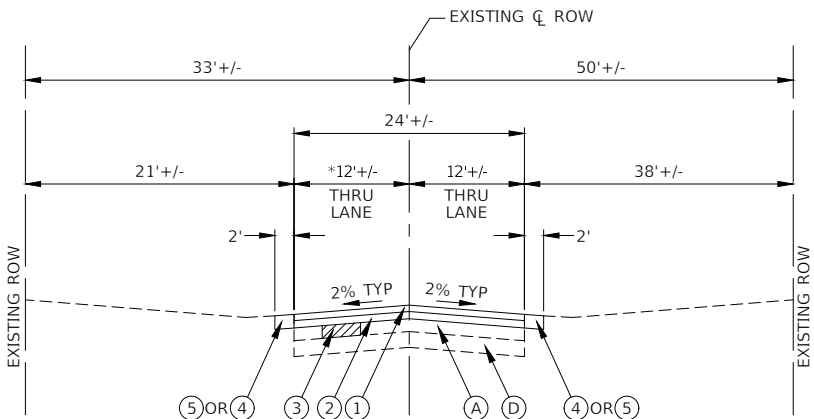

PROPOSED TYPICAL SECTION
TAFT DRIVE
STA 106+70 TO STA 119+94.07

*THE ASPHALT SHOULDER ON THE NORTH SIDE OF TAFT DRIVE BETWEEN STA 110+00 AND 114+00 SHALL BE PAVED THE SAME DETPH AS THE ROADWAY.

EXISTING LEGEND

- (A) EXISTING HMA PAVEMENT, 7" TO 8"±
- (B) HOT-MIX ASPHALT SURFACE REMOVAL, 4"
- (C) PAVEMENT REMOVAL FOR CLASS D PATCHES, 4 INCH
- (D) EXISTING SUBBASE, 4" TO 5"±
- (E) EXISTING GRASSED/AGGREGATE SHOULDER
- (F) EXISTING SIDEWALK

 ITEM TO BE REMOVED (AS DIRECTED BY ENGINEER)

NOTE:
THE LONGITUDINAL JOINT SEALANT SHALL BE PLACED ON
THE HOT-MIX ASPHALT BINDER COURSE, IL-19.0, N50.

PROPOSED LEGEND

- ① HOT-MIX ASPHALT SURFACE COURSE, IL-9.5, MIX "D", N50, 2"
- ② HOT-MIX ASPHALT BINDER COURSE, IL-19.0, N50, 2 1/4"
- ③ CLASS D PATCHES, 4 INCH (AS DIRECTED BY ENGINEER)
- ④ TOPSOIL FURNISH AND PLACE, 4" SEEDING, CLASS 2A (SPECIAL)
- ⑤ AGGREGATE SHOULDERS, TYPE B 4" (AS DIRECTED BY ENGINEER)
- ⑥ PORTLAND CEMENT CONCRETE SIDEWALK 5 INCH AGGREGATE BASE COURSE, TYPE B 4"

HOT-MIX ASPHALT MIXTURE REQUIREMENTS		
MIXTURE TYPE	AIR VOIDS @ Ndes	QMP
ROADWAY RESURFACING		
HOT-MIX ASPHALT SURFACE COURSE, IL-9.5, MIX "D", N50, 2"	4% @ 50 Gyr.	LR 1030-2
HOT-MIX ASPHALT BINDER COURSE, IL-19.0, N50, 2 1/4"	4% @ 50 Gyr.	LR 1030-2
HMA DRIVEWAY PAVEMENT, 8"		
HOT-MIX ASPHALT SURFACE COURSE, IL-9.5, MIX "D", N50, 2"	4% @ 50 Gyr.	LR 1030-2
HOT-MIX ASPHALT BINDER COURSE, IL-19.0, N50, 6"	4% @ 50 Gyr.	LR 1030-2
PATCHING		
CLASS D PATCHES (HMA BINDER IL-19mm), 4"	4% @ 70 Gyr.	LR 1030-2
QMP DESIGNATION: QUALITY CONTROL/QUALITY ASSURANCE (QC/QA) PER LR1030-2		

- NOTES:
- THE UNIT WEIGHT USED TO CALCULATE ALL HMA SURFACE MIXTURE IS 112 LBS/SQ YD/IN.
 - ALL PATCHING OPERATIONS SHALL TAKE PLACE AFTER SURFACE MILLING HAS BEEN COMPLETED.
 - THE "AC TYPE" FOR POLYMERIZED HMA MIXES SHALL BE "SBS/SBR PG 76-22" AND FOR NON-POLYMERIZED HMA THE "AC TYPE" SHALL BE "PG-64-22" UNLESS MODIFIED BY RECLAIMED MATERIALS SPECIFICATIONS.

FILE NAME = 23R0706-TYPX-01 - P03	USER NAME =	DESIGNED — MPN	REVISED —	STATE OF ILLINOIS DEPARTMENT OF TRANSPORTATION	TAFT DRIVE ROADWAY RESURFACING TYPICAL CROSS SECTIONS					F.A.U RTE.	SECTION	COUNTY	TOTAL SHEETS	SHEET NO.
		CHECKED — WPD	REVISED —							1044	22-00117-00-RS	COOK	17	6
	PLOT SCALE = 1"=50'	DRAWN — RG	REVISED —							CONTRACT NO. 61L20				
	PLOT DATE = 11-18-24	CHECKED — AG	REVISED —											
					SCALE: 1"=50'	SHEET NO. 6	OF 17 SHEETS	STA.	TO STA.	FED. ROAD DIST. NO. 1	ILLINOIS	FED. AID PROJECT	Y7DP(186)	

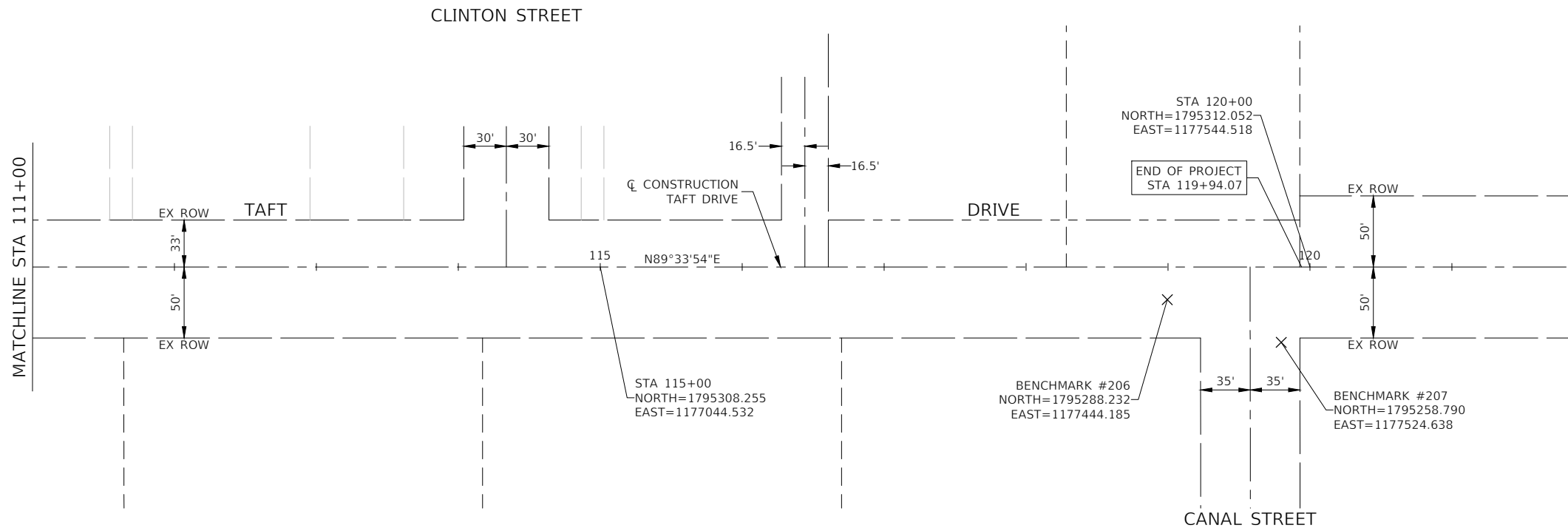
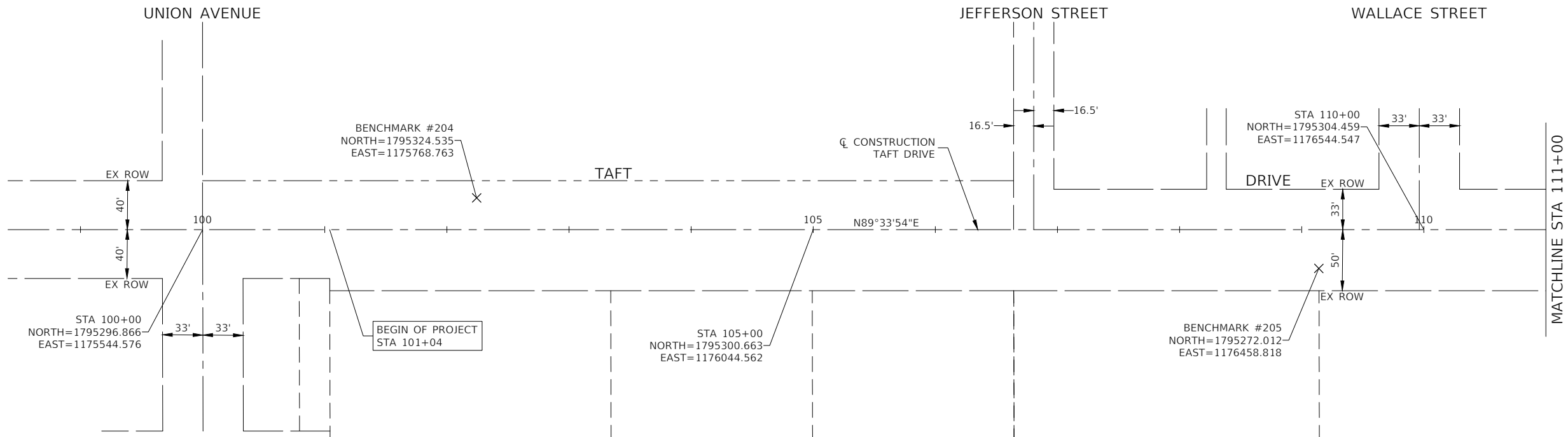
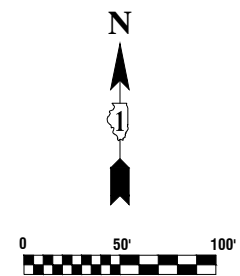

NOTES

- COORDINATES ARE BASED ON ILLINOIS STATE PLANE EASTERN ZONE NORTH AMERICAN DATUM 1983
- SURVEY FEET UNITS WERE USED.
- ALL ELEVATIONS REFER TO NAVD88 DATUM.

BENCHMARKS

BENCHMARK #204
RR SPIKE IN SOUTH FACE OF PP ON NORTH SIDE TAFT DR, 2ND PP EAST OF UNION AVE.
ELEV=606.14

BENCHMARK #205
SPIKE NAIL IN NORTH FACE OF PP, 1ST PP WEST OF WALLACE WAY ON SOUTH SIDE TAFT DR.
ELEV=604.86

BENCHMARK #206
CROSS ON TOP OF NORTH BOLT OF CONC BASE FOR LIGHT POLE AT SOUTHWEST COR TAFT DR & CANAL ST.
ELEV=603.72

BENCHMARK #207
SPIKE NAIL IN NORTH FACE OF PP AT SOUTHEAST COR TAFT DR & CANAL ST.
ELEV=604.07

FILE NAME = 23R0706-TIES-01 - TAFT DR	USER NAME =	DESIGNED — MPN	REVISED —	STATE OF ILLINOIS DEPARTMENT OF TRANSPORTATION	TAFT DRIVE ROADWAY RESURFACING ALIGNMENT AND TIES	F.A.U RTE.	SECTION	COUNTY	TOTAL SHEETS	SHEET NO.			
		CHECKED — WPD	REVISED —										
	PLOT SCALE = 1"=50'	DRAWN — BG	REVISED —										
	PLOT DATE = 11-18-24	CHECKED — AG	REVISED —										
					SCALE: 1"=50'	SHEET NO. 7	OF 17 SHEETS	STA.	TO STA.		FED. ROAD DIST. NO. 1 ILLINOIS		FED. AID PROJECT Y7DP(186)
					CONTRACT NO. 61L20								

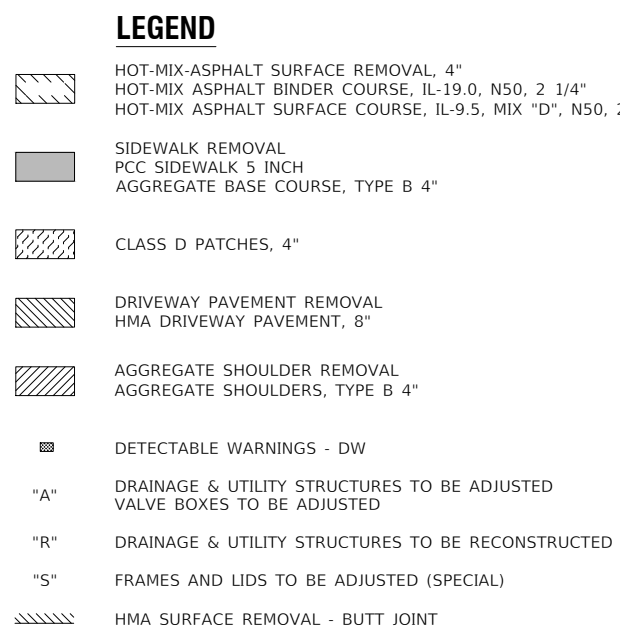
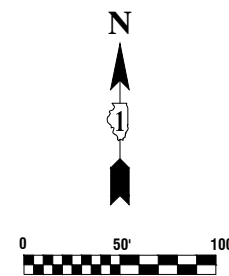

NOTE:

1. ALL SIDEWALK RAMPS WILL BE IN ACCORDANCE WITH THE HIGHWAY STANDARDS REFERENCED ON SHEET 2.
2. AREAS WHERE DRIVEWAY IS REMOVED AND NOT REPLACED SHALL BE RESTORED WITH TOPSOIL FURNISH AND PLACE, 4" AND SEEDING, CLASS 2A (SPECIAL)

FILE NAME = 23R0706-PLAN-01 - TAFT	USER NAME =	DESIGNED — MPN	REVISED —	STATE OF ILLINOIS DEPARTMENT OF TRANSPORTATION	TAFT DRIVE ROADWAY RESURFACING PROPOSED IMPROVEMENT PLAN			F A U R T E.	SECTION	COUNTY	TOTAL SHEETS	SHEET NO.
		CHECKED — WPD	REVISED —					1044	22-00117-00-RS	COOK	17	8
	PLOT SCALE = 1"=50'	DRAWN — BG	REVISED —		SCALE: 1"=50'			SHEET NO. 8	OF 17 SHEETS	STA.	TO STA.	
	PLOT DATE = 11-18-24	CHECKED — AG	REVISED —								CONTRACT NO. 61L20	
								FED. ROAD DIST. NO. 1 ILLINOIS FED. AID PROJECT Y7DP(186)				

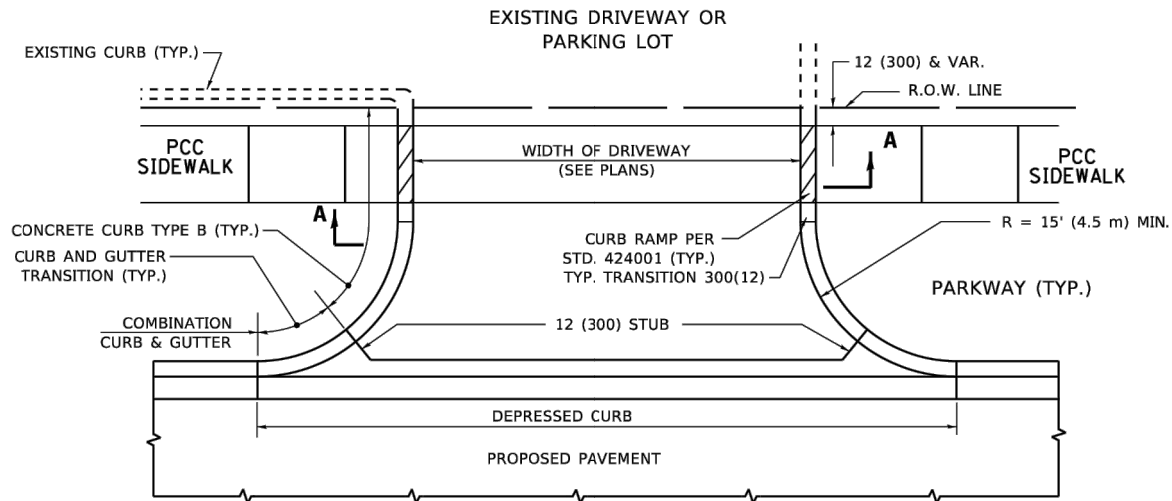

WITH CONCRETE CURB, TYPE B

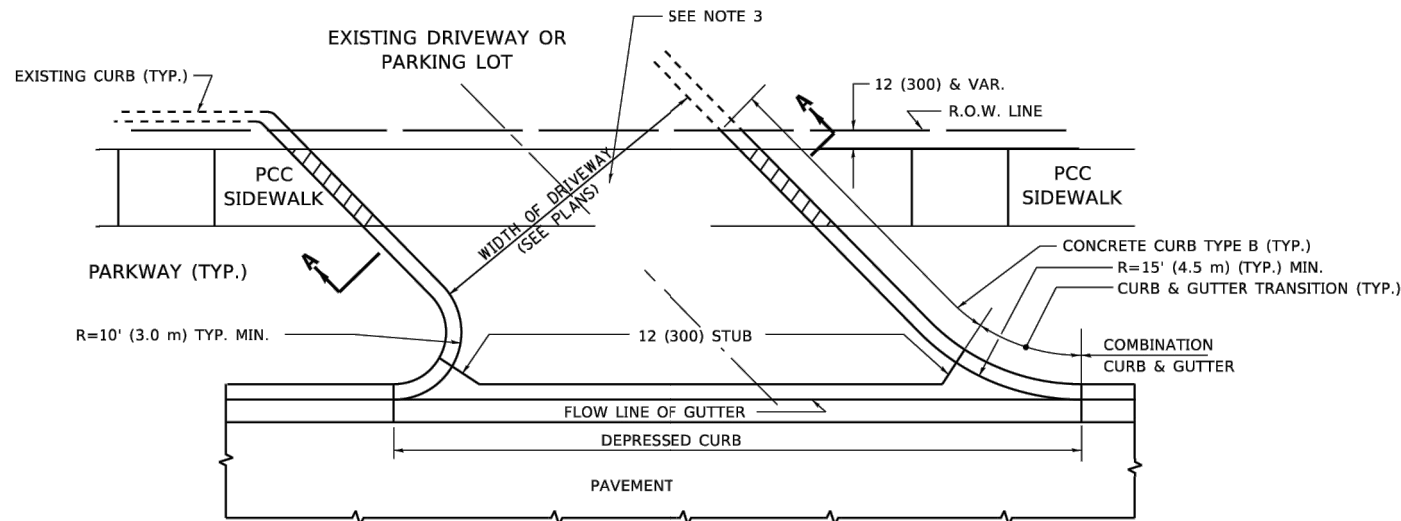

WITH CONCRETE CURB, TYPE B

RIGID DRIVEWAY

COMMERCIAL ENTRANCE (CE):
PCC DRIVEWAY PAVEMENT 8 (200)
MEASURED IN SQ. YD. (m²)

PRIVATE ENTRANCE (PE):
PCC DRIVEWAY PAVEMENT 8 (200)
MEASURED IN SQ. YD. (m²)

SECTION A-A

HMA DRIVEWAY

HMA SURFACE COURSE,
MIX "D", IL-9.5, N50, 2 (50)
MEASURED IN TONS (METRIC TONS)

COMMERCIAL ENTRANCE (CE):
HMA BASE COURSE, 6 (150)
MEASURED IN SQ. YD. (m²)

PRIVATE ENTRANCE (PE):
HMA BASE COURSE, 6 (150)
MEASURED IN SQ. YD. (m²)

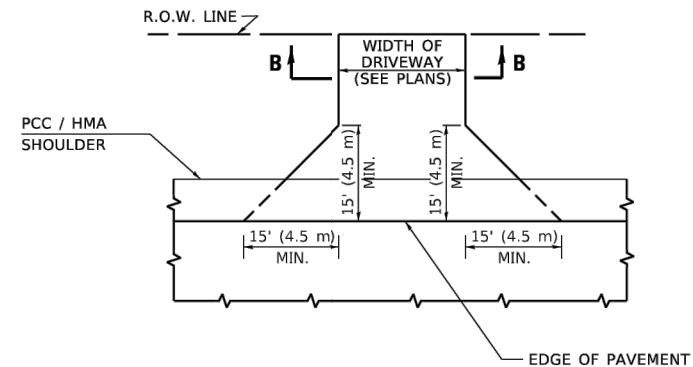

ADJACENT TO PCC /HMA SHOULDER

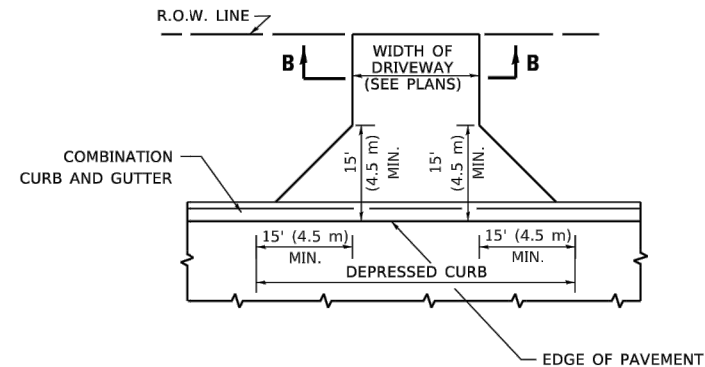

ADJACENT TO CURB AND GUTTER

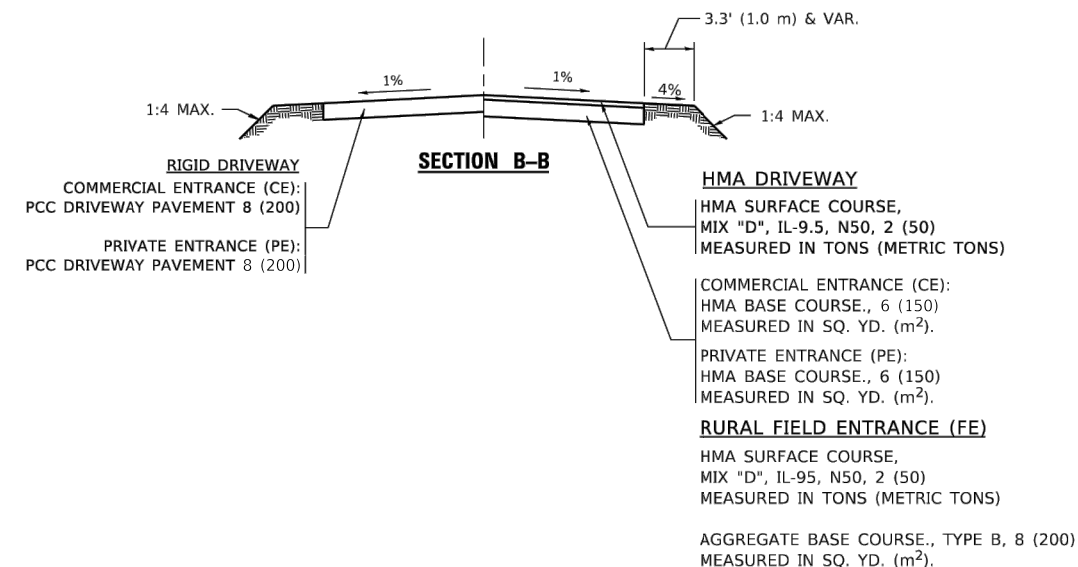

GENERAL NOTES

1. DRIVEWAY SLOPES, LOCATIONS, & GEOMETRIC LAYOUT SHALL BE IN ACCORDANCE WITH THE LATEST EDITION OF THE "HANDBOOK FOR POLICY ON PERMITS FOR ACCESS DRIVEWAYS TO STATE HIGHWAYS". FOR FURTHER LAYOUT REQUIREMENTS, REFER TO ILLUSTRATIONS IN THE PERMIT HANDBOOK. DRIVEWAYS SHALL BE REPLACED IN KIND, UNLESS OTHERWISE NOTED ON THE PLANS.
2. COMMERCIAL DRIVEWAYS SHALL BE CONSTRUCTED WITH CONCRETE CURB, TYPE B RETURNS EXCEPT WHEN THE SIDEWALK EDGE IS 4 FEET (1.2 METERS) OR LESS FROM THE BACK OF CURB, CONSTRUCT A FLARE DRIVEWAY WITHOUT CURB.

ALL DIMENSIONS ARE IN INCHES (MILLIMETERS)
UNLESS OTHERWISE NOTED.

FILE NAME = 23R0706-DTLS-02 - P01

USER NAME =

DESIGNED —

REVISED —

CHECKED —

REVIS

REVISED —

PLOT SCALE =

DRAWN —

REVISED —

PLOT DATE =

CHECKED —

REVISED —

STATE OF ILLINOIS
DEPARTMENT OF TRANSPORTATION

**DRIVEWAY DETAILS – DISTANCE BETWEEN R.O.W.
AND FACE OF CURB & EDGE OF SHOULDER ≥ 15'(4.5m)**

SCALE:

SHEET NO. 10 OF 17 SHEETS

STA.

TO STA.

F.A.U
RTE.

SECTION

COUNTY

TOTAL
SHEETS

SHEET
NO.

1044

22-00117-00-RS

COOK

17

10

MODIFIED BD-01

CONTRACT NO. 61L20

FED. ROAD DIST. NO. 1

ILLINOIS

FED. AID PROJECT Y7DP(186)

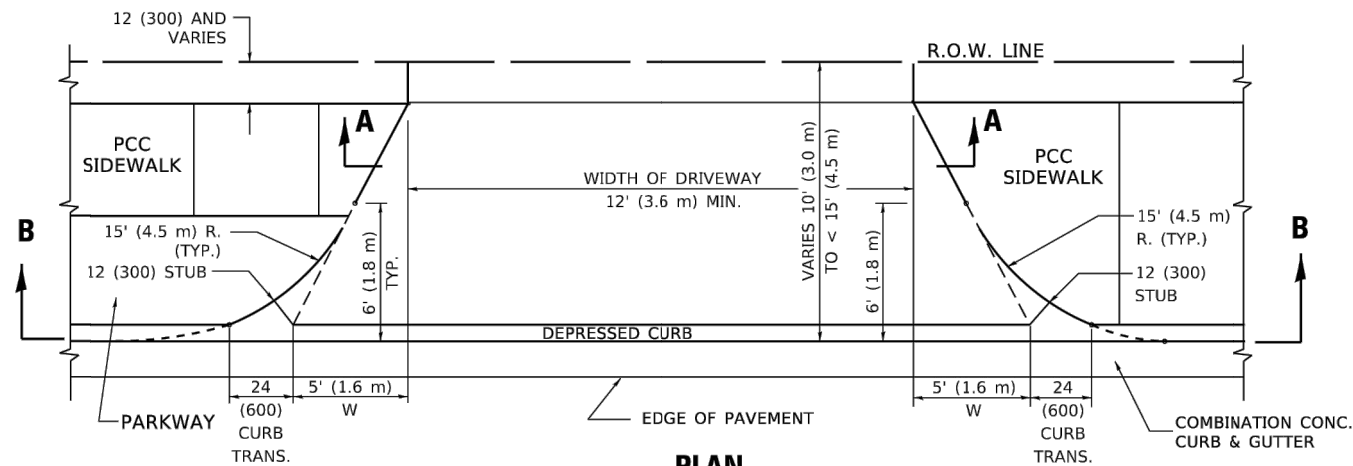

PLAN
10' (3.0 m) TO < 15' (4.5 m)

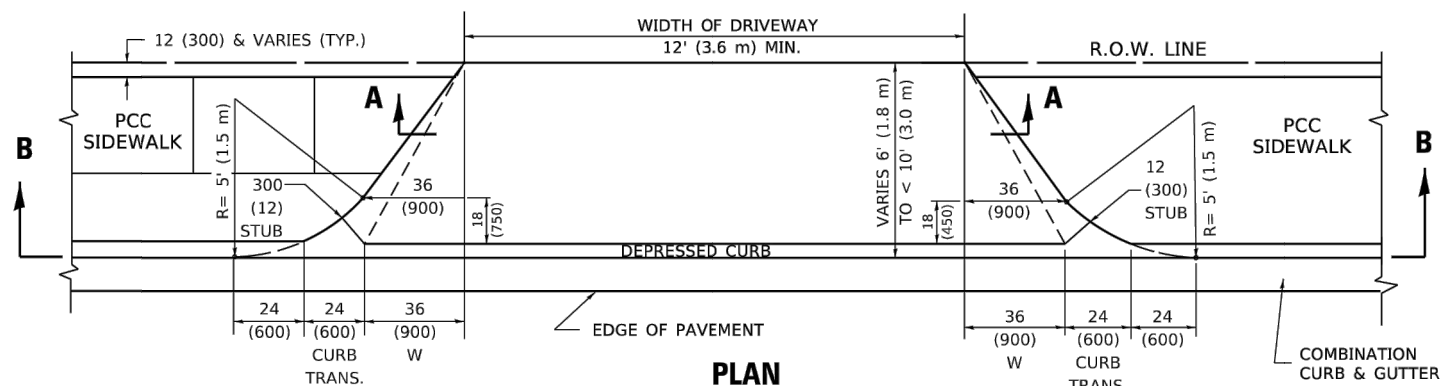

PLAN
6' (1.8 m) TO < 10' (3.0 m)

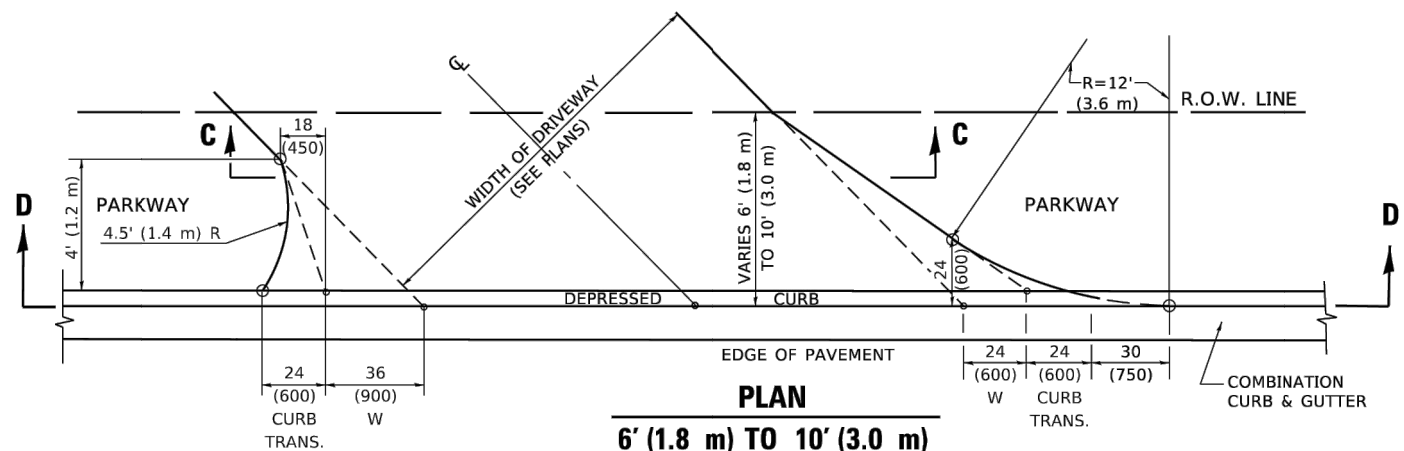

PLAN
6' (1.8 m) TO 10' (3.0 m)

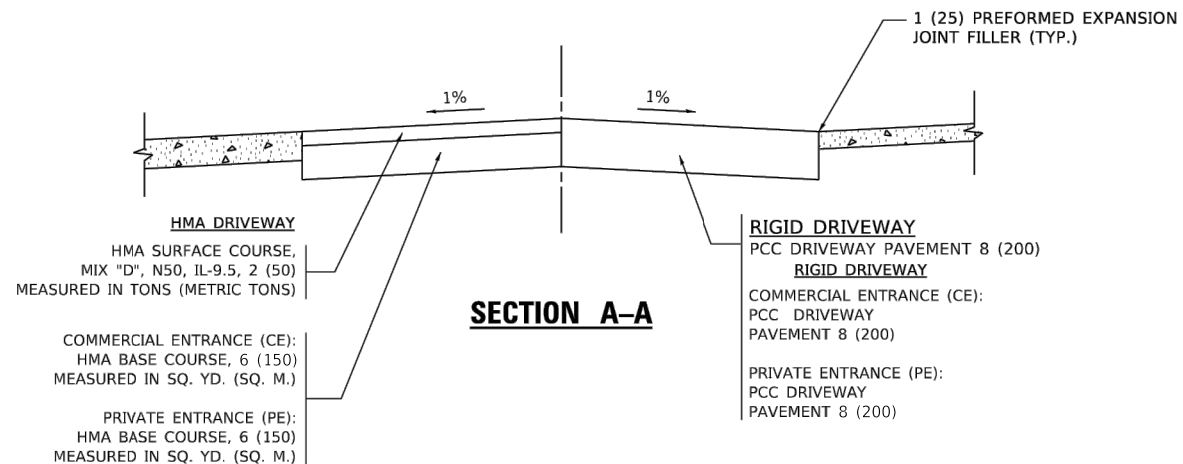

SECTION A-A

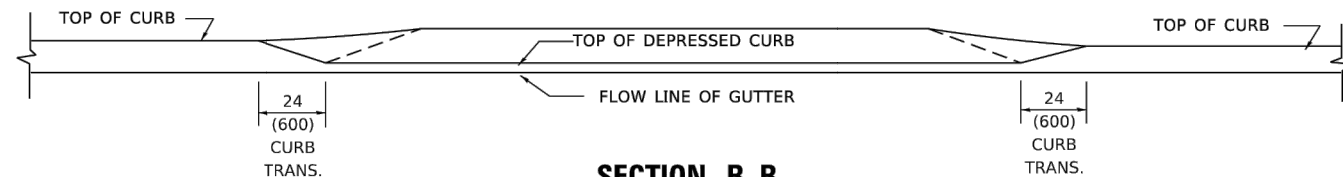

SECTION B-B

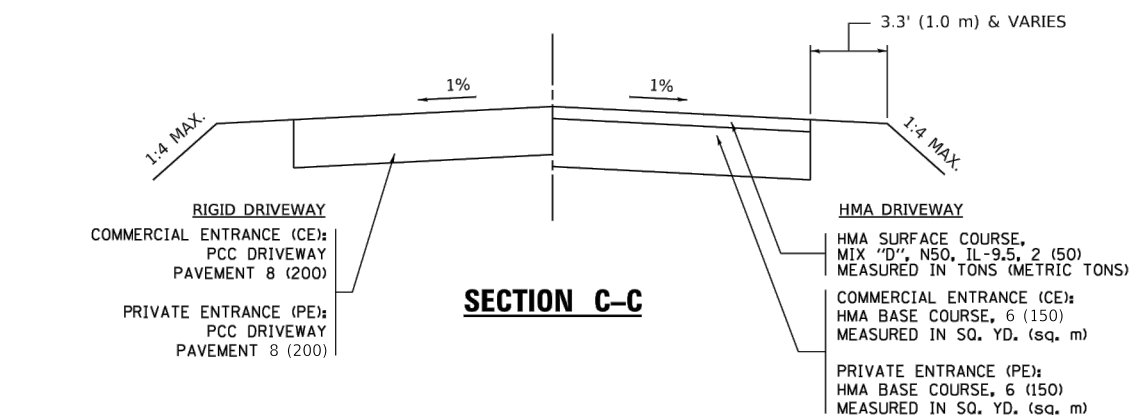

SECTION C-C

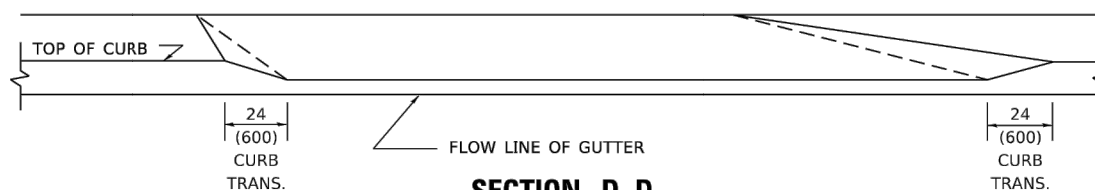

SECTION D-D

GENERAL NOTES

1. DRIVEWAY SLOPES, LOCATIONS, & GEOMETRIC LAYOUT SHALL BE IN ACCORDANCE WITH THE LATEST EDITION OF THE "HANDBOOK FOR POLICY ON PERMITS FOR ACCESS DRIVEWAYS TO STATE HIGHWAYS". FOR FURTHER LAYOUT REQUIREMENTS, REFER TO ILLUSTRATION 10 IN THE PERMIT HANDBOOK. WHERE SIDEWALKS EXIST, DRIVEWAYS SHALL BE REPLACED WITH RIGID PAVEMENT. WHERE NO SIDEWALKS EXIST, DRIVEWAYS SHALL BE REPLACED IN KIND. SIDEWALK CROSS SLOPE THRU DRIVEWAY AREA TO BE A MAXIMUM OF 1:50.
2. WHEN THE DISTANCE BETWEEN R.O.W. AND THE BACK OF CURB IS EQUAL TO OR LESS THAN 8' (2.4 m), THE PCC SIDEWALK SHALL EXTEND TO THE BACK OF CURB.
3. "W" VARIES FROM 36 (900) TO 5' (1.5 m) PROPORTIONAL TO THE LENGTH (L), FROM 6' (1.8 m) TO 10' (3 m).

ALL DIMENSIONS ARE IN INCHES (MILLIMETERS)
UNLESS OTHERWISE NOTED.

FILE NAME = 23R0706-DTLS-02 - P02

USER NAME =	DESIGNED —	REVISED —
	CHECKED —	REVISED —
PLOT SCALE =	DRAWN —	REVISED —
PLOT DATE =	CHECKED —	REVISED —

STATE OF ILLINOIS
DEPARTMENT OF TRANSPORTATION

DRIVEWAY DETAILS
DISTANCE BETWEEN ROW AND FACE OF CURB < 15' (4.5m)

SCALE: SHEET NO. 11 OF 17 SHEETS STA. TO STA.

F.A.U. RTE.	SECTION	COUNTY	TOTAL SHEETS	SHEET NO.
1044	22-00117-00-RS	COOK	17	11
MODIFIED BD-02		CONTRACT NO. 61L20		
FED. ROAD DIST. NO. 1	ILLINOIS	FED. AID PROJECT	Y7DP(186)	

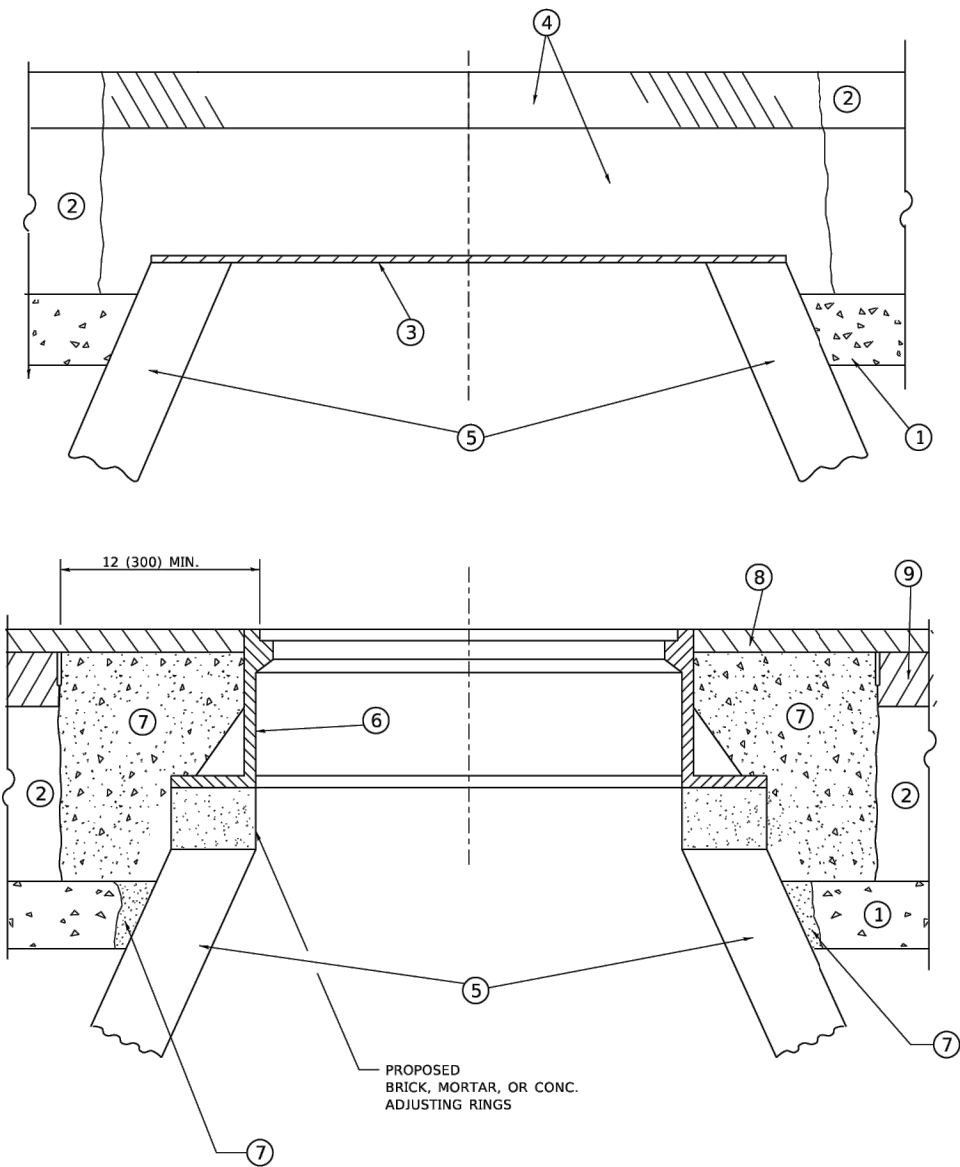

**DETAILS FOR FRAMES AND LIDS ADJUSTMENT
WITH MILLING**

NOTES

- EXISTING BROKEN FRAMES AND LIDS SHALL BE REMOVED AND DISPOSED OF BY THE CONTRACTOR AND SHALL BE REPLACED AS DIRECTED BY THE ENGINEER. REPLACEMENT FRAMES AND LIDS WILL BE PAID FOR IN ACCORDANCE WITH ARTICLE 109.04 OF THE STANDARD SPECIFICATIONS UNLESS A SEPARATE PAY ITEM HAS BEEN PROVIDED.
- IF THE EXISTING LIDS ARE OPEN, THE FRAME WILL BE ADJUSTED TO THE ELEVATION OF THE MILLED PAVEMENT SURFACE PRIOR TO THE MILLING OPERATION. THE FRAME WILL NOT BE REMOVED AND COVERED BY THE METAL PLATE.
- CITY OF CHICAGO CASTINGS ARE THE PROPERTY OF THE CITY AND THE CONTRACTOR SHALL NOTIFY THE CITY FOR REMOVAL AND DISPOSITION OF THE CASTINGS.
- THE METAL PLATE USED TO COVER THE STRUCTURE SHALL REMAIN THE PROPERTY OF THE CONTRACTOR.
- THE CONTRACTOR SHALL REMOVE ALL TRAFFIC CONTROL DEVICES BY THE END OF EACH WORK SHIFT.

CONSTRUCTION PROCEDURES

STAGE 1 (BEFORE PAVEMENT MILLING)

- REMOVE A MINIMUM OF 12 (300) OF THE PAVEMENT FROM AROUND THE STRUCTURE.
- REMOVE THE EXISTING FRAME AND LID FROM THE STRUCTURE.
- COVER THE STRUCTURE OPENING WITH A 36 (900) DIAMETER METAL PLATE.
- BACKFILL WITH CRUSHED STONE AND HMA SURFACE MIX APPROVED BY THE ENGINEER. (MIN. 3 (80) HMA TO REMAIN AFTER MILLING).

STAGE 2 (AFTER PAVEMENT MILLING)

- REMOVE THE HMA SURFACE MIX AND CRUSHED STONE.
- INSTALL THE FRAME AND LID; ADJUST THE FRAME TO ITS FINAL SURFACE ELEVATION.
- THE SURROUNDING SPACE SHALL BE FILLED WITH CLASS PP-2* CONCRETE TO THE ELEVATION OF THE SURFACE OF THE EXISTING BASE COURSE OR THE BINDER COURSE.

* UNLESS OTHERWISE SPECIFIED IN THE PLANS.

THE PROCEDURE EXPLAINED ABOVE SHALL CONFORM TO THE APPLICABLE PORTIONS OF SECTIONS 353, 406, 602, AND 603 OF THE STANDARD SPECIFICATIONS EXCEPT THAT "THE CONTRACTOR SHALL ADJUST THE STRUCTURES TO THE FINISHED PAVEMENT ELEVATION NO MORE THAN 5 CALENDAR DAYS PRIOR TO PLACEMENT OF THE FINAL LIFT OF SURFACE UNLESS APPROVED BY THE ENGINEER."

LEGEND

- | | |
|--|-------------------------------|
| ① SUB-BASE GRANULAR MATERIAL | ⑥ FRAME AND LID (SEE NOTES) |
| ② EXISTING PAVEMENT | ⑦ CLASS PP-2* CONCRETE |
| ③ 36 (900) DIAMETER METAL PLATE | ⑧ PROPOSED HMA SURFACE COURSE |
| ④ PROPOSED CRUSHED STONE AND HMA SURFACE MIX | ⑨ PROPOSED HMA BINDER COURSE |
| ⑤ EXISTING STRUCTURE | |

LOCATION OF STRUCTURES

THE CONTRACTOR WILL BE REQUIRED TO KEEP A RECORD OF THE LOCATIONS OF THE BURIED STRUCTURES ACCORDING TO THE STATION AND DISTANCE LEFT OR RIGHT OF THE CENTERLINE OF PAVEMENT. UPON COMPLETION OF THE WORK, THE CONTRACTOR WILL DELIVER THE RECORD TO THE ENGINEER.

BASIS OF PAYMENT

- REMOVING FRAMES AND LIDS ON DRAINAGE AND UTILITY STRUCTURES IN THE PAVEMENT PRIOR TO MILLING, AND ADJUSTING TO FINAL GRADE PRIOR TO PLACING THE SURFACE COURSE, WILL BE PAID FOR AT THE CONTRACT UNIT PRICE EACH FOR "FRAMES AND LIDS TO BE ADJUSTED (SPECIAL)."
- THIS WORK WILL NOT BE PAID FOR WHEN DRAINAGE AND UTILITY STRUCTURES ARE SPECIFIED FOR PAYMENT AS STRUCTURE RECONSTRUCTION.
- NEW FRAMES AND LIDS, WHEN SPECIFIED, WILL BE PAID FOR SEPARATELY.
- WHEN STRUCTURES ARE TO BE ADJUSTED OR RECONSTRUCTED, THE LOWERING AND RAISING OF THE FRAMES AND LIDS WILL NOT BE PAID FOR SEPARATELY BUT WILL BE INCLUDED IN THE COST OF THE CORRESPONDING PAY ITEM.

ALL DIMENSIONS ARE IN INCHES (MILLIMETERS) UNLESS OTHERWISE SHOWN

	USER NAME = Lawrence.DeManche	DESIGNED - R. SHAH	REVISED - R. BORO 03-09-11	STATE OF ILLINOIS DEPARTMENT OF TRANSPORTATION	DETAILS FOR FRAMES AND LIDS ADJUSTMENT WITH MILLING	F.A.U RTE.	SECTION	COUNTY	TOTAL SHEETS	SHEET NO.
		DRAWN -	REVISED - R. BORO 12-06-11			1044	22-00117-00-RS	COOK	17	12
	PLOT SCALE = 100.0000 ' / in.	CHECKED -	REVISED - K. SMITH 11-18-22			BD600-03 (BD-08)		CONTRACT NO. 61L20		
	PLOT DATE = 9/15/2023	DATE - 10-25-94	REVISED - K. SMITH 09-15-23			SCALE: NONE	SHEET 1 OF 1 SHEETS	STA. TO STA.	FED. ROAD DIST. NO. 1 ILLINOIS	FED. AID PROJECT Y7DP(186)

METHOD OF MEASUREMENT

REFER TO SECTION 442 OF THE STANDARD SPECIFICATIONS FOR ROAD AND BRIDGE CONSTRUCTION AND THE RECURRING SPECIAL PROVISION "PATCHING WITH HOT-MIX ASPHALT OVERLAY REMOVAL."

BASIS OF PAYMENT

- 1. REFER TO SECTION 442 OF THE STANDARD SPECIFICATIONS FOR ROAD AND BRIDGE CONSTRUCTION AND THE RECURRING SPECIAL PROVISION "PATCHING WITH HOT-MIX ASPHALT OVERLAY REMOVAL."
- 2. SAW CUT/SCORING OF EXISTING HMA OVERLAY IS INCLUDED IN THE COST OF PAVEMENT PATCHING.
- 3. SAW CUT/SCORING OF EXISTING PAVEMENT IS INCLUDED IN THE COST OF PAVEMENT PATCHING.

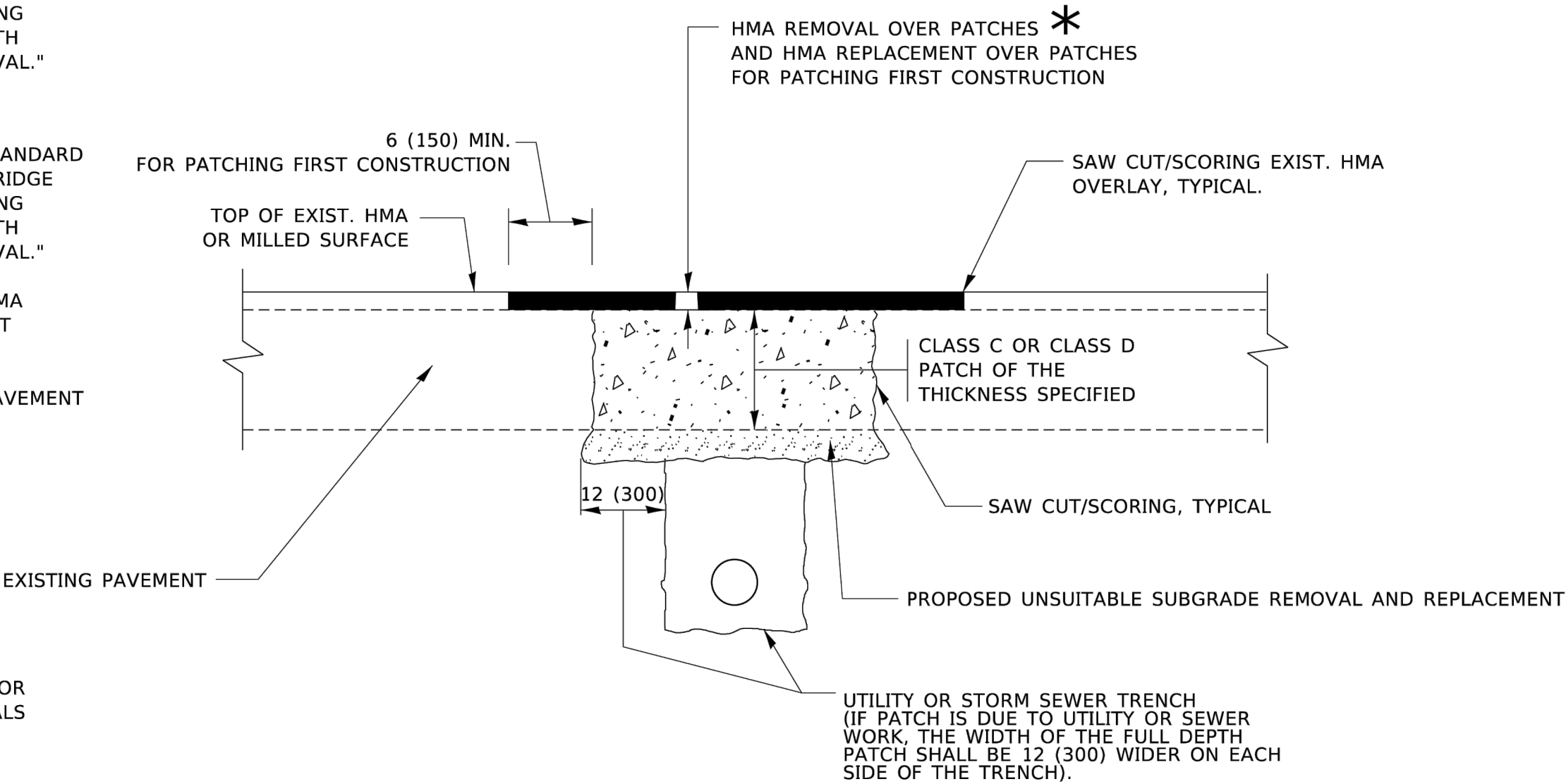

* SEE TYPICAL SECTIONS FOR
THICKNESS AND MATERIALS

SEQUENCE OF CONSTRUCTION (PATCHING FIRST)

- 1. REMOVE THE EXISTING HMA MATERIAL OVER THE AREA TO BE PATCHED.
- 2. REMOVE AND REPLACE WITH CLASS C OR D PATCH.
- 3. REPLACE HMA MATERIAL OVER THE AREA TO BE PATCHED.

SEQUENCE OF CONSTRUCTION (MILLING FIRST)

- 1. MILL HMA FIRST IF THERE IS AT LEAST 4½ INCHES OR MORE OF HMA MATERIAL ON TOP OF THE EXISTING PAVEMENT OR IF THE PAVEMENT IS FULL DEPTH HMA. A MINIMUM OF 2 INCHES OF HMA MATERIAL SHALL BE IN PLACE AFTER MILLING.
- 2. REMOVE AND REPLACE WITH FULL DEPTH CLASS D PATCHES TO TOP OF MILLED SURFACE.

ALL DIMENSIONS ARE IN INCHES (MILLIMETERS) UNLESS OTHERWISE SHOWN.

	USER NAME = Lawrence.DeManche	DESIGNED - R. SHAH	REVISED - R. BORO 01-01-07	STATE OF ILLINOIS DEPARTMENT OF TRANSPORTATION	PAVEMENT PATCHING FOR HMA SURFACED PAVEMENT	SCALE: NONE	SHEET 1 OF 1 SHEETS	STA. TO STA.	F.A.U RTE.	SECTION	COUNTY	TOTAL SHEETS	SHEET NO.
		DRAWN -	REVISED - R. BORO 09-04-07						1044	22-00117-00-RS	COOK	17	13
	PLOT SCALE = 100.0000 ' / in.	CHECKED -	REVISED - K. ENG 10-27-08						BD400-04 (BD-22)		CONTRACT NO. 61L20		
	PLOT DATE = 11/18/2022	DATE - 10-25-94	REVISED - K. SMITH 11-18-22						FED. ROAD DIST. NO. 1 ILLINOIS FED. AID PROJECT Y7DP(186)				

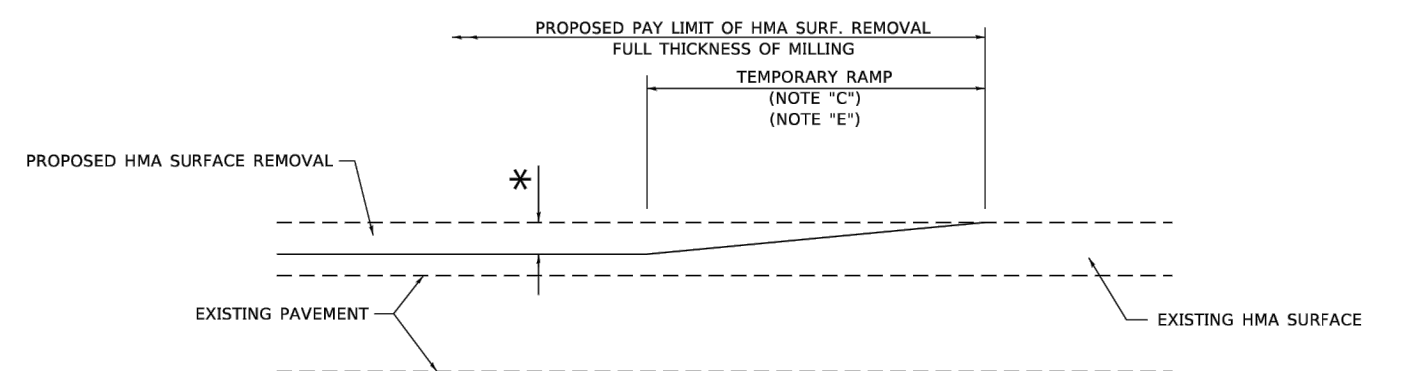

MILLED TEMPORARY RAMP

(FOR BUTT JOINT AND HMA TAPER SEE DETAIL BELOW)

OPTION 1

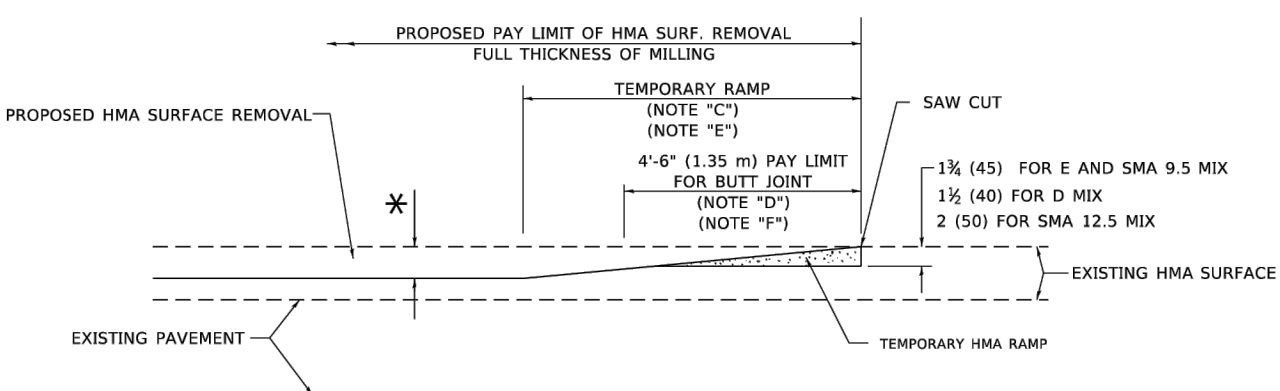

HMA CONSTRUCTED TEMPORARY RAMP

(FOR BUTT JOINT AND HMA TAPER SEE DETAIL BELOW)

OPTION 2

TYPICAL TEMPORARY RAMP

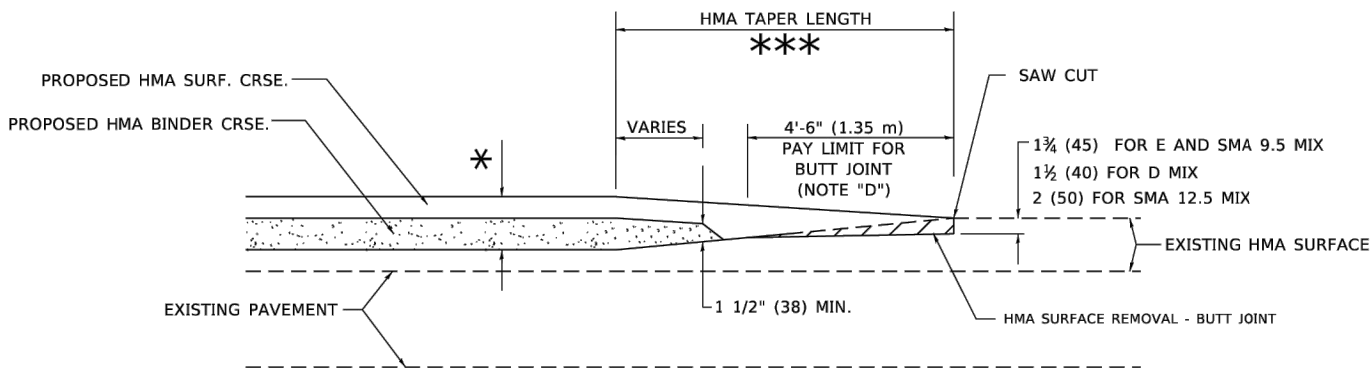

BUTT JOINT AND HMA TAPER

TYPICAL BUTT JOINT AND HMA TAPER FOR MILLING AND RESURFACING

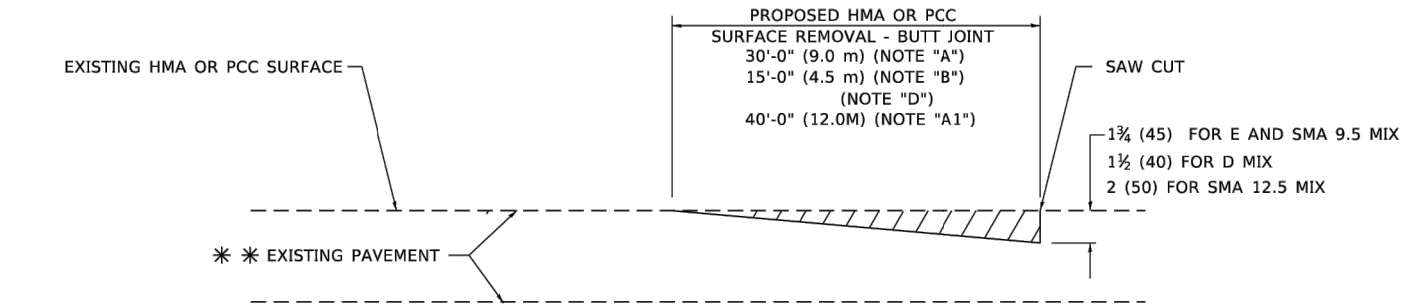

BUTT JOINT DETAIL

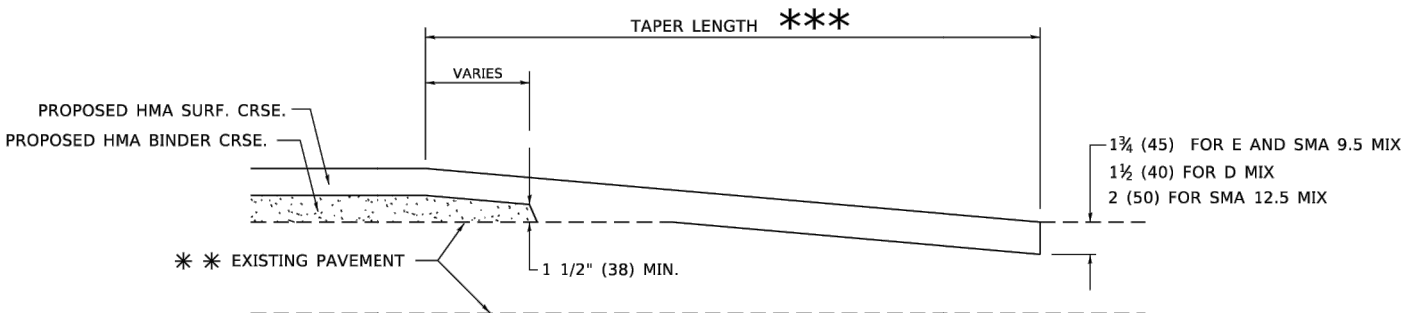

HMA TAPER DETAIL

TYPICAL BUTT JOINT AND HMA TAPER FOR RESURFACING ONLY

** PC CONCRETE, HMA OR HMA RESURFACED PAVEMENT.

GENERAL NOTES

- MAINLINE ARTERIAL ROADWAYS AND MAJOR SIDE ROADS.
- INTERSTATES
- MINOR SIDE ROADS.
- THE TEMP. RAMP SHALL BE CONSTRUCTED IMMEDIATELY UPON REMOVAL OF THE EXISTING HMA SURFACE.
- THE BUTT JOINT SHALL BE CONSTRUCTED IMMEDIATELY PRIOR TO PLACING THE PROPOSED HMA COURSES.
- TAPER THE TEMP. RAMP AT A RATE OF 3' - 4" (1.02m) PER 1 INCH (25 mm) OF MILLING THICKNESS.
* SEE TYPICAL SECTIONS FOR MILLING THICKNESS.
- SEE ARTICLE 406.08 AND 406.14 OF THE STANDARD SPECIFICATIONS FOR "HMA AND/OR PCC SURFACE REMOVAL, BUTT JOINT".
*** 20'-0" (6.1 m) PER 1 (25) RESURFACING (NOTE "A")
10'-0" (3.0 m) PER 1 (25) RESURFACING (NOTE "B")

BASIS OF PAYMENT

- THE BUTT JOINT WILL BE PAID FOR AT THE CONTRACT UNIT PRICE PER SQUARE YARD (SQUARE METER) FOR "HOT-MIX ASPHALT SURFACE REMOVAL - BUTT JOINT" OR FOR "PORTLAND CEMENT CONCRETE SURFACE REMOVAL- BUTT JOINT".
- THE TEMPORARY RAMP AND SAW CUT SHALL BE INCLUDED IN THE UNIT COST FOR HMA OR PCC SURFACE REMOVAL-BUTT JOINT.

ALL DIMENSIONS ARE IN INCHES (MILLIMETERS) UNLESS OTHERWISE SHOWN.

USER NAME = Lawrence.DeManche	DESIGNED - M. DE YONG	REVISED - A. ABBAS 03-21-97
	DRAWN -	REVISED - M. GOMEZ 04-06-01
PLOT SCALE = 100.0000 ' / in.	CHECKED -	REVISED - R. BORO 01-01-07
PLOT DATE = 11/18/2022	DATE - 06-13-90	REVISED - K. SMITH 11-18-22

STATE OF ILLINOIS
DEPARTMENT OF TRANSPORTATION

BUTT JOINT AND HMA TAPER DETAILS

SCALE: NONE SHEET 1 OF 1 SHEETS STA. TO STA.

F.A.U RTE.	SECTION	COUNTY	TOTAL SHEETS	SHEET NO.
1044	22-00117-00-RS	COOK	17	14
BD400-05 BD-32		CONTRACT NO. 61L20		
FED. ROAD DIST. NO. 1	ILLINOIS	FED. AID PROJECT	Y7DP(186)	



* TYPE III BARRICADES
WITH TWO FLASHING AMBER
LIGHTS ON EACH. (SEE NOTE

TYPE I OR TYPE II BARRICADES WITH ONE FLASHING AMBER LIGHT ON EACH, OR TYPE III BARRICADES WITH TWO FLASHING AMBER LIGHTS ON EACH. (SEE NOTE 1)



DRIVEWAY

* COLLECTION
SPEED LIMIT> 40 MPH (60 km/h)

**** LOCAL STREET; SPEED
LIMIT 40 MPH OR LESS**

200' (60 m)



W20-I103(0)

M6-4(0) 21"X15"

OR

M6-1(0) 21"X15"
(SEE NOTE 4)

SIDE ROAD WITH A SPEED LIMIT OF 40 MPH (60 km/h) OR LESS AS SHOWN ON THE DRAWING AND AS DIRECTED BY THE ENGINEER:

- ONE "ROAD CONSTRUCTION AHEAD" SIGN 36 x 36 (900x900) WITH A FLASHER MOUNTED ON IT APPROXIMATELY 200' (60 m) IN ADVANCE OF THE MAIN ROUTE.
- THE CLOSED PORTION OF THE MAIN ROUTE SHALL BE PROTECTED BY BLOCKING WITH TYPE I, TYPE II OR TYPE III BARRICADES, 1/3 OF THE CROSS SECTION OF THE CLOSED PORTION.

SIDE ROAD WITH A SPEED LIMIT GREATER THAN 40 MPH (60 km/h) AS SHOWN ON THE DRAWING AND AS DIRECTED BY THE ENGINEER:

- ONE "ROAD CONSTRUCTION AHEAD" SIGN 48 x 48 (1.2 m x 1.2 m) WITH A FLASHER MOUNTED ON IT APPROXIMATELY 500' (150 m) IN ADVANCE OF THE MAIN ROUTE.
- THE CLOSED PORTION OF THE MAIN ROUTE SHALL BE PROTECTED BY BLOCKING WITH TYPE III BARRICADES, 1/2 OF THE CROSS SECTION OF THE CLOSED PORTION.

CONES MAY BE SUBSTITUTED FOR BARRICADES OR DRUMS AT HALF THE SPACING DURING DAY OPERATIONS. CONES SHALL BE A MINIMUM OF 28 (710) IN HEIGHT.

WHEN THE SIDE ROAD LIES BETWEEN THE BEGINNING OF THE MAINLINE SIGNING AND THE WORK ZONE, A SINGLE HEADED ARROW (M6-1) SHALL BE USED IN LIEU OF THE DOUBLE HEADED ARROW (M6-4).

- WHEN WORK IS BEING PERFORMED ON A SIDE ROAD OR DRIVEWAY, FOLLOW THE APPLICABLE STANDARD(S). THE DIRECTIONAL ARROW (M6-1 OR M6-4) SHALL BE COVERED OR REMOVED WHEN NO LONGER CONSISTENT WITH THE TRAFFIC CONTROL SET-UP.
- ADVANCE WARNING SIGNS ARE TO BE OMITTED ON DRIVEWAYS UNLESS OTHERWISE SPECIFIED IN THE PLANS OR BY THE ENGINEER.
- THE TRAFFIC CONTROL AND PROTECTION FOR SIDE ROADS, INTERSECTIONS, AND DRIVEWAYS SHALL BE INCLUDED IN THE COST OF SPECIFIED TRAFFIC CONTROL STANDARDS OR ITEMS.

All dimensions are in inches (millimeters) unless otherwise shown.

	USER NAME = Lawrence,DeManche	DESIGNED - L.H.A.	REVISED - T. RAMMACHER 01-06-00	STATE OF ILLINOIS DEPARTMENT OF TRANSPORTATION	TRAFFIC CONTROL AND PROTECTION FOR SIDE ROADS, INTERSECTIONS, AND DRIVEWAYS				F.A.U RTE.	SECTION		COUNTY	TOTAL SHEETS	SHEET NO.
		DRAWN -	REVISED - A. SCHUETZE 07-01-13						1044	22-0017-00-RS		COOK	17	15
	PLOT SCALE = 100.0000 ' / in.	CHECKED -	REVISED - A. SCHUETZE 09-15-16		TC-10				CONTRACT NO. 61L20					
	PLOT DATE = 5/8/2024	DATE - 06-89	REVISED - D. SENDERAK 05-03-24		SCALE: NONE	SHEET 1	OF 1	SHEETS	STA.	TO STA.		FED. ROAD DIST. NO. 1	ILLINOIS	FED. AID PROJECT Y7DP(186)

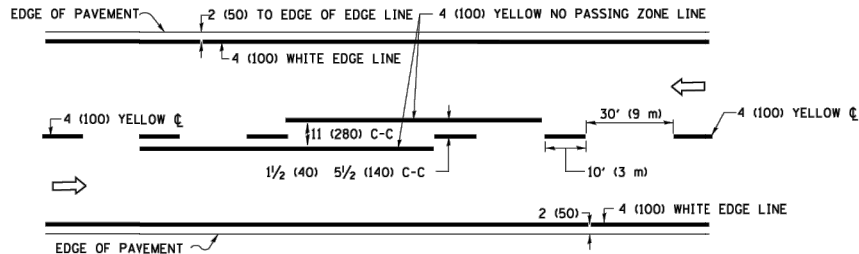

2-LANE ROADWAY

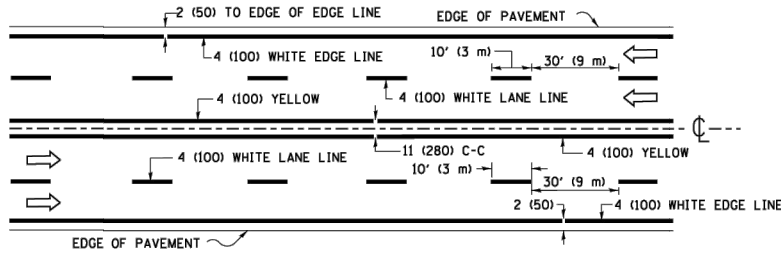

MULTI-LANE UNDIVIDED

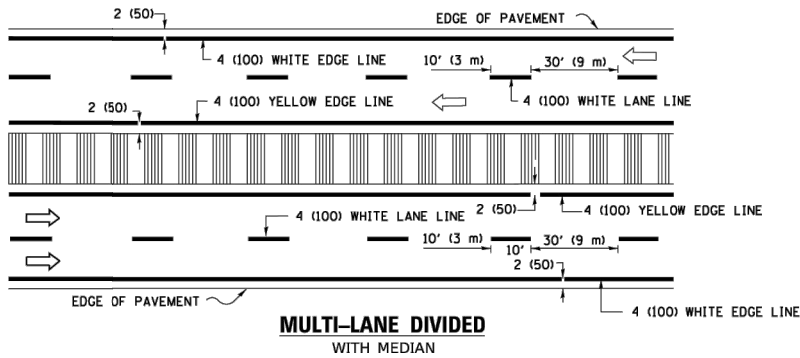

MULTI-LANE DIVIDED WITH MEDIAN

TYPICAL LANE AND EDGE LINE MARKING

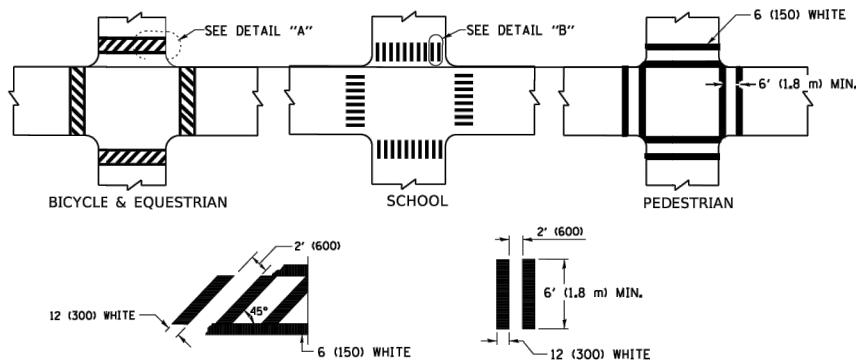

DETAIL "A"

DETAIL "B"

TYPICAL CROSSWALK MARKING

* MARKINGS SHALL BE INSTALLED PARALLEL TO THE CENTERLINE OF THE ROAD WHICH IT CROSSES

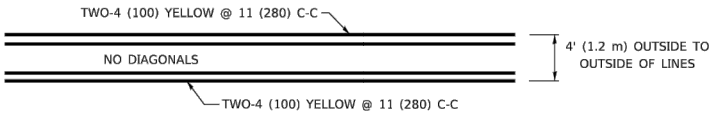

4' (1.2 m) WIDE MEDIANS ONLY

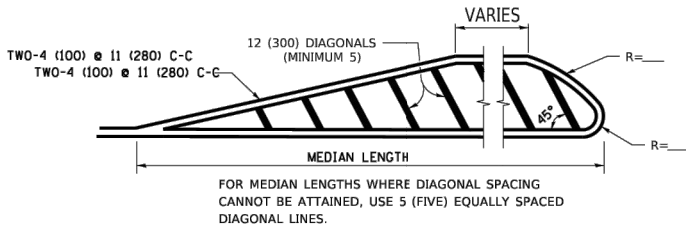

MEDIANS OVER 4' (1.2 m) WIDE

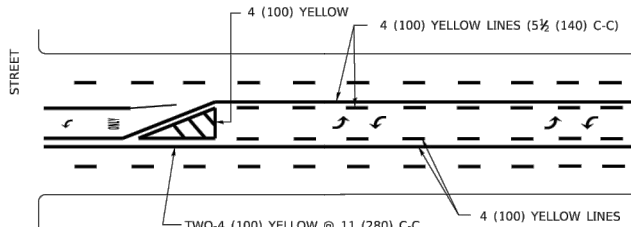

A MINIMUM OF TWO PAIRS OF TURN ARROWS SHALL BE USED, WHITE IN COLOR. ADDITIONAL PAIRS SHALL BE PLACED AT 200' (60 m) TO 300' (90 m) INTERVALS.

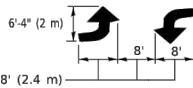

MEDIAN WITH TWO-WAY LEFT TURN LANE

TYPICAL PAINTED MEDIAN MARKING

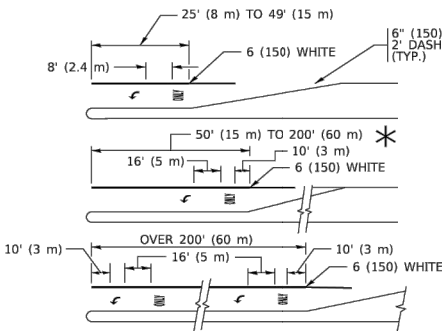

FULL SIZE LETTERS 8' (2.4 m) AND ARROWS SHALL BE USED.
AREA = 15.6 SQ. FT. (1.5 m²) ONLY AREA = 20.8 SQ. FT. (1.9 m²)
TURN LANES IN EXCESS OF 400' (120 m) IN LENGTH MAY HAVE AN ADDITIONAL SET OF ARROW - "ONLY" INSTALLED MIDWAY BETWEEN THE OTHER TWO SETS OF ARROW - "ONLY".

TYPICAL LEFT (OR RIGHT) TURN LANE

TYPICAL TURN LANE MARKING

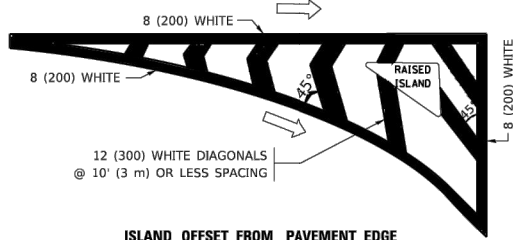

ISLAND OFFSET FROM PAVEMENT EDGE

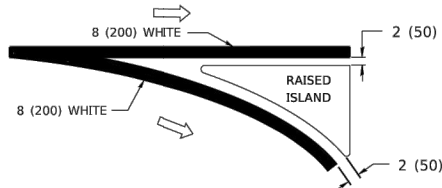

ISLAND AT PAVEMENT EDGE

TYPICAL ISLAND MARKING

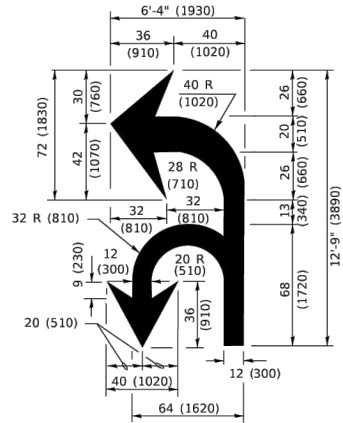

COMBINATION LEFT AND U-TURN

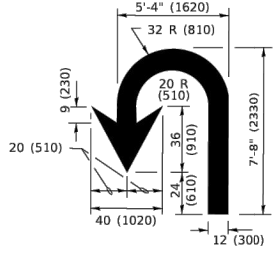

U-TURN

LANE REDUCTION TRANSITION

* LANE REDUCTION ARROWS REQUIRED AT SPEEDS OF 45 MPH OR GREATER OR WHEN SPECIFIED IN PLANS.

D(FT)	SPEED LIMIT
345	30
425	35
500	40
580	45
665	50
750	55

TYPE OF MARKING	WIDTH OF LINE	PATTERN	COLOR	SPACING / REMARKS
CENTERLINE ON 2 LANE PAVEMENT	4 (100)	SKIP-DASH	YELLOW	10' (3 m) LINE WITH 30' (9 m) SPACE
CENTERLINE ON MULTI-LANE UNDIVIDED PAVEMENT	2 @ 4 (100)	SOLID	YELLOW	11 (280) C-C
NO PASSING ZONE LINES: FOR ONE DIRECTION FOR BOTH DIRECTIONS	4 (100) 2 @ 4 (100)	SOLID SOLID	YELLOW YELLOW	5½ (140) C-C FROM SKIP-DASH CENTERLINE 11 (280) C-C OMIT SKIP-DASH CENTERLINE BETWEEN
LANE LINES	4 (100) 5 (125) ON FREEWAYS	SKIP-DASH SKIP-DASH	WHITE WHITE	10' (3 m) LINE WITH 30' (9 m) SPACE
DOTTED LINES (EXTENSIONS OF CENTER, LANE OR TURN LANE MARKINGS)	SAME AS LINE BEING EXTENDED	SKIP-DASH	SAME AS LINE BEING EXTENDED	2' (600) LINE WITH 6' (1.8 m) SPACE
EDGE LINES	4 (100)	SOLID	YELLOW-LEFT WHITE-RIGHT	OUTLINE MEDIANS IN YELLOW
TURN LANE MARKINGS	6 (150) LINE: FULL SIZE LETTERS & SYMBOLS (8' (2.4m))	SOLID	WHITE	SEE TYPICAL TURN LANE MARKING DETAIL
TWO WAY LEFT TURN MARKING	2 @ 4 (100) EACH DIRECTION 8' (2.4m) LEFT ARROW	SKIP-DASH AND SOLID IN PAIRS	YELLOW WHITE	10' (3 m) LINE WITH 30' (9 m) SPACE FOR SKIP-DASH; 5½ (140) C-C BETWEEN SOLID LINE AND SKIP-DASH LINE SEE TYPICAL TWO-WAY LEFT TURN MARKING DETAIL
CROSSWALK LINES (PEDESTRIAN) A. DIAGONALS (BIKE & EQUESTRIAN) B. LONGITUDINAL BARS (SCHOOL)	2 @ 6 (150) 12 (300) @ 45° 12 (300) @ 90°	SOLID SOLID SOLID	WHITE WHITE WHITE	NOT LESS THAN 6' (1.8 m) APART 2' (600) APART 2' (600) APART SEE TYPICAL CROSSWALK MARKING DETAILS.
STOP LINES	24 (600)	SOLID	WHITE	PLACE 4' (1.2 m) IN ADVANCE OF AND PARALLEL TO CROSSWALK, IF PRESENT. OTHERWISE, PLACE AT DESIRED STOPPING POINT. PARALLEL TO CROSSROAD CENTERLINE, WHERE POSSIBLE
PAINTED MEDIANS	2 @ 4 (100) WITH 12 (300) DIAGONALS @ 45° NO DIAGONALS USED FOR 4' (1.2 m) WIDE MEDIANS	SOLID	YELLOW: TWO WAY TRAFFIC WHITE: ONE WAY TRAFFIC	11 (280) C-C FOR THE DOUBLE LINE SEE TYPICAL PAINTED MEDIAN MARKING.
GORE MARKING AND CHANNELIZING LINES	8 (200) WITH 12 (300) DIAGONALS @ 45°	SOLID	WHITE	DIAGONALS: 15' (4.5 m) C-C (LESS THAN 30MPH (50 km/h)) 20' (6 m) C-C 30MPH (50 km/h) TO 45MPH (70 km/h) 30' (9 m) C-C (OVER 45MPH (70 km/h))
RAILROAD CROSSING	24 (600) TRANSVERSE LINES: "RR" 15 6' (1.8 m) LETTERS; 16 (400) LINE FOR "X"	SOLID	WHITE	SEE STATE STANDARD 780001 AREA OF: "R"=3.6 SQ. FT. (0.33 m ²) EACH "X"=54.0 SQ. FT. (5.0 m ²)
SHOULDER DIAGONALS (REQUIRED FOR SHOULDERS ≥ 8')	12 (300) @ 45°	SOLID	WHITE - RIGHT YELLOW - LEFT	50' (15 m) C-C (LESS THAN 30MPH (50 km/h)) 75' (25 m) C-C (30 MPH (50 km/h) TO 45MPH (70 km/h)) 150' (45 m) C-C (OVER 45MPH (70 km/h))
U TURN ARROW	SEE DETAIL	SOLID	WHITE	16.3 SF
2 ARROW COMBINATION LEFT AND U TURN	SEE DETAIL	SOLID	WHITE	30.4 SF

FOR FURTHER DETAILS ON PAVEMENT MARKING REFER TO STANDARD SPECIFICATIONS FOR ROAD AND BRIDGE CONSTRUCTION AND STATE STANDARD 780001.

All dimensions are in inches (millimeters) unless otherwise shown.

	USER NAME = footemj	DESIGNED - EVERS	REVISED - C. JUCIUS 09-09-09	STATE OF ILLINOIS DEPARTMENT OF TRANSPORTATION	DISTRICT ONE TYPICAL PAVEMENT MARKINGS				F.A.U RTE.	SECTION		COUNTY	TOTAL SHEETS	SHEET NO.			
		DRAWN -	REVISED - C. JUCIUS 07-01-13						1044	22-00117-00-RS		COOK	NO. 17	16			
	PLOT SCALE = 50.0000 ' / in.	CHECKED -	REVISED - C. JUCIUS 12-21-15						TC-13								
	PLOT DATE = 3/4/2019	DATE - 03-19-90	REVISED - C. JUCIUS 04-12-16		SCALE: NONE				SHEET 1 OF 2 SHEETS	STA.	TO STA.		FED. ROAD DIST. NO. 1 ILLINOIS			FED. AID PROJECT Y7DP(186)	
									CONTRACT NO. 61L20								

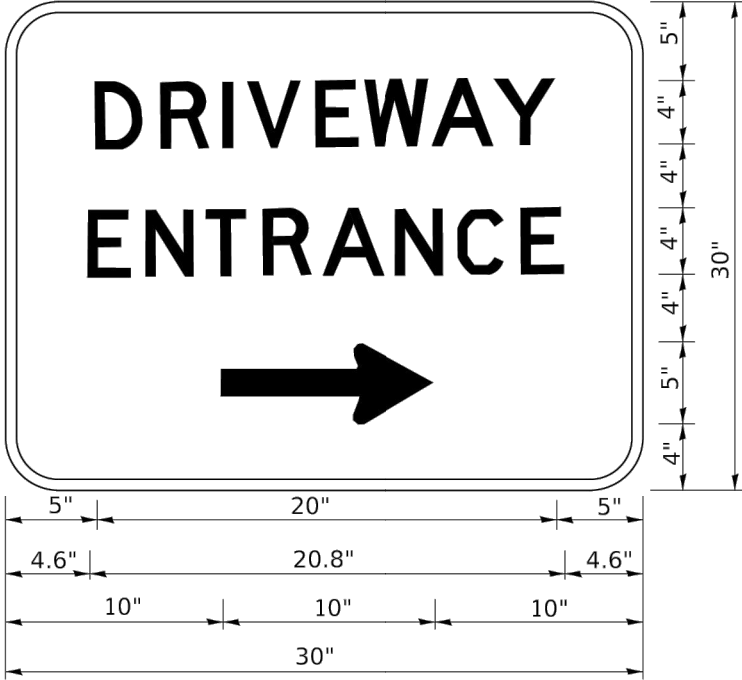

3.0" RADIUS, 0.5" BORDER, WHITE ON GREEN; REFLECTORIZED
"DRIVEWAY" D; "ENTRANCE" D; STANDARD ARROW CUSTOM 12.0" x 5.0"

- NOTES:
- 1. HALF OF THE SIGNS WILL REQUIRE A LEFT HAND FACING ARROW.
 - 2. TWO SIGNS SHALL BE USED AT EACH COMMERCIAL ENTRANCE
PLACED BACK-TO-BACK: ONE WITH A RIGHT HAND ARROW (SHOWN)
SHALL BE PLACED ON THE NEAR RIGHT SIDE THE DRIVEWAY
AND ONE WITH A LEFT HAND ARROW SHALL BE PLACED ON THE
FAR LEFT SIDE OF THE DRIVEWAY.
 - 3. SIGNS TO BE PAID FOR AS ITEM "TEMPORARY INFORMATION SIGNING".