

STATE OF ILLINOIS
DEPARTMENT OF TRANSPORTATION

FAP RTE	SECTION	COUNTY	TOTAL SHEETS	SHEET NO.
IL 5	(7R-1)TS	ROCK ISLAND	6	1
		ILLINOIS	CONTRACT NO. 64S87	

INDEX OF SHEETS

- 1. COVER SHEET
- 2. UTILITIES
- 3. SUMMARY OF QUANTITIES
- 4. TRAFFIC SIGNAL PLAN SHEET
- 5. TRAFFIC SIGNAL CABLE PLANS
- 6. SIGN DETAILS

STANDARDS

701006-05	805001-01
701201-05	814001-03
701301-04	814006-03
701311-03	857001-01
701421-08	873001-02
701701-10	877011-10
701901-10	878001-11
720001-01	880006-01

PROPOSED
HIGHWAY PLANS

FAP ROUTE 300 (IL 5)
SECTION (7R-1)TS
PROJECT NHPP-QZNC(364)
TYPE of IMPROVEMENT
ROCK ISLAND COUNTY
C92-013-25

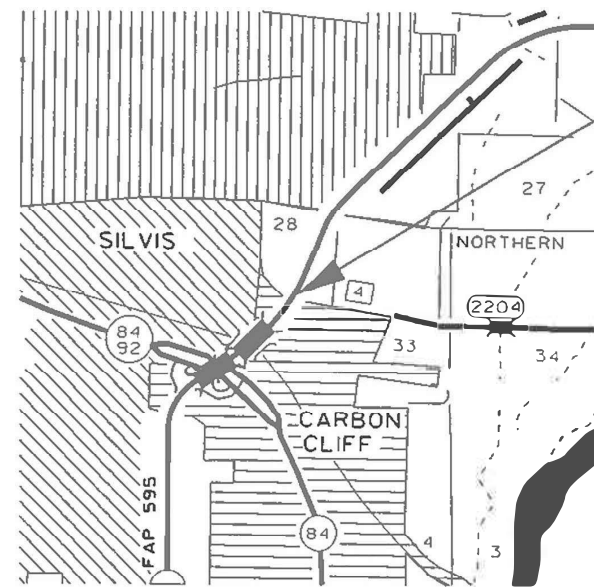

LOCATION OF PROJECT
IL 5 AT BARSTOW RD

HAMPTON TWP.
T18N, T1E, SECTION 28 & 33

J.U.L.I.E.
JOINT UTILITY LOCATION INFORMATION FOR EXCAVATION
1-800-892-0123
OR 811

PROJECT ENGINEER SCOTT KULLERTSTAND 815-284-5468
PROJECT MANAGER KRISTINE HILL

CONTRACT NO. 64S87

D92-039-24

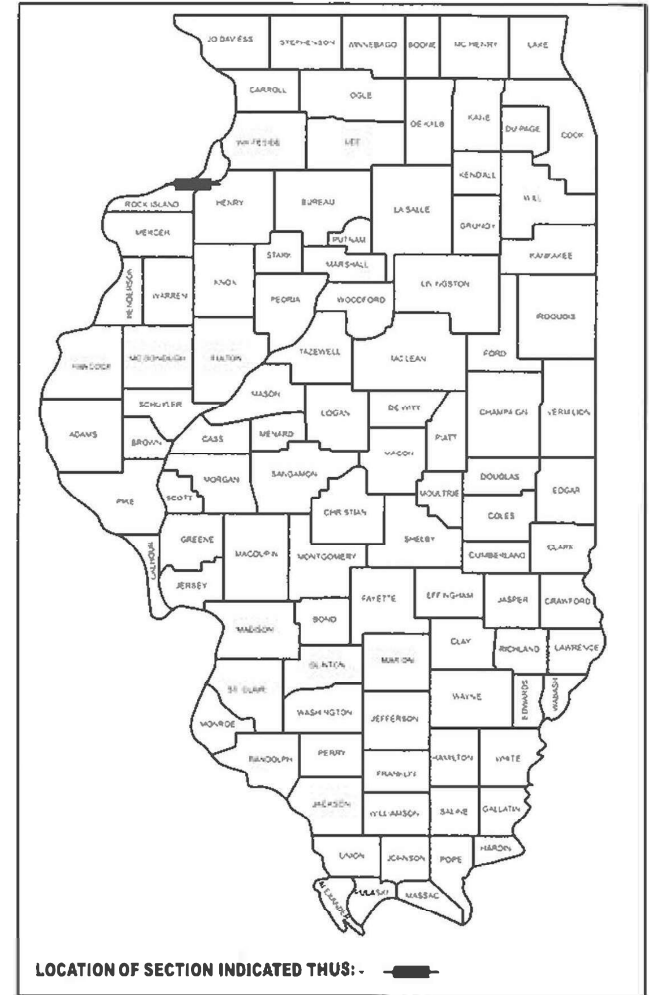

LOCATION OF SECTION INDICATED THUS: -

STATE OF ILLINOIS
DEPARTMENT OF TRANSPORTATION

SUBMITTED 12/4 2024
Tisha Thompson REGIONAL ENGINEER
January 31 2025
Scott Kullertstand ENGINEER OF DESIGN AND ENVIRONMENT
January 31 2025
Scott Kullertstand 5
DIRECTOR OF HIGHWAYS PROJECT IMPLEMENTATION

PRINTED BY THE AUTHORITY
OF THE STATE OF ILLINOIS

UTILITIES			
NAME AND ADDRESS	TYPE	TELEPHONE	
MR CHRIS DUNN GENESEO COMMUNICATIONS, INC. 111 E 1ST STREET GENESEO, IL 61254	TELEPHONE	309-714-2429	JULIE MEMBER? YES CALL: 800-892-0123
MR NATE TEAGER MID-AMERICAN ENERGY COMPANY 2811 5TH AVENUE ROCK ISLAND, IL 61201	ELECTRIC	536-333-8721	JULIE MEMBER? YES CALL: 800-892-0123
MR CHRISTOPHER MINARD MEDIACOM 3625 GARDEN PRAIRIE ROAD GARDEN PRAIRIE, IL 61038	CATV	815-716-0582	JULIE MEMBER? YES CALL: 800-892-0123
MR DEVEN BARNHILL VILLAGE OF CARBON CLIFF P.O. BOX 426/ 106 - 1ST AVENUE CARBON CLIFF, IL 61239	COMMUNICATIONS	815-715-2287	JULIE MEMBER? CALL:
MR NICK GOTTWALT WINDSTREAM 385 OAK STREET COAL CITY, IL 60416	WATER & SEWER	309-792-8297	JULIE MEMBER? YES CALL: 800-892-0123
MR HECTOR GARCIA AT & T 1000 COMMERCE DRIVE OAK BROOK, IL 60523	TELEPHONE/FO	630-573-5465	JULIE MEMBER? YES CALL: 800-892-0123

MODEL: SHT PLAN
FILE NAME: C:\Bentley\CONNECTION\11\Organization\Civil\DOT_Standards\Cell\DOT_Sheets.cel

USER NAME	• Eric.Thomas	DESIGNED	-	REVISED	-
		DRAWN	-	REVISED	-
		CHECKED	-	REVISED	-
PLOT DATE	• 12/7/2022	DATE	-	REVISED	-

STATE OF ILLINOIS
DEPARTMENT OF TRANSPORTATION

SCALE		SHEET	OF	SHEETS	STA	TO STA
-------	--	-------	----	--------	-----	--------

UTILITIES
TRAFFIC SIGNALS IL 5 AT BARSTOW RD

FAP RTE	SECTION	COUNTY	TOTAL SHEETS	SHEET NO
IL 5	(7R-1)TS	ROCK ISLAND		
CONTRACT NO. 64S87			ILLINOIS FED AID PROJECT	

PAY CODE	ITEM	UNIT	100% STATE
			QTY
25000300	SEEDING CLASS 3	ACRE	0.030
25000400	NITROGEN FERTILIZER NUTRIENT	POUND	40.6
25000600	POTASSIUM FERTILIZER NUTRIENT	POUND	33.1
25100630	EROSION CONTROL BLANKET	SQ YD	1402
69900530	SOIL DISPOSAL ANALYSIS	EACH	3
66901001	REGULATED SUBSTANCES PRE-CONSTRUCTION PLAN	L SUM	1
66901003	REGULATED SUBSTANCES FINAL CONSTRUCTION REPORT	L SUM	1
66901006	REGULATED SUBSTANCES MONITORING	CAL DA	9
66900200	NON-SPECIAL WASTE DISPOSAL	CU YD	14
67100100	MOBILIZATION	L SUM	1
70100450	TRAFFIC CONTROL AND PROTECTION, STANDARD 701201	L SUM	1
70100310	TRAFFIC CONTROL AND PROTECTION, STANDARD 701421	L SUM	1
70102635	TRAFFIC CONTROL AND PROTECTION, STANDARD 701701	L SUM	1
72000100	SIGN PANEL - TYPE 1	SQ FT	45.5
80500100	SERVICE INSTALLATION, TYPE A	EACH	1
81028360	UNDERGROUND CONDUIT, PVC, 2 1/2" DIA.	FOOT	54
81028390	UNDERGROUND CONDUIT, PVC, 4" DIA.	FOOT	4
81028740	UNDERGROUND CONDUIT, COILABLE NONMETALLIC CONDUIT, 1 1/2" DIA.	FOOT	28
81028760	UNDERGROUND CONDUIT, COILABLE NONMETALLIC CONDUIT, 2 1/2" DIA.	FOOT	63
81028790	UNDERGROUND CONDUIT, COILABLE NONMETALLIC CONDUIT, 4" DIA.	FOOT	372
81400700	HANDHOLE, PORTLAND CEMENT CONCRETE	EACH	4
81400720	DOUBLE HANDHOLE, PORTLAND CEMENT CONCRETE	EACH	1
81702110	ELECTRIC CABLE IN CONDUIT, 600V (XLP-TYPE USE) 1/C NO. 10	FOOT	1720
82110008	LUMINAIRE, LED, ROADWAY, OUTPUT DESIGNATION H	EACH	4
85000200	MAINTENANCE OF EXISTING TRAFFIC SIGNAL INSTALLATION	EACH	1
85700200	FULL-ACTUATED CONTROLLER AND TYPE IV CABINET	EACH	1

PAY CODE	ITEM	UNIT	100% STATE
			QTY
87301815	ELECTRIC CABLE IN CONDUIT, SERVICE NO. 6 3C	FOOT	36
87301245	ELECTRIC CABLE IN CONDUIT, SIGNAL NO 14 5C	FOOT	1727
87301255	ELECTRIC CABLE IN CONDUIT, SIGNAL NO 14 7C	FOOT	1231
87301900	ELECTRIC CABLE IN CONDUIT, GROUND NO 6 1C (GREEN)	FOOT	519
87500900	TRAFFIC SIGNAL POST, 13 FT	EACH	2
87702840	STEEL COMBINATION MAST ARM ASSEMBLY AND POLE 22 FT	EACH	1
87702900	STEEL COMBINATION MAST ARM ASSEMBLY AND POLE 34 FT	EACH	1
87702940	STEEL COMBINATION MAST ARM ASSEMBLY AND POLE 42 FT	EACH	1
87702960	STEEL COMBINATION MAST ARM ASSEMBLY AND POLE 46 FT	EACH	1
87800100	CONCRETE FOUNDATION, TYPE A	FOOT	6
87800200	CONCRETE FOUNDATION, TYPE D	FOOT	3
87800400	CONCRETE FOUNDATION, TYPE E DIA., 30 IN CH DIAMETER	FOOT	23.5
87800415	CONCRETE FOUNDATION, TYPE E DIA., 36 IN CH DIAMETER	FOOT	26
88040070	SIGNAL HEAD, POLYCARBONATE, LED, 1-FACE, 3-SECTION, BRACKET MOUNTED	EACH	1
88040090	SIGNAL HEAD, POLYCARBONATE, LED, 1-FACE, 3-SECTION, MAST ARM MOUNTED	EACH	8
88040110	SIGNAL HEAD, POLYCARBONATE, LED, 1-FACE, 4-SECTION, BRACKET MOUNTED	EACH	2
88040120	SIGNAL HEAD, POLYCARBONATE, LED, 1-FACE, 4-SECTION, MAST ARM MOUNTED	EACH	2
88040150	SIGNAL HEAD, POLYCARBONATE, LED, 1-FACE, 5-SECTION, BRACKET MOUNTED	EACH	2
88200100	TRAFFIC SIGNAL BACKPLATE	EACH	10
89502375	REMOVE EXISTING TRAFFIC SIGNAL EQUIPMENT	EACH	1
89502380	REMOVE EXISTING HANDHOLE	EACH	4
89502385	REMOVE EXISTING CONCRETE FOUNDATION	EACH	5
X4402810	ISLAND SURFACE REMOVAL AND REPLACEMENT	SQ FT	10
X8950105	REMOVE EXISTING TRAFFIC CONTROLLER CABINET	EACH	1
X8891001	VIDEO VEHICLE DETECTION SYSTEM	EACH	1

0021

MODEL_SHT_PLAN
FILE NAME C:\Bentley\CONNECT101\Organization-Civil\DOT_Standards\Cen\DOT_Sheets.cel

USER NAME	DESIGNED	REVISED
Eric Thomas	-	-
DRAWN	CHECKED	REVISED
-	-	-
PLOT DATE	DATE	REVISED
12/7/2022	-	-

**STATE OF ILLINOIS
DEPARTMENT OF TRANSPORTATION**

**UTILITIES
TRAFFIC SIGNALS IL 5 AT BARSTOW RD**

SCALE SHEET OF SHEETS STA TO STA

F A P R T E	SECTION	COUNTY	TOTAL SHEETS	SHEET NO
4.5	(7R-1)TS	ROCK ISLAND		
CONTRACT NO. 64S87			ILLINOIS FED AID PROJECT	

LEGEND

- EXISTING CONTROLLER
 - NEW CONTROLLER
 - EXISTING STEEL MAST ARM ASSEMBLY AND POLE
 - NEW STEEL MAST ARM ASSEMBLY AND POLE
 - EXISTING SIGNAL HEAD AND POST
 - NEW SIGNAL HEAD AND POST
 - EXISTING SIGNAL HEAD
 - NEW SIGNAL HEAD WITH BACKPLATE
 - EXISTING HANDHOLE
 - NEW HANDHOLE
 - NEW DOUBLE HANDHOLE
 - NEW LUMINAIRE
 - NEW CNC OR PVC CONDUIT
- UPPER NUMERAL INDICATES LENGTH
 LOW NUMERAL INDICATES SIZE AND TYPE
 "PVC" INDICATES UNDERGROUND CONDUIT, PVC
 "CNC" INDICATES UNDERGROUND, COILABLE NONMETALLIC CONDUIT

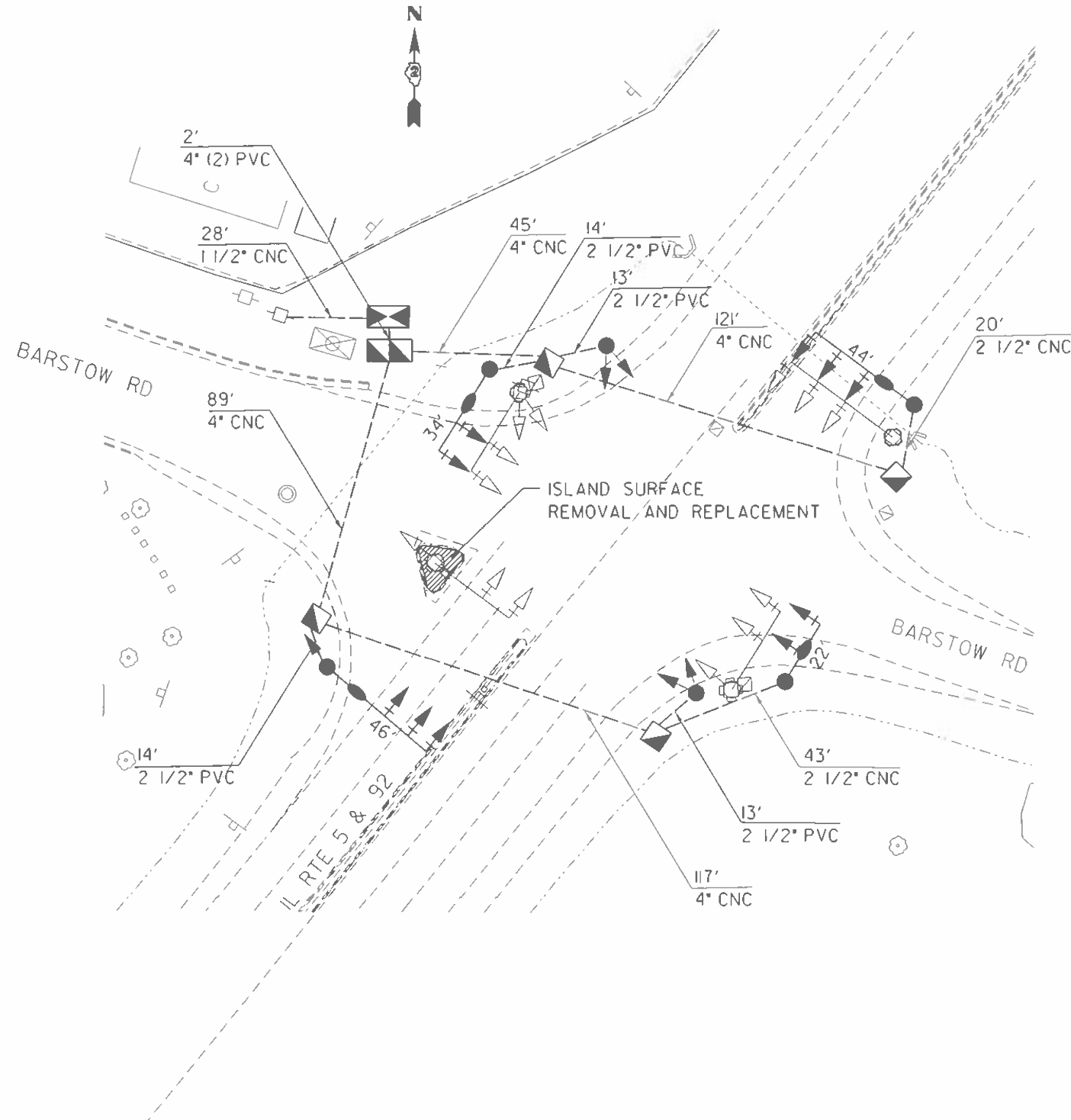

NOTE:
LUMINAIRE MOUNTING HEIGHT 35'
ON A 12' ARM.

MAST ARM FOUNDATIONS		
MAST ARM LENGTH	DIAMETER	DEPTH
22'	30"	10'
34'	30"	13'6"
42'	36"	13'
46'	36"	13'

REMOVAL NOTE:

- 89502375 REMOVE EXISTING TRAFFIC SIGNAL EQUIPMENT
 - 4 - COMBINATION MAST ARM ASSEMBLIES
 - 8 - 3 SECTION MAST ARM MOUNTED SIGNAL HEADS
 - 1 - 5 SECTION MAST ARM MOUNTED SIGNAL HEAD
 - 1 - 3 SECTION BRACKET MOUNTED SIGNAL HEAD
 - 2 - 5 SECTION BRACKET MOUNTED SIGNAL HEADS
 - 1 - BATTERY BACKUP SYSTEM
 - 5 - MAST ARM MOUNTED TYPE I SIGN PANELS
 - 4 - LIGHTING LUMINAIRES
- 89500120 REMOVE EXISTING SERVICE INSTALLATION IEACH
- 89502380 REMOVE EXISTING HANDHOLE 5 EACH
- 89502385 REMOVE EXISTING CONCRETE FOUNDATION 5 EACH
 - 1 TYPE C AND 4 TYPE E
- X8950105 REMOVE EXISTING TRAFFIC CONTROLLER CABINET IEACH

MODEL: SWT_PLAN
FILE NAME: C:\Bentley\CONNECT\1011\Organization-Civil\DOT_Standards\Civil\DOT_Sheets.cad

DESIGNED -	REVISOR -
DRAWN -	REVISION -
CHECKED -	REVISION -
DATE - 12/7/2022	REVISION -

**STATE OF ILLINOIS
DEPARTMENT OF TRANSPORTATION**

**TRAFFIC SIGNAL PLANS
IL 5 AT BARSTOW RD**

SCALE: SHEET OF SHEETS STA TO STA

FAP RTE	SECTION	COUNTY	TOTAL SHEETS	SHEET NO
IL 5	(7R-1)TS	ROCK ISLAND		
CONTRACT NO. 64S87				
ILLINOIS FED AID PROJECT				

PHASE DESIGNATION DIAGRAM

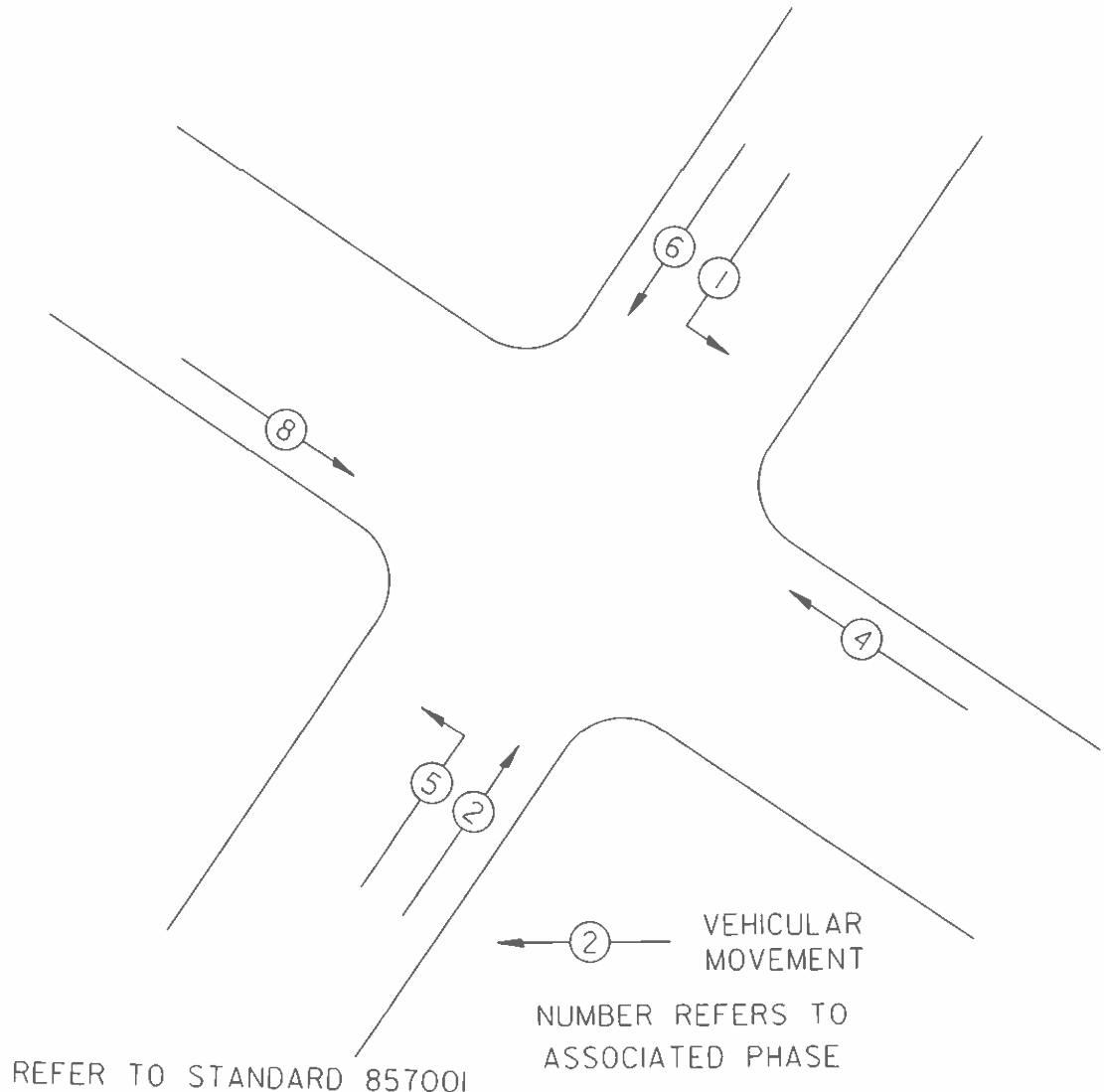

LEGEND

- ② INDICATES NUMBER OF NEW CONDUCTORS, ALL CABLE IS NO. 14 EXCEPT AS INDICATED.
- | |
|---|
| R |
| Y |
| G |

 NEW SIGNAL HEAD WITH OR WITHOUT BACKPLATE
- LUMINAIRE, DESIGNATION H
- ⊠ NEW CONTROLLER AND CABINET
- SERVICE INSTALLATION

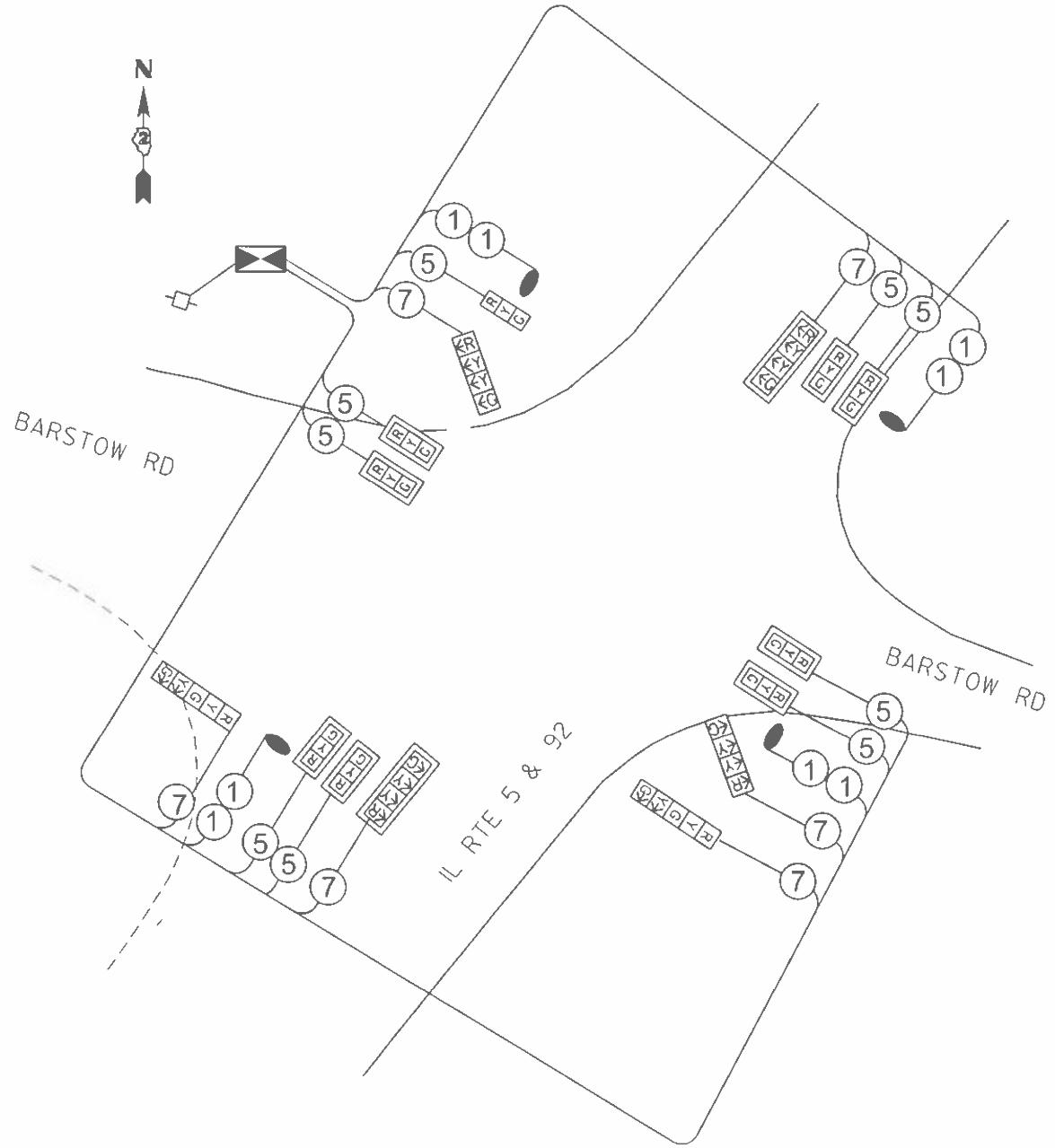

MODEL: SHT PLAN
FILE NAME: C:\Bentley\CONNECT101\Organization\Civil\DOT_Standards\Cat\DOT_Sheets.cel

USER NAME	• Eric Thomas	DESIGNED	-	REVISED	-
DRAWN	-	CHECKED	-	REVISED	-
PLOT DATE	• 12/7/2022	DATE	-	REVISED	-

**STATE OF ILLINOIS
DEPARTMENT OF TRANSPORTATION**

**TRAFFIC SIGNAL CABLE PLANS
IL 5 AT BARSTOW RD**

SCALE: SHEET OF SHEETS STA. TO STA.

FAP RTE	SECTION	COUNTY	TOTAL SHEETS	SHEET NO.
IL 5	(7R-1)TS	ROCK ISLAND		
CONTRACT NO. 64S87				
ILLINOIS FED AID PROJECT				



3.00" Radius, 1.00" Border, White on Green;
 "Barstow Rd", D;
 Table of widths and spaces

5.02	B		a		r		s		t		o		w
5.02	5.37	1.92	4.46	2.60	3.39	0.86	4.46	1.33	3.48	1.53	4.63	1.38	6.96
	R		d										
	8.00	5.37	1.76	4.46	5.02								



R10-1109
 30 X 30

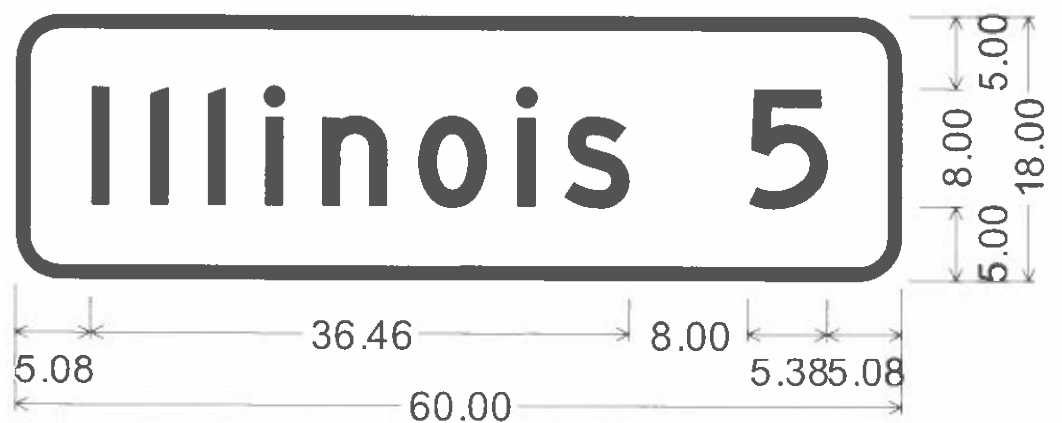

3.00" Radius, 1.00" Border, White on Green;
 "Illinois 5", D;
 Table of widths and spaces

5.08	l		l		l		i		n		o		i		s
5.08	1.25	2.76	1.25	2.61	1.25	2.61	1.25	2.60	4.46	2.09	4.63	2.09	1.25	1.90	4.46
		5													
	8.00	5.38	5.08												

MODEL: SHT PLAN
 FILE NAME: C:\Bentley\CONNECT\1011\Organization\Civil\DOT_Standards\Cert\DOT_Sheets.col

USER NAME	Eric Thomas	DESIGNED	-	REVISED	-	STATE OF ILLINOIS DEPARTMENT OF TRANSPORTATION	SIGN DETAILS IL 5 AT BARSTOW RD			FAP	SECTION	COUNTY	TOTAL	SHEETS	SHEET NO	
DRAWN	-	CHECKED	-	REVISED	-					RTE	IL 5	(R-1)TS	ROCK ISLAND			
PLOT DATE	12/7/2022	DATE	-	REVISED	-					SCALE	SHEET	OF	SHEETS	STA	TO STA	CONTRACT NO 64587
											ILLINOIS	FED AID PROJECT				