

STATE OF ILLINOIS  
DEPARTMENT OF TRANSPORTATION

RTE.	SECTION	COUNTY	TOTAL SHEETS	SHEET NO.
**	(13,14)RS-1	BUREAU	17	1
		ILLINOIS	CONTRACT NO. 66R29	

\*SBI 7C, FAS 1252 W

D-93-051-25

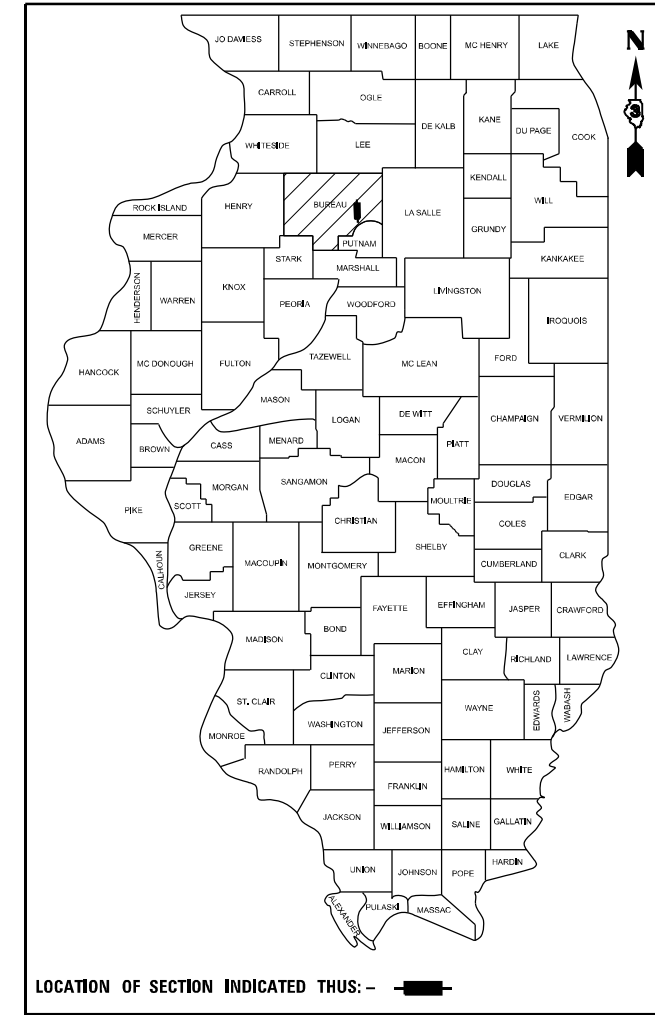

# PROPOSED HIGHWAY PLANS

**SBI 7C (2775E RD), FAS 1252W (2800E ST)  
SECTION (13,14)RS-1  
PROJECT STP-U0EU(552)  
MILLING & RESURFACING (DESIGN OVERLAY)  
BUREAU COUNTY**

INDEX OF SHEETS

- 1 COVER SHEET
- 2 GENERAL NOTES
- 3-4 LINE DIAGRAM
- 5-7 SUMMARY OF QUANTITIES
- 8-9 TYPICAL SECTIONS
- 10-11 SCHEDULES
- 12-17 DETAILS

LIST OF ILLINOIS DOT HIGHWAY STANDARDS

- 000001-08 STANDARD SYMBOLS, ABBREVIATIONS AND PATTERNS
- 001006 DECIMAL OF AN INCH AND OF A FOOT
- 406201-01 MAILBOX TURNOUT
- 442101-09 CLASS B PATCHES
- 635001-02 DELINEATORS
- 701006-05 OFF-ROAD OPERATIONS 2L, 2W, 15' TO 24" FROM PAVEMENT EDGE
- 701011-04 OFF-ROAD MOVING OPERATIONS 2L, 2W, DAY ONLY
- 701201-05 LANE CLOSURE, 2L, 2W, DAY ONLY, FOR SPEEDS ≥ 45 MPH
- 701206-05 LANE CLOSURE, 2L, 2W, NIGHT ONLY, FOR SPEEDS ≥ 45 MPH
- 701301-04 LANE CLOSURE, 2L, 2W, SHORT TIME OPERATIONS
- 701306-04 LANE CLOSURE, 2L, 2W, SLOW MOVING OPERATIONS DAY ONLY, FOR SPEEDS ≥ 45 MPH
- 701311-03 LANE CLOSURE, 2L, 2W, MOVING OPERATIONS DAY ONLY
- 701336-07 LANE CLOSURE, 2L, 2W, WORK AREAS IN SERIES, FOR SPEEDS ≥ 45 MPH
- 701901-10 TRAFFIC CONTROL DEVICES
- 725001-01 OBJECT AND TERMINAL MARKERS
- 728001-01 TELESCOPING STEEL SIGN SUPPORT
- 729001-01 APPLICATIONS OF TYPE A AND B METAL POSTS (FOR SIGNS & MARKERS)
- 781001-04 TYPICAL APPLICATIONS RAISED REFLECTIVE PAVEMENT MARKERS

C-93-076-25

PROJECT START  
STA 292 + 80

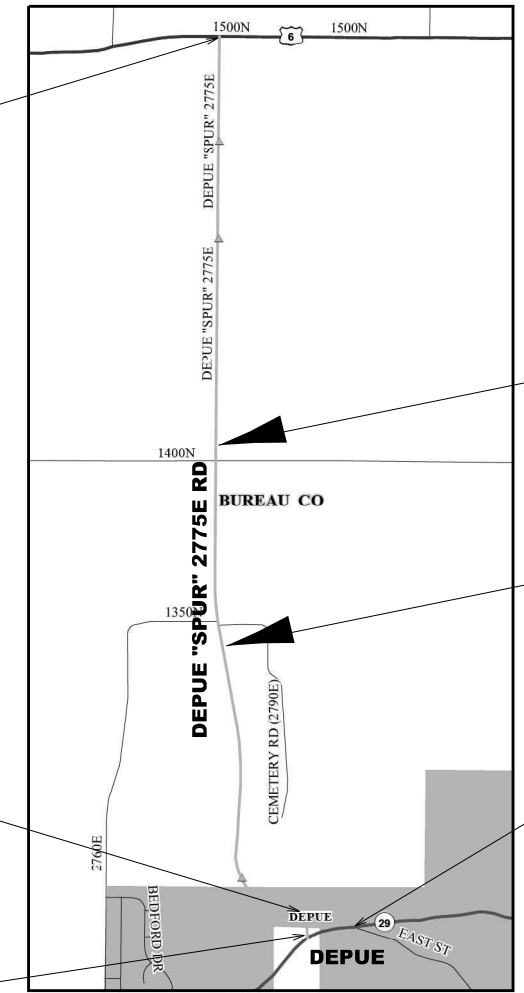

STA EQ:  
340 + 08.08 BK =  
340 + 04.08 AH

STA EQ:  
371 + 02.95 BK =  
371 + 00 AH

PROJECT END  
412 + 25

PROJECT START  
2800E ST

PROJECT END  
2800E ST

GROSS LENGTH = 12,237 FT. = 2.3 MILE  
NET LENGTH = 12,237 FT. = 2.3 MILE

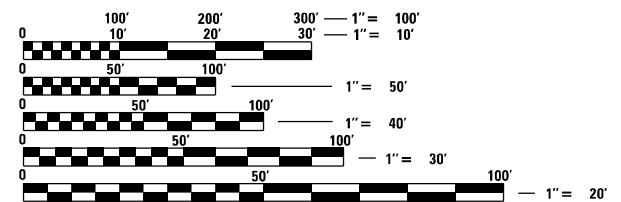

FULL SIZE PLANS HAVE BEEN PREPARED USING STANDARD ENGINEERING SCALES, REDUCED SIZED PLANS WILL NOT CONFORM TO STANDARD SCALES. IN MAKING MEASUREMENTS ON REDUCED PLANS, THE ABOVE SCALES MAY BE USED.

J.U.L.I.E.  
JOINT UTILITY LOCATION INFORMATION FOR EXCAVATION  
1-800-892-0123  
OR 811

PROJECT ENGINEER: JOSEPH KANNEL, P.E.  
UNIT CHIEF: MOHAMED YOUSIF  
DISTRICT 3 NO. (815) 434-6131  
CONTRACT NO. 66R29

FUNCTIONAL CLASSIFICATION

2775E RD  
MINOR COLLECTOR  
2023 ADT = 950  
PV=100% SU=0% MU=0%

STATE OF ILLINOIS  
DEPARTMENT OF TRANSPORTATION

SUBMITTED December 16, 2024

*Trisha Thompson* REGIONAL ENGINEER

January 31, 2025

*Scott A. [Signature]* ENGINEER OF DESIGN AND ENVIRONMENT

January 31, 2025

*[Signature]* DIRECTOR OF HIGHWAYS PROJECT IMPLEMENTATION

PRINTED BY THE AUTHORITY  
OF THE STATE OF ILLINOIS

**GENERAL NOTES**

THE HMA SURFACE OF ALL MAILBOX TURNOUTS, PRIVATE ENTRANCES, COMMERCIAL ENTRANCES, AND SIDE ROADS SHALL BE MADE NEATLY, IN A WORKMANLIKE MANNER, AND SHALL ACCURATELY CONFORM TO THE SHAPES AND DIMENSIONS SHOWN ON THE PLAN DETAILS. IF REQUIRED BY THE ENGINEER, THE CONTRACTOR SHALL SAW CUT THE HMA SURFACE TO CONFORM TO THE SHAPES AND DIMENSIONS SHOWN ON THE PLAN DETAILS. THIS WORK WILL BE INCLUDED IN THE COST OF THE HMA SURFACE.

EXCEPT AS NOTED ON THE PLANS, PAVEMENT GRADES SHOWN ARE AT THE TOP OF PAVEMENT SURFACES.

THE ENGINEER WILL BE THE SOLE JUDGE CONCERNING CURING TIME FOR THE VARIOUS HMA LIFTS.

THE FINISHED EARTHWORK SHALL HAVE A VEGETATION SUSTAINING SOIL COVERING THE TOP FOUR INCHES IN AREAS TO BE SEEDED OR SODDED. THE VEGETATION SUSTAINING SOIL REQUIRED WILL NOT BE PAID FOR SEPARATELY BUT WILL BE INCLUDED IN THE COST OF FURNISHED EXCAVATION (SPECIAL).

ALL EXCAVATED MATERIAL, WHICH INCLUDES DIGGING OR GRADING OF ANY SOIL OR FILL MATERIAL, WITH THE EXCEPTION OF AGGREGATE FILLS, MUST BE INCORPORATED WITHIN THE IDOT RIGHT OF WAY.

ON EXISTING PAVEMENT WHICH MAY BE SUPERELEVATED, THE NEW HMA PAVEMENT SHALL BE BUILT WITH THE SAME SUPERELEVATION UNLESS NEW SUPERELEVATION RATES ARE GIVEN ON THE PLANS.

ALL ELEVATIONS REFERRING TO U.S.G.S. MEAN SEA LEVEL DATUM.

ALL EXCAVATED MATERIAL SHALL REMAIN ON SITE.

THE FOLLOWING RATES OF APPLICATION HAVE BEEN USED IN CALCULATING PLAN QUANTITIES:

GRANULAR MATERIALS	2.05	TONS / CU YD
HMA RESURFACING	112	LBS / SQ YD / IN
SHORT TERM PAVEMENT MARKING	10	FT /100 FT OF APPLICATION
MIX FOR CRACKS, JTS & FLGWYS	0.0003	TONS / SQ YD
BINDER (HAND METHOD)	0.0005	TONS / SQ YD

ALL DAMAGE TO DEPARTMENT OWNED UNDERGROUND FACILITIES, CAUSED BY THE CONTRACTOR SHALL BE REPAIRED TO THE SATISFACTION OF THE ENGINEER AND AT NO EXPENSE TO THE DEPARTMENT. THIS SHALL INCLUDE ALL TEMPORARY REPAIRS REQUIRED TO KEEP THE FACILITY OPERATIONAL WHILE MATERIAL IS BEING OBTAINED TO MAKE PERMANENT REPAIRS. SPLICING OF ELECTRIC CABLE WILL NOT BE ALLOWED. ELECTRIC CABLE SHALL BE REPLACED FROM POLE TO POLE OR CONTROLLER.

THE CONTRACTOR SHALL CONTACT JULIE AT LEAST 48 HOURS PRIOR TO EXCAVATION TO DETERMINE WHICH UTILITIES ARE IN THE AREA.

**COMMITMENTS**

NONE

LOCATIONS:	ENTIRE PROJECT	ENTIRE PROJECT	ENTIRE PROJECT
MIXTURE USE(S):	HMA	HMA	HMA
	BINDER	SURFACE	INCIDENTAL
BINDER GRADE (PG):	PG 64-22	PG 64-22	PG 64-22
DESIGN AIR VOIDS:	4.0% @ N50	4.0% @ N50	4.0% @ N50
MIXTURE COMPOSITION: (MIXTURE GRADATION)	IL 19.0	IL 9.5	IL 9.5
FRICTION AGGREGATE:		MIXTURE C	MIXTURE C
MIXTURE WEIGHT:	112.0 LB/SY/IN	112.0 LB/SY/IN	112.0 LB/SY/IN
QUALITY MANAGEMENT PROGRAM:	QCP	QCP	QCQA
SUBLOT SIZE:	1000 TONS	1000 TONS	NA
DENSITY TEST METHOD:	CORES	CORES	SATISFACTION OF ENGINEER
MATERIAL TRANSFER DEVICE (REQUIRED):	YES	YES	NO

STATE OF ILLINOIS  
DEPARTMENT OF TRANSPORTATION  
DISTRICT THREE  
AS BUILT INFORMATION

\_\_\_\_\_  
SUPERVISING CONSTRUCTION FIELD ENGINEER

\_\_\_\_\_  
RESIDENT ENGINEER / TECHNICIAN

START & END DATES  
OF CONSTRUCTION:

INSPECTORS:

\_\_\_\_\_

\_\_\_\_\_

\_\_\_\_\_

MODEL: Default  
FILE NAME: c:\pwworking\infon\alascocj\1046113\0368629-shr-cover.dgn

USER NAME = Cassandra.Nolasco	DESIGNED -	REVISED -	<b>STATE OF ILLINOIS DEPARTMENT OF TRANSPORTATION</b>	<b>GENERAL NOTES</b>				RTE.	SECTION	COUNTY	TOTAL SHEETS	SHEET NO.
	DRAWN -	REVISED -							(13,14)RS-1	BUREAU	17	2
	CHECKED -	REVISED -		CONTRACT NO. 66R29								
PLOT DATE = 12/5/2024	DATE -	REVISED -		SCALE:	SHEET	OF	SHEETS	STA.	TO	STA.	ILLINOIS FED. AID PROJECT	

EX CURVE  
 PI STA = 363+37.39  
 $\Delta = 11^\circ 11' 54''$  (LT)  
 $D = 01^\circ 59' 59''$   
 $R = 2,865.21'$   
 $T = 280.90'$   
 $L = 560.00'$   
 $E = 13.74'$   
 $e =$   
 PC STA = 360+56.50  
 PT STA = 366+16.50

EX CURVE  
 PI STA = 382+24.73  
 $\Delta = 15^\circ 15' 46''$  (RT)  
 $D = 02^\circ 00' 42''$   
 $R = 2,848.14'$   
 $T = 381.61'$   
 $L = 758.70'$   
 $E = 25.45'$   
 $e =$   
 PC STA = 378+43.12  
 PT STA = 386+01.82

EX CURVE  
 PI STA = 398+75.69  
 $\Delta = 76^\circ 34' 24''$  (LT)  
 $D = 09^\circ 48' 13''$   
 $R = 584.44'$   
 $T = 461.34'$   
 $L = 781.08'$   
 $E = 160.15'$   
 $e =$   
 PC STA = 394+14.35  
 PT STA = 401+95.43

EX CURVE  
 PI STA = 412+82.31  
 $\Delta = 23^\circ 52' 08''$  (LT)  
 $D = 06^\circ 21' 58''$   
 $R = 900.00'$   
 $T = 190.22'$   
 $L = 374.93'$   
 $E = 19.88'$   
 $e =$   
 PC STA = 410+92.08  
 PT STA = 414+67.01

MODEL: D:\h111...  
 FILE NAME: ...  
 PROJECT: ...  
 USER: ...

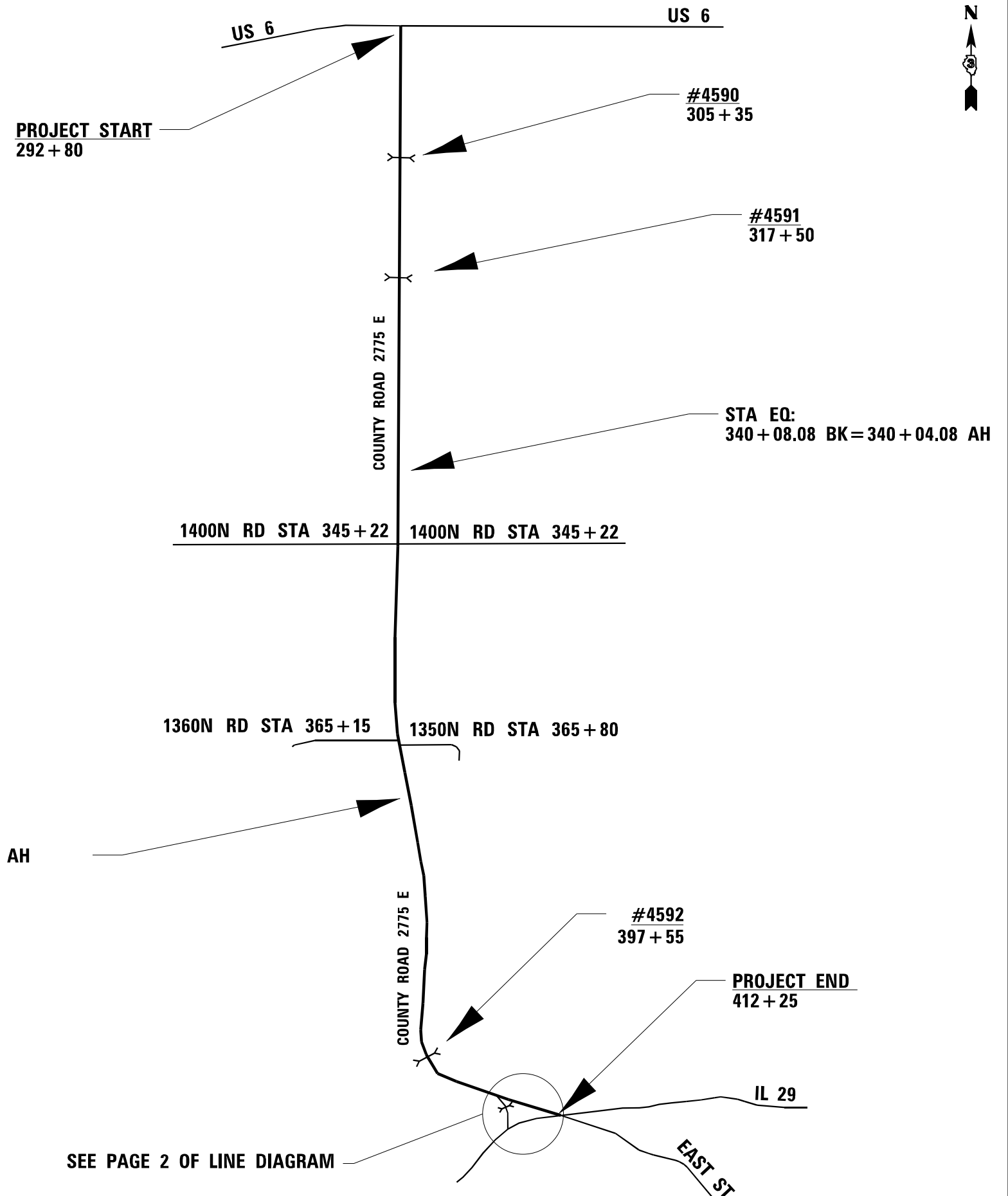

SEE PAGE 2 OF LINE DIAGRAM

USER NAME = Cassandra.Nicisco PLOT SCALE = \$SCALE\$ PLOT DATE = 12/11/2024	DESIGNED - DRAWN -	REVISED - REVISED -	<b>STATE OF ILLINOIS</b> <b>DEPARTMENT OF TRANSPORTATION</b>	<b>LINE DIAGRAM</b>		RTE. *	SECTION (13,14)RS-1	COUNTY BUREAU	TOTAL SHEETS 17	SHEET NO. 3
	CHECKED - DATE -	REVISED - REVISED -				SCALE:	SHEET OF SHEETS STA. TO STA.	ILLINOIS FED. AID PROJECT CONTRACT NO. 66R29		

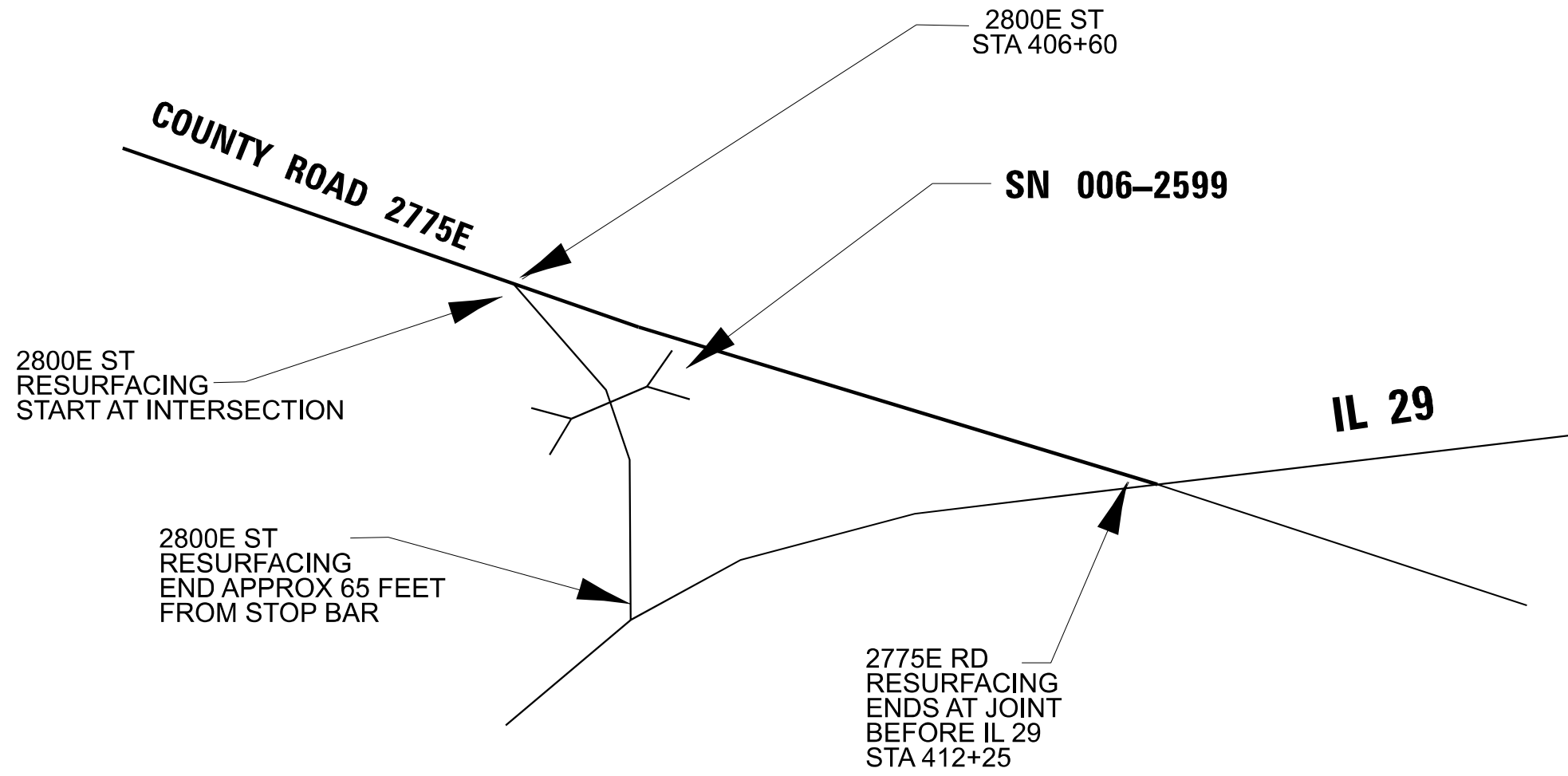
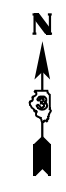

MODEL: D:\data\...  
 FILE NAME: ...

USER NAME = Cassandra.Nolesco	DESIGNED -	REVISED -
	DRAWN -	REVISED -
PLOT SCALE = \$\$SCALE\$	CHECKED -	REVISED -
PLOT DATE = 12/11/2024	DATE -	REVISED -

**STATE OF ILLINOIS**  
**DEPARTMENT OF TRANSPORTATION**

SCALE:		LINE DIAGRAM	
		SHEET OF SHEETS	STA. TO STA.

RTE.	SECTION	COUNTY	TOTAL SHEETS	SHEET NO.
*	(13,14)RS-1	BUREAU	17	4
CONTRACT NO. 66R29				
ILLINOIS		FED. AID PROJECT		

\*SBI 7C, FAS 1252 W

80% FED  
20% STATE  
CONSTR. CODE  
STP-RUR

CODE NO.	ITEM	UNIT	TOTAL QUANTITY	ROADWAY
				0005 RURAL
40200800	AGGREGATE SURFACE COURSE, TYPE B	TON	4	4
40600290	BITUMINOUS MATERIALS (TACK COAT)	POUND	23748	23748
40600370	LONGITUDINAL JOINT SEALANT	FOOT	17447	17447
40600400	MIXTURE FOR CRACKS, JOINTS, AND FLANGEWAYS	TON	10	10
40600405	MATERIAL TRANSFER DEVICE	TON	7214	7214
40600900	HOT-MIX ASPHALT BINDER COURSE (HAND METHOD), N50	TON	17	17
40600990	TEMPORARY RAMP	SQ YD	174	174
40603080	HOT-MIX ASPHALT BINDER COURSE, IL-19.0, N50	TON	4329	4329
40604050	HOT-MIX ASPHALT SURFACE COURSE, IL-9.5, MIX "C", N50	TON	2885	2885
40800050	INCIDENTAL HOT-MIX ASPHALT SURFACING	TON	189	189
44000164	HOT-MIX ASPHALT SURFACE REMOVAL, 3 3/4"	SQ YD	34354	34354
44201019	CLASS B PATCHES, TYPE II, 14 INCH	SQ YD	73	73
44201023	CLASS B PATCHES, TYPE III, 14 INCH	SQ YD	36	36
44201298	DOWEL BARS 1 1/4"	EACH	224	224

MODEL: Default  
FILE NAME: c:\p\work\pww\final\ascc\01046113\368629-shr-SOC.dgn

USER NAME = Cassandra.Nolasco	DESIGNED -	REVISED -
	DRAWN -	REVISED -
	CHECKED -	REVISED -
PLOT DATE = 12/5/2024	DATE -	REVISED -

**STATE OF ILLINOIS  
DEPARTMENT OF TRANSPORTATION**

**SUMMARY OF QUANTITIES**

SCALE: SHEET OF SHEETS STA. TO STA.

RTE.	SECTION	COUNTY	TOTAL SHEETS	SHEET NO.
*	(13,14)RS-1	BUREAU	17	5
CONTRACT NO. 66R29				
ILLINOIS FED. AID PROJECT				

80% FED  
20% STATE

CONSTR. CODE

STP-RUR

CODE NO.	ITEM	UNIT	TOTAL QUANTITY	ROADWAY
				0005 RURAL
44213200	SAW CUTS	FOOT	544	544
48102100	AGGREGATE WEDGE SHOULDER, TYPE B	TON	699	699
63500105	DELINEATORS	EACH	8	8
67000400	ENGINEER'S FIELD OFFICE, TYPE A	CAL MO	3	3
67100100	MOBILIZATION	L SUM	1	1
70100450	TRAFFIC CONTROL AND PROTECTION, STANDARD 701201	L SUM	1	1
70100460	TRAFFIC CONTROL AND PROTECTION, STANDARD 701306	L SUM	1	1
70100600	TRAFFIC CONTROL AND PROTECTION, STANDARD 701336	L SUM	1	1
70300100	SHORT TERM PAVEMENT MARKING	FOOT	1224	1224
70300150	SHORT TERM PAVEMENT MARKING REMOVAL	SQ FT	408	408
* 72501000	TERMINAL MARKER - DIRECT APPLIED	EACH	20	20
* 78004720	PREFORMED PLASTIC PAVEMENT MARKING, TYPE D - STANDARD - LINE 24"	FOOT	60	60
* 78009004	MODIFIED URETHANE PAVEMENT MARKING - LINE 4"	FOOT	81364	81364
* 78009006	MODIFIED URETHANE PAVEMENT MARKING - LINE 6"	FOOT	2486	2486

\*= SPECIALTY ITEM

MODEL: Default  
FILE NAME: c:\p\work\pav\dot\mohamed.yousif\illinois.gov\1046113\0366R22-shr-SOO.dgn

USER NAME = Mohamed.Yousif	DESIGNED -	REVISED -
	DRAWN -	REVISED -
	CHECKED -	REVISED -
PLOT DATE = 1/2/2025	DATE -	REVISED -

STATE OF ILLINOIS  
DEPARTMENT OF TRANSPORTATION

SUMMARY OF QUANTITIES

SCALE: SHEET OF SHEETS STA. TO STA.

RT.	SECTION	COUNTY	TOTAL SHEETS	SHEET NO.
*	(13,14)RS-1	BUREAU	17	6
CONTRACT NO. 66R29				
ILLINOIS FED. AID PROJECT				

80% FED  
20% STATE

CONSTR. CODE

STP-RUR

ROADWAY

0005

RURAL

CODE NO.	ITEM	UNIT	TOTAL QUANTITY	ROADWAY	
				0005	RURAL
* 78011125	GROOVING FOR RECESSED PAVEMENT MARKING 25"	FOOT	60	60	
* 78100100	RAISED REFLECTIVE PAVEMENT MARKER	EACH	153	153	
* 78200005	GUARDRAIL REFLECTORS, TYPE A	EACH	42	42	
78300200	RAISED REFLECTIVE PAVEMENT MARKER REMOVAL	EACH	153	153	
X2040805	FURNISHED EXCAVATION (SPECIAL)	CU YD	20	20	
X4401198	HOT-MIX ASPHALT SURFACE REMOVAL, VARIABLE DEPTH	SQ YD	1231	1231	
X6350204	LINEAR DELINEATOR PANELS, 4 INCH	EACH	42	42	
X6350206	LINEAR DELINEATOR PANELS, 6 INCH	EACH	6	6	
Z0030850	TEMPORARY INFORMATION SIGNING	SQ FT	42	42	

\*= SPECIALTY ITEM

MODEL: Default  
FILE NAME: c:\pwwork\pwwork\mohamed.yousif@illinois.gov\1046113\0368629-stp-SOC.dgn

USER NAME = Mohamed.Yousif	DESIGNED -	REVISED -
	DRAWN -	REVISED -
	CHECKED -	REVISED -
PLOT DATE = 1/2/2025	DATE -	REVISED -

STATE OF ILLINOIS  
DEPARTMENT OF TRANSPORTATION

SUMMARY OF QUANTITIES

SCALE: SHEET OF SHEETS STA. TO STA.

RTE.	SECTION	COUNTY	TOTAL SHEETS	SHEET NO.
*	(13,14)RS-1	BUREAU	17	7
CONTRACT NO. 66R29				
ILLINOIS FED. AID PROJECT				

\* SBI 70 REV. 1/21/25 REV. 1/6/24

**\*LONGITUDINAL JOINT SEALANT**  
**LONGITUDINAL JOINT SEALANT IS PLACED**  
**ON THE TOP OF THE BINDER COURSE**  
**JOINTS/UNDERNEATH THE SURFACE COURSE,**  
**FINAL LOCATION OF LONGITUDINAL JOINT**  
**SEALANT TO BE DETERMINED BY THE ENGINEER.**

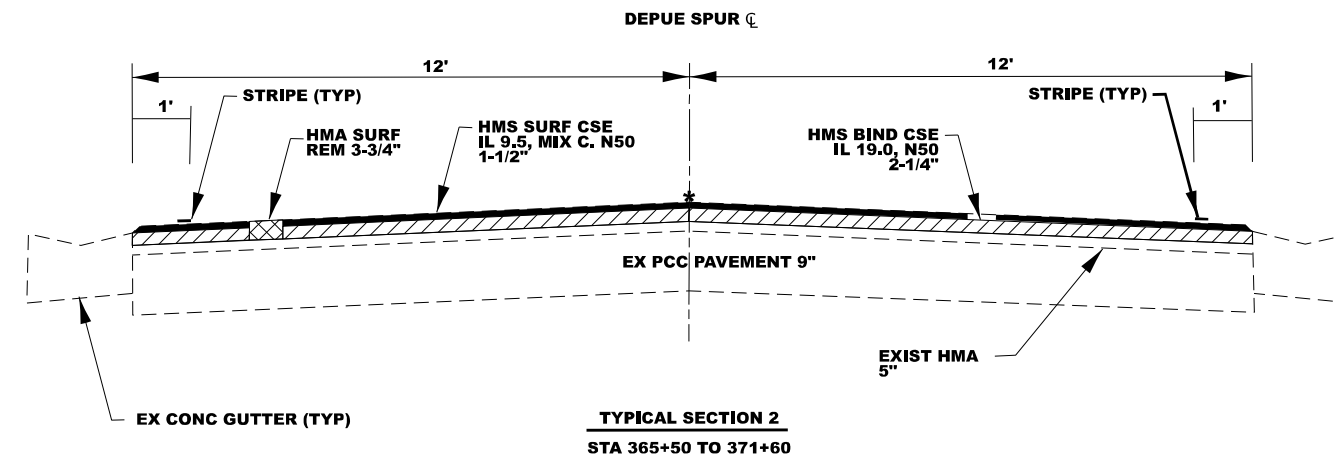
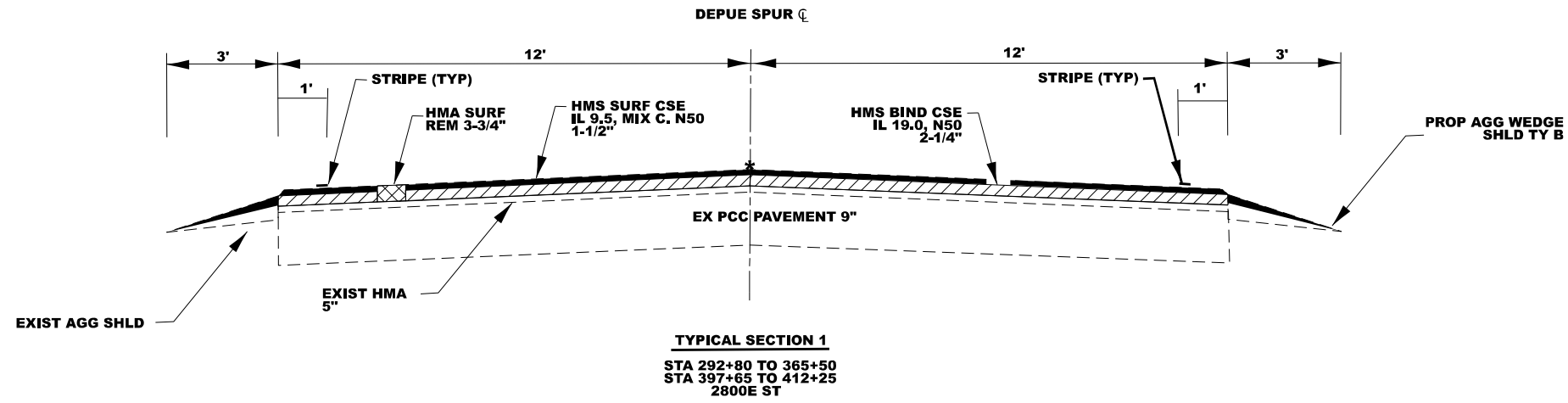

MODEL: Default  
 FILE NAME: c:\p\work\pav\hinalasco\01046113\368629-shl-typical\_sections.dgn

USER NAME = Cassandra.Nolasco	DESIGNED -	REVISED -
	DRAWN -	REVISED -
	CHECKED -	REVISED -
PLOT DATE = 12/5/2024	DATE -	REVISED -

**STATE OF ILLINOIS**  
**DEPARTMENT OF TRANSPORTATION**

**TYPICAL SECTIONS**

SCALE: SHEET OF SHEETS STA. TO STA.

RTE.	SECTION	COUNTY	TOTAL SHEETS	SHEET NO.
*	(13,14)RS-1	BUREAU	17	8
CONTRACT NO. 66R29				
ILLINOIS FED. AID PROJECT				

\* SBI 7C, FAS 1252 W



**\* LONGITUDINAL JOINT SEALANT**  
**LONGITUDINAL JOINT SEALANT IS PLACED**  
**ON THE TOP OF THE BINDER COURSE**  
**JOINTS/UNDERNEATH THE SURFACE COURSE,**  
**FINAL LOCATION OF LONGITUDINAL JOINT**  
**SEALANT TO BE DETERMINED BY THE ENGINEER.**

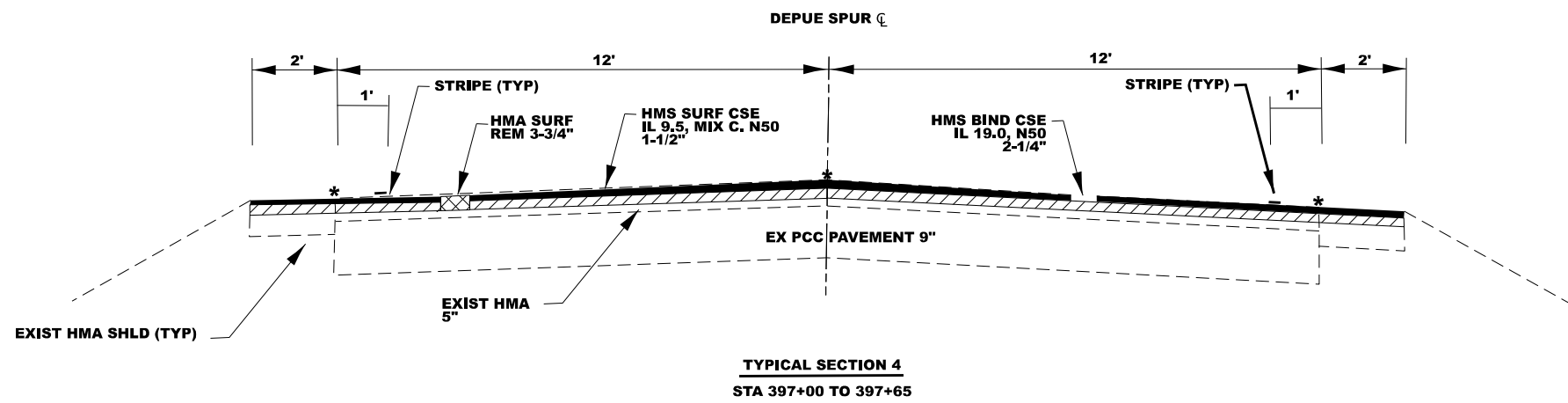
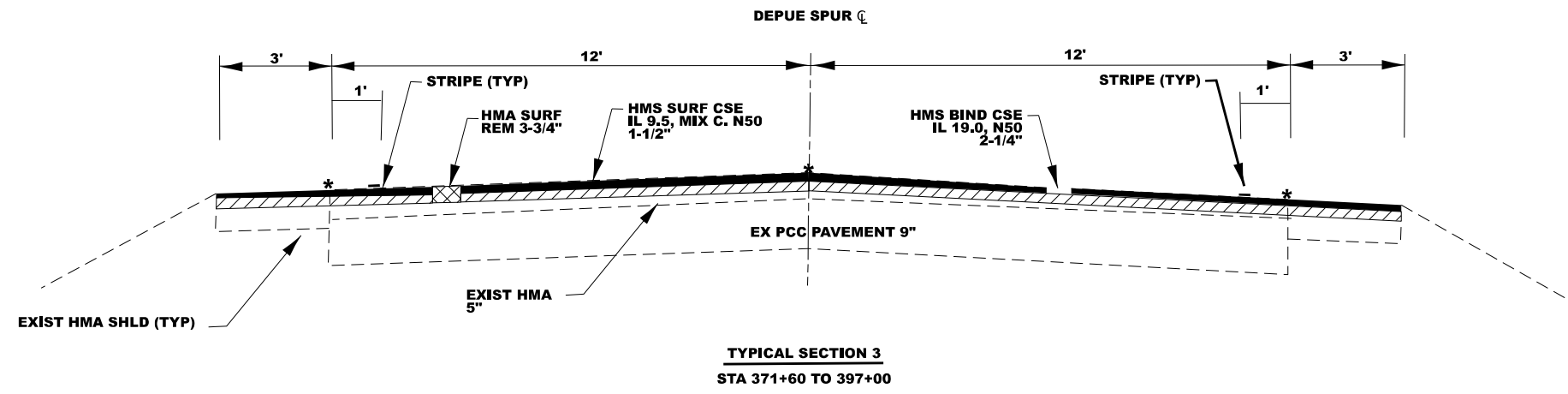

MODEL: Default  
 FILE NAME: c:\p\work\pav\hinalasco\1046113\368629-sh-typical\_sections.dgn

USER NAME = Cassandra.Nolasco	DESIGNED -	REVISED -
	DRAWN -	REVISED -
	CHECKED -	REVISED -
PLOT DATE = 12/5/2024	DATE -	REVISED -

**STATE OF ILLINOIS**  
**DEPARTMENT OF TRANSPORTATION**

**TYPICAL SECTIONS**

SCALE: SHEET OF SHEETS STA. TO STA.

RTE.	SECTION	COUNTY	TOTAL SHEETS	SHEET NO.
*	(13,14)RS-1	BUREAU	17	9
CONTRACT NO. 66R29				
ILLINOIS FED. AID PROJECT				

MAINLINE SCHEDULE													
LOCATION	LENGTH	HMA MAIN LINE	HMA SURF REM 3-3/4"	HMA BIND CSE IL-19.0, N50 (2-1/4")	HMA SURF CSE IL 9.5 MIX C, N50 (1-1/2")	HMA BINDER CSE (HM) N50	LONG JOINT SEAL	AGG WEDGE SHLD TY B	TEMP RAMP	BIT MATL (TACK COAT)	MIXTURE CRACKS JTS & FLANGEWYS	MATL TRANS DEVICE	
STATION	FOOT	WIDTH	SQ YD	TON	TON	TON	FOOT	TON	SQ YD	POUND	TON	TON	
292+80 TO 365+50	7270	24	19387	2443.0	1629.0	9.7	7270	563.0	33	13086	5.8	4072	
365+50 TO 371+60	610	24	1627	205.0	137.0	0.8	610	0.0	66	1098	0.5	342	
371+60 TO 397+00	2540	30	8467	1067.0	711.0	4.2	7620	0.0	42	5715	2.5	1778	
397+00 TO 397+65	65	28	202	25.0	17.0	0.1	195	0.0	39	137	0.1	42	
397+65 TO 412+25	1460	24	3893	491.0	327.0	1.9	1460	113.1	33	2628	1.2	818	
2800E ST	285	24	760	96.0	64.0	0.4	285	22.1	33	513	0.2	160	
TOTAL	12230		34336	4327	2885	17	17440	698	246	23177	10	7212	

SIDE ROAD AND ENTRANCE SCHEDULE													
LOCATION	SIDE	TYPE	MAT'L	WIDTH	LENGTH	AREA	FURNISHED EXCAVATION (SP)	AGG SURF CSE, TYPE B	BITUMINOUS MATERIALS (TACK COAT)	INCIDENTAL HMA SURFACING	HMA SURF REMOVAL VARIABLE DEPTH	TEMP RAMP	
				FT	FT	SQ YD	CU YD	TON	POUND	TON	SQ YD	SQ YD	
STA 298+20	EAST	FE	AGG	15	3	5		0.6					
STA 298+30	WEST	FE	AGG	15	3	5		0.6					
STA 310+42	WEST	FE	AGG	25	3	8		1					
STA 313+30	WEST	FE	AGG	20	3	7		0.8					
STA 313+90	EAST	FE	AGG	14	3	5		0.5					
STA 319+37	WEST	PE	HMA	30	10	33			15	5	33		
STA 320+00	WEST	MBTO	HMA	72	10	80			36	12	80		
STA 321+75	EAST	FE	AGG	20	3	7		0.8					
STA 321+85	WEST	PE	HMA	20	10	22			10	3	22		
STA 331+60	WEST	MBTO	HMA	72	10	80			36	12	80		
STA 332+00	WEST	PE	HMA	50	10	56			25	9	56		
STA 345+22	EAST	1400 N RD	HMA	51	30	170	5.0		77	26	170	28	
STA 345+22	WEST	1400 N RD	HMA	48.5	30	162	5.0		73	25	162	27	
STA 351+00	EAST	PE	HMA	40	10	44			20	7	44		
STA 365+15	WEST	1360 N	HMA	53.5	30	178	5.0		80	27	178	30	
STA 365+80	EAST	1350 N	HMA	40.5	30	135	5.0		61	21	135	23	
STA 403+00	NORTH	PE	HMA	30	10	33			15	5	33		
STA 403+90	NORTH	PE	HMA	35	10	39			18	6	39		
STA 405+25	NORTH	PE	HMA	30	10	33			15	5	33		
STA 405+90	NORTH	PE	HMA	40	10	44			20	7	44		
STA 406+80	NORTH	PE	HMA	35	10	39			18	6	39		
STA 407+80	NORTH	PE	HMA	40	10	44			20	7	44		
STA 408+90	NORTH	PE	HMA	35	10	39			18	6	39		
TOTAL							20	4	557	189	1231	108	

PLACE FURNISHED EXCAVATION (SPECIAL) AROUND SIDE ROAD RADII.  
THIS AREA TO BE SEEDED, FERTILIZED AND MULCHED - NOT PAID FOR SEPARATELY BUT INCLUDED IN THE COST OF FURN EX (SPECIAL).

DELINEATOR SCHEDULE				
STA	STR NO.	DELINEATORS	LINEAR DELINEATOR PANELS 4 IN	LINEAR DELINEATOR PANELS 6 IN
		EA	EA	EA
305+35	#4590	2	12	
317+50	#4591	2	8	
397+55	#4592	2	10	
2800 E ST	#4593	2	4	4
TOTAL		8	34	4

MODEL: Default  
FILE NAME: c:\pwworking\hinalascoj\1046113\368629-shr-schedule.dgn

USER NAME = Cassandra.Nolasco	DESIGNED -	REVISED -
	DRAWN -	REVISED -
	CHECKED -	REVISED -
PLOT DATE = 12/5/2024	DATE -	REVISED -

STATE OF ILLINOIS  
DEPARTMENT OF TRANSPORTATION

SCHEDULE OF QUANTITIES

SCALE: SHEET OF SHEETS STA. TO STA.

ROUTE	SECTION	COUNTY	TOTAL SHEETS	SHEET NO.
	(13,14)RS-1		17	10
CONTRACT NO. 66R29				
ILLINOIS FED. AID PROJECT				

PAVEMENT MARKING SCHEDULE										
LOCATION	COMMENT	LENGTH	MODIFIED URETHANE PM (2 APPLICATIONS)			PREFORMED PLASTIC PM, TYPE D, STD, LINE 24"	GROOVING FOR REC PM 25"	RAISED REF PM	RAISED REF PM	
			LINE 4"		LINE 6"					
STATION		FOOT	WHITE FOOT	YELLOW FOOT	YELLOW FOOT	WHITE FOOT	FOOT	EACH	EACH	
STA 292+80 TO STA 309+91	NO PASS	1711	6844	6844		12	12	21	21	
STA 309+91 TO STA 319+21	NB NO PASS	930	3720	1860	466			12	12	
STA 319+21 TO STA 352+13	PASS	3292	13168		1646			41	41	
STA 352+13 TO STA 359+57	SB NO PASS	744	2976	1488	372			9	9	
STA 359+57 TO STA 412+25	NO PASS	5268	21072	21072		12	12	66	66	
2800 E ST	NO PASS	285	1140	1140		24	24	4	4	
TOTALS		12230	81324		2484	48	48	153	153	

SHORT TERM PAVEMENT MARKINGS			
LOCATION	LENGTH	SHORT TERM PM	SHORT TERM PM REM
STATION	FOOT	FT	SQ FT
STA 292+80 TO STA 412+25	11945	1195	398
2800E ST	285	29	10
TOTALS	12230	1224	408

PATCHING SCHEDULE							
LOCATION	LANE	PATCH LENGTH	PATCH WIDTH	CLASS B PATCHES		DOWEL BARS 1-1/4"	SAW CUTS
				TYPE II 14 IN	TYPE III 14 IN		
STATION		FOOT	FOOT	SQ YD	SQ YD	EACH	FOOT
293+50	NORTH	6	12	8		20	48
	SOUTH	6	12	8		20	48
319+00	NORTH	12	12		16	20	60
	SOUTH	6	12	8		20	48
321+50	NORTH	8	12	11		20	52
	SOUTH	6	12	8		20	48
375+00	NORTH	6	15	10		26	57
	SOUTH	12	15		20	26	69
377+50	NORTH	6	15	10		26	57
	SOUTH	6	15	10		26	57
TOTAL				73	36	224	544

PERMANENT SURVEY MARKER SCHEDULE						
MONUMENT NUMBER	DESCRIPTION	APPROXIMATE LOCATION	EXISTING MONUMENT TYPE	PROPOSED MONUMENT TYPE	MONUMENT RECORD TO BE RECORDED	RESPONSIBILITY
DEPUE001	NW CORNER OF THE NE QTR OF THE SE QTR SECTION 22, T16N, R10E, 4TH PM	1/2 MI S OF US RTE 6	MAG NAIL	TYPE 1	YES	2
DEPUE002	VANCE HOPPER CENTERLINE ALTERNATE OPINION	"	BURIED IRON PIN PER DOC NO 79-2791	NO CHANGE	REFERENCE ON NEW MR	
DEPUE003	NW CORNER OF THE SE QTR OF THE SE QTR SECTION 22, T16N, R10E, 4TH PM	1/4 MI N OF 1400 N RD	COTTON GIN SPINDLE	TO BE DETERMINED	TO BE DETERMINED	2

**R.E. WILL INFORM PLATS AND PLANS WHEN SURFACE IS TO BE MILLED FOR THE PURPOSE OF SEARCHING FOR ADDITIONAL BURIED SURVEY MONUMENTS.**

UNKNOWN MONUMENTS MAY EXIST. IF AN UNLISTED MONUMENT IS FOUND, R.E. IS REQUIRED TO PROTECT THE MONUMENT FROM DAMAGE UNTIL A PLATS AND PLANS LAND SURVEYOR CAN DOCUMENT THE MONUMENT. PLATS AND PLANS WILL RESET SUCH MONUMENTS IN KIND FOLLOWING CONSTRUCTION.

**NOTE: FOR BIDDING PURPOSES, NO CONTRACTED LAND SURVEYING SERVICES WILL BE REQUIRED. PLATS AND PLANS WILL PREPARE AND RECORD THE REQUIRED MONUMENT RECORDS.**

**RESPONSIBILITY:**

- 1) RESIDENT TO RE-ESTABLISH MONUMENT (PAY ITEM REQUIRED. PERMANENT SURVEY MARKER, TYPE 1)
- 2) PLATS AND PLANS TO RE-ESTABLISH MONUMENT

MODEL: Default  
FILE NAME: c:\p\work\pww\hinalasco\01046113\0368R29-shr-schedule.dgn

USER NAME = Cassandra.Nolasco	DESIGNED -	REVISED -	<b>STATE OF ILLINOIS DEPARTMENT OF TRANSPORTATION</b>	<b>SCHEDULE OF QUANTITIES</b>				RTE.	SECTION	COUNTY	TOTAL SHEETS	SHEET NO.
	DRAWN -	REVISED -						(13,14)RS-1	BUREAU	17	11	
PLOT DATE = 12/5/2024	CHECKED -	REVISED -		SCALE:	SHEET	OF	SHEETS	STA.	TO STA.	ILLINOIS FED. AID PROJECT CONTRACT NO. 66R29		

# IDENTIFICATION OF ROADSIDE HAZARDS FOR TWO-LANE ROADWAYS

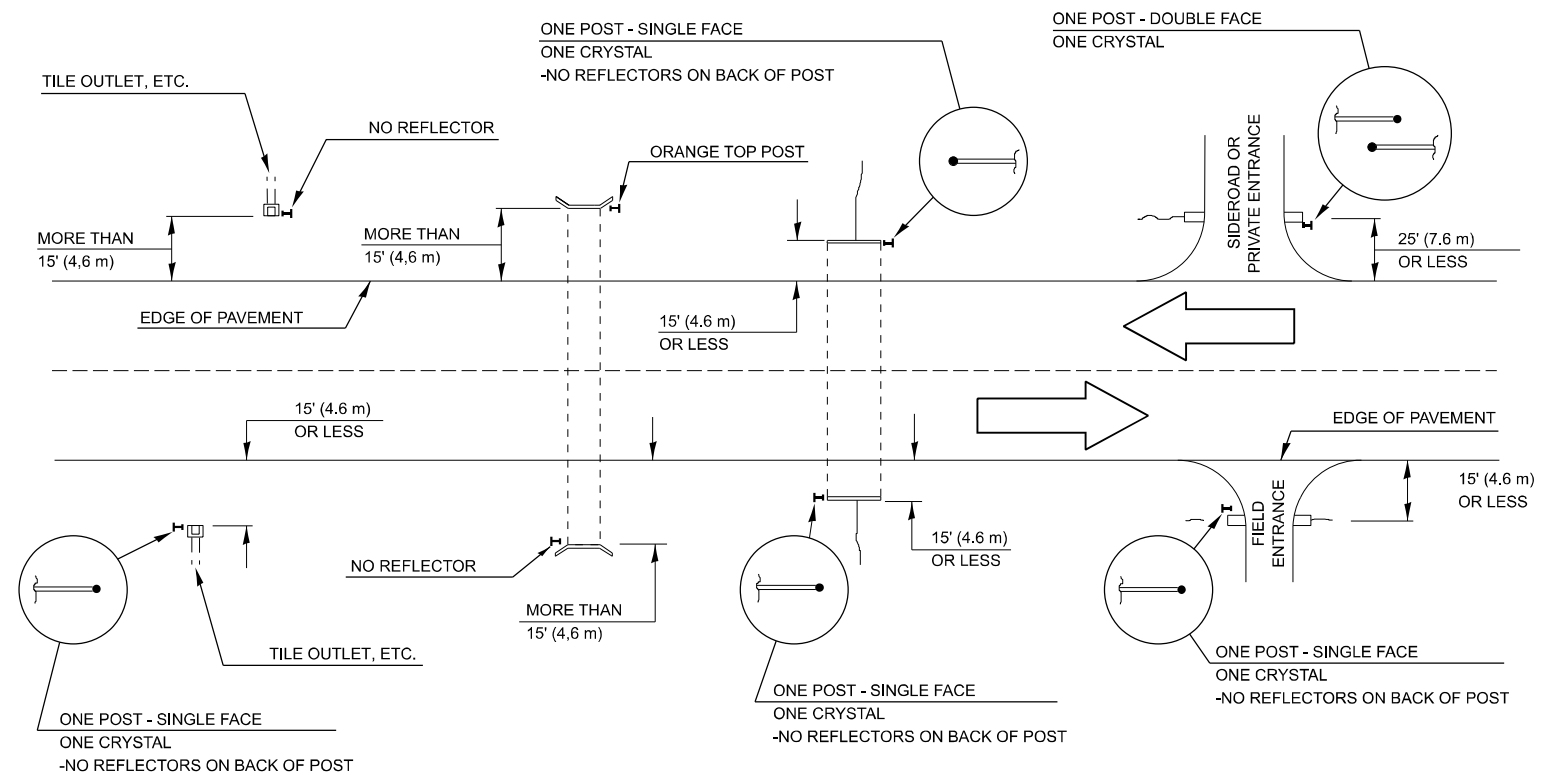

## BILL OF MATERIALS

DELINEATOR TYPE	SINGLE FACE	DOUBLE FACE	NO REFLECTOR	TOTAL DELINEATORS
SINGLE CRYSTAL			N/A	<b>8</b>
NO REFLECTOR			TOTAL	<b>8</b>

**NOTE:**

DELINEATORS FOR ROADSIDE HAZARDS SHALL ONLY BE PLACED AT LOCATIONS WHERE THERE IS NO GUARDRAIL, OR OTHER PERMANENT BARRIER, ON THE SAME SIDE OF THE ROAD AS THE HAZZARD.

DELINEATORS FOR ROADSIDE HAZARDS SHALL ONLY BE PLACED AT LOCATIONS WHERE DELINEATORS ARE NOT IN PLACE ALONG THE EDGE OF SHOULDER.

EACH POST SHALL BE CONSIDERED AS ONE DELINEATOR FOR PAYMENT, REGARDLESS OF THE NUMBER OF DELINEATORS ATTACHED TO IT.

FOR ONE-WAY AND INTERSTATE ROADWAYS THE APPLICATION SHALL BE SIMILAR WITH DELINEATORS PLACED ON THE TRAFFIC APPROACH SIDE OF HAZARDS AND OBJECTS, ONLY SINGLE FACE DELINEATORS WILL BE REQUIRED ON ONE-WAY ROADWAYS, CRYSTAL ON THE RIGHT SIDE AND AMBER ON THE LEFT SIDE.

FOR OTHER DELINEATOR APPLICATIONS, REFER TO HIGHWAY STANDARD 635001.

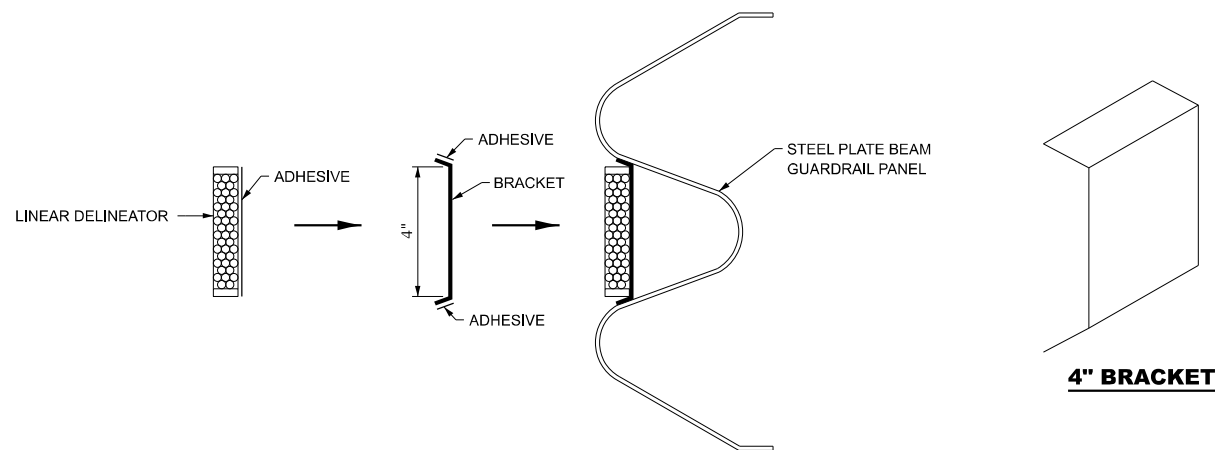

### LINEAR DELINEATOR APPLICATION TO STANDARD GALVANIZED GUARDRAIL

LINEATOR DELINEATOR SHALL BE APLIED ACCORDING TO THE MANUFACTURER'S RECOMMENDATIONS

MODEL: Default  
FILE NAME: c:\pwworking\hinalasco\1046113\368629-sh1-details.dgn

USER NAME = Cassandra.Nolasco	DESIGNED -	REVISED -	<b>STATE OF ILLINOIS DEPARTMENT OF TRANSPORTATION</b>	<b>DETAILS</b>				RTE.	SECTION	COUNTY	TOTAL SHEETS	SHEET NO.
	DRAWN -	REVISED -						*	(13,14)RS-1		17	12
PLOT DATE = 12/6/2024	CHECKED -	REVISED -		SCALE:	SHEET	OF	SHEETS	STA.	TO STA.	CONTRACT NO. 66R29		
	DATE -	REVISED -		ILLINOIS FED. AID PROJECT * SBI 7C, FAS 1252 W								

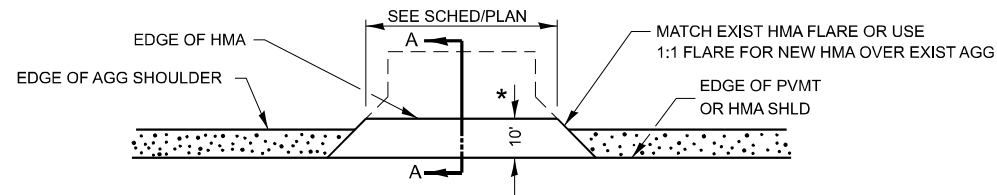

**PLAN AT PRIVATE & COMMERCIAL ENTRANCES**

(DO NOT RESURFACE FIELD ENTRANCES)

\* PROPOSED HMA RESURFACING AT PUBLIC EDUCATIONAL FACILITY ENTRANCES SHALL BE EXTENDED TO THE RIGHT-OF-WAY LIMITS.

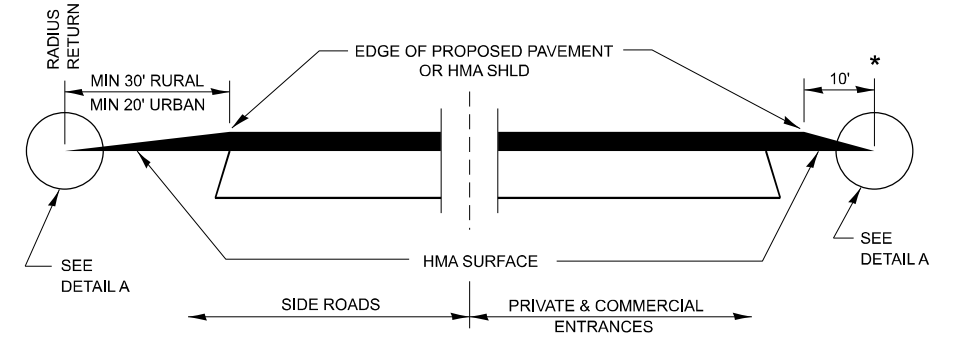

**SECTION A-A  
DETAILS AT ENTRANCES & SIDE ROADS**

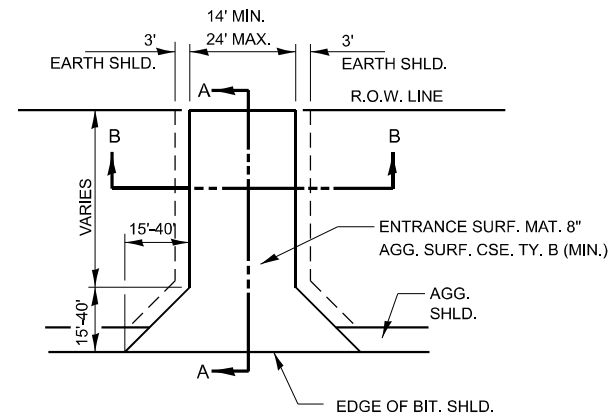

**TYPICAL NONCOMMERCIAL - RURAL  
(FIELD ENTRANCE)**

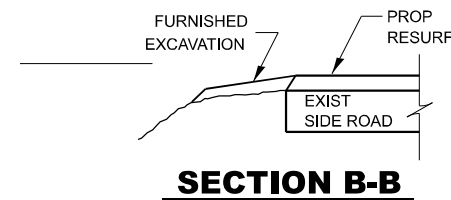

**SECTION B-B**

THE COST OF REMOVAL AT EXISTING HMA OR PCC LOCATIONS SHALL BE PAID FOR PER SQ YD BY THE APPROPRIATE PAY ITEM. REMOVAL AT THE EXISTING AGG LOCATIONS SHALL BE INCIDENTAL TO THE HMA. A-3 LOCATIONS SHALL BE FEATHER TAPERED.

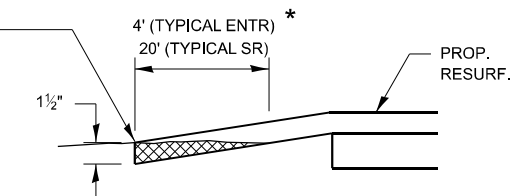

**DETAIL A**

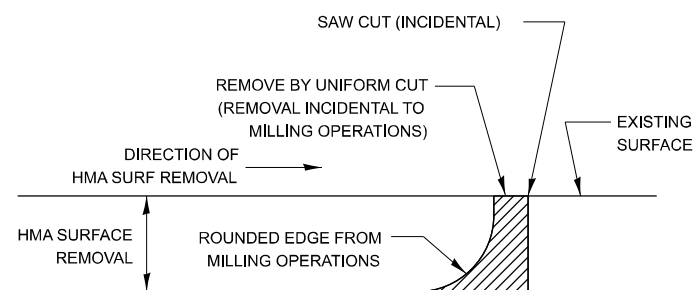

NOTE:  
WHEN MILLING OPERATIONS PRODUCE A ROUNDED EDGE, THEN A SAW CUT SHALL BE USED TO MANUFACTURE A PERPENDICULAR EDGE AS SHOWN IN THE DETAIL. THE ENGINEER SHALL BE THE SOLE JUDGE CONCERNING THE USE OF THIS DETAIL.

**HMA BUTT JOINT SAW CUTS**

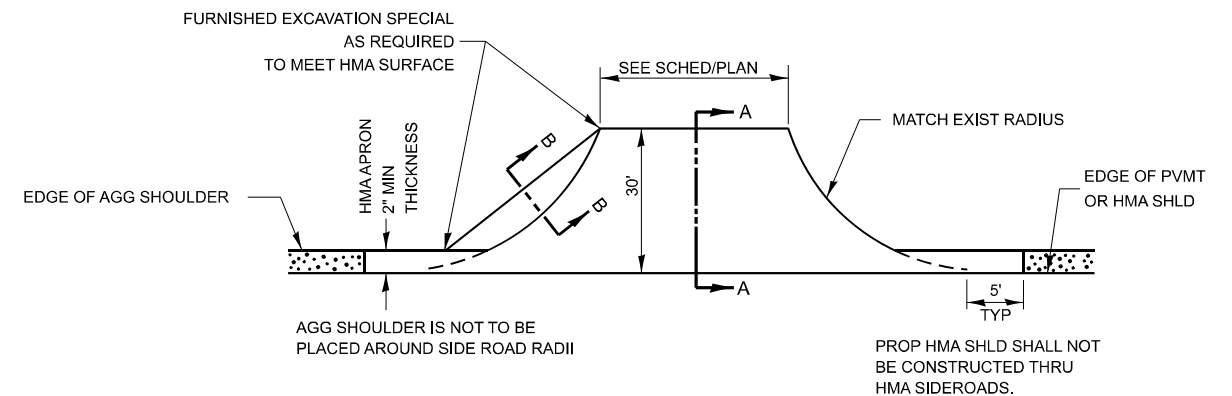

**PLAN AT SIDE ROADS**

MODEL: Default  
FILE NAME: c:\pwworking\hinalascoj\1046113\0368629-shr-details.dgn

USER NAME = Cassandra.Nolasco	DESIGNED -	REVISED -
	DRAWN -	REVISED -
	CHECKED -	REVISED -
PLOT DATE = 12/6/2024	DATE -	REVISED -

STATE OF ILLINOIS  
DEPARTMENT OF TRANSPORTATION

SCALE:	SHEET	OF	SHEETS	STA.	TO	STA.
--------	-------	----	--------	------	----	------

RTE.	SECTION	COUNTY	TOTAL SHEETS	SHEET NO.
	(13,14)RS-1	BUREAU	17	13
CONTRACT NO. 66R29				
ILLINOIS FED. AID PROJECT				

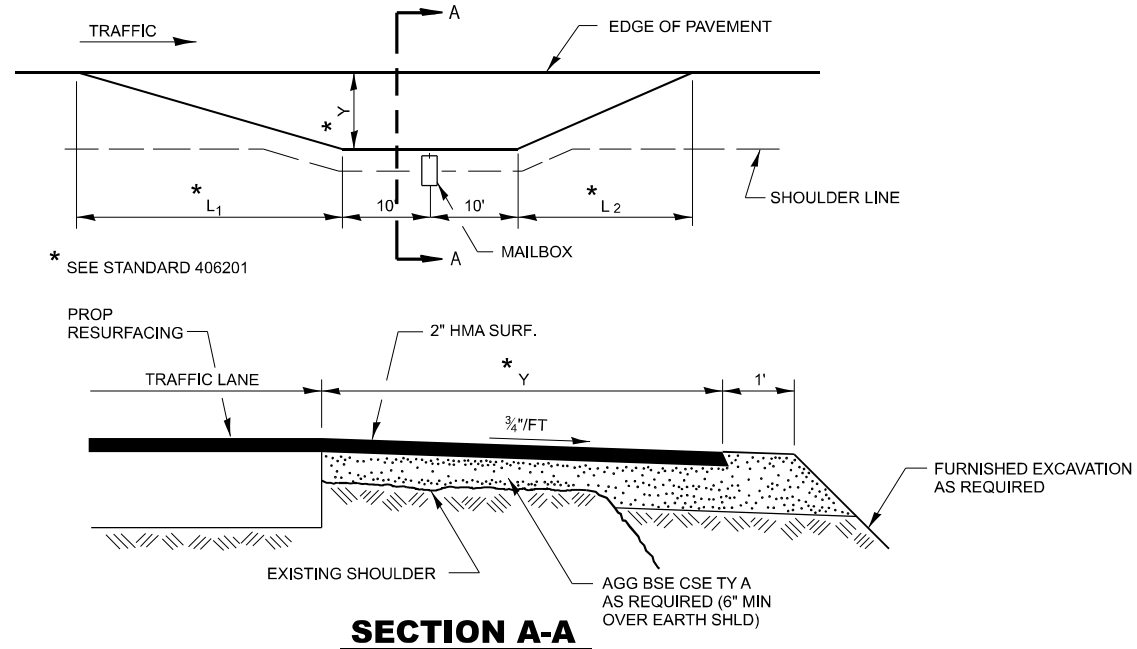

**SECTION A-A**  
**RURAL MAILBOX TURNOUT DETAILS**

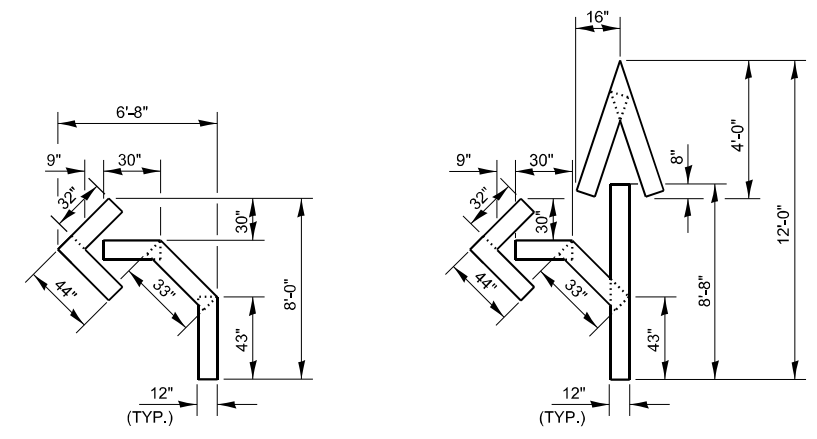

QUANTITY  
12" LINE = 16 LIN FT  
OR 4" LINE = 48 LIN FT

QUANTITY  
12" LINE = 29 LIN FT  
OR 4" LINE = 87 LIN FT

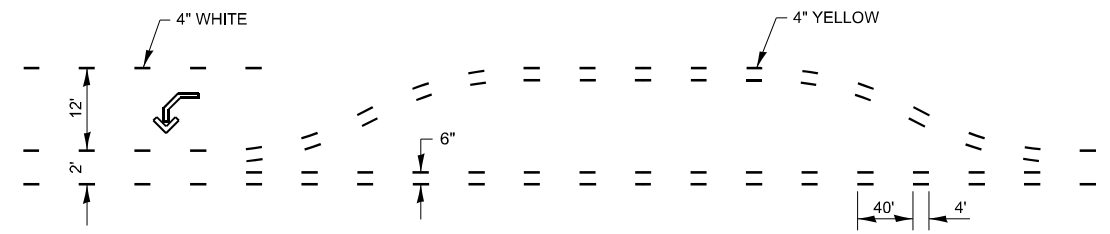

**SHORT-TERM PAVEMENT MARKING  
FOR MEDIANS AND ARROWS**

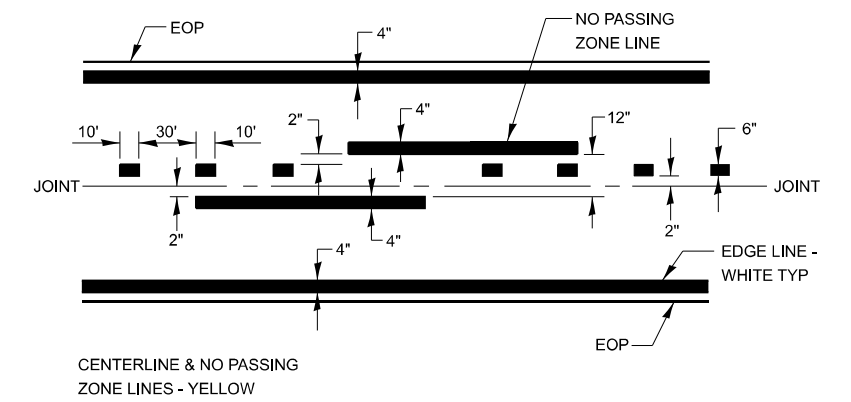

**PAVEMENT MARKING**

MODEL: Default  
FILE NAME: c:\p\work\pav\detail\detail.dgn

USER NAME = Cassandra.Nolasco	DESIGNED -	REVISED -
	DRAWN -	REVISED -
	CHECKED -	REVISED -
PLOT DATE = 12/6/2024	DATE -	REVISED -

**STATE OF ILLINOIS  
DEPARTMENT OF TRANSPORTATION**

SCALE:		SHEET	OF	SHEETS	STA.	TO STA.

RTE.	SECTION	COUNTY	TOTAL SHEETS	SHEET NO.
	(13,14)RS-1	BUREAU	17	14
CONTRACT NO. 66R29				
ILLINOIS FED. AID PROJECT				

\* SBI 7C, FAS 1252 W

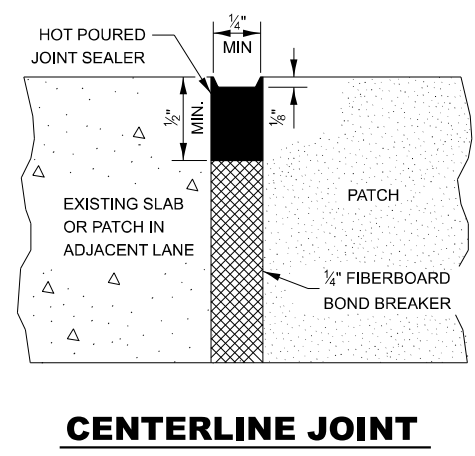
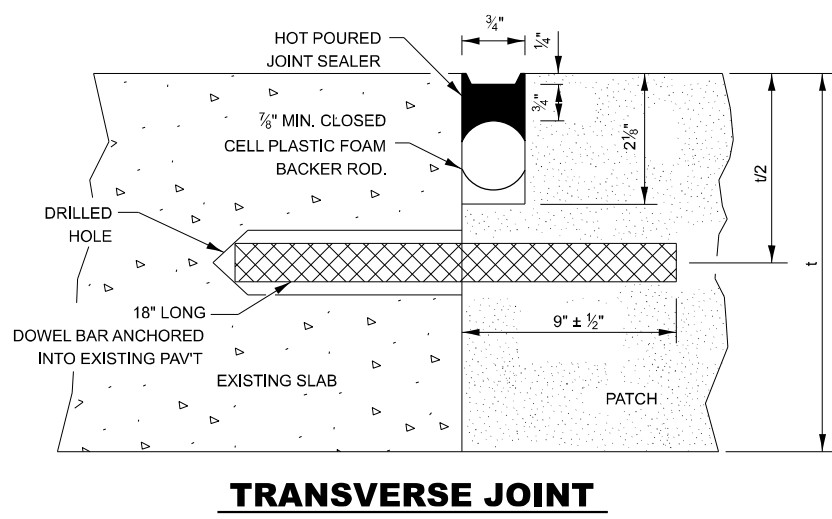
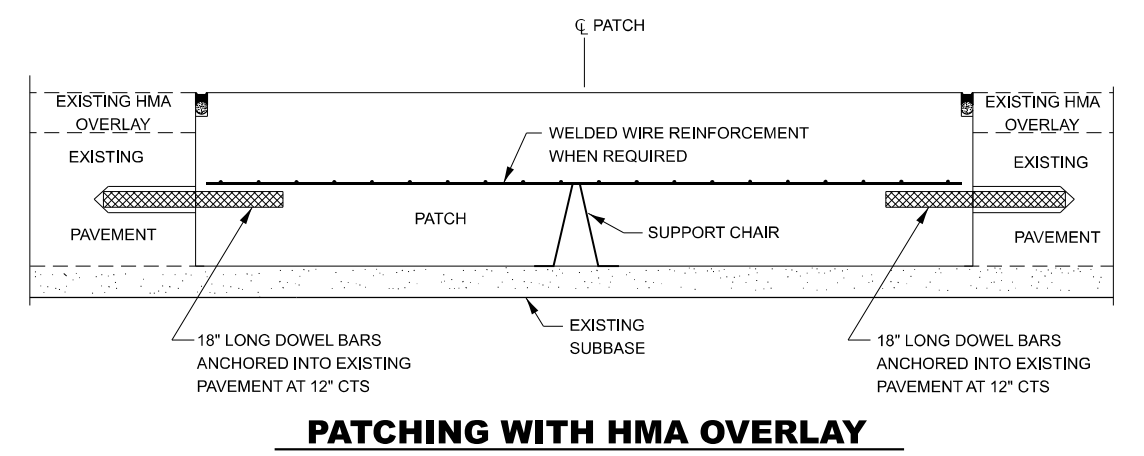
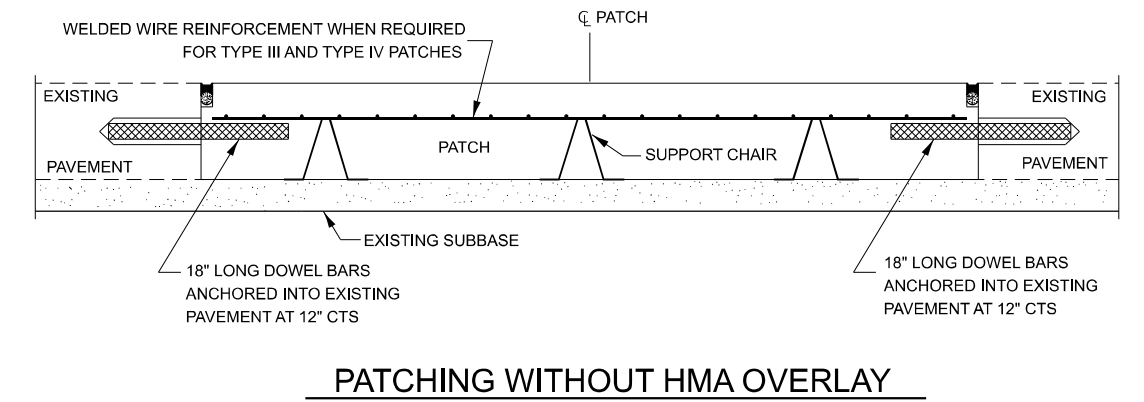
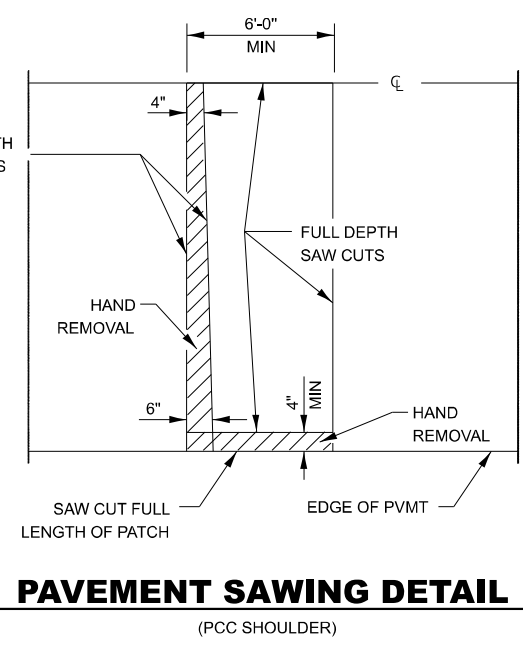
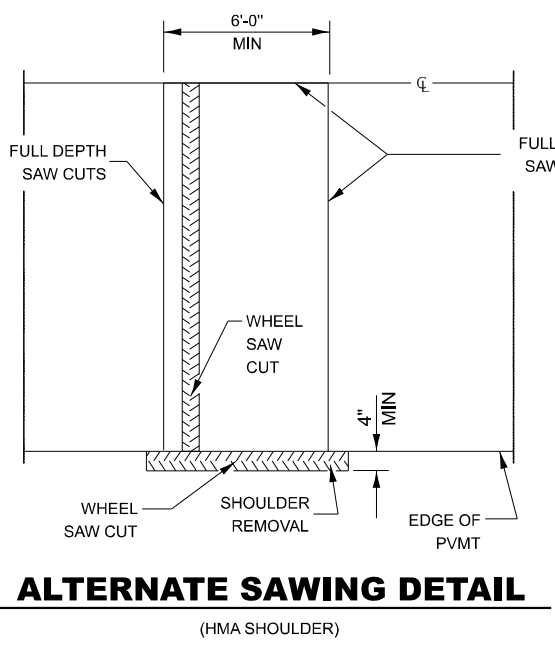
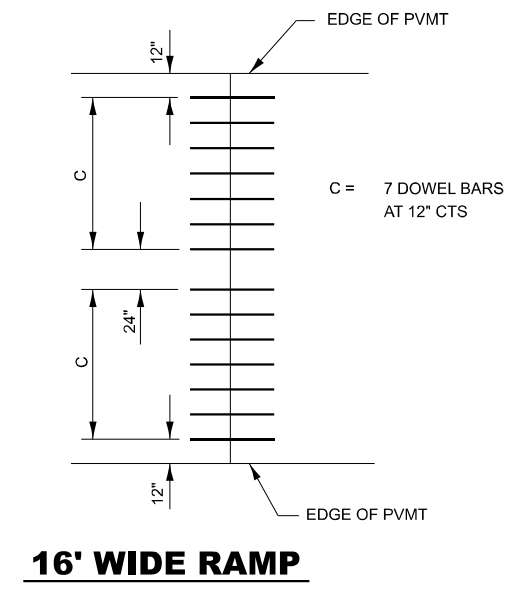
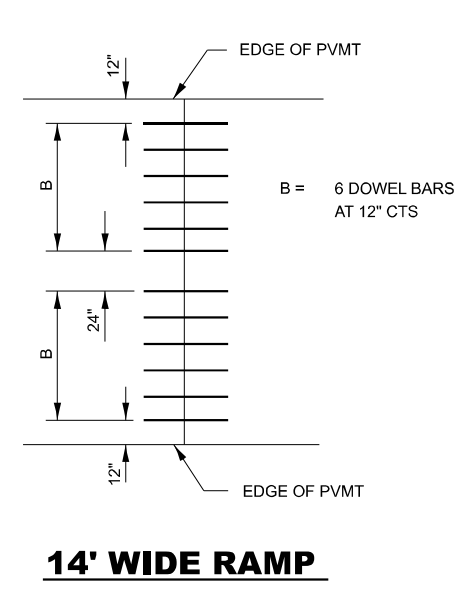
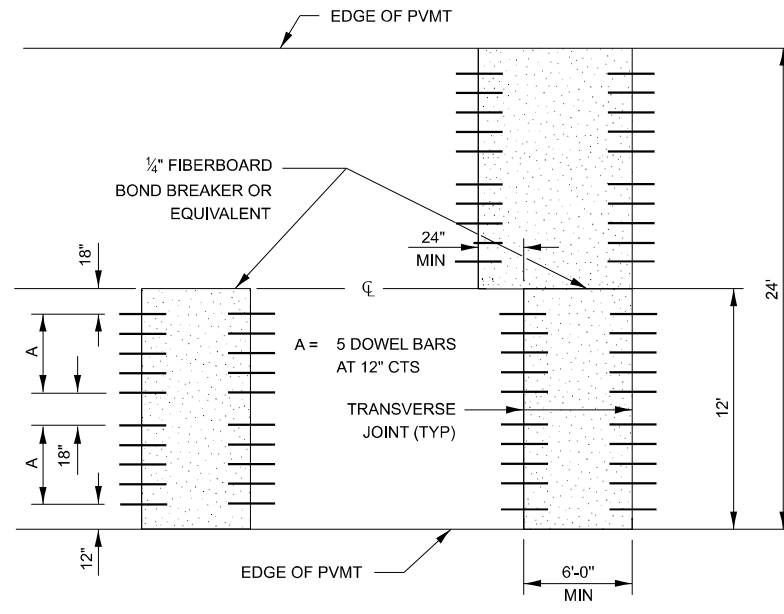
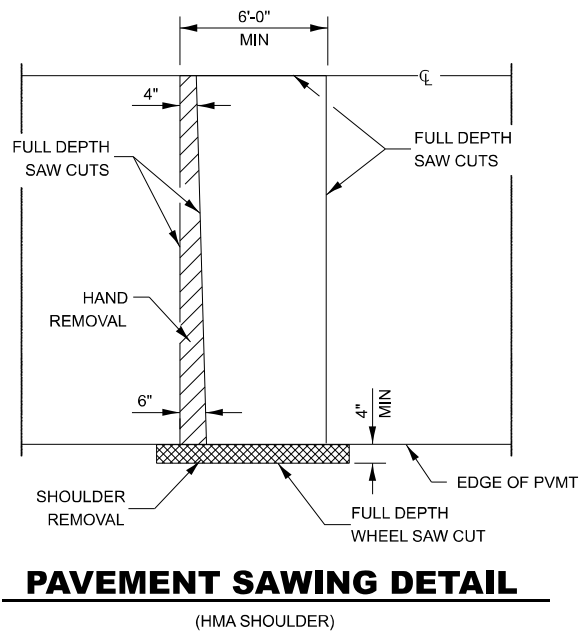

DOWEL BAR TABLE		
PAVEMENT THICKNESS	DOWEL BAR DIAMETER	HOLE DIAMETER
8" OR GREATER	1 1/2"	1 5/8"
7" THRU 7.99"	1 1/4"	1 3/8"
LESS THAN 7"	1"	1 1/8"

**GENERAL NOTES**

THE TRANSVERSE JOINTS FOR CLASS B PATCHES SHALL ALIGN WITH JOINTS OR CRACKS IN THE ADJACENT LANE WHENEVER POSSIBLE.

SEE STANDARD 420701 FOR DETAILS OF PAVEMENT WELDED WIRE REINFORCEMENT.

MODEL: Default  
FILE NAME: c:\p\work\pav\hmalasco\01046113\0368629-sh1-details.dgn

USER NAME = Cassandra.Nolasco	DESIGNED -	REVISED -	<b>STATE OF ILLINOIS DEPARTMENT OF TRANSPORTATION</b>	<b>CLASS B PATCHING DETAILS</b>				RTE.	SECTION	COUNTY	TOTAL SHEETS	SHEET NO.
PLOT DATE = 12/6/2024	DRAWN -	REVISED -						(13,14)RS-1	BUREAU	17	15	
	CHECKED -	REVISED -		SCALE: SHEET OF SHEETS STA. TO STA.				CONTRACT NO. 66R29				
	DATE -	REVISED -		ILLINOIS FED. AID PROJECT				* SBI 7C, FAS 1252 W				

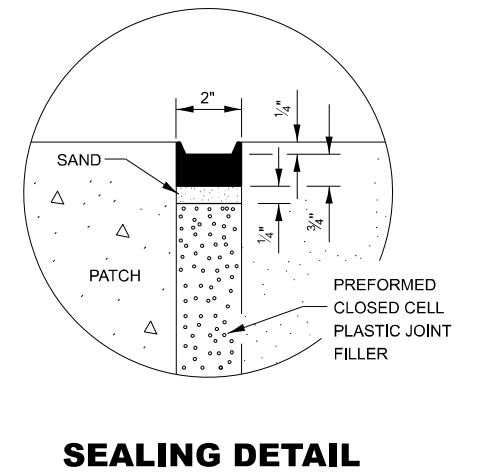
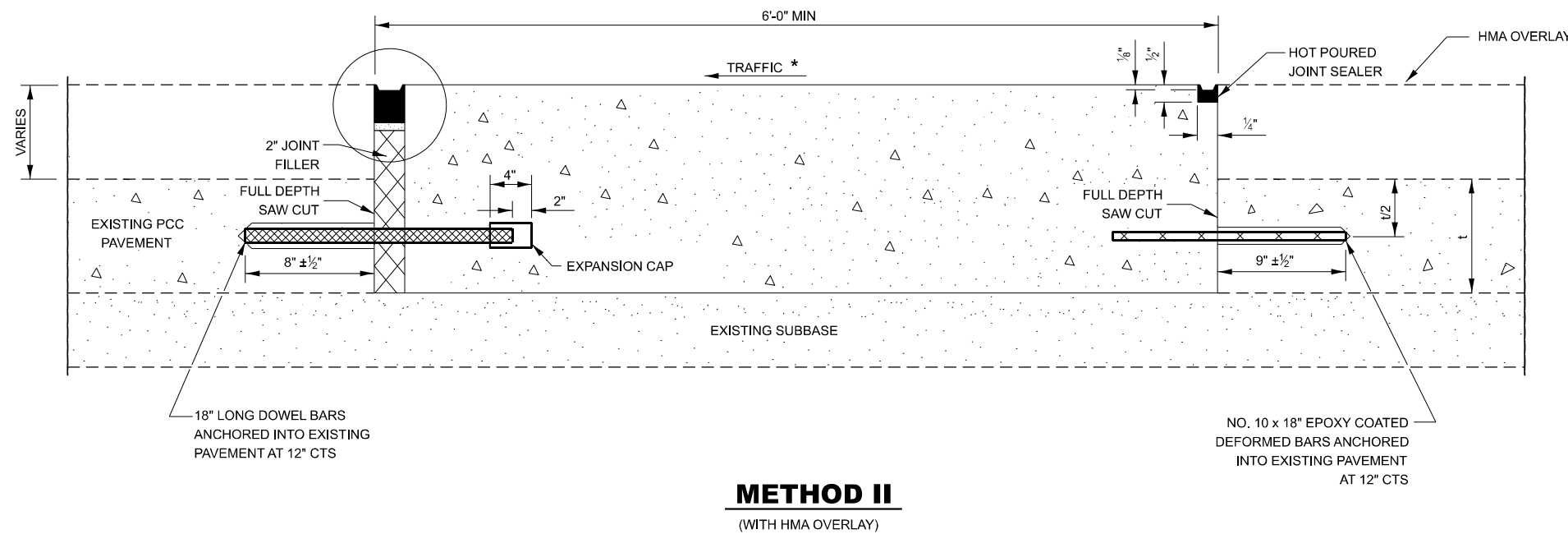
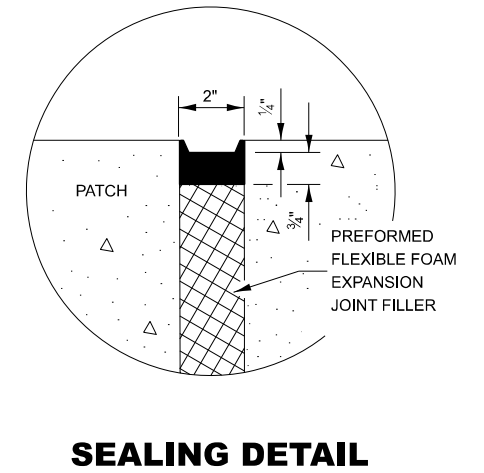
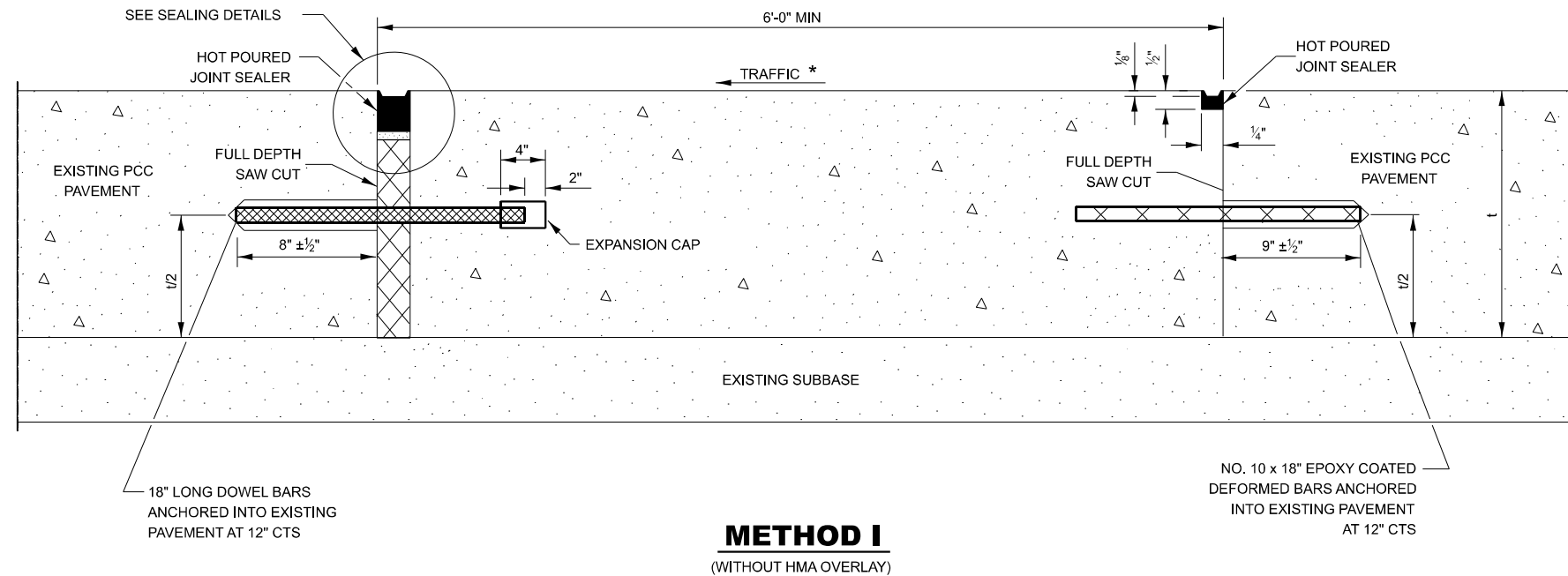

**NOTE**

\* WHEN RE-ESTABLISHING A TRANSVERSE EXPANSION JOINT ON A TWO-WAY ROAD, REVERSE THE ORIENTATION OF THE DOWEL BARS WITH RESPECT TO TRAFFIC FOR ONE OF THE PATCHES SUCH THAT THE JOINT WILL BE CONTINUOUS ACROSS BOTH LANES.

MODEL: Default  
FILE NAME: c:\pwworking\hinalasco\1046113\368629-shr-details.dgn

USER NAME = Cassandra.Nolasco	DESIGNED -	REVISED -	<b>STATE OF ILLINOIS DEPARTMENT OF TRANSPORTATION</b>	<b>CLASS B PATCHING DETAILS</b>			RTE.	SECTION	COUNTY	TOTAL SHEETS	SHEET NO.
	DRAWN -	REVISED -						(13,14)RS-1	BUREAU	17	16
	CHECKED -	REVISED -		CONTRACT NO. 66R29							
PLOT DATE = 12/6/2024	DATE -	REVISED -		SCALE:	SHEET	OF	SHEETS	STA.	TO	STA.	ILLINOIS



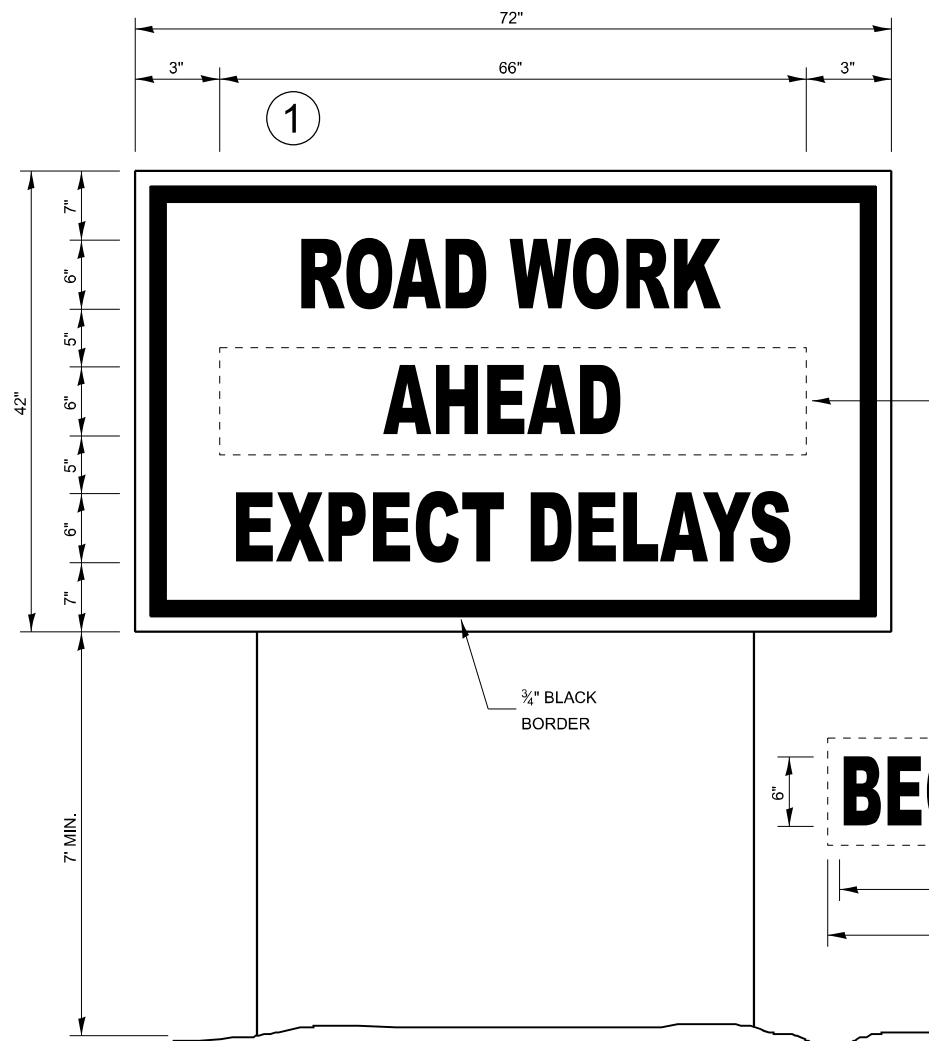

**TEMPORARY INFORMATION SIGNING**

**NOTES:**

1. USE 6" D BLACK LETTERING ON FLOURESENT ORANGE BACKGROUND.
2. ERECT SIGNS AT LOCATIONS IN ADVANCE OF THE "ROAD CONSTRUCTION AHEAD" SIGNS AS DIRECTED BY THE ENGINEER.
3. ERECT SIGN①WITH INSTALLED PANEL②A MINIMUM OF ONE WEEK PRIOR TO THE START OF THE LANE CLOSURE.
4. REMOVE PANEL②ON THAT DATE.
5. SEE SPECIAL PROVISION "TEMPORARY INFORMATION SIGNING" FOR ADDITIONAL INFORMATION.
6. WILL BE PAID FOR PER SQ FT AS "TEMPORARY INFORMATION SIGNING". EACH SIGN = 21 SQ FT

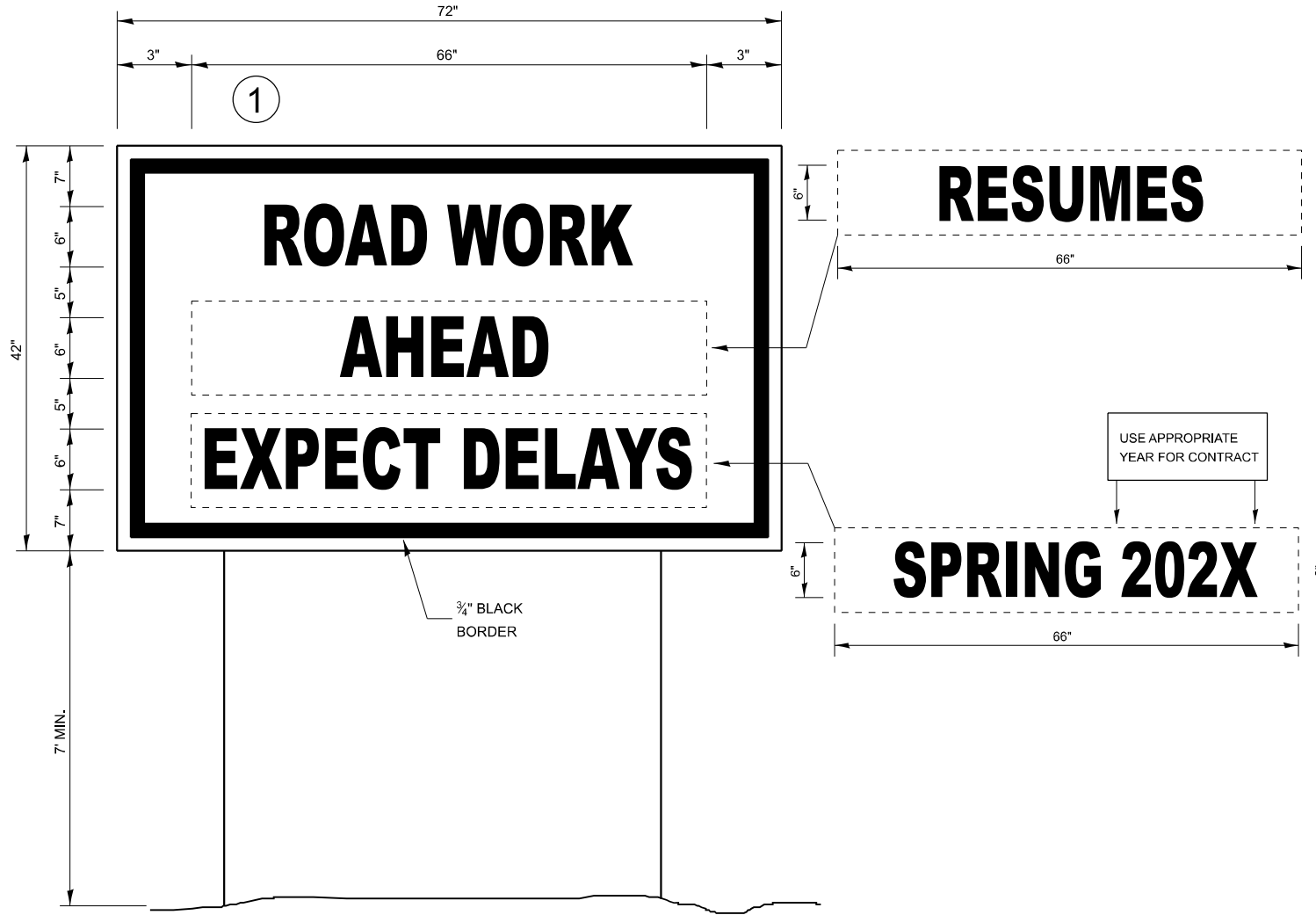

**WINTER SHUT DOWN SIGNING**

MODEL: Default  
FILE NAME: c:\p\work\pww\detail\alasco\01046113\368629-sh1-detail.dgn

USER NAME = Cassandra.Nolasco	DESIGNED -	REVISED -
	DRAWN -	REVISED -
	CHECKED -	REVISED -
PLOT DATE = 12/6/2024	DATE -	REVISED -

**STATE OF ILLINOIS  
DEPARTMENT OF TRANSPORTATION**

**DETAILS**

SCALE: SHEET OF SHEETS STA. TO STA.

RTE.	SECTION	COUNTY	TOTAL SHEETS	SHEET NO.
*	(13,14)RS-1	BUREAU	17	17
CONTRACT NO. 66R29				
ILLINOIS FED. AID PROJECT				