

STATE OF ILLINOIS  
 DEPARTMENT OF TRANSPORTATION  
 DIVISION OF HIGHWAYS

**PROPOSED  
 HIGHWAY PLANS**

F.A.P. ROUTE 346: US 41 (SKOKIE HIGHWAY)  
 OVER DEERPATH RD. (SN 049-0033)  
 SECTION: 130S-I(12)  
**BRIDGE JOINT & APPROACH PAVEMENT REPAIRS  
 LAKE COUNTY**

C-91-414-12

F.A.P. RTE.	SECTION	COUNTY	TOTAL SHEETS	SHEET NO.
346	130S-I(12)	LAKE	15	1
ILLINOIS CONTRACT NO.			60T65	

\*15+2=17

D-91-414-12

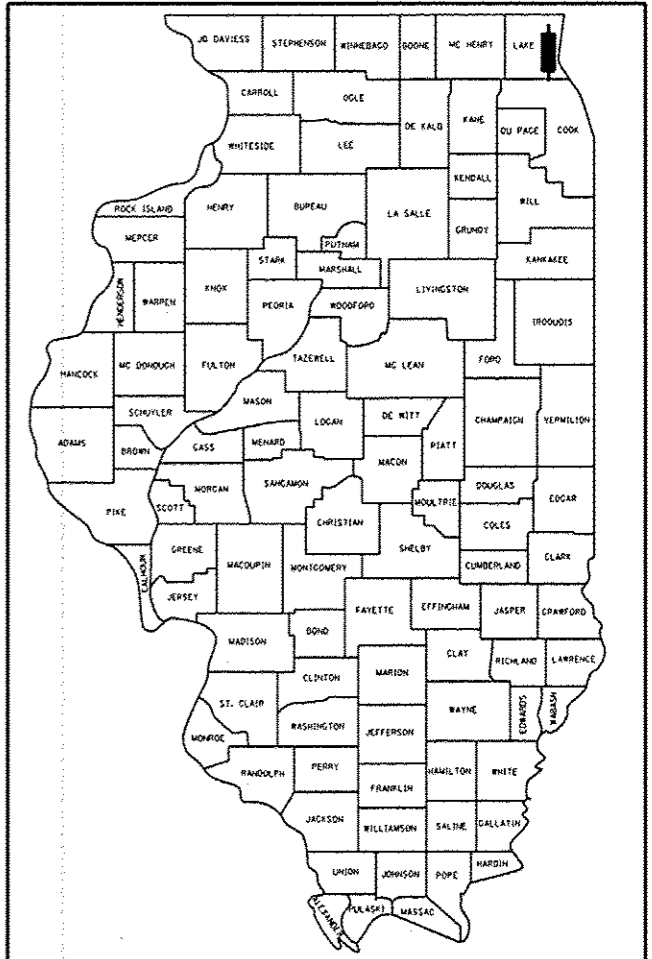

LOCATION OF SECTION INDICATED THUS: - [black rectangle] -

FOR INDEX OF SHEETS, SEE SHEET NO. 2

PROJECT IS LOCATED IN THE  
 CITY OF LAKE FOREST.

**TRAFFIC DATA**

2011 ADT = 44,900  
 POSTED SPEED LIMIT = 55 MPH

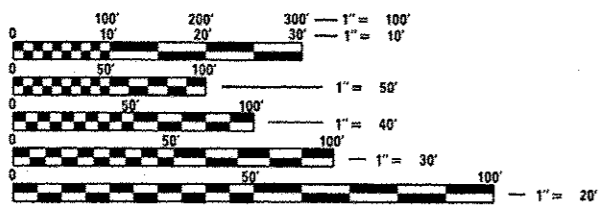

FULL SIZE PLANS HAVE BEEN PREPARED USING STANDARD ENGINEERING SCALES. REDUCED SIZED PLANS WILL NOT CONFORM TO STANDARD SCALES. IN MAKING MEASUREMENTS ON REDUCED PLANS, THE ABOVE SCALES MAY BE USED.

J.U.L.I.E.  
 JOINT UTILITY LOCATION INFORMATION FOR EXCAVATION  
 1-800-892-0123  
 OR 811

IMPROVEMENT LOCATION  
 SN 049-0033

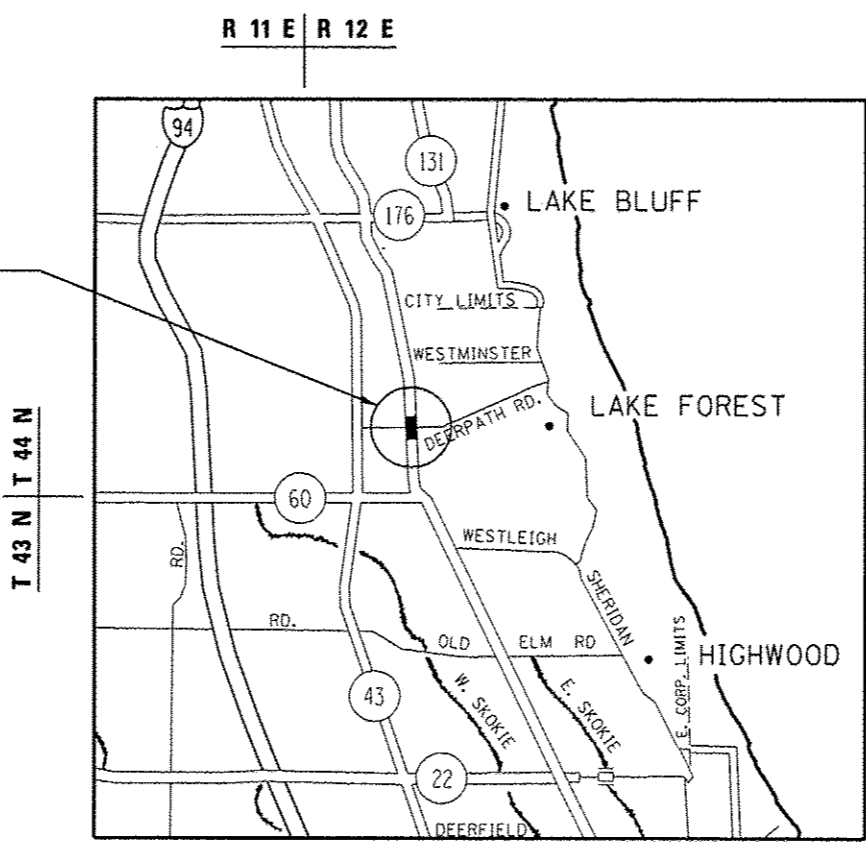

SHIELDS TOWNSHIP

GROSS & NET LENGTH = 568.8 FT. = 0.108 MILE

PROJECT ENGINEER J. ALAIN MIDY (847) 221-3057  
 PROJECT MANAGER ISSAM RAYYAN (847) 705-4178

CONTRACT NO. 60T65

STATE OF ILLINOIS  
 DEPARTMENT OF TRANSPORTATION  
 DIVISION OF HIGHWAYS

SUBMITTED December 18, 2012

John Costantino  
 DEPUTY DIRECTOR OF HIGHWAYS, REGION ENGINEER

Feb 1, 2013  
John D. Baranzelli, P.E.  
 ENGINEER OF DESIGN AND ENVIRONMENT

Feb 1, 2013  
Omer Osman, P.E.  
 DIRECTOR OF HIGHWAYS, CHIEF ENGINEER

PRINTED BY THE AUTHORITY  
 OF THE STATE OF ILLINOIS