

**AUXILIARY LANE MARKINGS**

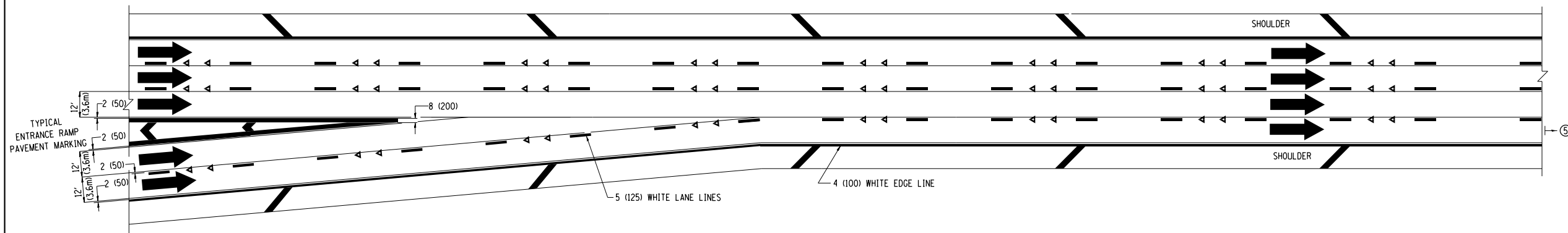

**TWO LANE ENTRANCE RAMP WITH MERGE MARKINGS**

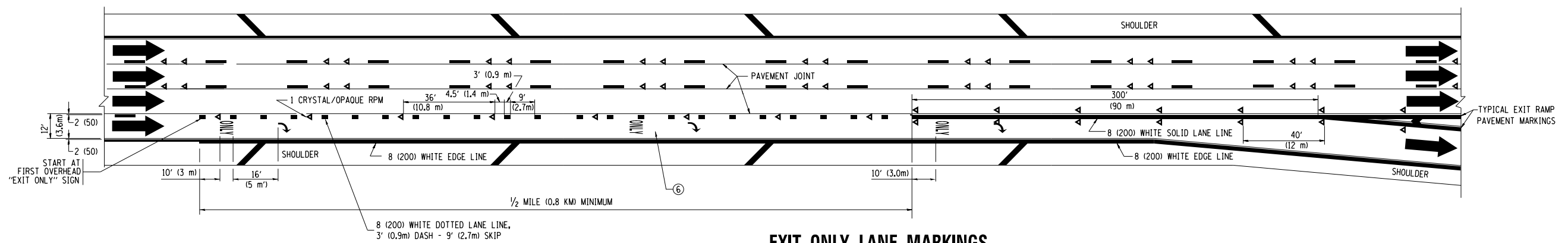

**EXIT ONLY LANE MARKINGS**

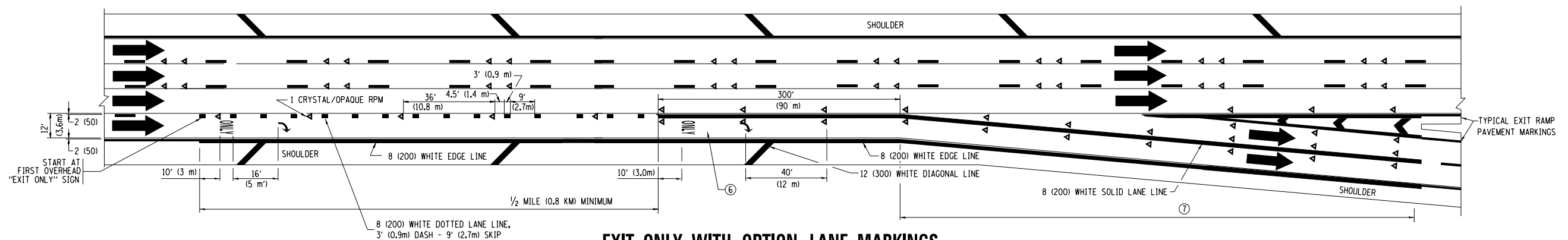

**EXIT ONLY WITH OPTION LANE MARKINGS**

- NOTES**
- ③ OMIT WHEN LENGTH OF AUXILIARY LANE IS LESS THAN 500' (150 m).
  - ④ 8-INCH WIDE DOTTED LANE LINE MARKINGS SHALL BE USED WHEN THE LENGTH OF THE AUXILIARY LANE IS 2 MILES OR LESS.
  - ⑤ FOR TWO-LANE ENTRANCE RAMP, IF RIGHT LANE ENDS, USE TYPICAL ENTRANCE RAMP PAVEMENT MARKINGS.
  - ⑥ ONLY AND ARROWS EQUALLY SPACED, 500' (150 m) MAXIMUM SPACING. FULL SIZE LETTERS AND ARROW SHALL BE USED.
  - ⑦ CONTINUE 8" SOLID LANE LINE THROUGH EXIT TO END OF PAVED GORE.

|  |                      |                   |                        |
|--|----------------------|-------------------|------------------------|
| FILE NAME =  | USER NAME = edouardj | DESIGNED - D.W.S. | REVISED - D.W.S. 07-96 |
| ei:\pw\work\p1d0t\edouardj\0317958\0108913-sht-pln.dgn |                      | DRAWN -           | REVISED - J.A.F. 02-06 |
|  |                      | CHECKED -         | REVISED - S.P.B. 01-07 |
|  |                      | DATE - 01-90      | REVISED - S.P.B. 01-10 |

**STATE OF ILLINOIS  
DEPARTMENT OF TRANSPORTATION**

|  |                         |      |         |
|--|-------------------------|------|---------|
| <b>MULTI-LANE FREEWAY<br/>PAVEMENT MARKING DETAILS</b> |                         |      |         |
| SCALE: NONE  | SHEET NO. 2 OF 2 SHEETS | STA. | TO STA. |

|   |           |                           |              |           |
|---|-----------|---------------------------|--------------|-----------|
| F.A.I. RTE.                                     | SECTION   | COUNTY                    | TOTAL SHEETS | SHEET NO. |
| 57  | 2012-0661 | COOK                      | 27           | 24        |
| <b>TC-12</b>                                    |           | <b>CONTRACT NO. 60V79</b> |              |           |
| FED. ROAD DIST. NO. 1 ILLINOIS FED. AID PROJECT |           |                           |              |           |