

SCHEDULE OF QUANTITIES
U.S. 20 (LAKE ST) AT JOHN F. KENNEDY BOULEVARD

NO.	QUANT.	UNIT	DESCRIPTION
1.	1	EACH	MAINTENANCE OF EXISTING TRAFFIC SIGNAL INSTALLATION
2.	1	EACH	MODIFY EXISTING CONTROLLER CABINET
3.	1	EACH	UNINTERRUPTABLE POWER SUPPLY, SPECIAL

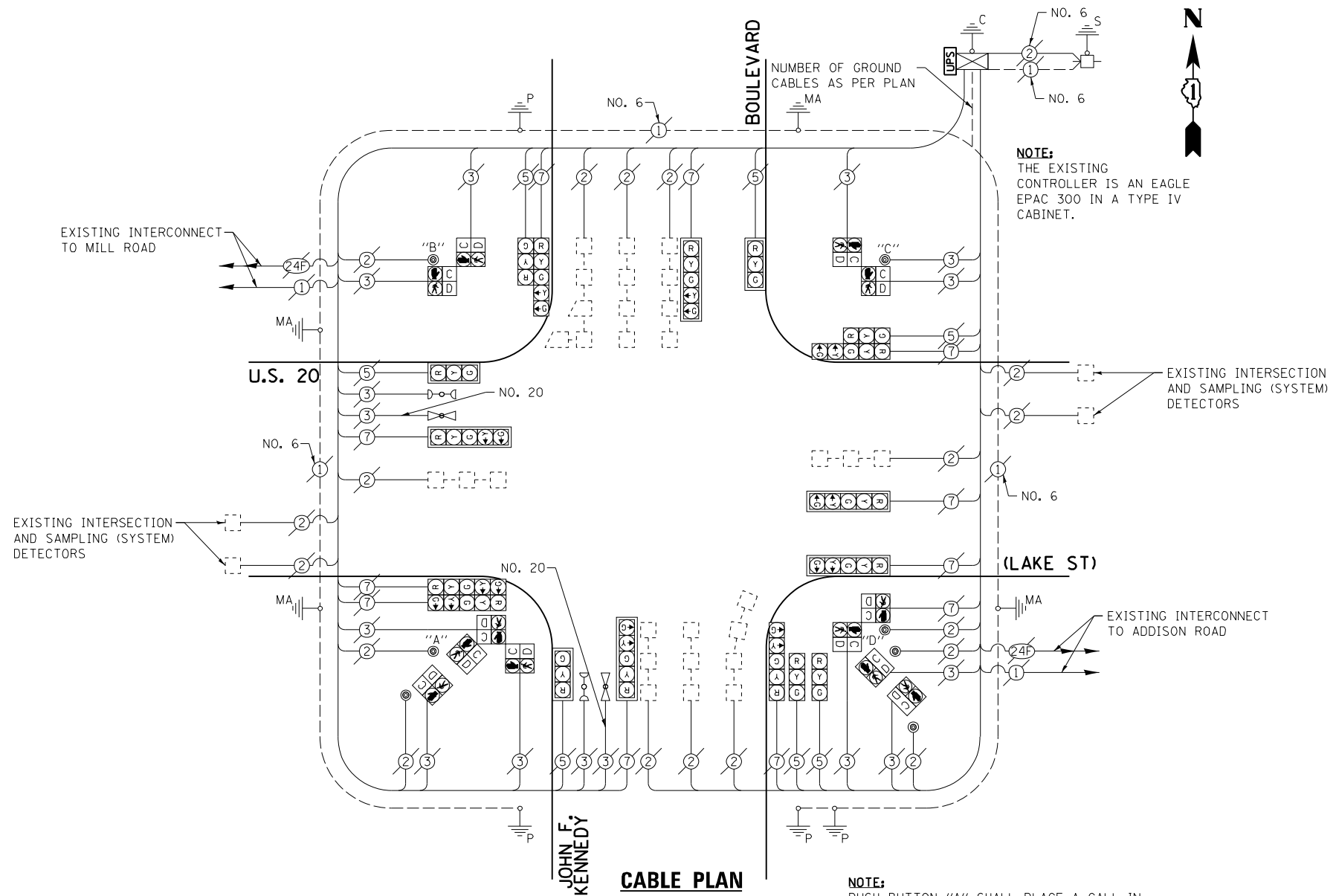

NOTE:
THE EXISTING CONTROLLER IS AN EAGLE EPAC 300 IN A TYPE IV CABINET.

NOTE:
PUSH BUTTON "A" SHALL PLACE A CALL IN PHASES 2 AND 4.
PUSH BUTTON "B" SHALL PLACE A CALL IN PHASES 4 AND 6.
PUSH BUTTON "C" SHALL PLACE A CALL IN PHASES 6 AND 8.
PUSH BUTTON "D" SHALL PLACE A CALL IN PHASES 2 AND 8.

EXISTING CONTROLLER SEQUENCE

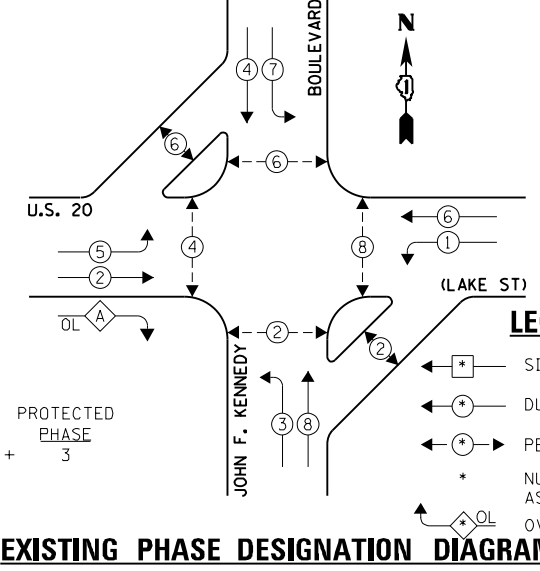

EXISTING EMERGENCY VEHICLE PREEMPTION SEQUENCE

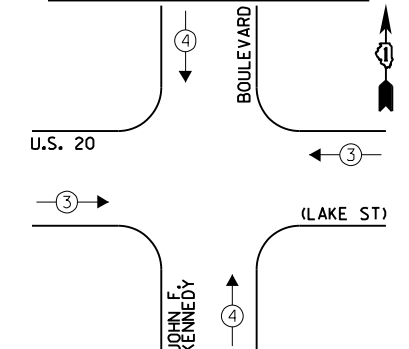

LEGEND:
 ← + → SINGLE ENTRY PHASE
 ← + → DUAL ENTRY PHASE
 ← + → PEDESTRIAN PHASE
 + NUMBER REFERS TO ASSOCIATED PHASE
 ← + → OVERLAP

OVERLAP LETTER A = PERMISSIVE PHASE 2 + PROTECTED PHASE 3

EXISTING PHASE DESIGNATION DIAGRAM

I.D.O.T. TRAFFIC SIGNAL INSTALLATION ELECTRICAL SERVICE REQUIREMENTS				TOTAL WATTAGE	
TYPE	NO. LAMPS	WATTAGE INCAND.	WATTAGE L.E.D.	OPERATION	
SIGNAL (RED)	17	135	17	0.50	144.50
SIGNAL (YELLOW)	17	135	25	0.25	106.25
SIGNAL (GREEN)	17	135	15	0.25	63.75
ARROW	20	135	12	0.10	24.0
PED. SIGNAL	12	90	25	1.00	300.0
CONTROLLER	1	-	100	1.00	100.0
LUMINAIRE	-	-	250	0.50	-
L.E.D. ST. NAME SIGN	-	-	64	0.50	-
VIDEO SYSTEM	-	-	150	1.00	-
BATTERY BACKUP	1	-	25	1.00	25.0
ILLUMINATED SIGN	-	-	25	0.05	-
TOTAL =					763.50

ENERGY COSTS - BILLED TO: IL DEPT. OF TRANSPORTATION
 (ADDRESS) 201 W. CENTER COURT
 (ADDRESS) SCHALMBURG, IL 60196-1096
 ENERGY SUPPLY - CONTACT: JOE STACHO
 PHONE: (630) 424-5704
 COMPANY: CQM-ED

EXISTING EMERGENCY VEHICLE PREEMPTORS	
EMERGENCY VEHICLE PREEMPTOR	3
MOVEMENT	4

FILE NAME = 60VB0-023-ts.dgn	USER NAME = zwallsten	DESIGNED - JRD	REVISED -
Default	PLOT SCALE = 1:20	DRAWN - JPW	REVISED -
	PLOT DATE = 12/20/2012	CHECKED - KLB	REVISED -
		DATE - 12-20-12	REVISED -

STATE OF ILLINOIS
DEPARTMENT OF TRANSPORTATION

SCHEDULE OF QUANTITIES, CABLE PLAN, PHASE DESIGNATION DIAGRAM, & EMERGENCY VEHICLE PREEMPTION SEQUENCE
U.S. 20 (LAKE ST) AT JOHN F. KENNEDY BOULEVARD

F.A. RTE. VARIES	SECTION 2012-070 I	COUNTY DuPAGE	TOTAL SHEETS 103	SHEET NO. 23
SCALE: NONE			CONTRACT NO. 60VB0	
SHEET OF SHEETS STA. TO STA.		ILLINOIS FED. AID PROJECT		

GHA #4085.887