

POINT	NORTH	EAST	STATION	ELEV	OFFSET	DESCRIPTION
CP-100	1,981,435.54	1,121,333.37	75+17.70	645.47	39.62' RT	"X" ON SIDEWALK SW CORNER ENT
CP-101	1,981,517.26	1,121,383.56	75+67.75	645.52	42.18' LT	REBAR TRAVERSE STATION
CP-102	1,981,512.15	1,121,796.52	79+80.73	643.00	37.75' LT	REBAR TRAVERSE STATION

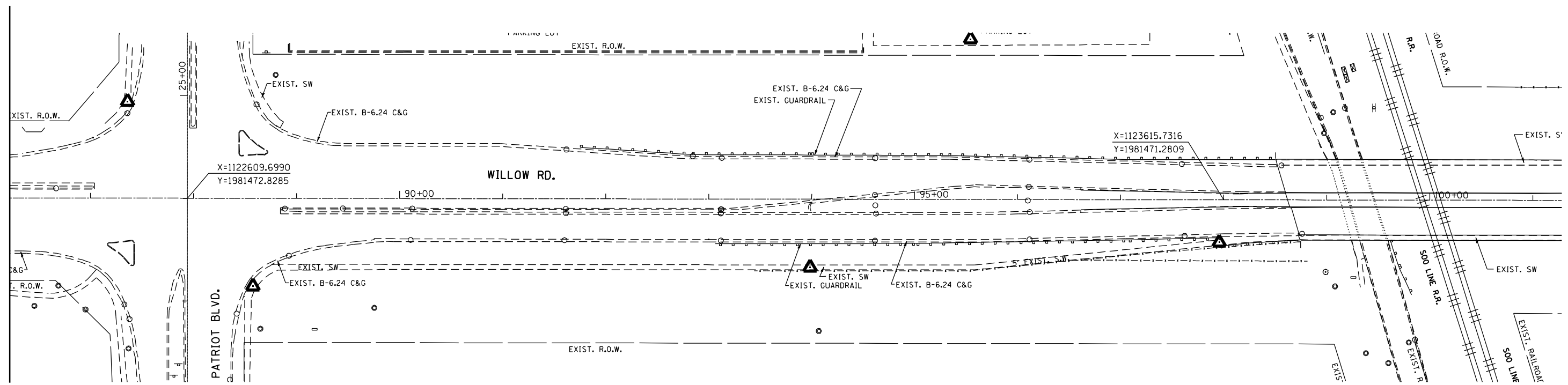

FILE NAME : P:\2011\ME11007_Ver-Var-PhI\CADD\W08.Willow.Rd\Shts\DI60W04-sh1-Align.dgn
 PLOT SCALE : 1/8"=1'-0"
 USER NAME : Millennium Professional Services



200 22ND Street, Suite 216, Lombard, IL 60148
 630.785.0110 voice, 630.839.2566 fax
 www.mps-ll.com
MILLENNIA PROFESSIONAL SERVICES

DESIGNED - TVN	REVISED -
DRAWN - MJW	REVISED -
CHECKED - TVN	REVISED -
DATE - 12/23/2012	REVISED -

STATE OF ILLINOIS
DEPARTMENT OF TRANSPORTATION

WILLOW ROAD
ALIGNMENT AND BENCHMARKS

SCALE: SHEET NO. OF SHEETS STA. TO STA.

F.A.P. RTE.	SECTION	COUNTY	TOTAL SHEETS	SHEET NO.
305	1920.01-B-R	COOK	60	6
CONTRACT NO. 60W04				
FED. ROAD DIST. NO. 1 ILLINOIS FED. AID PROJECT				

P:\2011\ME11007_Ver-Var-PhI\CADD\W08.Willow.Rd\Shts\DI60W04-sh1-Align.dgn