

**ELEVATION**

(Looking East)  
 (Dimensions shown are at right angle to  $\perp$  roadway unless noted)

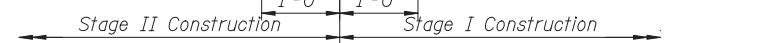

**NOTES**

1. A distance of half the length of the wingwall but not less than six feet of the barrel shall be poured monolithically with the wingwalls.
2. Reinforcement bars designated (E) shall be epoxy coated.
3. Bars indicated thus 12 x 4-#5 etc. indicates 12 lines of bars with 4 lengths per line.
4. Backfill shall be placed in equal layers behind each sidewall. At no time shall the fill behind one sidewall be more than 2 feet higher than behind the opposite wall.
5. For minimum bar lap, see sheet S1-07.

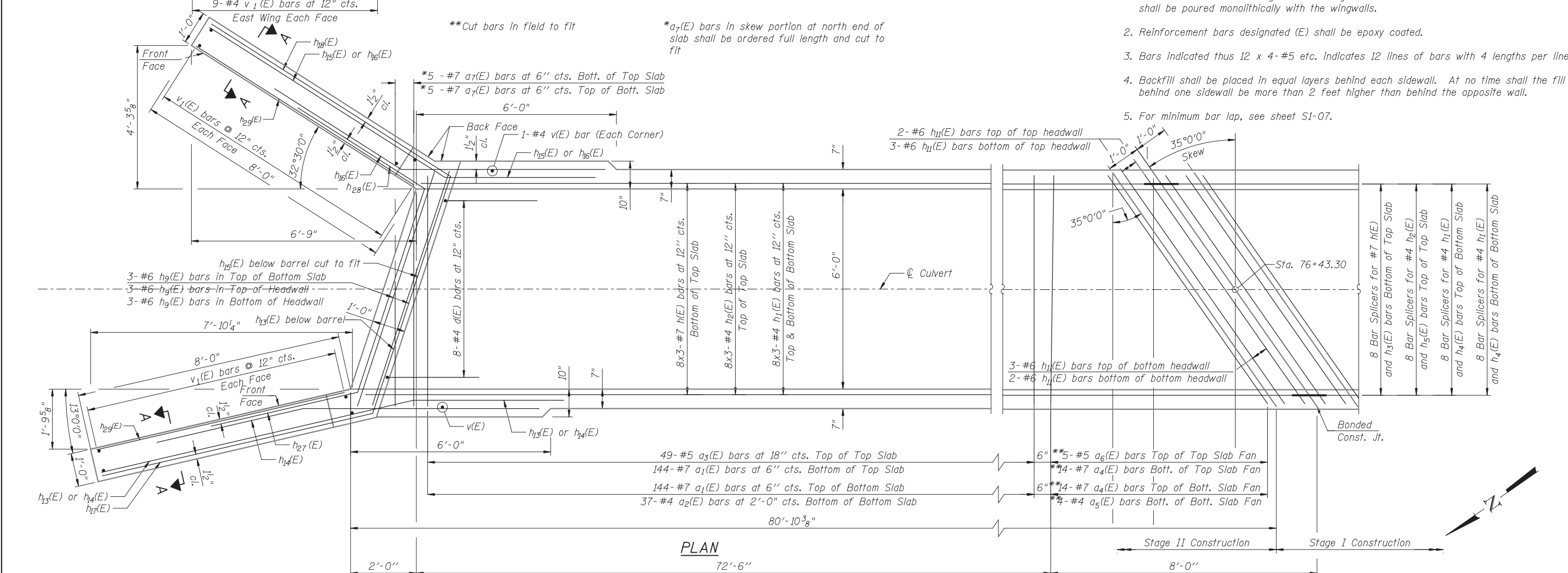

**PLAN**

72'-6"

**HBM**  
 ENGINEERING GROUP, LLC  
 CONSULTING & DESIGN  
 RESEARCH & TESTING

4415 WEST HARRISON ST.  
 SUITE 231  
 HILLSIDE, IL 60162  
 PHONE: (708) 236-0900  
 FAX: (708) 236-0901

DESIGNED - MI, LAB	REVISED -
CHECKED - MI	REVISED -
DRAWN - LAB, AI	REVISED -
CHECKED - MAI, MI	REVISED -

**STATE OF ILLINOIS**  
**DEPARTMENT OF TRANSPORTATION**

**PLAN AND ELEVATION I**  
**6'x4' BOX CULVERT (S.N. 016-1392) - STA. 76+44.64**

SHEET NO. S1-05 OF S1-10 SHEETS

F.A.P. RTE.	SECTION	COUNTY	TOTAL SHEETS	SHEET NO.
305	1920.01-B-R	COOK	60	31
CONTRACT NO. 60W04				

ILLINOIS FED. AID PROJECT