

MATCH LINE STA. 21+50.00
 SEE SHEET P-01

MATCH LINE STA. 27+50.00
 SEE SHEET P-03

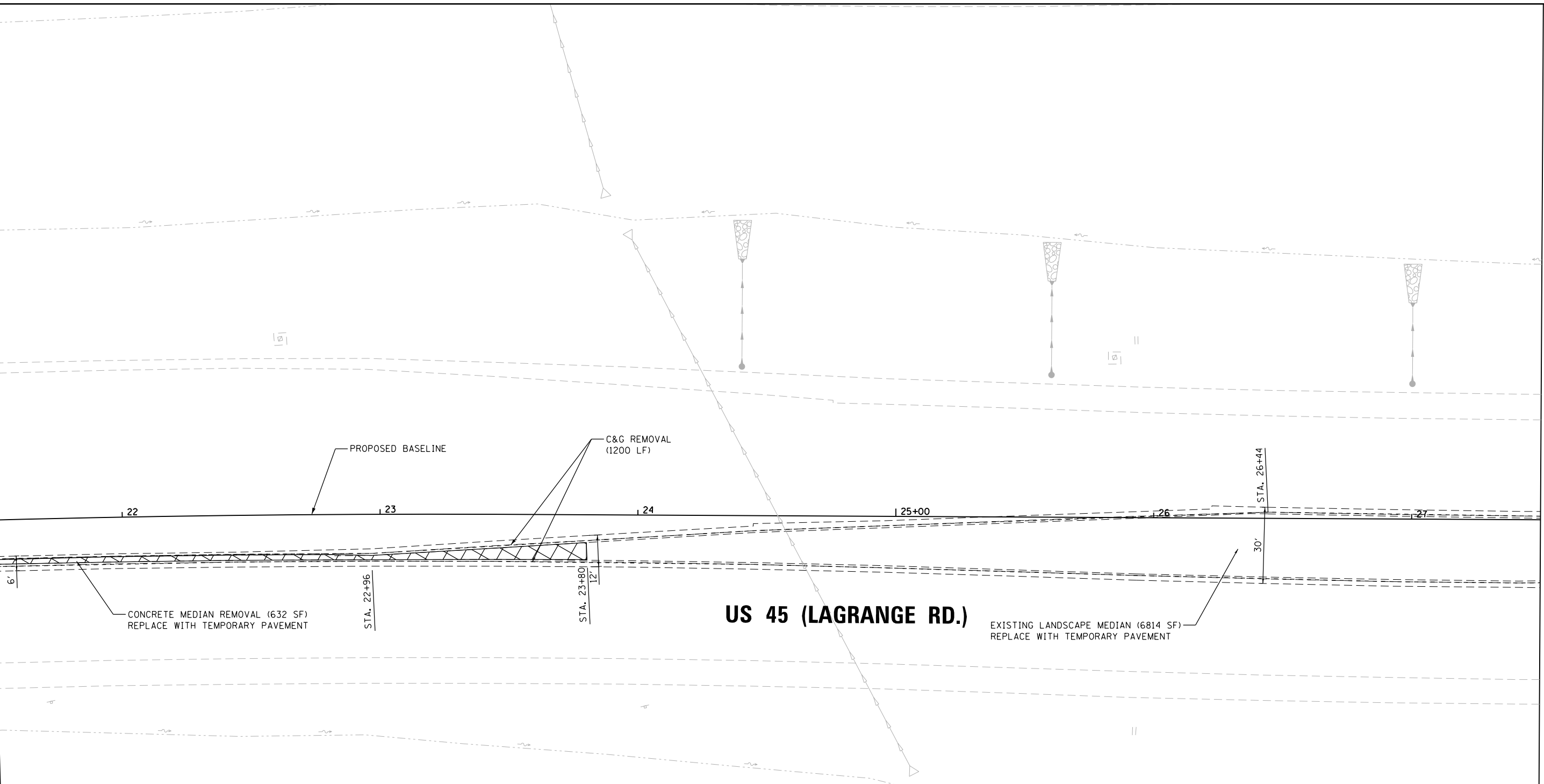

EXISTING R.O.W.		LEGEND	
MEDIAN REMOVAL		PROPOSED STORM SEWER	
BARRIER MEDIAN REMOVAL		EXISTING STORM SEWER	
CONCRETE MEDIAN REMOVAL		STORM SEWER TO BE PLUGGED AND ABANDONED (REMOVED IN FUTURE CONTRACT)	
SELECTIVE CLEARING		TREE TO BE REMOVED	
TREE REMOVAL		STORM STRUCTURE TO BE ADJUSTED	
PAVEMENT REMOVAL		SIGN TO BE REMOVED	
R.O.W. NOT YET ACQUIRED		PROPOSED MANHOLE	
		FUTURE STORM SEWER	

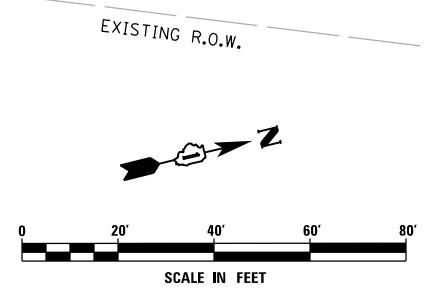

FILE NAME = D160W07-SHT-PLAN02.dgn	USER NAME = Frank.Stallone	DESIGNED - MGS	REVISED -
		DRAWN - REW	REVISED -
		CHECKED - JRS	REVISED -
		DATE - 01/02/13	REVISED -

**STATE OF ILLINOIS
 DEPARTMENT OF TRANSPORTATION**

REMOVAL, TEMPORARY PAVEMENT, AND DRAINAGE PLAN
 SCALE: 1"=20' SHEET 2 OF 26 SHEETS STA. 21+50.00 TO STA. 27+50.00

F.A.P. RTE. 330	SECTION 2012-0861	COUNTY COOK	TOTAL SHEETS 98	SHEET NO. 17
P-02		CONTRACT NO. 60W07		
ILLINOIS FED. AID PROJECT				