

**LEGEND**

- MEDIAN REMOVAL
- BARRIER MEDIAN REMOVAL
- CONCRETE MEDIAN REMOVAL
- SELECTIVE CLEARING
- TREE REMOVAL
- PAVEMENT REMOVAL
- R.O.W. NOT YET ACQUIRED
- PROPOSED STORM SEWER
- EXISTING STORM SEWER
- STORM SEWER TO BE PLUGGED AND ABANDONED (REMOVED IN FUTURE CONTRACT)
- TREE TO BE REMOVED
- STORM STRUCTURE TO BE ADJUSTED
- SIGN TO BE REMOVED
- PROPOSED MANHOLE
- FUTURE STORM SEWER

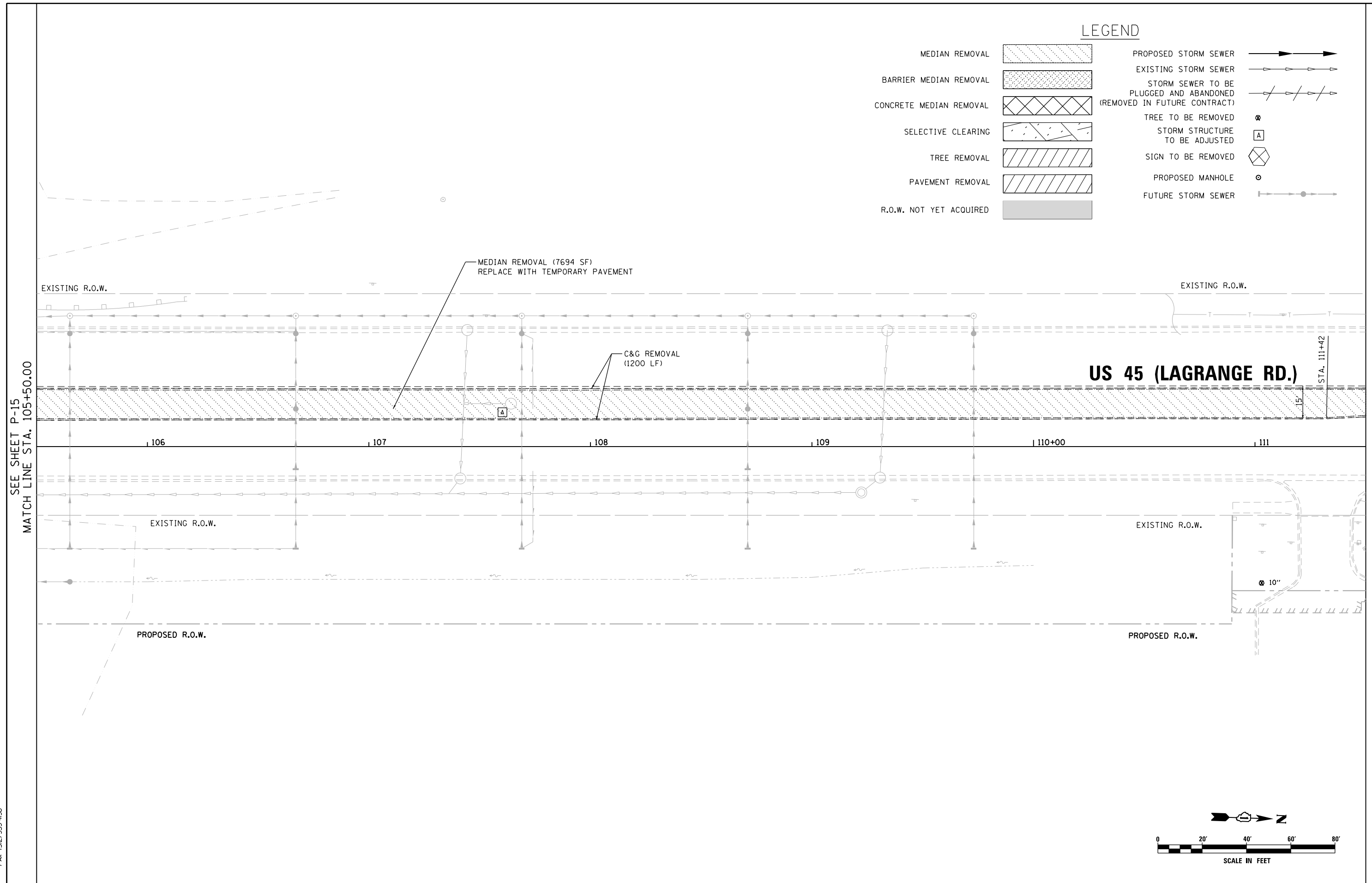

100 S. WACKER DR.  
 SUITE 600  
 CHICAGO, IL 60606  
 TEL (312) 939-1000  
 FAX (312) 939-4998  
**URS**

FILE NAME = D160W07-SHT-PLAN16.dgn	USER NAME = Frank_Stallone	DESIGNED - MGS	REVISED -
SHT_PLAN	PLOT SCALE = 48.0000' / in.	DRAWN - REW	REVISED -
	PLOT DATE = 1/7/2013	CHECKED - JRS	REVISED -
		DATE - 01/02/13	REVISED -

**STATE OF ILLINOIS  
DEPARTMENT OF TRANSPORTATION**

**REMOVAL, TEMPORARY PAVEMENT, AND DRAINAGE PLAN**

SCALE: 1"=20'    SHEET 16 OF 26 SHEETS    STA. 105+50.00 TO STA. 111+50.00

F.A.P. RTE.	SECTION	COUNTY	TOTAL SHEETS	SHEET NO.
330	2012-0861	COOK	98	31
<b>P-16</b>			<b>CONTRACT NO. 60W07</b>	
ILLINOIS FED. AID PROJECT				

