

LEGEND

	HOT-MIX ASPHALT PAVEMENT
	PCC DRIVEWAY
	PCC SIDEWALK 5'

- NOTE:**
1. THE LOCATION OF ALL SERVICE LINES ON THE PLANS ARE APPROXIMATE AND EXACT LOCATIONS TO BE DETERMINED IN THE FIELD BY THE CONTRACTOR.
 2. CONCRETE PAVEMENT SHALL BE REMOVED TO THE NEAREST JOINT.
 3. PORTLAND CEMENT CONCRETE SIDEWALK SHALL BE 6" THROUGH ALL DRIVEWAY ENTRANCES. THIS WORK WILL BE PAID AS PCC SIDEWALKS, 5'.
 4. ALL RADII ARE TO THE EDGE OF PAVEMENT UNLESS OTHERWISE NOTED.
 5. ALL SAW CUTTING SHALL BE INCLUDED IN THE COST FOR ADJACENT WORK.
 6. SEE SHEET 18 FOR STORM SEWER STRUCTURE AND PIPE TABLE.

PROPOSED COMBINATION CURB AND GUTTER SHALL BE DEPRESSED THROUGH ALL DRIVEWAYS AND SIDEWALKS. THIS ITEM IS CONSIDERED INCLUDED TO THE CONTRACT AND NO ADDITIONAL COMPENSATION WILL BE MADE.

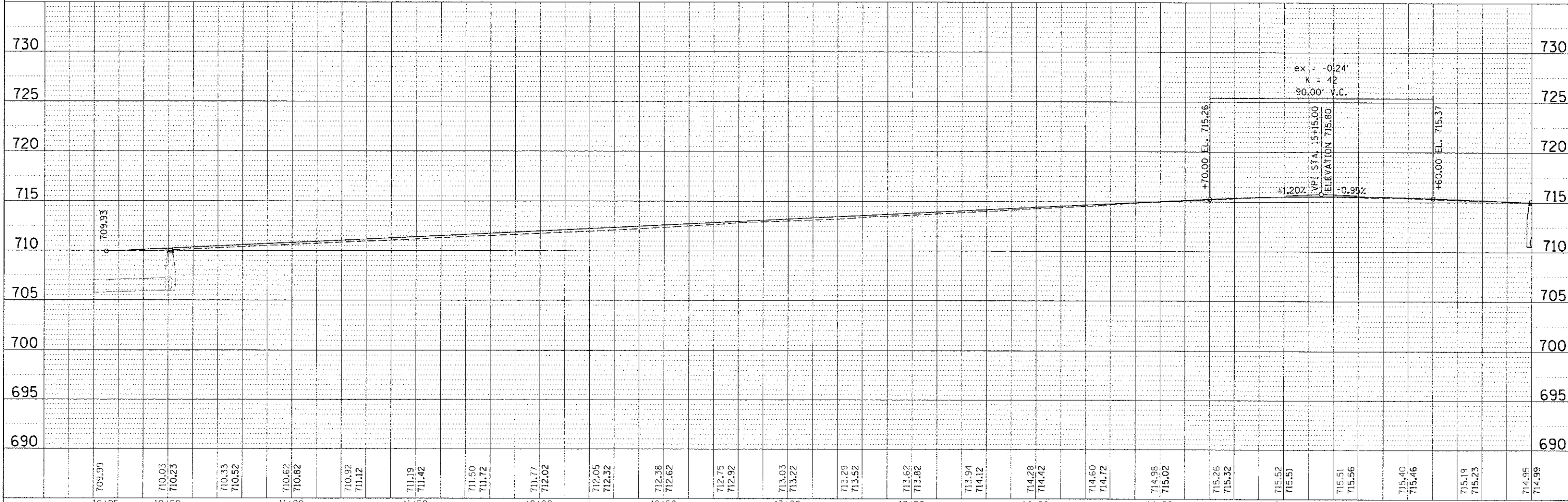
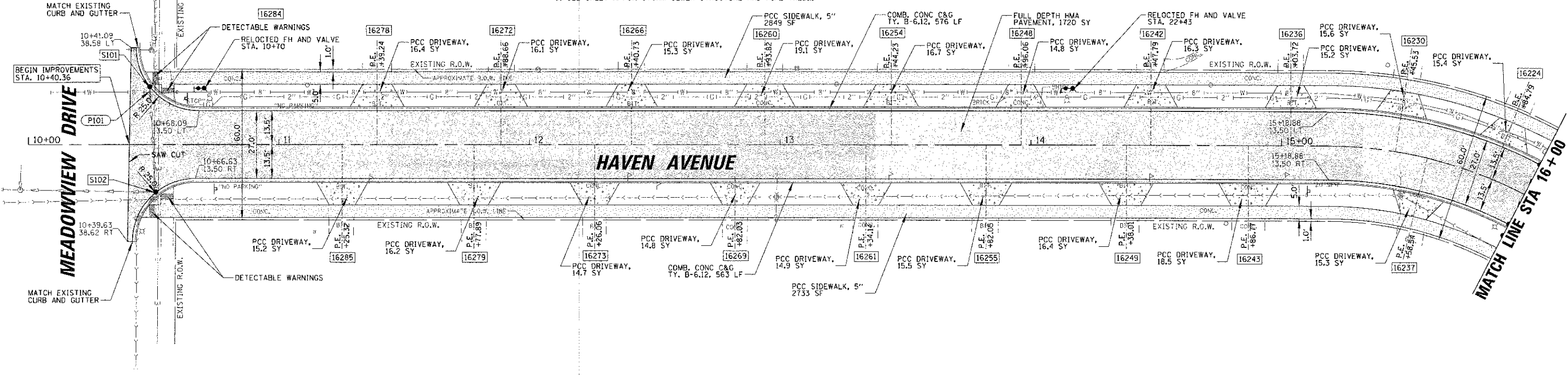

DATE	
BY	
CHECKED	
IN CHARGE	
PROJECT	
NO.	

DATE	
BY	
CHECKED	
IN CHARGE	
PROJECT	
NO.	

CHRISTOPHER B. BURKE ENGINEERING, LTD. 1938 E. Lincoln Highway, Suite 121 New Lenox, Illinois 60451 (815) 463-9050	USER NAME = mkgarnea DESIGNED <i>CJM</i> DRAWN <i>MAK</i> CHECKED <i>DV</i> DATE -	REVISED - REVISED - REVISED - REVISED -	STATE OF ILLINOIS DEPARTMENT OF TRANSPORTATION	ROADWAY PLAN AND PROFILE HAVEN AVENUE	F.A.U. RTE. 1037 SECTION 10-00024-00-FP COUNTY COOK CONTRACT NO. 63773	TOTAL SHEETS 59 SHEET NO. 12
	SCALE = 1" = 20' PLOT DATE = 1/3/2013	SCALE: 1" = 20' SHEET 12 OF 59 SHEETS STA. 10+00.00 TO STA. 16+00.00			ILLINOIS FED. AID PROJECT	