

- NOTE:
1. THE LOCATION OF ALL SERVICE LINES ON THE PLANS ARE APPROXIMATE AND EXACT LOCATIONS TO BE DETERMINED IN THE FIELD BY THE CONTRACTOR.
  2. CONCRETE PAVEMENT SHALL BE REMOVED TO THE NEAREST JOINT.
  3. PORTLAND CEMENT CONCRETE SIDEWALK SHALL BE 6" THROUGH ALL DRIVEWAY ENTRANCES. THIS WORK WILL BE PAID AS PCC SIDEWALKS, 5".
  4. ALL RADII ARE TO THE EDGE OF PAVEMENT UNLESS OTHERWISE NOTED.
  5. ALL SAW CUTTING SHALL BE INCLUDED IN THE COST FOR ADJACENT WORK.
  6. SEE SHEET 18 FOR STORM SEWER STRUCTURE AND PIPE TABLE.

PROPOSED COMBINATION CURB AND GUTTER SHALL BE DEPRESSED THROUGH ALL DRIVEWAYS AND SIDEWALKS. THIS ITEM IS CONSIDERED INCLUDED TO THE CONTRACT AND NO ADDITIONAL COMPENSATION WILL BE MADE.

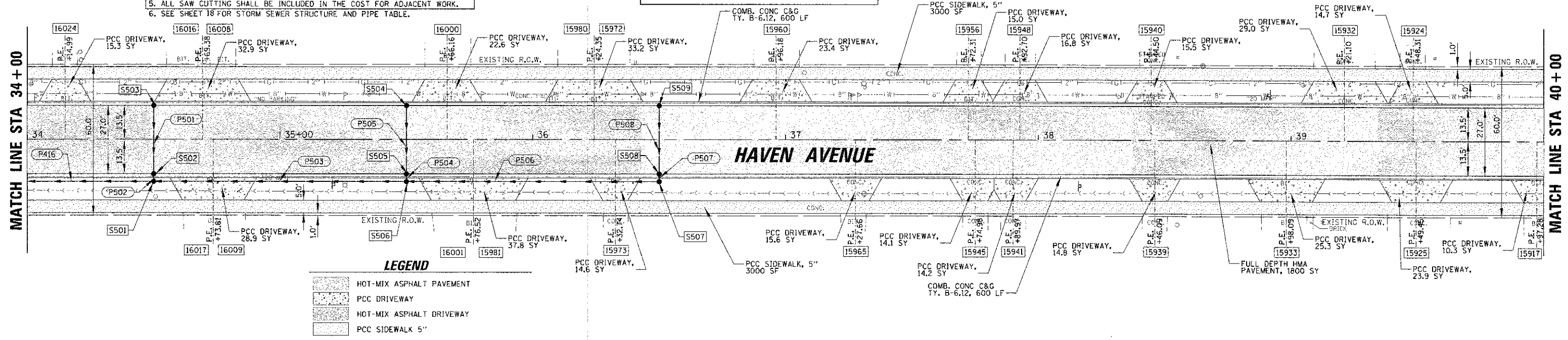
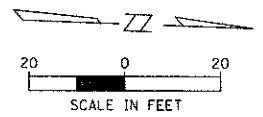

|              |                |
|--------------|----------------|
| PLAN         | NO. 1          |
| DATE         | 12/3/2013      |
| BY           | CB             |
| CHECKED      | MAK            |
| DESIGNED     | MAK            |
| PROJECT      | 10-00024-00-FP |
| SHEET        | 16             |
| TOTAL SHEETS | 59             |

|              |                |
|--------------|----------------|
| PROFILE      | NO. 1          |
| DATE         | 12/3/2013      |
| BY           | CB             |
| CHECKED      | MAK            |
| DESIGNED     | MAK            |
| PROJECT      | 10-00024-00-FP |
| SHEET        | 16             |
| TOTAL SHEETS | 59             |

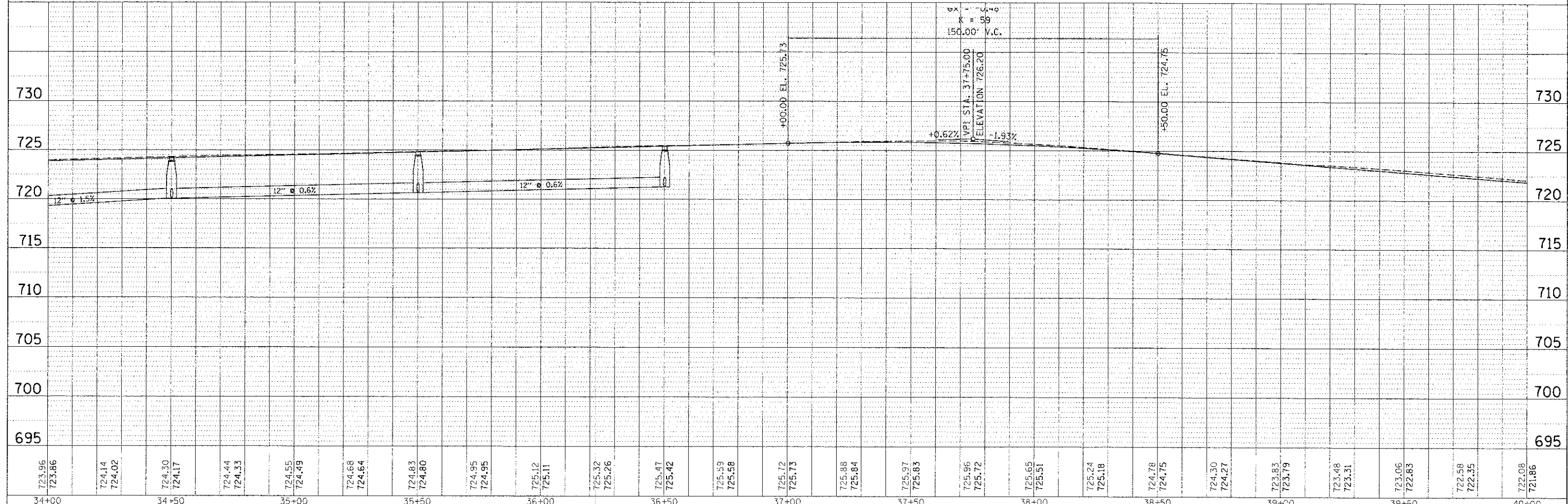

|                  |                  |                  |                  |                  |                  |                  |                  |                  |                  |                  |                  |                  |                  |                  |                  |                  |                  |                  |                  |                  |                  |                  |                  |                  |
|------------------|------------------|------------------|------------------|------------------|------------------|------------------|------------------|------------------|------------------|------------------|------------------|------------------|------------------|------------------|------------------|------------------|------------------|------------------|------------------|------------------|------------------|------------------|------------------|------------------|
| 723.96<br>723.86 | 724.14<br>724.02 | 724.30<br>724.17 | 724.44<br>724.33 | 724.55<br>724.49 | 724.68<br>724.64 | 724.83<br>724.80 | 724.95<br>724.95 | 725.12<br>725.11 | 725.32<br>725.26 | 725.47<br>725.42 | 725.59<br>725.58 | 725.72<br>725.73 | 725.88<br>725.84 | 725.97<br>725.83 | 725.96<br>725.72 | 725.65<br>725.51 | 725.24<br>725.18 | 724.78<br>724.75 | 724.30<br>724.27 | 723.83<br>723.79 | 723.48<br>723.31 | 723.06<br>722.83 | 722.58<br>722.35 | 722.08<br>721.86 |
| 34+00            | 34+50            | 35+00            | 35+50            | 36+00            | 36+50            | 37+00            | 37+50            | 38+00            | 38+50            | 39+00            | 39+50            | 40+00            |                  |                  |                  |                  |                  |                  |                  |                  |                  |                  |                  |                  |

**CHRISTOPHER B. BURKE**  
ENGINEERING, LTD.  
1938 E. Lincoln Highway, Suite 121  
New Lenox, Illinois 60451  
(815) 483-9050

USER NAME = cburke  
PLOT SCALE = 20'  
PLOT DATE = 12/3/2013

DESIGNED *CBM*  
DRAWN *MAK*  
CHECKED *DV*  
DATE

STATE OF ILLINOIS  
DEPARTMENT OF TRANSPORTATION

ROADWAY PLAN AND PROFILE  
HAVEN AVENUE  
SCALE: 1" = 20' SHEET 16 OF 59 SHEETS STA. 34+00.00 TO STA. 40+00.00

F.A.U. SECTION COUNTY TOTAL SHEETS NO.  
1037 10-00024-00-FP COOK 59 16  
CONTRACT NO. 63773  
ILLINOIS FED. AID PROJECT