

PLAN	REVISION	DATE
NO.	BY	
1		

PROFILE	REVISION	DATE
NO.	BY	
1		

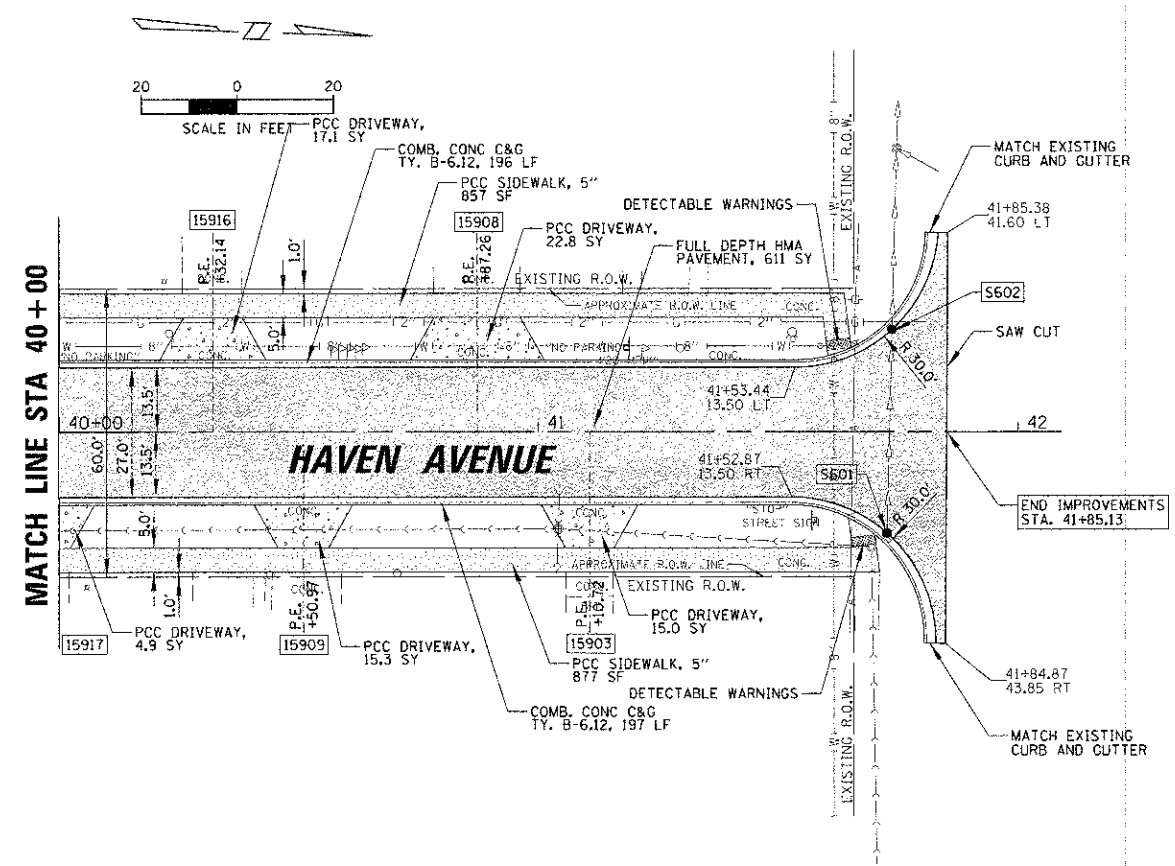

- NOTE:
1. THE LOCATION OF ALL SERVICE LINES ON THE PLANS ARE APPROXIMATE AND EXACT LOCATIONS TO BE DETERMINED IN THE FIELD BY THE CONTRACTOR.
 2. CONCRETE PAVEMENT SHALL BE REMOVED TO THE NEAREST JOINT.
 3. PORTLAND CEMENT CONCRETE SIDEWALK SHALL BE 6" THROUGH ALL DRIVEWAY ENTRANCES. THIS WORK WILL BE PAID AS PCC SIDEWALKS, 5".
 4. ALL RADII ARE TO THE EDGE OF PAVEMENT UNLESS OTHERWISE NOTED.
 5. ALL SAW CUTTING SHALL BE INCLUDED IN THE COST FOR ADJACENT WORK.
 6. SEE SHEET 18 FOR STORM SEWER STRUCTURE AND PIPE TABLE.

PROPOSED COMBINATION CURB AND GUTTER SHALL BE DEPRESSED THROUGH ALL DRIVEWAYS AND SIDEWALKS. THIS ITEM IS CONSIDERED INCLUDED TO THE CONTRACT AND NO ADDITIONAL COMPENSATION WILL BE MADE.

LEGEND

[Pattern]	HOT-MIX ASPHALT PAVEMENT
[Pattern]	PCC DRIVEWAY
[Pattern]	PCC SIDEWALK 5"

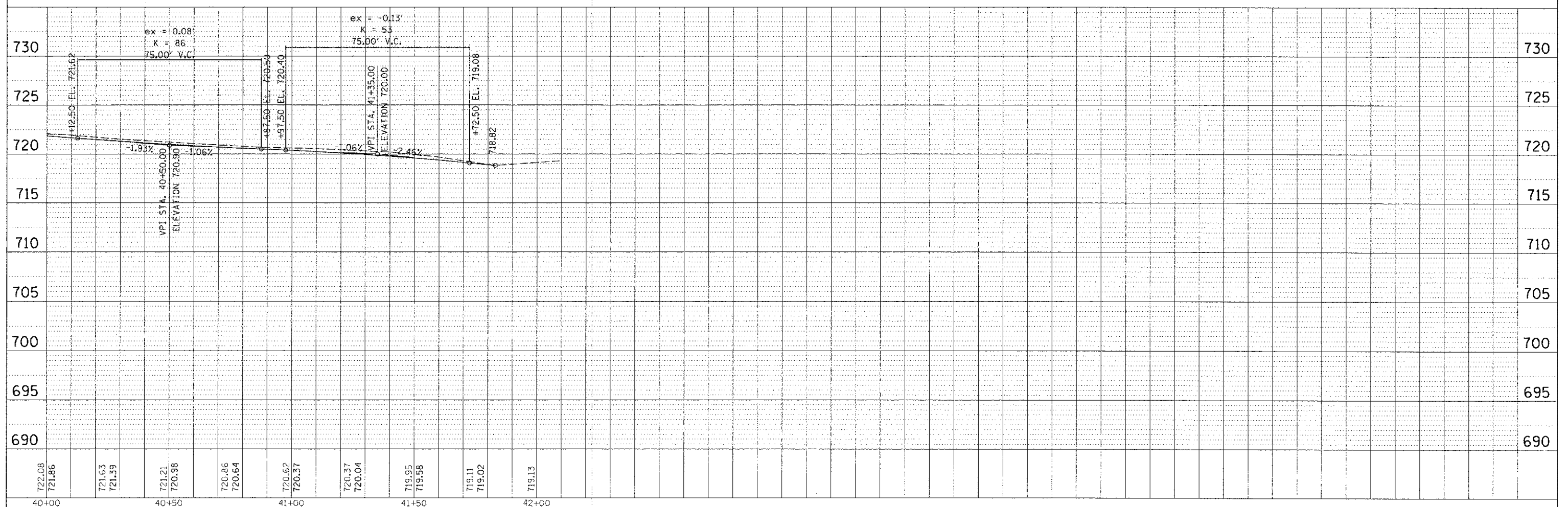

722.08 721.86	721.63 721.39	721.21 720.98	720.86 720.64	720.62 720.37	720.37 720.04	719.95 719.58	719.11 719.02	719.13
40+00	40+50	41+00	41+50	42+00				

CHRISTOPHER B. BURKE
ENGINEERING, LTD.
1938 E. Lincoln Highway, Suite 121
New Lenox, Illinois 60451
(815) 463-9050

USER NAME = masonpc	DESIGNED <i>CJM</i>	REVISED -
PLLOT SCALE = 2"	DRAWN <i>MAK</i>	REVISED -
PLLOT DATE = 1/3/2013	CHECKED <i>DV</i>	REVISED -
	DATE -	REVISED -

STATE OF ILLINOIS
DEPARTMENT OF TRANSPORTATION

ROADWAY PLAN AND PROFILE
HAVEN AVENUE

SCALE: 1" = 20' SHEET 17 OF 59 SHEETS STA. 40+00.00 TO STA. 42+00.00

F.A.U. R.T.E. 1037	SECTION 10-00024-00-FP	COUNTY COOK	TOTAL SHEETS 59	SHEET NO. 17
CONTRACT NO. 63773				ILLINOIS FED. AID PROJECT