

**NORTH EDGE OF SHOULDER**

Location	Station	Offset	Theoretical Grade Elevations
W. End of West Appr. Slab	17+36.74	-16.00	678.15
A1	17+46.74	-16.00	678.47
A2	17+56.74	-16.00	678.75
E. End of West Appr. Slab	17+66.74	-16.00	679.00

**NORTH EDGE OF ROADWAY**

Location	Station	Offset	Theoretical Grade Elevations
W. End of West Appr. Slab	17+38.19	-12.00	678.26
A1	17+48.19	-12.00	678.57
A2	17+58.19	-12.00	678.85
E. End of West Appr. Slab	17+68.19	-12.00	679.10

**℄ FULLERTON AVENUE & P.G.L.**

Location	Station	Offset	Theoretical Grade Elevations
W. End of West Appr. Slab	17+42.56	00.00	678.59
A1	17+52.56	00.00	678.88
A2	17+62.56	00.00	679.15
E. End of West Appr. Slab	17+72.56	00.00	679.39

**SOUTH EDGE OF ROADWAY**

Location	Station	Offset	Theoretical Grade Elevations
W. End of West Appr. Slab	17+46.93	12.00	678.53
A1	17+56.93	12.00	678.82
A2	17+66.93	12.00	679.07
E. End of West Appr. Slab	17+76.93	12.00	679.29

**SOUTH EDGE OF SHOULDER**

Location	Station	Offset	Theoretical Grade Elevations
W. End of West Appr. Slab	17+48.38	16.00	678.51
A1	17+58.38	16.00	678.79
A2	17+68.38	16.00	679.04
E. End of West Appr. Slab	17+78.38	16.00	679.26

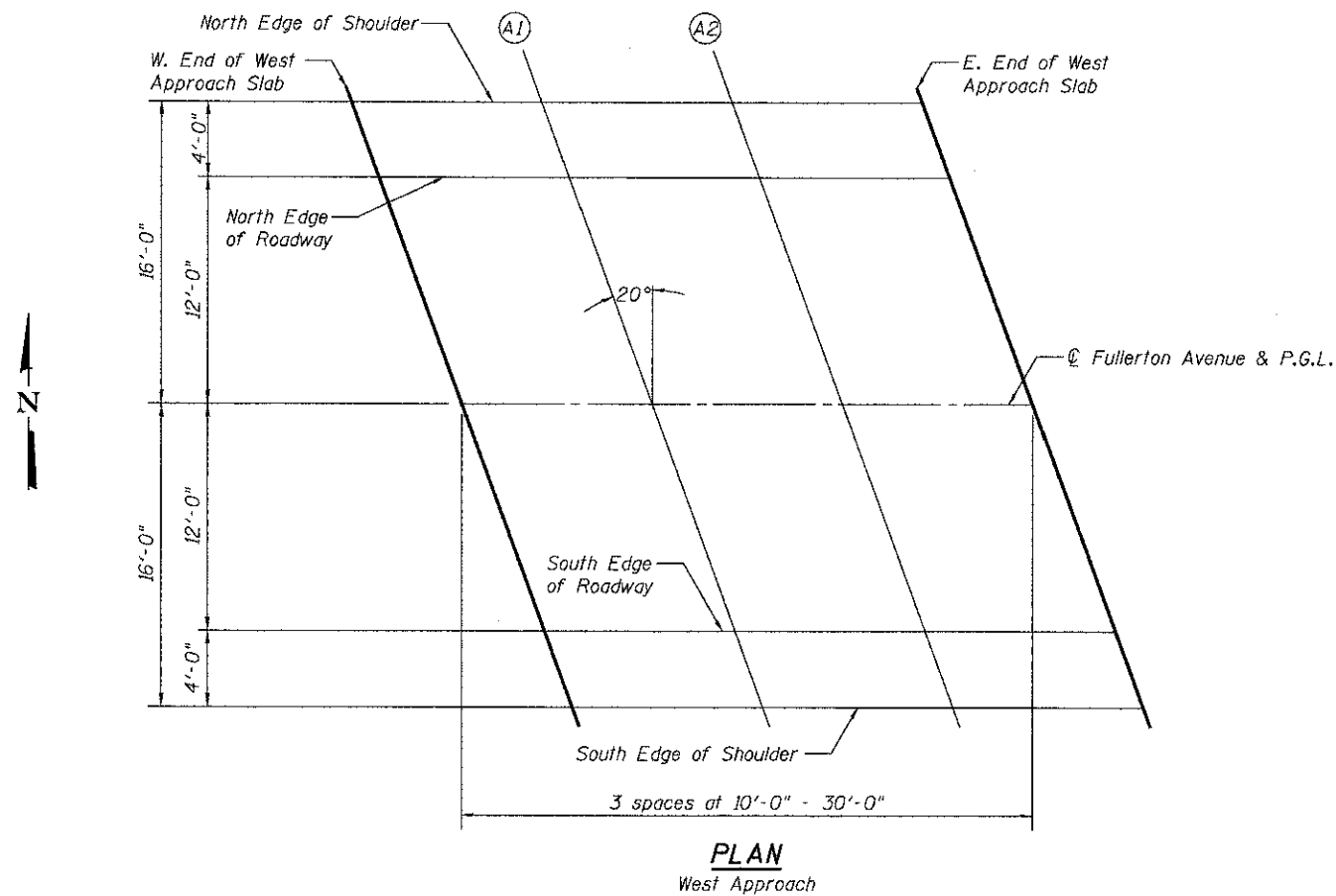

**PLAN**  
West Approach



USER NAME =	DESIGNED - RJP	REVISED
	CHECKED - MJT	REVISED
PLOT SCALE =	DRAWN - JTF	REVISED
PLOT DATE =	CHECKED - MJT	REVISED

**STATE OF ILLINOIS**  
**DEPARTMENT OF TRANSPORTATION**

**TOP OF WEST APPROACH SLAB ELEVATIONS**  
**STRUCTURE NO. 022-3041**

SHEET NO. 7 OF 18 SHEETS

F.A.P. RTE.	SECTION	COUNTY	TOTAL SHEETS	SHEET NO.
	08-01120-00-BR	DUPAGE	28	23
CONTRACT NO. 63785				
ILLINOIS FED. AID PROJECT				