

55100500 STORM SEWER REMOVAL - 12"

STA. 262+49.74 TO 263+80.88 - 132.0'
 STA. 263+78.18 TO 263+80.88 - 18.0'
 STA. 263+87.22 TO 263+80.88 - 58.0'
 STA. 264+06.14 TO 263+80.88 - 29.0'
 STA. 264+24.77 TO 263+80.88 - 42.0'
 STA. 266+63.80 TO 264+24.77 - 237.0'
 STA. 266+64.44 TO 266+63.80 - 18.0'
 STA. 266+91.11 TO 266+63.80 - 34.0'
 STA. 266+52.56 TO 266+63.80 - 41.0'
 TOTAL - 609.0'

REMOVAL LIMITS
 STA. 14002+45.0

44000600 SIDEWALK REMOVAL

STA. 262+49.96 TO 263+73.13, LT - 759.1
 STA. 263+70.41 TO 263+79.79, LT - 338.8
 STA. 263+80.98 TO 263+89.35, LT - 341.2
 STA. 263+91.19 TO 263+96.35, LT - 211.6
 STA. 264+33.61 TO 264+26.18, LT - 211.0
 STA. 264+27.53 TO 264+18.95, LT - 400.5
 STA. 264+17.21 TO 264+12.18, LT - 219.3
 STA. 264+08.79 TO 264+91.55, LT - 423.3
 STA. 265+02.25 TO 266+58.69, LT - 985.6
 TOTAL - 3890.4 SQ FT

44000600 SIDEWALK REMOVAL

STA. 266+57.42 TO 266+58.25, LT - 390.4
 STA. 266+58.31 TO 266+58.37, LT - 287.9
 STA. 266+58.36 TO 266+59.01, LT - 171.6
 STA. 267+00.88 TO 267+00.48, LT - 168.8
 STA. 267+00.48 TO 267+00.58, LT - 201.1
 STA. 267+00.31 TO 266+99.70, LT - 379.2
 STA. 266+97.33 TO 267+99.12, LT - 795.6
 STA. 268+09.21 TO 268+37.61, LT - 128.2
 TOTAL - 2522.3 SQ FT

Z0075496 CONCRETE RETAINING WALL REMOVAL LF

STA. 263+07.00 TO 263+69.00 - 55.0'
 STA. 265+97.00 TO 265+97.00 - 55.0'
 STA. 267+06.00 TO 267+60.00 - 150.0'
 TOTAL - 260.0 LF

NOTE:
 SEE SHEET EX-1 FOR REMOVAL NOTES.



60500060 REMOVING INLETS

263+78.18, 26.9 LT
 264+06.14, 24.0 LT
 264+24.77, 4.5 LT
 266+64.44, 15.6 LT
 266+93.11, 15.3 LT
 266+52.56, 44.9 RT
 TOTAL - 6 EACH

60500040 REMOVING MANHOLES

263+80.88, 8.0 LT
 266+63.80, 4.5 LT
 TOTAL - 2 EACH

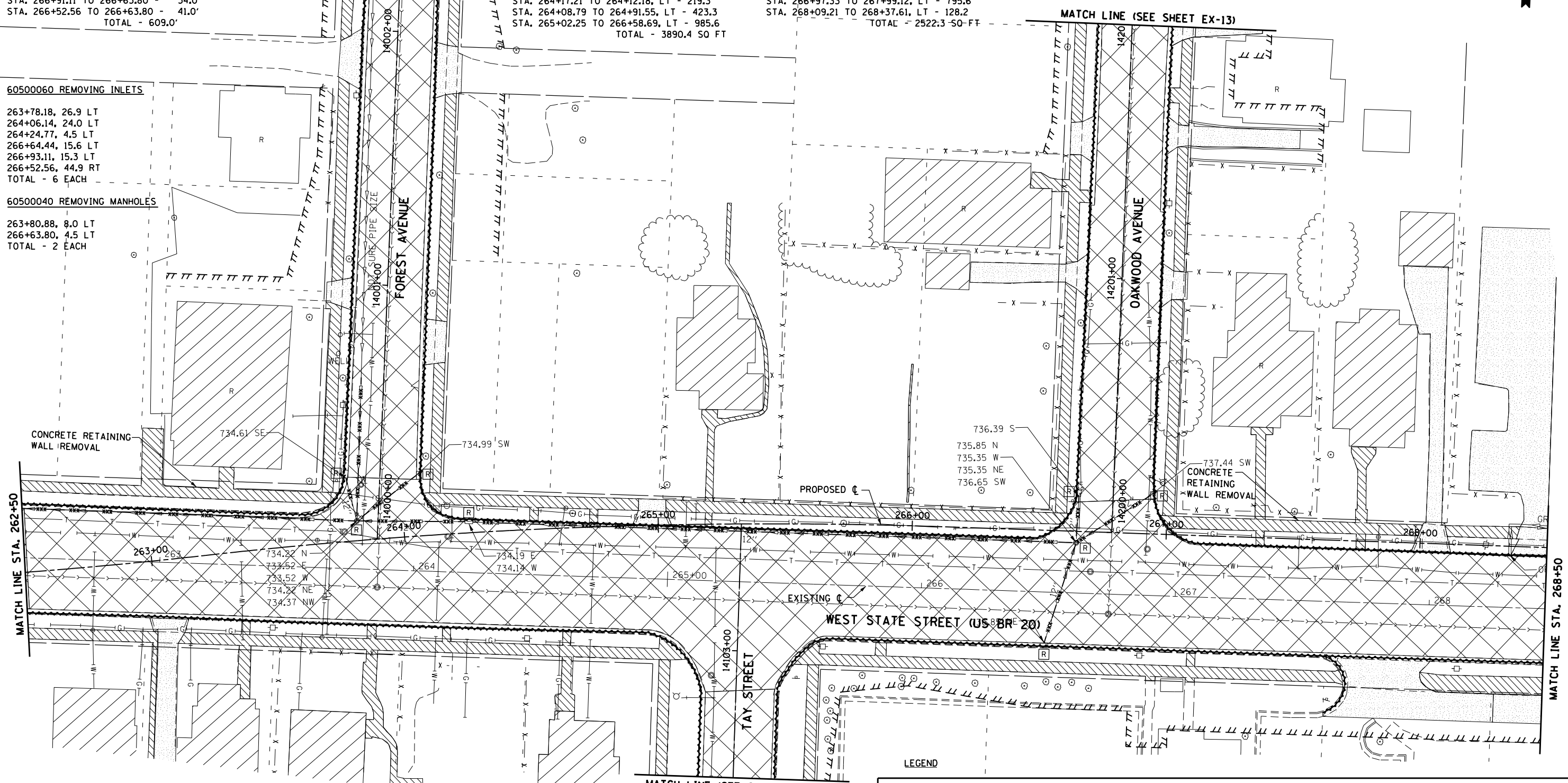

44000500 COMBINATION CURB AND GUTTER REMOVAL

STA. 262+48.77 TO 265+13.28, RT - 310.6'
 STA. 265+44.80 TO 268+49.11, RT - 346.4'
 STA. 267+63.14 TO 267+63.14, RT - 29.4'
 STA. 262+49.78 TO 264+02.89, LT - 355.8'
 STA. 264+27.19 TO 266+65.42, LT - 682.5'
 STA. 266+94.65 TO 268+49.11, LT - 350.0'
 TOTAL - 2074.7'

44000600 SIDEWALK REMOVAL (SF)

STA. 262+48.58 TO 262+96.84, RT - 429.2
 STA. 263+07.63 TO 265+08.13, RT - 1772.8
 STA. 265+00.49 TO 264+98.07, RT - 198.5
 STA. 265+59.13 TO 265+60.54, RT - 200.7
 STA. 265+55.21 TO 267+70.08, RT - 1,025.1
 STA. 268+01.35 TO 268+49.11, RT - 322.3
 TOTAL - 3948.6 SQ FT

44000100 PAVEMENT REMOVAL

STA. 262+50 TO 268+50 - 2936.8
 STA. 14000+24 TO 14002+45 - 635.4
 STA. 14102+50 TO 14102+85 - 103.6
 STA. 14200+12 TO 12202+00 - 587.1
 TOTAL - 4231.1 SQ FT

LEGEND

	TEMPORARY CONSTRUCTION EASEMENT	[R]	STRUCTURE TO BE REMOVED	[Hatched]	SIDEWALK REMOVAL
---	EXISTING R.O.W.	[REC]	STRUCTURE TO BE RECONSTRUCTED	[Hatched]	CONCRETE REMOVAL
- - -	PROPOSED R.O.W.	[X]	PAVEMENT REMOVAL	[Hatched]	BITUMINOUS REMOVAL
- xxx - xxx -	STORM SEWER REMOVAL	[Shaded]	DRIVEWAY PAVEMENT REMOVAL	[Hatched]	BARRIER CURB REMOVAL
[A]	STRUCTURE TO BE ADJUSTED	[Wavy]	COMBINATION CONCRETE CURB AND GUTTER REMOVAL	[Hatched]	BUILDING TO BE REMOVED (BY OTHERS)

McDonough Associates Inc.
 Engineers / Architects
 130 East Randolph Street, Chicago, Illinois 60601

FILE NAME =	USER NAME = dosddd	DESIGNED - JWM	REVISED -
et:\pw\work\p1dot\dosddd\0317613\026478	0-sht-rem052.dgn	DRAWN - JPF	REVISED -
	PLOT SCALE = 48.0000' / in.	CHECKED - RCH	REVISED -
	PLOT DATE = Mon Dec 17 13:27:47 2012	DATE - \$SUBDATE\$	REVISED -

**STATE OF ILLINOIS
 DEPARTMENT OF TRANSPORTATION**

EXISTING REMOVAL PLAN WEST STATE STREET (US BUS 20)	
SCALE:	SHEET NO. 5 OF 18 SHEETS STA. 262+50 TO STA. 268+50

F.A.P. RTE.	SECTION	COUNTY	TOTAL SHEETS	SHEET NO.
303	41R	WINNEBAGO	327	52
FED. ROAD DIST. NO. 2 ILLINOIS FED. AID PROJECT			CONTRACT NO. 64750	