

NOTE:
SEE SHEET EX-1 FOR REMOVAL NOTES.

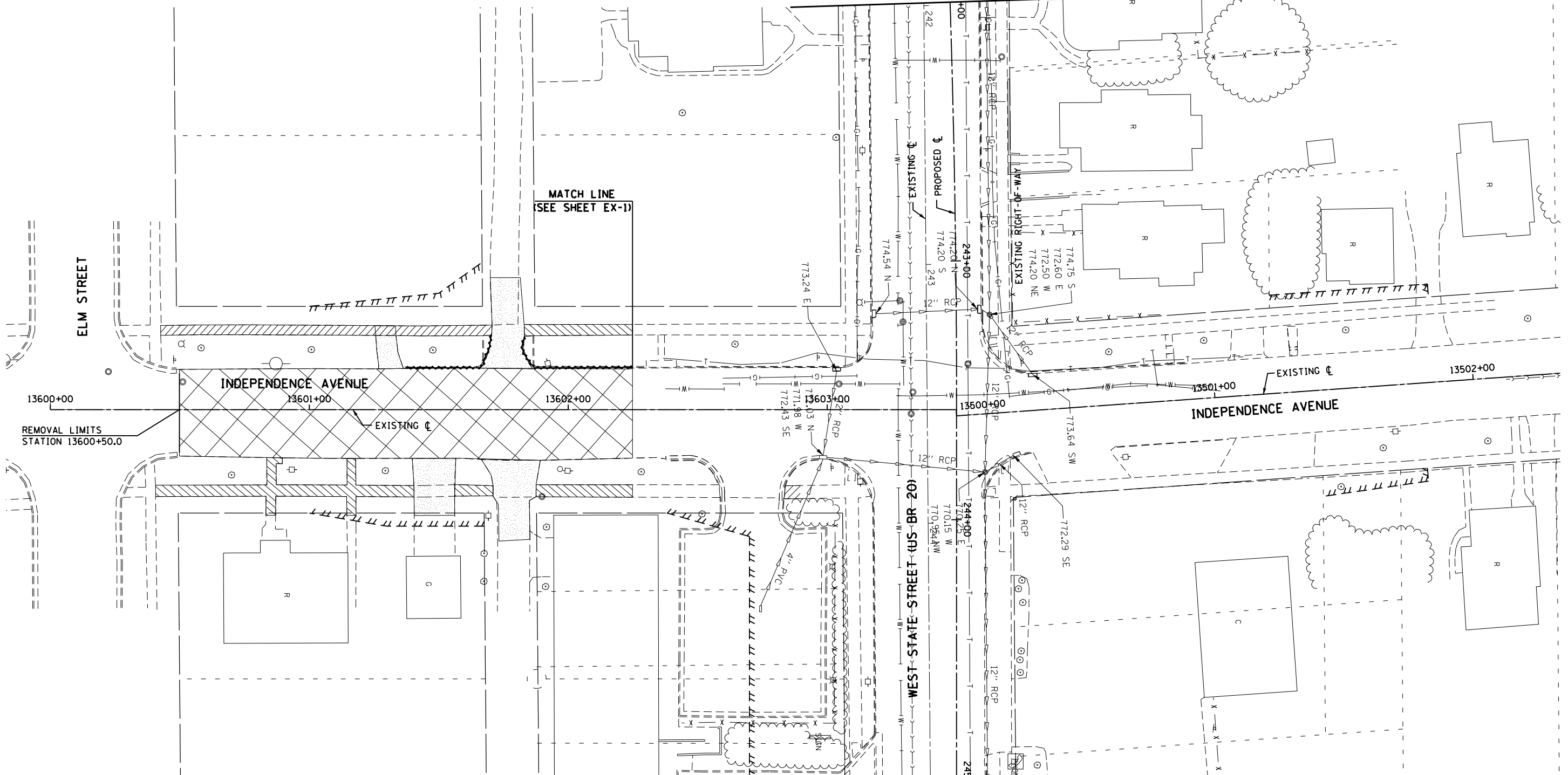

FOR CONTINUATION SEE SHEET EX-1



FOR CONTINUATION SEE SHEET EX-2

LEGEND

///	TEMPORARY CONSTRUCTION EASEMENT	[R]	STRUCTURE TO BE REMOVED	[Hatched]	SIDWALK REMOVAL
---	EXISTING R.O.W.	[REC]	STRUCTURE TO BE RECONSTRUCTED	[Hatched]	CONCRETE REMOVAL
- - -	PROPOSED R.O.W.	[X]	PAVEMENT REMOVAL	[Hatched]	BITUMINOUS REMOVAL
- xxx - xxx -	STORM SEWER REMOVAL	[Dotted]	DRIVEWAY PAVEMENT REMOVAL	[Hatched]	BARRIER CURB REMOVAL
[A]	STRUCTURE TO BE ADJUSTED	[Wavy]	COMBINATION CONCRETE CURB AND GUTTER REMOVAL	[Hatched]	BUILDING TO BE REMOVED (BY OTHERS)

44000100 PAVEMENT REMOVAL	44000600 SIDEWALK REMOVAL
STA. 13600+50 TO 13600+25 - 673.7 TOTAL - 673.7 SO YD	STA. 13600+42.59 TO 13601+70.56, LT - 489.6 STA. 13601+83.00 TO 13602+24.84, LT - 177.4 STA. 13600+40.61 TO 13601+40.42, RT - 572.6 STA. 13601+56.10 TO 13601+70.96, RT - 62.2 STA. 13601+87.60 TO 13602+24.84, RT - 175.7 TOTAL - 1477.5 SO FT
44000500 COMBINATION CURB AND GUTTER REMOVAL	
STA. 13601+37.30 TO 13601+67.46, LT - 42.4' STA. 13601+86.87 TO 13602+69.96, LT - 51.8' TOTAL - 94.2'	

McDonough Associates Inc.
 Engineers / Architects
 130 East Randolph Street, Chicago, Illinois 60601

FILE NAME =	USER NAME = dosddd	DESIGNED - JWM	REVISED -
et:\pw\work\p\dot\d\dosddd\d0317613\0264750-sht-rem056.dgn		DRAWN - JPF	REVISED -
		CHECKED - RCH	REVISED -
		DATE - \$SUBDATE\$	REVISED -

STATE OF ILLINOIS
DEPARTMENT OF TRANSPORTATION

EXISTING REMOVAL PLAN
INDEPENDANCE AVENUE

SCALE: SHEET NO. 9 OF 18 SHEETS STA. 13600+50 TO STA. 13602+25

F.A.P. RTE.	SECTION	COUNTY	TOTAL SHEETS	SHEET NO.
303	41R	WINNEBAGO	327	56
CONTRACT NO. 64750			FED. ROAD DIST. NO. 2 ILLINOIS FED. AID PROJECT	