

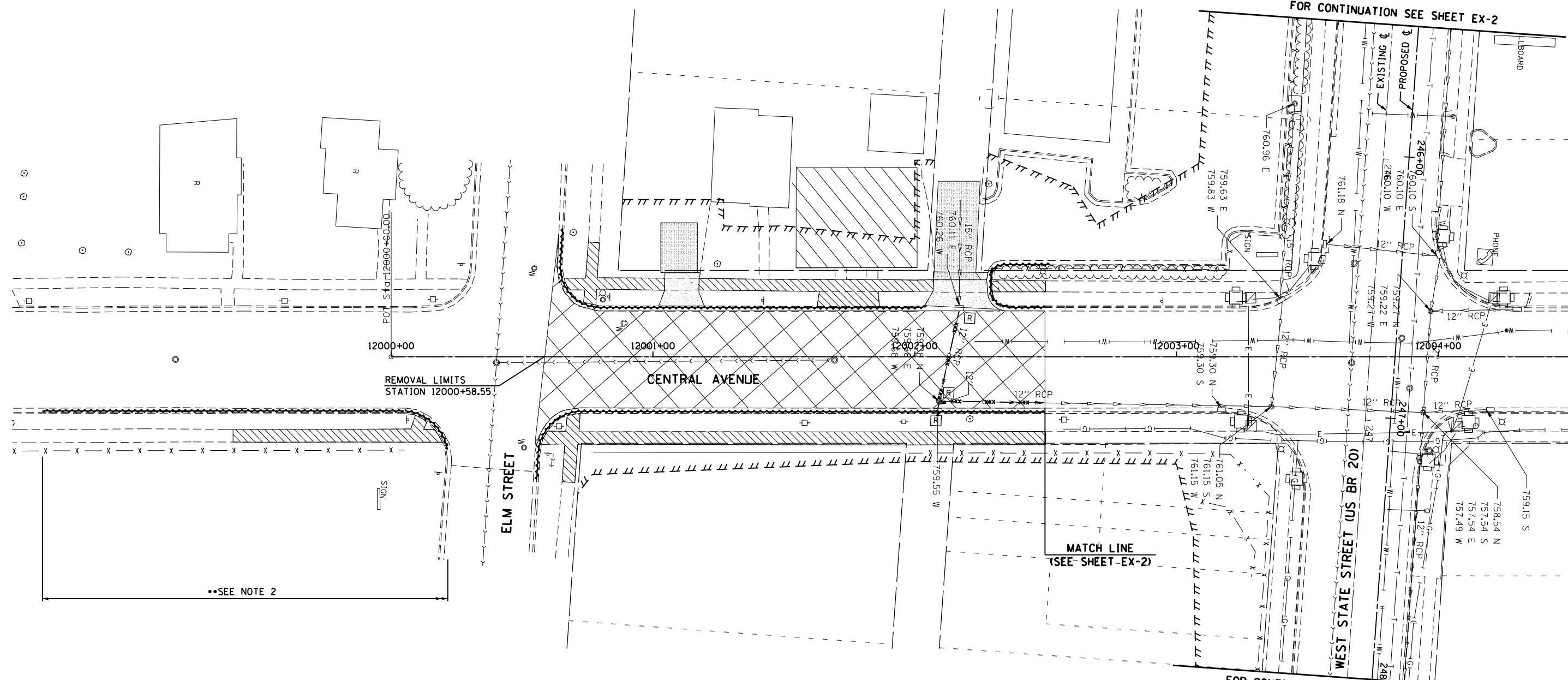

FOR CONTINUATION SEE SHEET EX-2



FOR CONTINUATION SEE SHEET EX-2

FOR CONTINUATION SEE SHEET EX-2

44000600 SIDEWALK REMOVAL
 STA. 11999+39.59 TO 12000+19.59, RT - 409.8
 STA. 12000+67.16 TO 12001+04.64, LT - 250.8
 STA. 12001+17.60 TO 12002+07.28, LT - 540.6
 STA. 12002+29.61 TO 12002+50.21, LT - 90.6
 STA. 12000+58.56 TO 12002+50.23, RT - 1,045.8
 TOTAL - 2337.6 SO FT

44000100 PAVEMENT REMOVAL
 STA. 12000+58 TO 12002+50 - 804.8 SO YD
 TOTAL - 804.8 SO YD

55100500 STORM SEWER REMOVAL - 12"
 STA. 12002+17.24 TO 12002+09.46 - 36.0'
 STA. 12002+09.05 TO 12002+09.46 - 3.0'
 STA. 12002+09.46 TO 12002+50.21 - 40.0'
 TOTAL - 79.0'

60500060 REMOVING INLETS
 12002+17.24, 19.4 LT
 12002+09.05, 19.4 RT
 TOTAL - 2 EACH

44000500 COMBINATION CURB AND GUTTER REMOVAL
 STA. 11998+66.78 TO 12000+21.63, RT - 162.5'
 STA. 12000+65.70 TO 12002+04.31, LT - 163.7'
 STA. 12002+29.21 TO 12002+04.31, LT - 55.2'
 STA. 12000+55.80 TO 12002+50.21, RT - 212.7'
 TOTAL - 594.1'

60500040 REMOVING MANHOLES
 12002+09.46, 16.1 RT
 TOTAL - 1 EACH

MANHOLE TO BE ADJUSTED
 246+78.76, 7.0 RT
 TOTAL - 1 EACH

NOTE:
 1. SEE SHEET EX-1 FOR REMOVAL NOTES.
 2. ALL ITEMS BEYOND THE IMPROVEMENT LIMITS REMOVED FOR TEMPORARY PAVEMENT INSTALLATION INCLUDING BUT NOT LIMITED TO: SIDEWALK, DRIVEWAYS, AND CURB & GUTTER, SHALL BE REPLACED IN KIND UPON TEMPORARY PAVEMENT REMOVAL. THE COST SHALL BE INCLUDED IN THE TEMPORARY PAVEMENT REMOVAL. SEE MOT PRE-STAGE SHEETS FOR ADDITIONAL REMOVAL ITEMS.

LEGEND

///	TEMPORARY CONSTRUCTION EASEMENT	[R]	STRUCTURE TO BE REMOVED	[Hatched]	SIDEWALK REMOVAL
---	EXISTING R.O.W.	[REC]	STRUCTURE TO BE RECONSTRUCTED	[Hatched]	CONCRETE REMOVAL
- - -	PROPOSED R.O.W.	[X]	PAVEMENT REMOVAL	[Hatched]	BITUMINOUS REMOVAL
- xxx - xxx -	STORM SEWER REMOVAL	[Shaded]	DRIVEWAY PAVEMENT REMOVAL	[Hatched]	BARRIER CURB REMOVAL
[A]	STRUCTURE TO BE ADJUSTED	[Wavy]	COMBINATION CONCRETE CURB AND GUTTER REMOVAL	[Hatched]	BUILDING TO BE REMOVED (BY OTHERS)

McDonough Associates Inc.
 Engineers / Architects
 130 East Randolph Street, Chicago, Illinois 60601

FILE NAME =	USER NAME = dosddd	DESIGNED - JWM	REVISED -
ei:\pw_work\p\dot\dosddd\0317613\0264750-sht-rem057.dgn		DRAWN - JPF	REVISED -
		CHECKED - RCH	REVISED -
		DATE - \$SUBDATE\$	REVISED -

STATE OF ILLINOIS
 DEPARTMENT OF TRANSPORTATION

EXISTING REMOVAL PLAN
 CENTRAL AVENUE
 SCALE: SHEET NO. 10 OF 18 SHEETS STA.12000+58.55 TO STA. 12000+50

F.A.P. RTE.	SECTION	COUNTY	TOTAL SHEETS	SHEET NO.
303	41R	WINNEBAGO	327	57
CONTRACT NO. 64750			FED. ROAD DIST. NO. 2 ILLINOIS FED. AID PROJECT	