

NOTE:

1. SEE SHEET EX-1 FOR REMOVAL NOTES.

2. ALL ITEMS BEYOND THE IMPROVEMENT LIMITS REMOVED FOR TEMPORARY PAVEMENT INSTALLATION INCLUDING BUT NOT LIMITED TO: SIDEWALK, DRIVEWAYS, AND CURB & GUTTER, SHALL BE REPLACED IN KIND UPON TEMPORARY PAVEMENT REMOVAL. THE COST SHALL BE INCLUDED IN THE TEMPORARY PAVEMENT REMOVAL. SEE MOT PRE-STAGE SHEETS FOR ADDITIONAL REMOVAL ITEMS.

••SEE NOTE 2

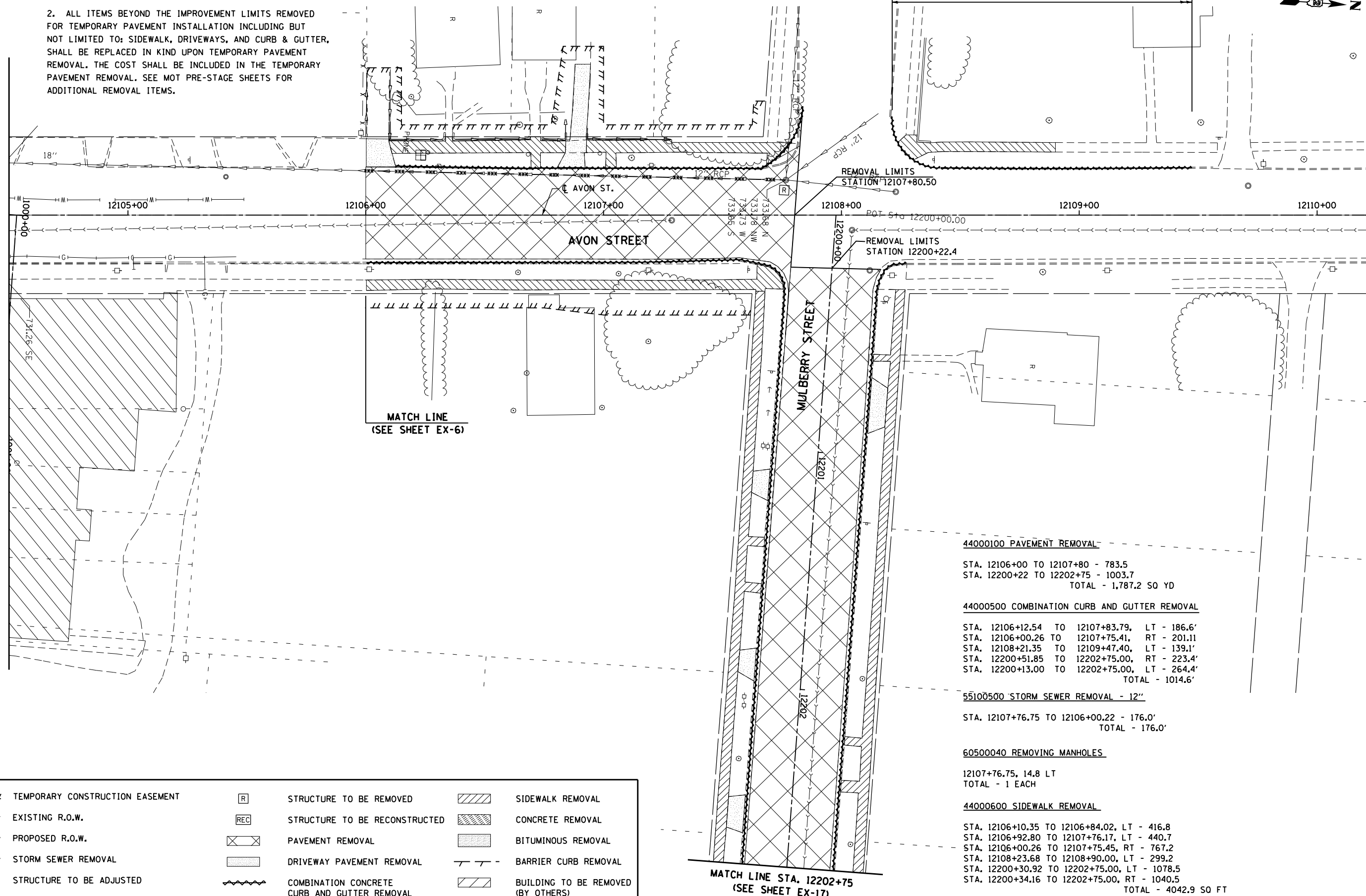

44000100 PAVEMENT REMOVAL	
STA. 12106+00 TO 12107+80	- 783.5
STA. 12200+22 TO 12202+75	- 1003.7
TOTAL - 1,787.2 SQ YD	
44000500 COMBINATION CURB AND GUTTER REMOVAL	
STA. 12106+12.54 TO 12107+83.79	LT - 186.6'
STA. 12106+00.26 TO 12107+75.41	RT - 201.11
STA. 12108+21.35 TO 12109+47.40	LT - 139.1'
STA. 12200+51.85 TO 12202+75.00	RT - 223.4'
STA. 12200+13.00 TO 12202+75.00	LT - 264.4'
TOTAL - 1014.6'	
55100500 STORM SEWER REMOVAL - 12"	
STA. 12107+76.75 TO 12106+00.22	- 176.0'
TOTAL - 176.0'	
60500040 REMOVING MANHOLES	
12107+76.75, 14.8 LT	
TOTAL - 1 EACH	
44000600 SIDEWALK REMOVAL	
STA. 12106+10.35 TO 12106+84.02	LT - 416.8
STA. 12106+92.80 TO 12107+76.17	LT - 440.7
STA. 12106+00.26 TO 12107+75.45	RT - 767.2
STA. 12108+23.68 TO 12108+90.00	LT - 299.2
STA. 12200+30.92 TO 12202+75.00	LT - 1078.5
STA. 12200+34.16 TO 12202+75.00	RT - 1040.5
TOTAL - 4042.9 SQ FT	

LEGEND

/// /// ///	TEMPORARY CONSTRUCTION EASEMENT	[R]	STRUCTURE TO BE REMOVED	[Hatched]	SIDEWALK REMOVAL
---	EXISTING R.O.W.	[REC]	STRUCTURE TO BE RECONSTRUCTED	[Hatched]	CONCRETE REMOVAL
- - - -	PROPOSED R.O.W.	[X]	PAVEMENT REMOVAL	[Hatched]	BITUMINOUS REMOVAL
- xxx - xxx -	STORM SEWER REMOVAL	[Dotted]	DRIVEWAY PAVEMENT REMOVAL	[Hatched]	BARRIER CURB REMOVAL
[A]	STRUCTURE TO BE ADJUSTED	[Wavy]	COMBINATION CONCRETE CURB AND GUTTER REMOVAL	[Hatched]	BUILDING TO BE REMOVED (BY OTHERS)

McDonough Associates Inc.
 Engineers / Architects
 130 East Randolph Street, Chicago, Illinois 60601

FILE NAME =	USER NAME = dosddd	DESIGNED - JWM	REVISED -
et:\pw\work\p\dot\dosddd\0317613\0264750-sht-rem063.dgn		DRAWN - JPF	REVISED -
		CHECKED - RCH	REVISED -
		DATE - \$SUBDATE\$	REVISED -

**STATE OF ILLINOIS
DEPARTMENT OF TRANSPORTATION**

**EXISTING REMOVAL PLAN
AVON STREET AND MULBERRY STREET**

SCALE: SHEET NO. 16 OF 18 SHEETS STA. 12106+00 TO STA. 12107+80.5

F.A.P. RTE.	SECTION	COUNTY	TOTAL SHEETS	SHEET NO.
303	41R	WINNEBAGO	327	63
CONTRACT NO. 64750			FED. ROAD DIST. NO. 2 ILLINOIS FED. AID PROJECT	