

TYPE II BARRICADES OR DRUMS WITH BI-DIRECTIONAL STEADY BURN LIGHTS AT 40' CENTERS, 20' IN TAPERS AND 10' IN RADII (TYP.)

PRE-STAGE AVON STREET
 STA. 12100+00 (ELM STREET) TO
 STA. 12104+00 (WEST STATE STREET)

TEMPORARY PAVEMENT & SUB-BASE DETAIL

FLEXIBLE PAVEMENT OPTION



- 2" HOT-MIX ASPHALT SURFACE COURSE, MIX "C", N50
- 2" HOT-MIX ASPHALT SURFACE COURSE, MIX "C", N50
- 12" GRANULAR MATERIAL, TYPE A

RIGID PAVEMENT OPTION

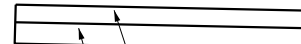

- 8" P.C.C. BASE COURSE
- 12" GRANULAR MATERIAL, TYPE A

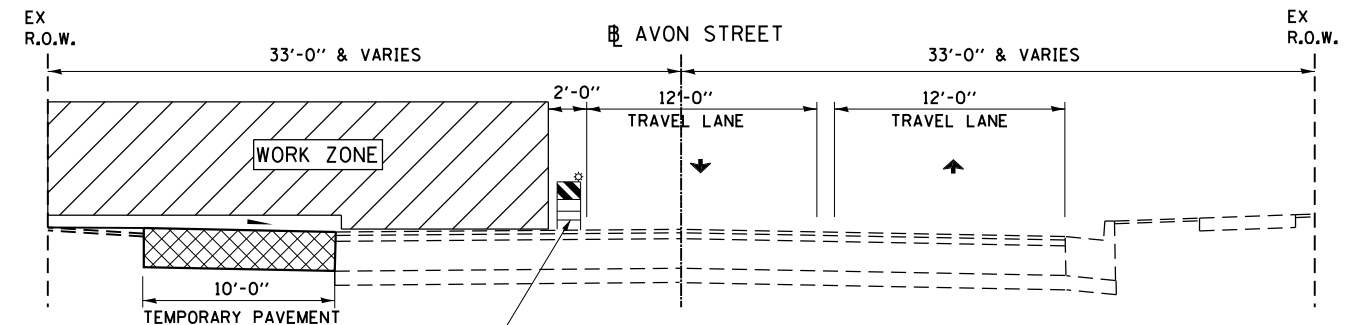

TYPE II BARRICADES OR DRUMS WITH BI-DIRECTIONAL STEADY BURN LIGHTS AT 40' CENTERS, 20' IN TAPERS AND 10' IN RADII (TYP.)

PRE-STAGE AVON STREET
 STA. 12104+00 (WEST STATE STREET) TO
 STA. 12108+00 (MULBERRY STREET)

TRAFFIC STAGING SEQUENCE NOTES

AVON STREET

PRE-STAGE

1. IMPLEMENT DETOUR PLAN.
2. CLOSE WEST STATE STREET.
3. REMOVE ALL THE TRAFFIC SIGNAL EQUIPMENTS INCLUDING MAST ARM POLES, FOUNDATION AND HANDHOLES.
4. ADJUST ALL THE EXISTING DRAINAGE INLETS WITH NEW FRAME AND GRATES.
5. POWER/LIGHT POLES TO BE RELOCATED BY OTHERS.
6. CONSTRUCT TEMPORARY PAVEMENT.
7. CONSTRUCT THE TEMPORARY PAVEMENT SLOPING TOWARDS THE EXISTING DRAINAGE STRUCTURES TO MAINTAIN POSITIVE DRAINAGE.

STAGE I

SHIFT TRAFFIC ONTO TEMPORARY PAVEMENT ON WEST SIDE OF AVON STREET:

1. CONSTRUCT NEW STORM SEWERS AND DRAINAGE STRUCTURES ON THE EAST SIDE OF AVON STREET.
2. RECONSTRUCT NB PAVEMENT, PART OF THE SB LANE AND CURB AND GUTTER WHILE THE EXIST. SIDEWALK REMAINS OPEN.
3. SET BARRICADES AS SHOWN FOR TEMPORARY SIDEWALK, AND CONSTRUCT NEW SIDEWALK ON THE EAST SIDE OF AVON STREET.

STAGE II

SHIFT TRAFFIC ONTO RECONSTRUCTED EAST SIDE OF AVON STREET:

1. COMPLETE CONSTRUCTION OF THE NEW STORM SEWER LATERALS AND DRAINAGE STRUCTURES.
2. RECONSTRUCT PAVEMENT ON SB LANE AND COMPLETE THE CONSTRUCTION OF THE LEFT-TURN LANE.
3. CONSTRUCT CURB AND GUTTER ON SB LANE.
4. CONSTRUCT NEW SIDEWALK ON THE WEST SIDE OF AVON STREET.
5. REMOVE/FILL EXISTING DRAINAGE STRUCTURES TO BE ABANDONED.

CONSTRUCTION TRAFFIC CONTROL GENERAL NOTES

1. THE WORK ZONE WILL BE DELINEATED AT ALL TIMES THROUGHOUT CONSTRUCTION BY TYPE II BARRICADES OR DRUMS WITH BI-DIRECTIONAL STEADY BURN LIGHTS. THE BARRICADES/DRUMS SHALL BE PLACED AT 40 FEET CENTERS. BARRICADES/DRUMS THAT MUST BE PLACED IN EXCAVATED AREAS SHALL HAVE LEG EXTENSIONS INSTALLED SUCH THAT THE TOP OF THE BARRICADE/DRUMS IS IN COMPLIANCE WITH THE HEIGHT REQUIREMENTS OF STANDARD 701901 IN AREAS OPEN TO TRAFFIC.
2. OPPOSING LANES OF TRAFFIC WILL BE DELINEATED AT ALL TIMES THROUGHOUT CONSTRUCTION BY TWO 4 INCHES YELLOW TEMPORARY PAVEMENT MARKING LINES AT 11 INCHES CENTERS.
3. EXISTING TRAFFIC SIGNS SHALL BE RELOCATED FOR EACH CONSTRUCTION STAGE AS REQUIRED AND AS DIRECTED BY THE ENGINEER.
4. ALL APPLICABLE PORTIONS OF TRAFFIC CONTROL STANDARDS 701311, 701501, 701701, 701801 AND 701901 SHALL APPLY DURING ALL STAGES AND ALL SUB STAGES THAT ARE NOT SPECIFIED.
5. A SINGLE LANE CLOSURE WITH FLAGMEN AT WORK ZONES WILL ONLY BE ALLOWED BETWEEN 9:00AM AND 3:00 PM.
6. THE CONTRACTOR SHALL BE RESPONSIBLE FOR ENSURING DRAINAGE OF THE ROADWAY DURING ALL STAGES OF CONSTRUCTION. THIS WORK SHALL BE INCLUDED IN THE COST OF TRAFFIC CONTROL FOR SIDE ROADS AND INTERSECTIONS.
7. THE CONTRACTOR SHALL INSTALL TEMPORARY PAVEMENT MARKING AS DIRECTED BY THE ENGINEER.

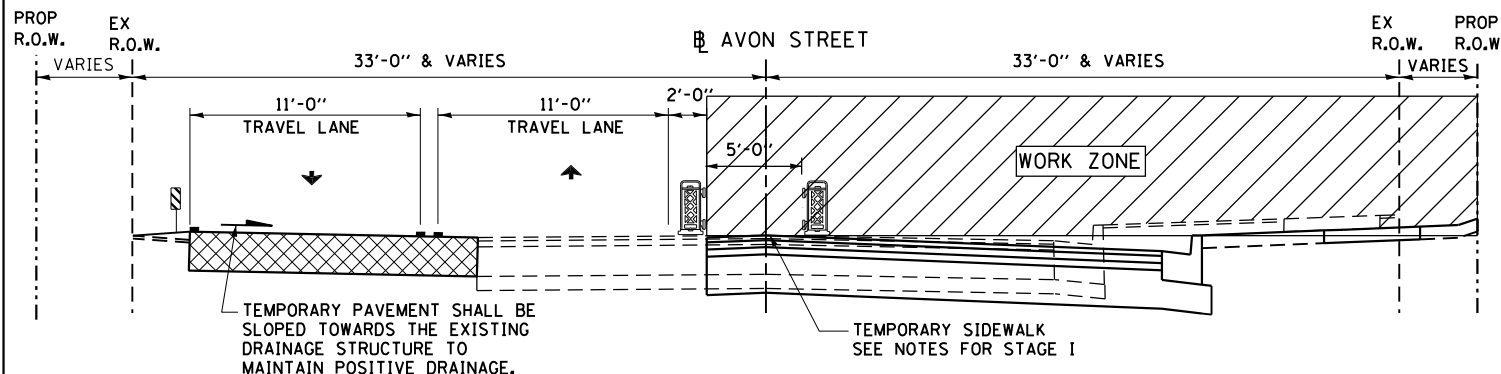

STAGE I - AVON STREET
 STA. 12100+00 (ELM STREET) TO
 STA. 12108+00 (MULBERRY STREET)

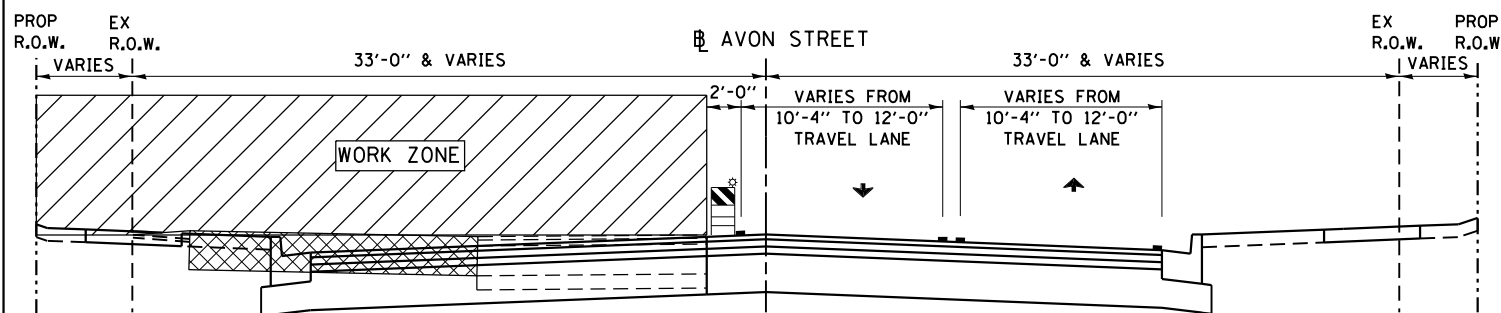

STAGE II - AVON STREET
 STA. 12100+00 (ELM STREET) TO
 STA. 12108+00 (MULBERRY STREET)

McDonough Associates Inc.
 Engineers / Architects
 130 East Randolph Street, Chicago, Illinois 60601

FILE NAME =	USER NAME = dossed	DESIGNED - BA	REVISED -
ei:\pw\work\p1dot\dossed\d0317617\026479	0-sht-stg-112-120.dgn	DRAWN - BA	REVISED -
	PLOT SCALE = 48.0000' / in.	CHECKED - DMB	REVISED -
	PLOT DATE = Mon Dec 17 14:15:31 2012	DATE - \$SUBDATE\$	REVISED -

STATE OF ILLINOIS
DEPARTMENT OF TRANSPORTATION

MAINTENANCE OF TRAFFIC - TYPICAL SECTIONS
AVON STREET

SCALE: SHEET NO. 3 OF 9 SHEETS STA. TO STA.

F.A.P. RTE.	SECTION	COUNTY	TOTAL SHEETS	SHEET NO.
303	41R	WINNEBAGO	327	114
FED. ROAD DIST. NO. 2 ILLINOIS FED. AID PROJECT			CONTRACT NO. 64750	