

WEST STATE ST (US BR 20) & SUNSET AVE INTERSECTION
NORTHWEST - SIDEWALK RAMP GRADES

POINT NO.	STATION	OFFSET	SIDE	ELEVATION
A	240+27.63	32.86	LT	784.35
B	240+17.45	32.90	LT	784.54
C	240+18.01	48.40	LT	785.78
D	240+11.95	48.42	LT	785.88
E	240+12.42	32.92	LT	784.64
F	240+12.41	29.26	LT	784.62
G	240+01.38	29.35	LT	785.44
H	240+01.23	24.93	LT	785.35
I	240+12.40	24.25	LT	784.51
J	240+12.38	19.14	LT	784.41

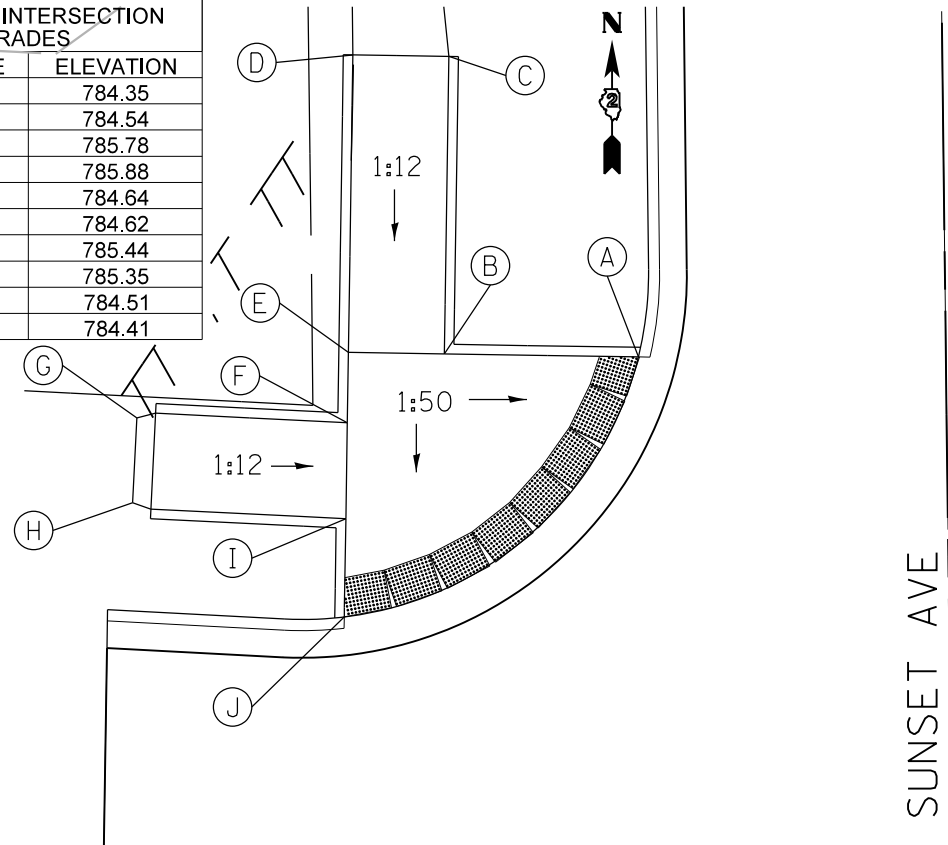

WEST STATE ST (US BR 20)

SUNSET AVE

WEST STATE ST (US BR 20) & SUNSET AVE INTERSECTION
NORTHEAST - SIDEWALK RAMP GRADES

POINT NO.	STATION	OFFSET	SIDE	ELEVATION
A	240+68.96	49.79	LT	784.48
B	240+76.52	51.84	LT	784.64
C	240+82.99	53.11	LT	785.18
D	240+88.44	53.84	LT	785.20
E	240+89.47	43.90	LT	785.00
F	240+84.56	43.24	LT	784.90
G	240+78.72	42.09	LT	784.40

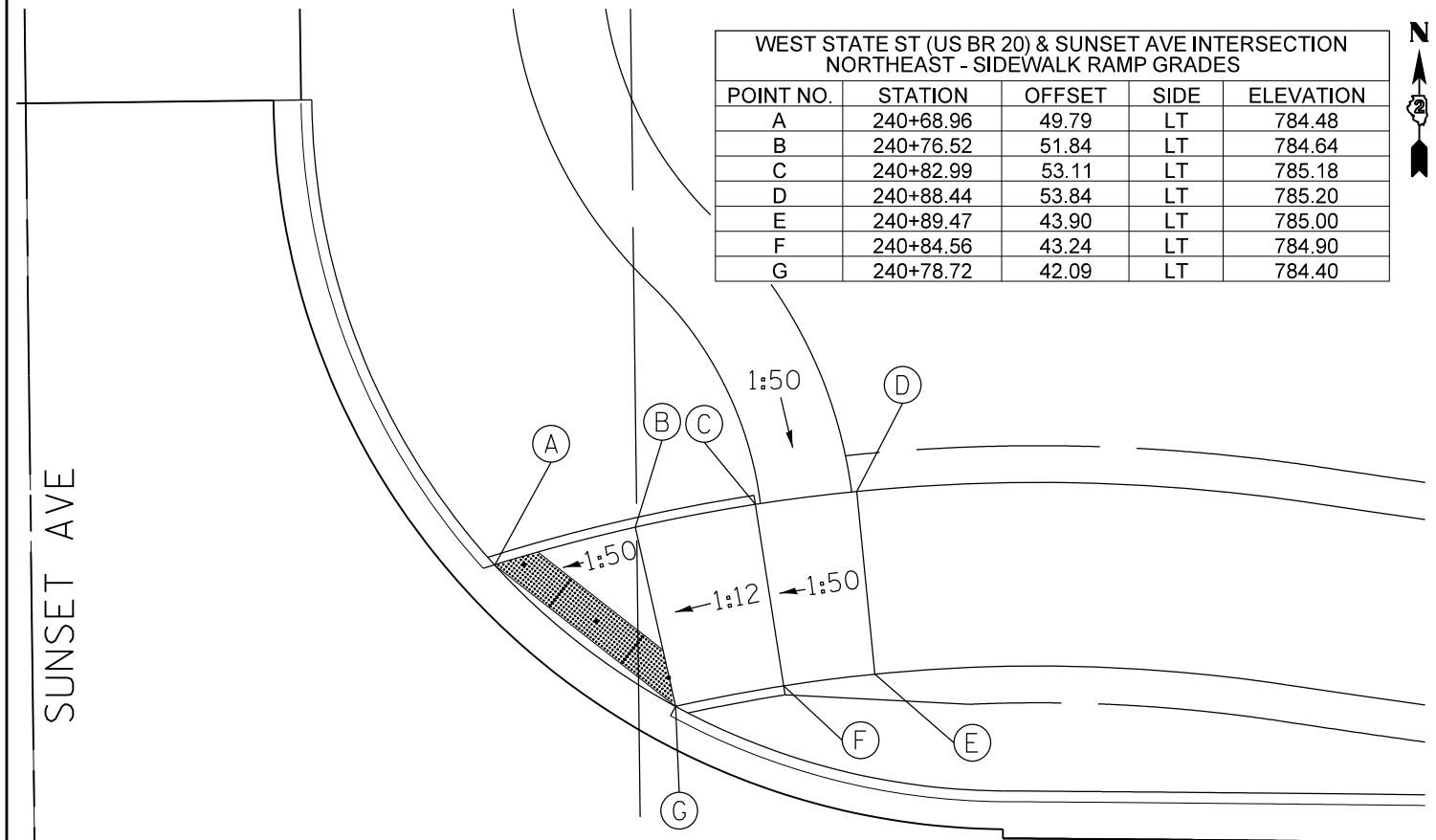

WEST STATE ST (US BR 20)

SUNSET AVE

WEST STATE ST (US BR 20)

SUNSET AVE
134

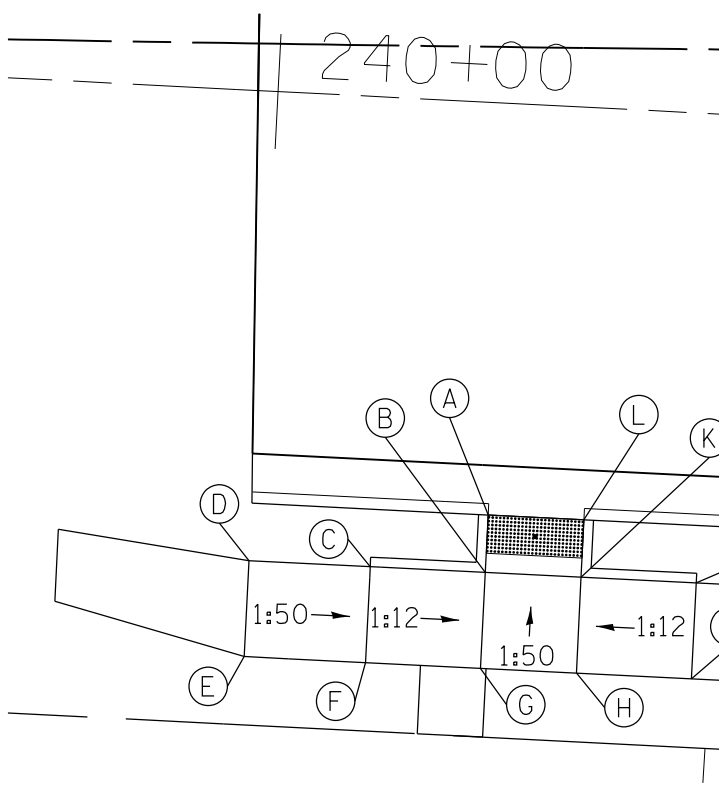

WEST STATE ST (US BR 20) & SUNSET AVE INTERSECTION
SOUTH SIDE CROSSWALK - SIDEWALK RAMP GRADES

POINT NO.	STATION	OFFSET	SIDE	ELEVATION
A	240+12.26	24.39	RT	784.12
B	240+12.15	27.39	RT	784.18
C	240+06.19	27.17	RT	784.67
D	239+99.90	26.95	RT	784.80
E	239+99.73	31.95	RT	784.89
F	240+06.01	32.17	RT	784.78
G	240+11.97	32.39	RT	784.28
H	240+16.94	32.57	RT	784.39
I	240+22.89	32.80	RT	784.88
J	240+23.09	27.81	RT	784.78
K	240+17.12	27.58	RT	784.29
L	240+17.24	24.58	RT	784.23

FILE NAME =	USER NAME = dossdd	DESIGNED -	REVISED -
es:\pwork\pwork\dot\dossdd\d0326838\01sabled_Ramps.dgn		DRAWN -	REVISED -
Default	PLOT SCALE = 10.0000' / in.	CHECKED -	REVISED -
	PLOT DATE = Mon Dec 17 15:41:50 2012	DATE -	REVISED -

STATE OF ILLINOIS
DEPARTMENT OF TRANSPORTATION

WEST STATE ST (US BR 20) AND SUNSET AVE
SIDEWALK RAMP DETAIL

SCALE: SHEET OF SHEETS STA. TO STA.

F.A.P. RTE.	SECTION	COUNTY	TOTAL SHEETS	SHEET NO.
303	41R	WINNEBAGO	327	186
CONTRACT NO. 64750				
ILLINOIS FED. AID PROJECT				