

SEE HEATH ST. DRAINAGE AND UTILITY SHEET FOR HEATH ST. PROPOSED STRUCTURES AND PIPES INFORMATION.

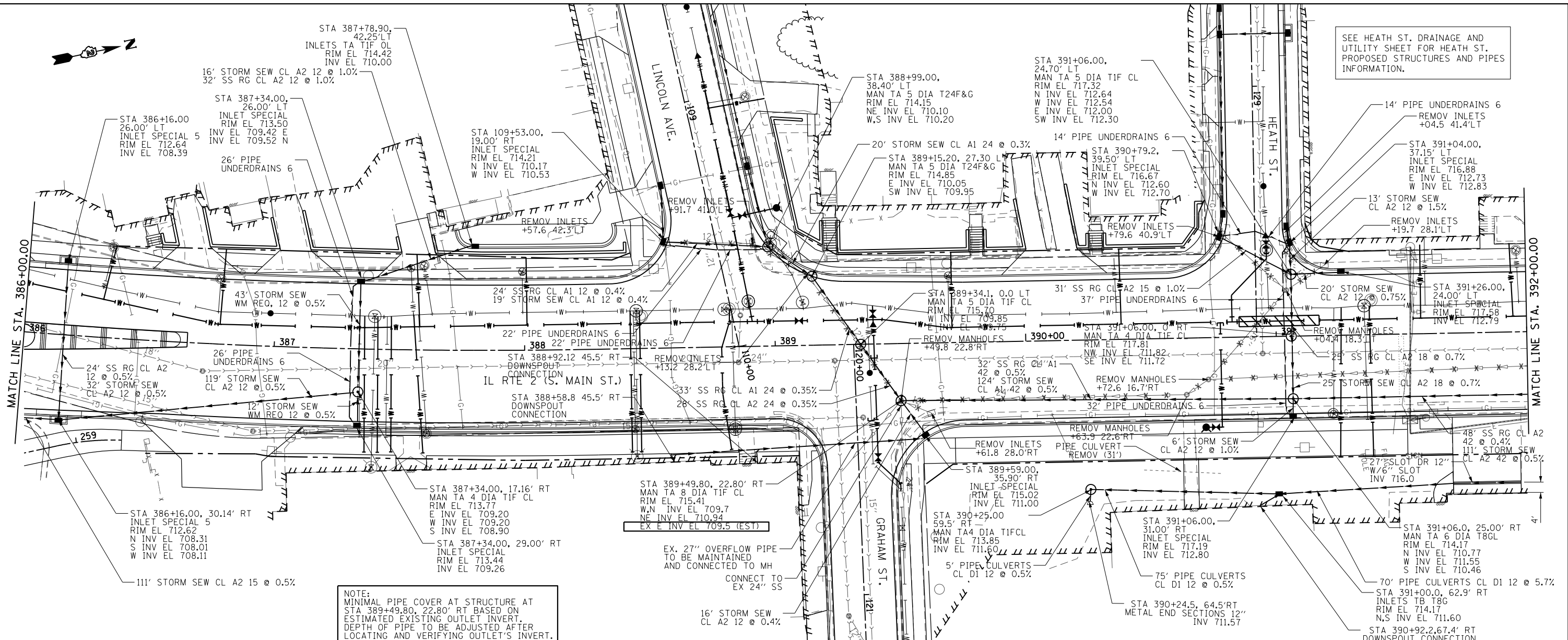

NOTE:  
MINIMAL PIPE COVER AT STRUCTURE AT STA 389+49.80, 22.80' RT BASED ON ESTIMATED EXISTING OUTLET INVERT. DEPTH OF PIPE TO BE ADJUSTED AFTER LOCATING AND VERIFYING OUTLET'S INVERT.

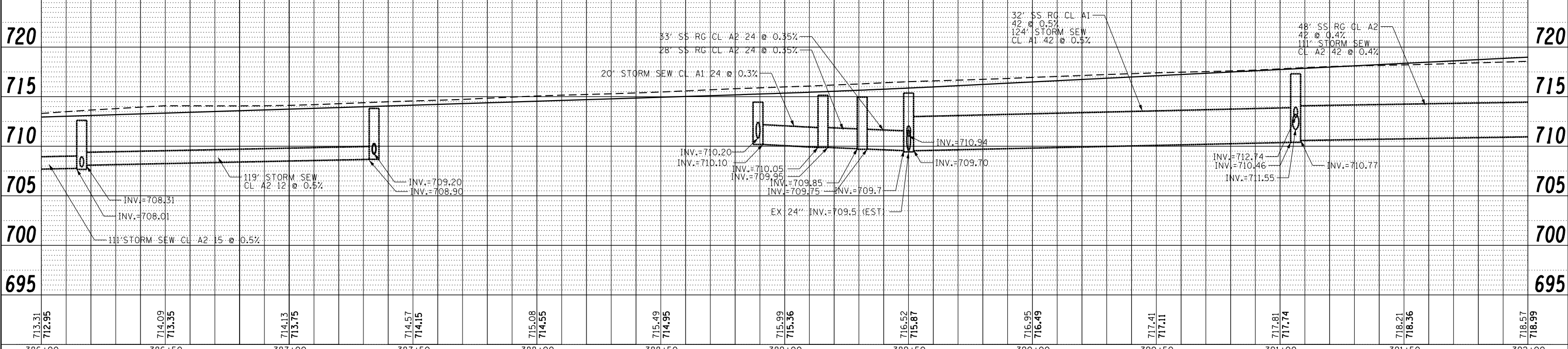

DATE	
BY	
PLAN	
SURVEYED	
PLOTTED	
NOTE BOOK	
CHECKED	
ALIGNMENT	
FILE NAME	
NO.	

DATE	
BY	
PROFILE	
SURVEYED	
PLOTTED	
NOTE BOOK	
CHECKED	
STRUCTURE	
NOTATIONS	
CHFD	

FILE NAME =	USER NAME = *USER*	DESIGNED -	REVISED -	<b>STATE OF ILLINOIS</b> <b>DEPARTMENT OF TRANSPORTATION</b>	<b>DRAINAGE AND UTILITY</b> <b>IL RTE 2</b>	F.A.P. R.E. =	SECTION	COUNTY	TOTAL SHEETS	SHEET NO.	
*FILEL*		DRAWN -	REVISED -			742	(32, 33) R-1	WINNEBAGO	705	308	
		CHECKED -	REVISED -			CONTRACT NO. 64821					
		DATE -	REVISED -			ILLINOIS FED. AID PROJECT					