

PLAN	SURVEYED	DATE
	PLOTTED	
	ALIGNED	
	CHECKED	
	DESIGNED	
	BY	
	NO.	

PROFILE	SURVEYED	DATE
	PLOTTED	
	GRADES CHECKED	
	STRUCTURE NOTATIONS CHECKED	
	BY	
	NO.	

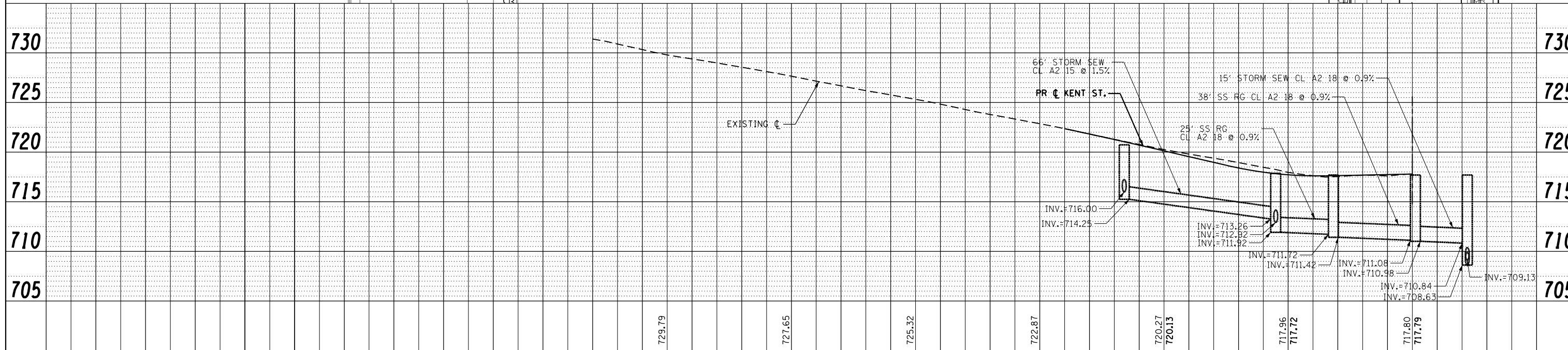
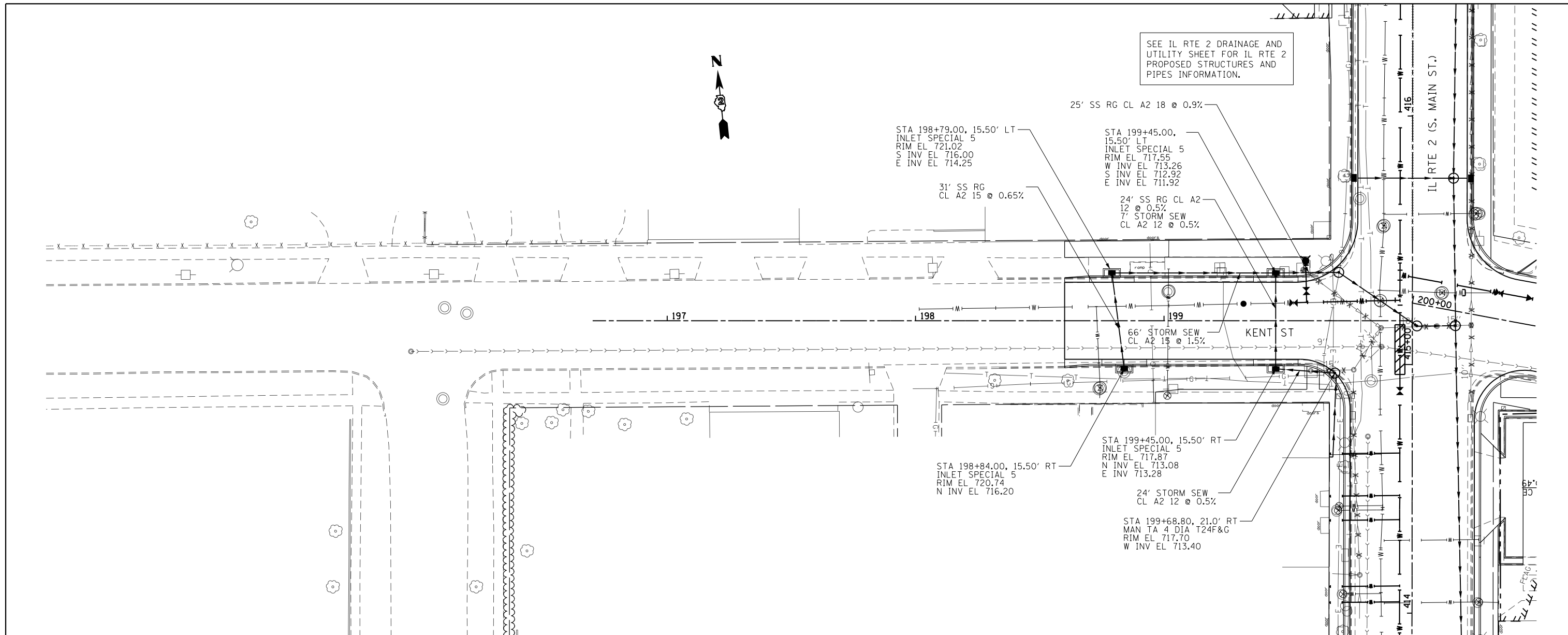

FILE NAME =	USER NAME = *USER*	DESIGNED -	REVISED -	<b>STATE OF ILLINOIS</b> <b>DEPARTMENT OF TRANSPORTATION</b>	<b>DRAINAGE AND UTILITY</b> <b>KENT ST.</b>			F.A.P. RTE. 742	SECTION (32, 33) R-1	COUNTY WINNEBAGO	TOTAL SHEETS 705	SHEET NO. 332
*FILEL*		DRAWN -	REVISED -		SCALE: 1:20	SHEET NO. 33 OF 35 SHEETS	STA. 196+70.00 TO STA. 200+00.00	CONTRACT NO. 64821		ILLINOIS FED. AID PROJECT		
		CHECKED -	REVISED -									
		DATE -	REVISED -									