

BENCHMARKS				
NO.	DESCRIPTION	STATION	OFFSET	ELEV.
NO. 1	RR SPIKE E. FACE OF P.P.	0+70	1' RT	713.15
	NW CORNER OGILBY / S. MAIN			

NOTE: THIS PLAN SHEET SHOWS EXISTING CONDITIONS ONLY. ALL REMOVALS NECESSARY TO COMPLETE THIS WORK ARE INCLUDED AS PART OF THE I.D.O.T. ROADWAY PLANS.

ROCK RIVER

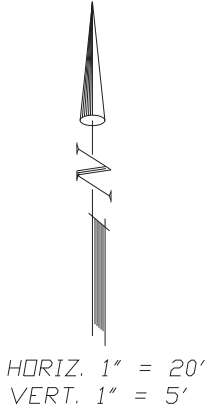

- NOTES:
- NOT ALL UTILITY SERVICES ARE SHOWN.
 - SANITARY SEWER SERVICE RECONNECTION TO 2303 S. MAIN ST. MUST BE CONNECTED TO 15" SAN. AND THE COLE AVE. SEWER EXTENSION STA. 364+78 MUST BE CONSTRUCTED PRIOR TO ABANDONING THE 8" SAN. UPSTREAM OF MH 014-007.

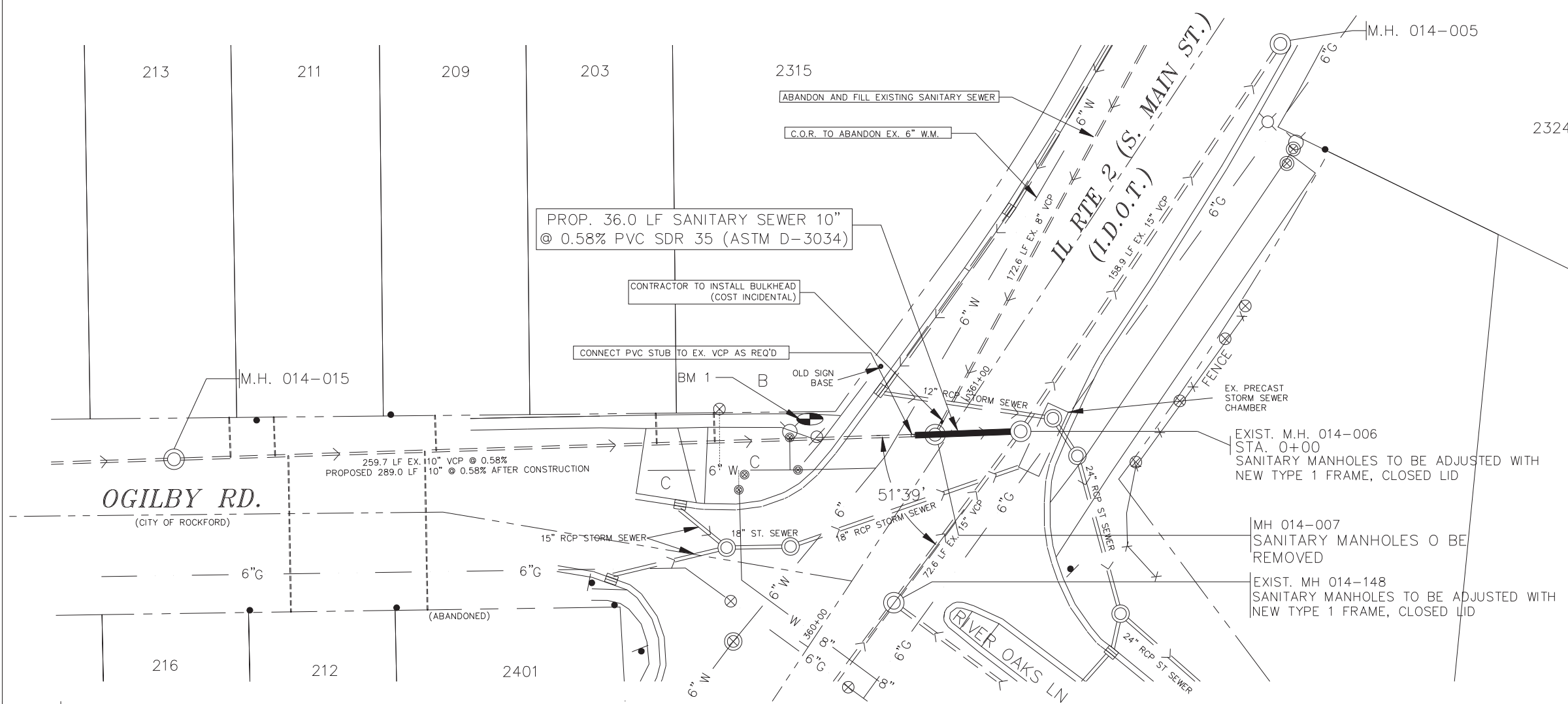

IL RTE 2 (S. MAIN ST.) - LINE B

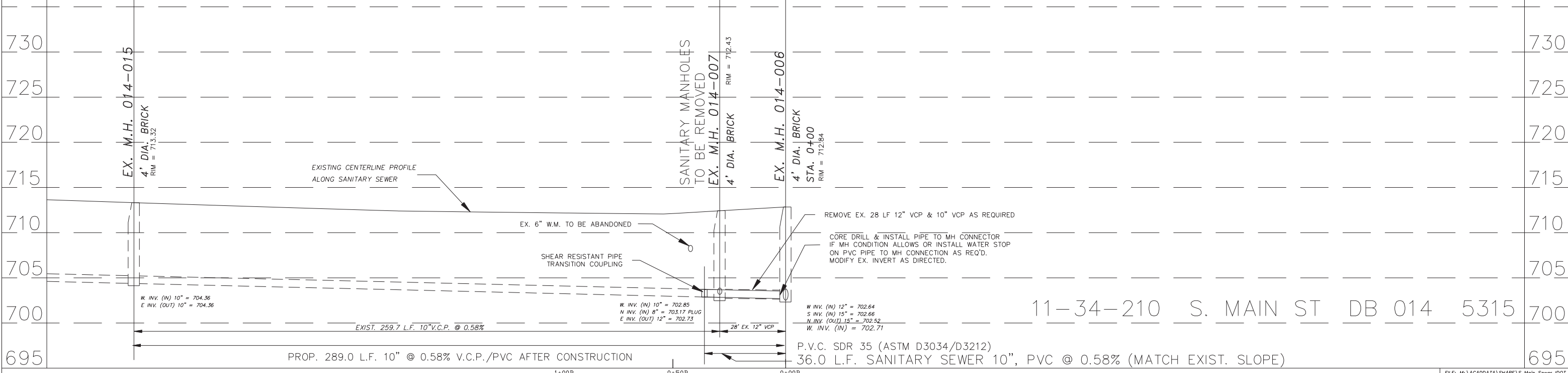

11-34-210 S. MAIN ST DB 014 5315

FILE NAME = S MAIN SEWER IDOT.DWG	USER NAME = M RIEGER	DESIGNED - MKR/MAW	REVISED 10/09/2012 BPF	ROCK RIVER WATER RECLAMATION DISTRICT 3501 KISHWAUKEE STREET ROCKFORD, ILLINOIS 61109 (815) 387-7660	STATE OF ILLINOIS DEPARTMENT OF TRANSPORTATION	PLAN & PROFILE - S. MAIN ST. STA. 0+00B - STA. 0+36B	F.A.P. RTE. 742	SECTION (32, 33) R-1	SCALE: 1:20	TOTAL SHEETS NO. 705	SHEET NO. 336
	PLOT SCALE AS NOTED	CHECKED - MAW	REVISED -		SOUTH MAIN ST. SAN. SEWER IMPROVEMENTS					CONTRACT NO. 64821	
	DATE - 4/16/2012	REVISD -	REVISD -		CAPITAL PROJECT 1257, 2012					ILLINOIS FED. AID PROJECT	