

NOTE: THIS PLAN SHEET SHOWS EXISTING CONDITIONS ONLY. ALL REMOVALS NECESSARY TO COMPLETE THIS WORK ARE INCLUDED AS PART OF THE I.D.O.T. ROADWAY PLANS.

BENCHMARKS				
NO.	DESCRIPTION	STATION	OFFSET	ELEV.
NO. 3	SW BONNET BOLT ON HYDRANT	0+70	22' RT	716.58
NW CORNER COLE AVE / S. MAIN				

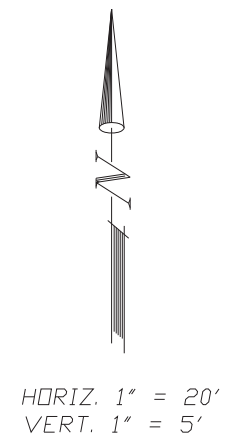
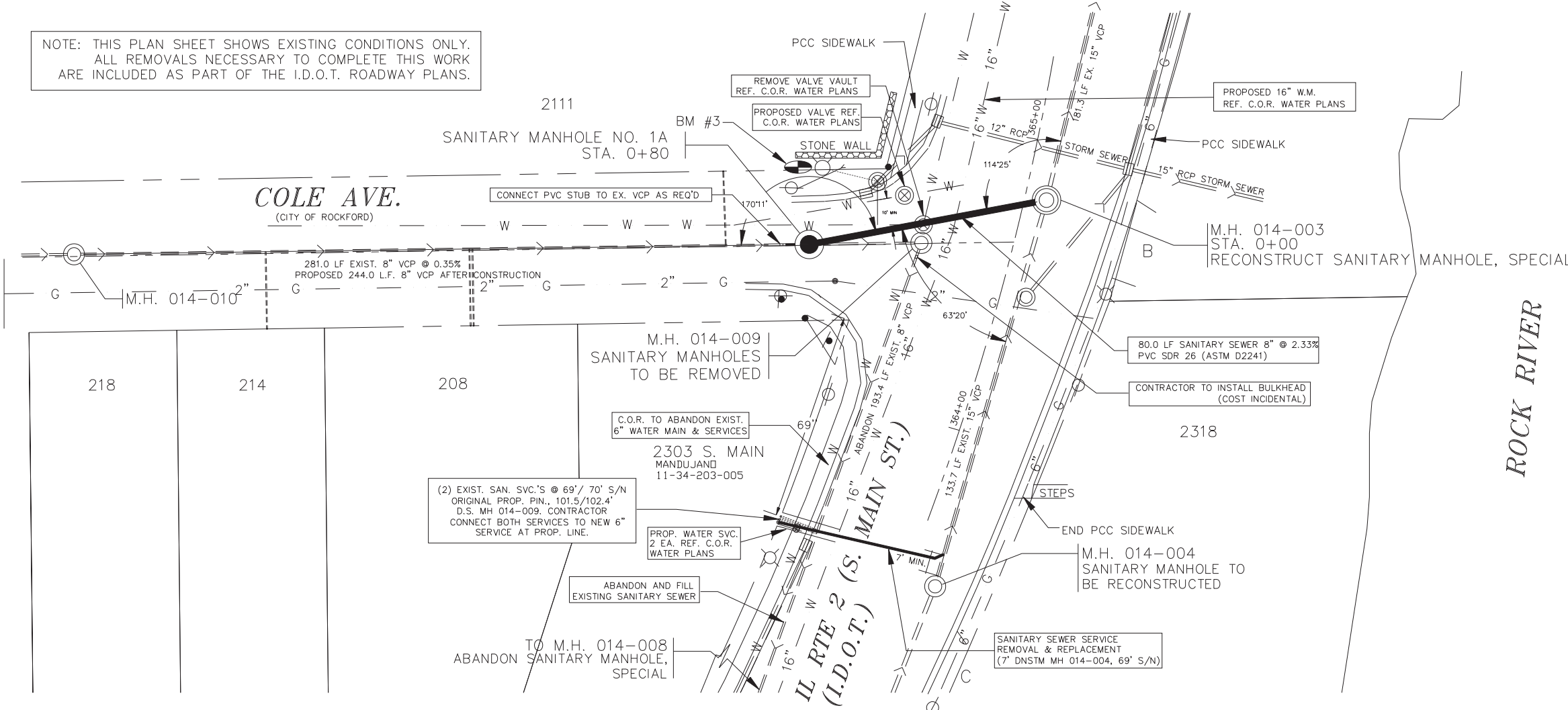

NOTES
 R = REMOVE TREE
 T = RELOCATE TREE
 S = SAVE TREE

NOTE: NOT ALL UTILITY SERVICES ARE SHOWN.

IL RTE 2 (S. MAIN ST.) - LINE A

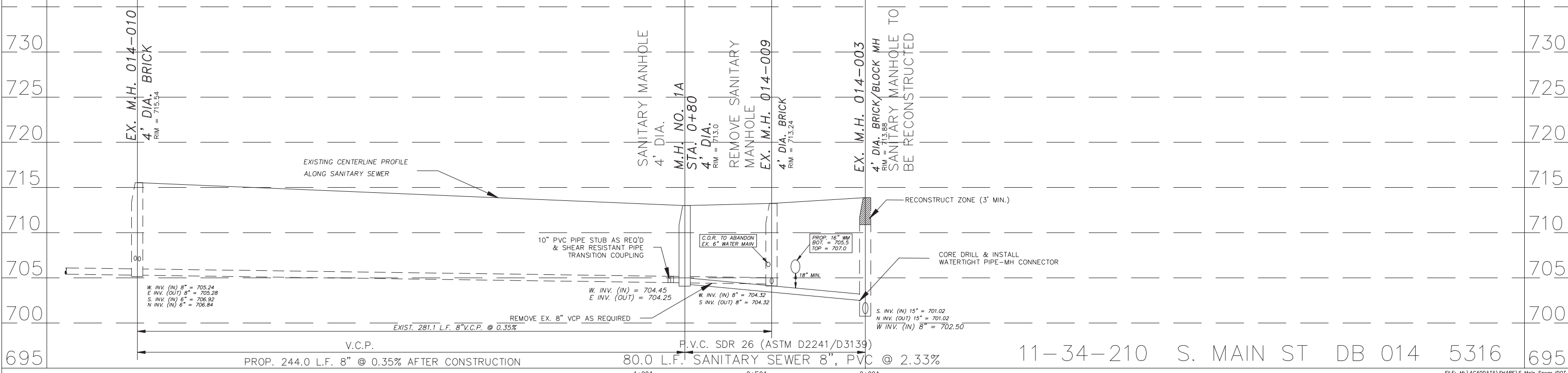

FILE NAME = S MAIN SEWER IDOT.DWG	USER NAME = M RIEGER	DESIGNED - MKR/MAW	REVISED 10/09/2012 BPF	ROCK RIVER WATER RECLAMATION DISTRICT 3501 KISHWAUKEE STREET ROCKFORD, ILLINOIS 61109 (815) 387-7660	STATE OF ILLINOIS DEPARTMENT OF TRANSPORTATION	PLAN & PROFILE - S. MAIN ST. STA. 0+00A - STA. 0+80A	F.A.P. RTE. 742	SECTION (32, 33) R-1	SCALE: 1:20	COUNTY WINNEBAGO	TOTAL SHEETS 705	SHEET NO. 337
DATE - 4/16/2012				SOUTH MAIN ST. SAN. SEWER IMPROVEMENTS CAPITAL PROJECT 1257, 2012		CONTRACT NO. 64821		ILLINOIS FED. AID PROJECT				