

LEGEND

- DETECTABLE WARNING
- DIRECTION OF FLOW
- (XXX.XX) EXISTING ELEVATION TO BE MATCHED
- LANDING
- RAMP

- NOTES:**
1. CURB RETURN ELEVATIONS ARE SHOWN AT 10' INCREMENTS BEGINNING AT THE IL 2 PC.
 2. SEE SHEET SEGMENTAL BLOCK WALL DETAIL- IL 2 LT, FROM KNOWLTON ST. TO LOOMIS ST. FOR RETAINING WALLS DETAILS.
 3. SEE DISTRICT 2 STANDARD 25.1 FOR DETAILS OF ENTRANCE APPROACHES - URBAN AREA

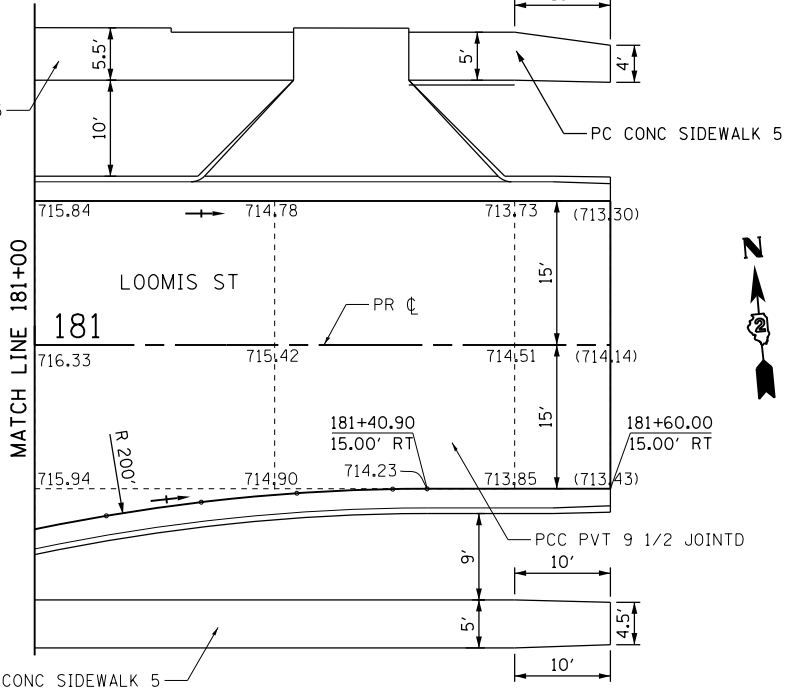

FILE NAME =	USER NAME = #USER*	DESIGNED -	REVISED -	STATE OF ILLINOIS DEPARTMENT OF TRANSPORTATION	INTERSECTION DETAIL LOOMIS ST.			F.A.P. RTE.	SECTION	COUNTY	TOTAL SHEETS	SHEET NO.	
#FILE#		DRAWN -	REVISED -		742	(32,33) R-1	WINNEBAGO	705	392				
PLOT SCALE = #SCALE*		CHECKED -	REVISED -		SCALE: 1"=10'			SHEET NO. 19 OF 26 SHEETS		STA.	TO STA.	CONTRACT NO. 64821	
PLOT DATE = #DATE*		DATE -	REVISED -		ILLINOIS FED. AID PROJECT								