

DETAIL - CONCRETE  
MEDIAN (SPECIAL)  
(NOT TO SCALE)

IL-2 PAVEMENT TRANSITIONS (S.B. ONLY)

BEGIN TRANSITION N.C.	END TRANSITION FULL S.E.	BEGIN TRANSITION FULL S.E.	END TRANSITION N.C.
STA 432+41.40	STA 433+25.00	STA 434+05.77	STA 434+89.37
-2.0%	+0.50%	+0.50%	-2.0%

TWO-CENTERED CURVE  
72' - 460' R  
11.5' OFFSET

SEE STATE STANDARD  
424011 FOR DETAIL OF  
CORNER PARALLEL CURB  
RAMPS FOR SIDEWALKS

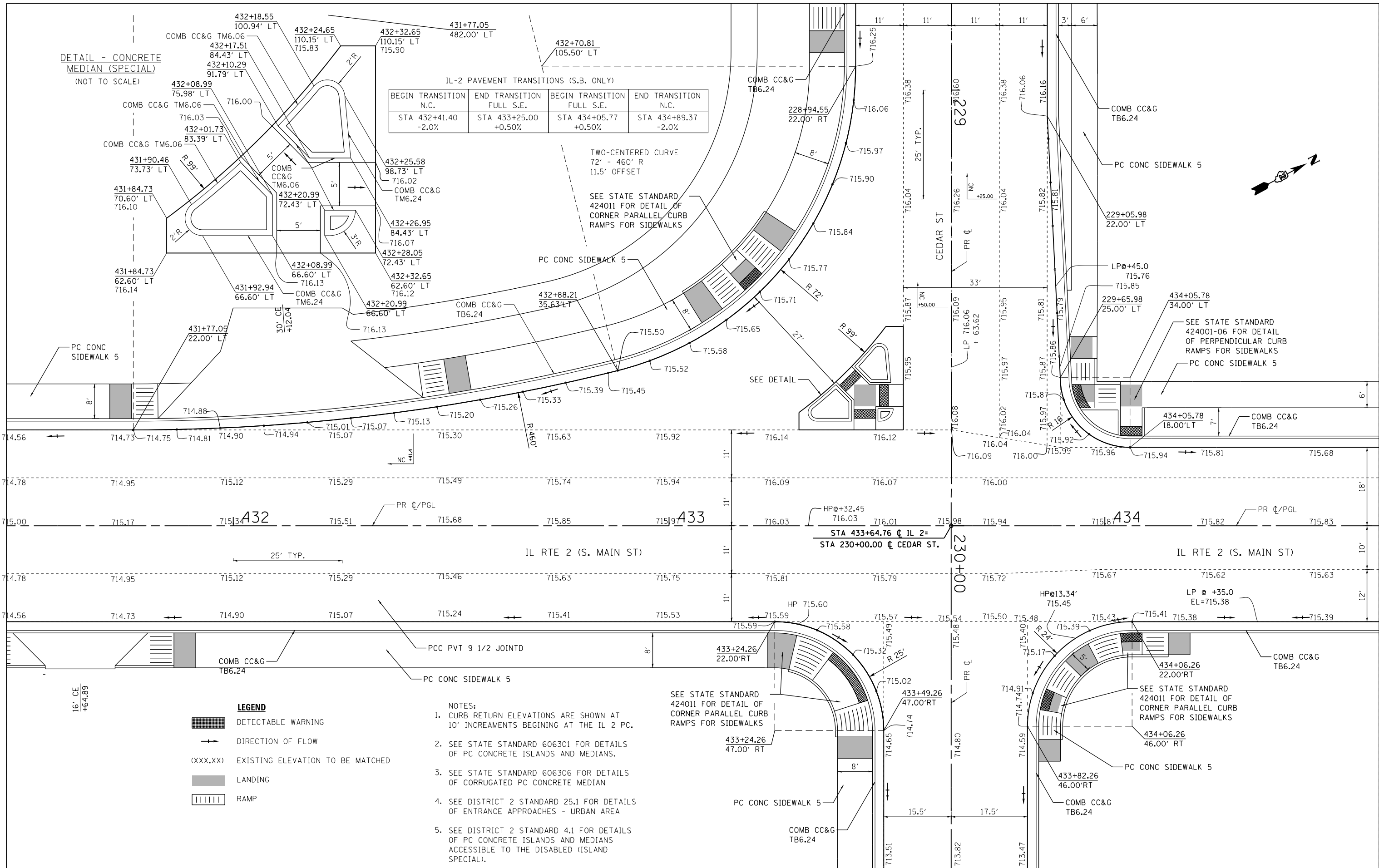
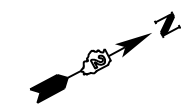

**LEGEND**

- DETECTABLE WARNING
- DIRECTION OF FLOW
- (XXX.XX) EXISTING ELEVATION TO BE MATCHED
- LANDING
- RAMP

- NOTES:
- CURB RETURN ELEVATIONS ARE SHOWN AT 10' INCREMENTS BEGINNING AT THE IL 2 PC.
  - SEE STATE STANDARD 606301 FOR DETAILS OF PC CONCRETE ISLANDS AND MEDIANS.
  - SEE STATE STANDARD 606306 FOR DETAILS OF CORRUGATED PC CONCRETE MEDIAN
  - SEE DISTRICT 2 STANDARD 25.1 FOR DETAILS OF ENTRANCE APPROACHES - URBAN AREA
  - SEE DISTRICT 2 STANDARD 4.1 FOR DETAILS OF PC CONCRETE ISLANDS AND MEDIANS ACCESSIBLE TO THE DISABLED (ISLAND SPECIAL).