

JOINTING NOTES

1. FOR GEOMETRICS SEE ROADWAY PLANS AND INTERSECTION DETAILS.
2. LONGITUDINAL AND TRANSVERSE JOINTS SHALL BE IN ACCORDANCE WITH STANDARD 420001.
3. TWO LANE JOINTED PORTLAND CEMENT CONCRETE PAVEMENT SHALL BE IN ACCORDANCE WITH STANDARD 420101.
4. CONTRACTION JOINT SPACING IS 15', UNLESS NOTED.

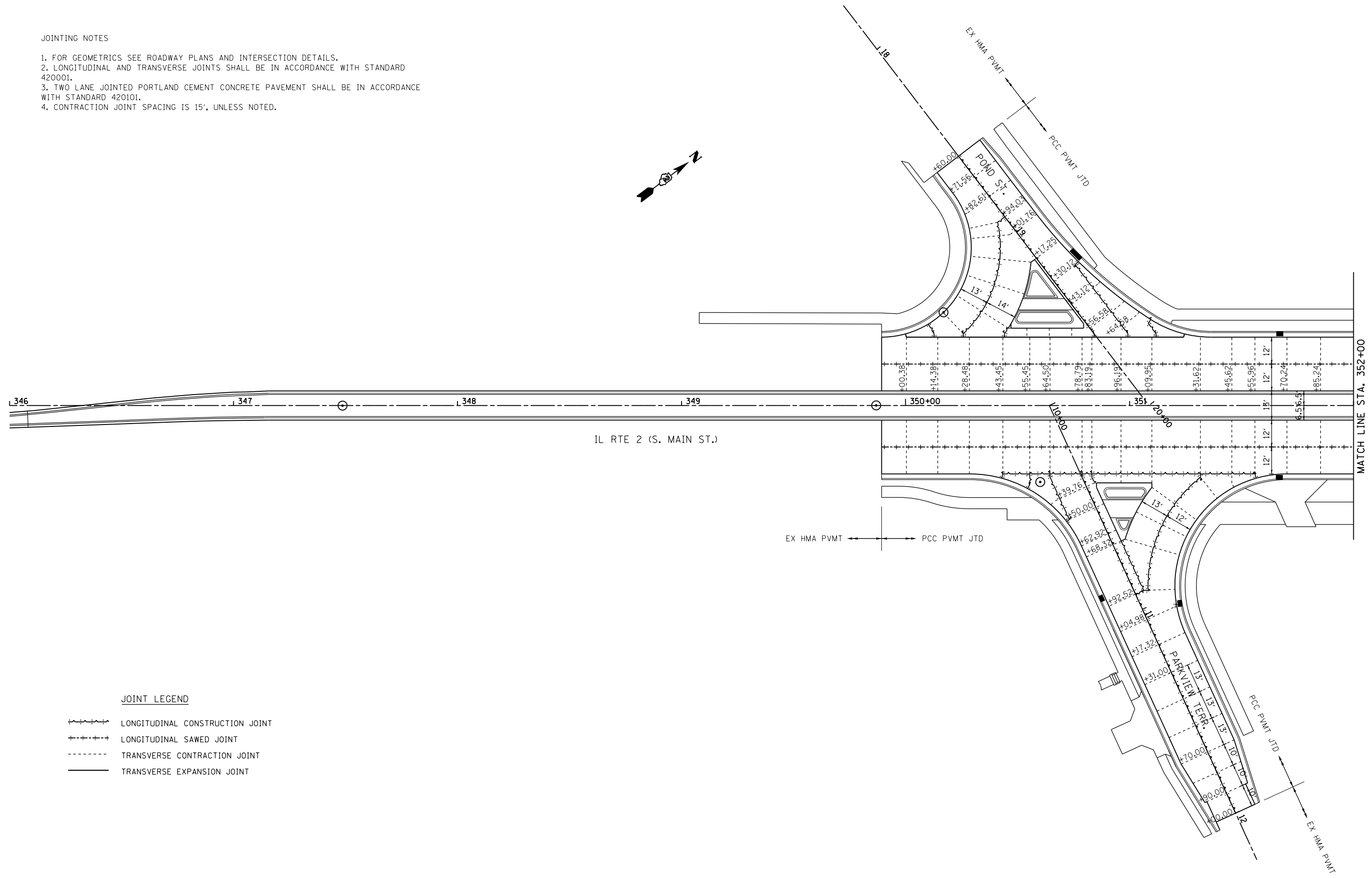
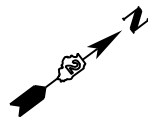

JOINT LEGEND

- LONGITUDINAL CONSTRUCTION JOINT
- LONGITUDINAL SAWED JOINT
- TRANSVERSE CONTRACTION JOINT
- TRANSVERSE EXPANSION JOINT

| | | | |
|------------------------|----------------------|------------|-----------|
| FILE NAME = *FILEL* | USER NAME = *USER* | DESIGNED - | REVISED - |
| | | DRAWN - | REVISED - |
| | PLOT SCALE = *SCALE* | CHECKED - | REVISED - |
| | PLOT DATE = *DATE* | DATE - | REVISED - |

**STATE OF ILLINOIS
DEPARTMENT OF TRANSPORTATION**

**PAVEMENT JOINT DETAILS
IL RTE 2**

SCALE: 1" = 20' SHEET NO. 1 OF 14 SHEETS STA. 346+00 TO STA. 352+00

| | | | | |
|--------------------|--------------|-----------|---------------------------|-----------|
| F.A.P. RTE. | SECTION | COUNTY | TOTAL SHEETS | SHEET NO. |
| 742 | (32, 33) R-1 | WINNEBAGO | 705 | 400 |
| CONTRACT NO. 64821 | | | ILLINOIS FED. AID PROJECT | |