

LEGEND

- (143'-E-2'') - LENGTH - EXISTING 2" CONDUIT
- (143'-2'') - LENGTH - PROPOSED INTERSECTION CONDUIT OF SIZE SPECIFIED
- 143'-2'' - LENGTH - PROPOSED SYSTEM CONDUIT OF SIZE SPECIFIED
- S - SYSTEM TRAFFIC SIGNAL ITEM
- I - INTERSECTION TRAFFIC SIGNAL ITEM

LEGEND

- |                             |          |          |
|-----------------------------|----------|----------|
|                             | EXISTING | PROPOSED |
| CONDUIT                     |          |          |
| HANDHOLE                    |          |          |
| CONTROLLER CABINET          |          |          |
| MASTER CONTROLLER           |          |          |
| POST OR MAST ARM FOUNDATION |          |          |

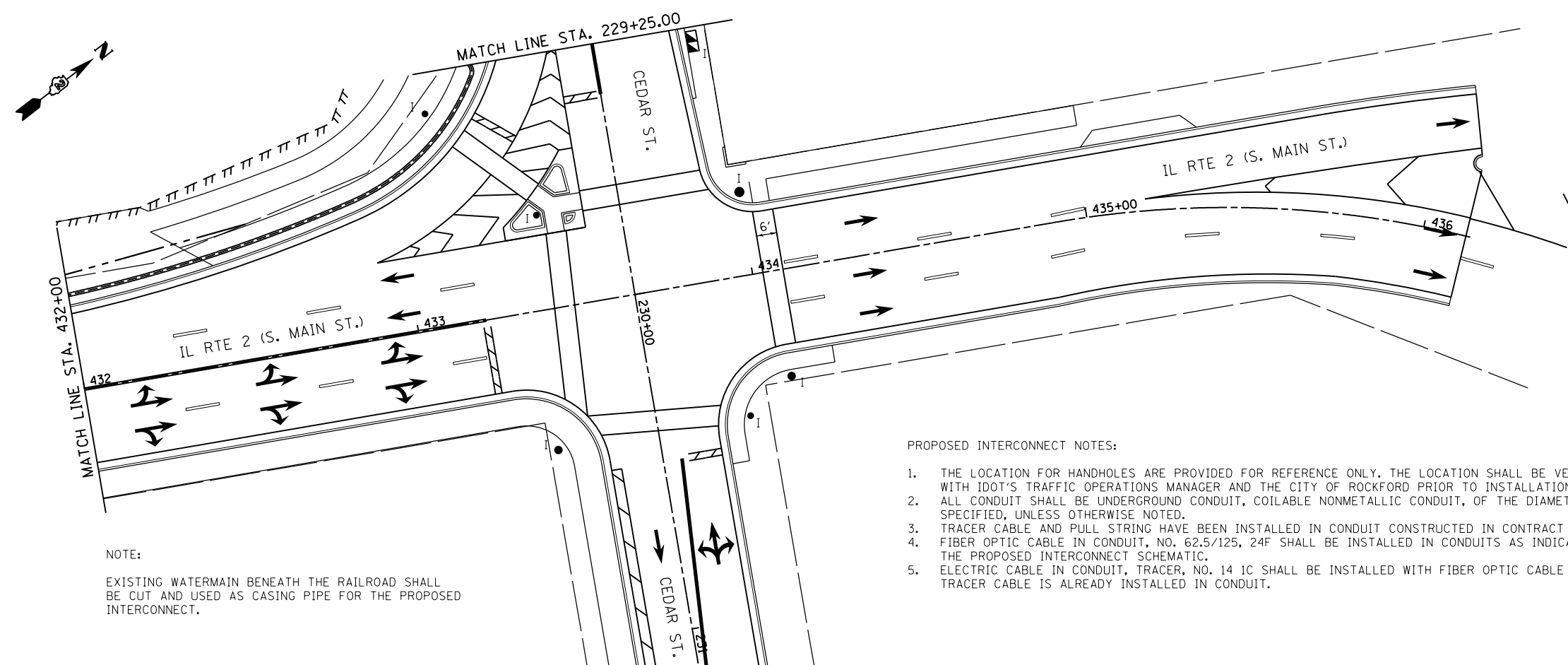

NOTE:

EXISTING WATERMAIN BENEATH THE RAILROAD SHALL BE CUT AND USED AS CASING PIPE FOR THE PROPOSED INTERCONNECT.

PROPOSED INTERCONNECT NOTES:

1. THE LOCATION FOR HANDHOLES ARE PROVIDED FOR REFERENCE ONLY. THE LOCATION SHALL BE VERIFIED WITH IDOT'S TRAFFIC OPERATIONS MANAGER AND THE CITY OF ROCKFORD PRIOR TO INSTALLATION.
2. ALL CONDUIT SHALL BE UNDERGROUND CONDUIT, COILABLE NONMETALLIC CONDUIT, OF THE DIAMETER SPECIFIED, UNLESS OTHERWISE NOTED.
3. TRACER CABLE AND PULL STRING HAVE BEEN INSTALLED IN CONDUIT CONSTRUCTED IN CONTRACT NO. 64515.
4. FIBER OPTIC CABLE IN CONDUIT, NO. 62.5/125, 24F SHALL BE INSTALLED IN CONDUITS AS INDICATED IN THE PROPOSED INTERCONNECT SCHEMATIC.
5. ELECTRIC CABLE IN CONDUIT, TRACER, NO. 14 1C SHALL BE INSTALLED WITH FIBER OPTIC CABLE UNLESS TRACER CABLE IS ALREADY INSTALLED IN CONDUIT.

FILE NAME = *FILEL*	USER NAME = *USER*	DESIGNED -	REVISED -	<b>STATE OF ILLINOIS DEPARTMENT OF TRANSPORTATION</b>	<b>IL RTE 2 INTERCONNECT PLAN</b>	F.A.P. RTE.	SECTION	COUNTY	TOTAL SHEETS	SHEET NO.	
	PLOT SCALE = *SCALE*	DRAWN -	REVISED -			742	(32,33) R-1	WINNEBAGO	705	466	
	PLOT DATE = *DATE*	CHECKED -	REVISED -			CONTRACT NO. 64821					
		DATE -	REVISED -			ILLINOIS FED. AID PROJECT					

SCALE: 1" = 20' SHEET NO. 12 OF 14 SHEETS STA. 428+00 TO STA. 436+11.90