

Approximate Limits of Recess for Steel Plates, As Required for M.O.T.

Inlet, Type B Type 23 Frame and Grate

Sta. 369+34.78
55.29' Rt.

Sta. 369+30.13
61.60' Rt.

Back 300'-0" R
Ahead 150'-0" R

1/2" Exp. Jt.

Sta. 369+43.82
65.18' Rt.

Sta. 369+46.53
58.79' Rt.

Sta. 369+40.66
29.00' Rt.

Manhole, Type A
7' Diameter, Type 1
Frame, Closed Lid

Prop. South
Traffic Island

Detectable warnings (typ.)

Concrete Foundation
Type E, 30-inch Diameter

Sawcut Joint,
See Detail

Sta. 369+54.62
63.06' Rt.

Handhole, Portland
Cement Concrete

Sta. 370+05.14
29.00' Rt.

Approximate Limits of
Recess for Steel Plates,
As Required for M.O.T.

Handhole, Portland
Cement Concrete
(Special)

Sta. 370+83.93
29.00' Rt.

Prop. North
Traffic Island

Concrete Foundation
Type E, 36-inch Diameter

Inlet, Type B
Type 24 Frame
and Grate

Sawcut Joint,
See Detail

Sta. 370+06.84
60.23' Rt.

15th Ave &
Stage Constr. Line

Sta. 370+64.34
57.12' Rt.

Sta. 370+72.99
58.34' Rt.

Sta. 370+68.75
52.96' Rt.

Sta. 370+93.80
48.97' Rt.

1/2" Exp. Jt.

52'-3 5/8"

57'-7"

Stage I Construction

Stage II Construction

109'-10 5/8"

PLAN

Stations and Offsets given from 15th Ave

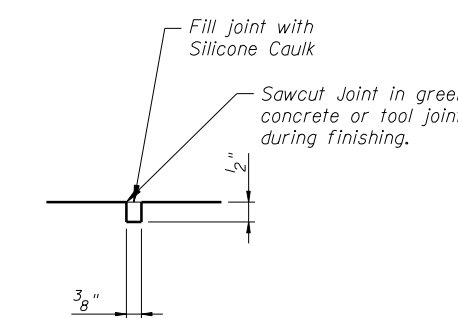

SAWCUT JOINT

Include cost of sawcut joint in unit price bid for Concrete Superstructure.

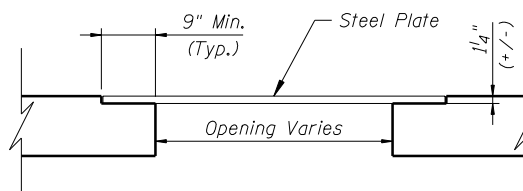

RECESS FOR STEEL PLATES

Note: Limits of Recess Shall Stay Within Limits of Traffic Island.



| | | |
|--------------|----------------|---------|
| USER NAME = | DESIGNED - DPW | REVISED |
| | CHECKED - ASP | REVISED |
| PLOT SCALE = | DRAWN - LNB | REVISED |
| PLOT DATE = | CHECKED - ASP | REVISED |

**STATE OF ILLINOIS
DEPARTMENT OF TRANSPORTATION**

**IL 2 (RT.) BIKE PATH AT 15TH AVENUE
APPROACH SLAB PLAN**

SHEET NO. 8 OF 18 SHEETS

| | | | | |
|--------------------|-------------|-----------|---------------------------|-----------|
| F.A.P. RTE. | SECTION | COUNTY | TOTAL SHEETS | SHEET NO. |
| 742 | (32.33) R-1 | WINNEBAGO | 705 | 538 |
| CONTRACT NO. 64821 | | | ILLINOIS FED. AID PROJECT | |