

Notes:

Plan dimensions and details relative to existing plans are subject to nominal construction variations. The Contractor shall field verify existing dimensions and details affecting new construction and make necessary approved adjustments prior to construction or ordering of materials. Such variations shall not be cause for additional compensation for a change in scope of the work, however, the Contractor will be paid for the quantity actually furnished at the unit price bid for the work.

See roadway plans for: elevations and transitions for the roadway, curbs, and sidewalks; sidewalk ramp details; locations of manholes, utility poles, and crossing gates.

Design Stresses
 $f'_c = 3,500$ psi (Concrete)
 $f_y = 60,000$ psi (Reinforcement)

See sheet 2 of 3 for Sections C-C & D-D and Views A-A & C-C.

See sheet 3 of 3 for railing details.

Reinforcement bars designated (E) shall be epoxy coated.

$a_1(E)$, $a_2(E)$, $a_3(E)$, and $a_4(E)$ bar spacing measured along ϕ Rdwy.

Bars indicated thus 70x2-#9 etc. indicates 70 lines of bars with 2 lengths per line.

The existing roadway pavement, concrete sidewalk, and concrete parapet with steel railing shall be removed for the proposed cast-in-place concrete slab, sidewalk, and parapets with steel railings to be constructed. Paid for as Removal of Existing Superstructure.

Roadway slab, sidewalk, and parapet concrete shall be paid for as Concrete Superstructure.

Reinforcement shall be paid for as Reinforcement Bars, Epoxy Coated.

The dowels, joints, and finishing shall be according to Section 420 of the Standard Specifications. The dowels shall be included in the cost of Concrete Superstructures.

The roadway subgrade and subbase shall follow Standard 420501-04 and be compacted over the structure using hand equipment approved by the Engineer.

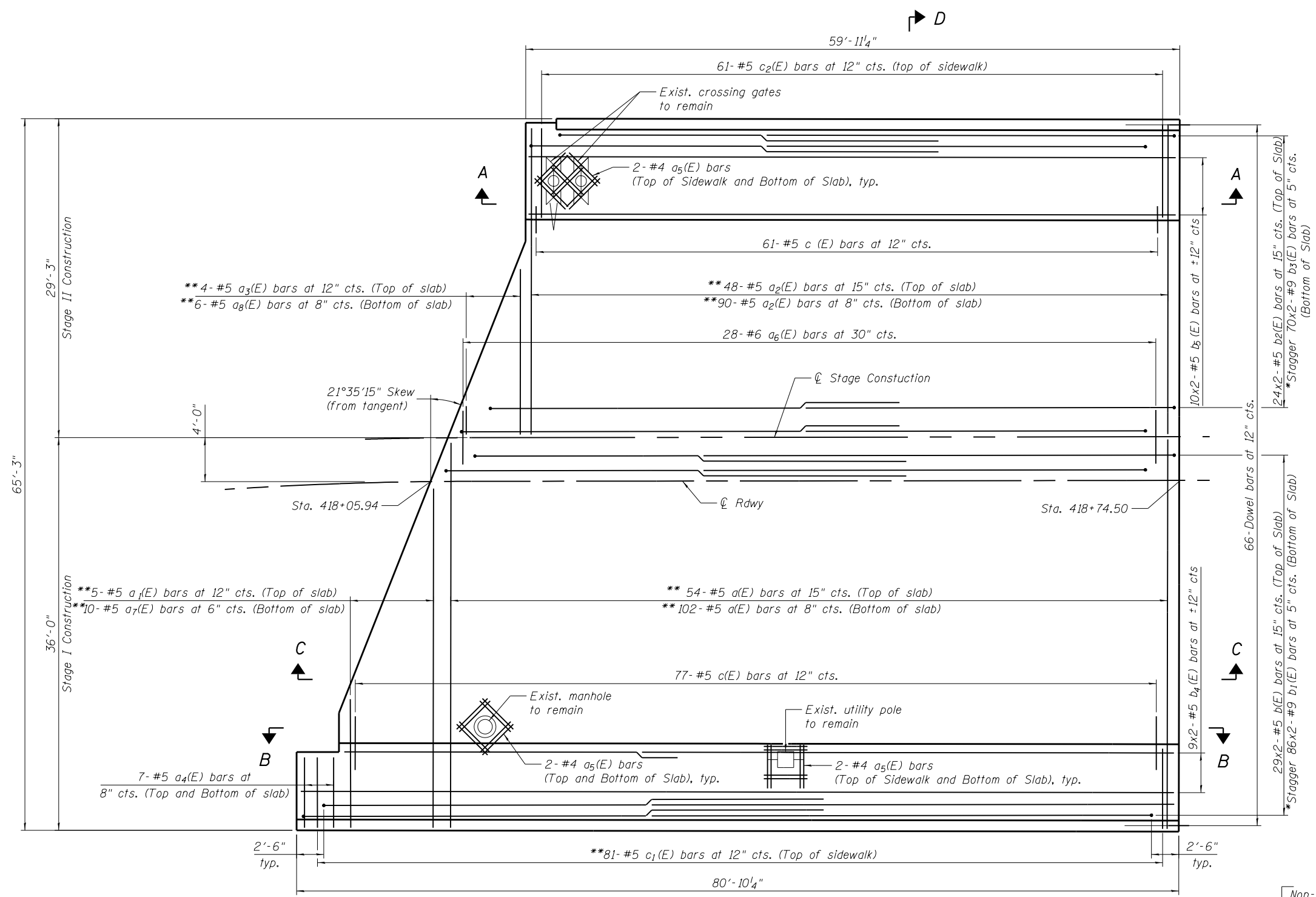

MIN. BAR LAP
 #5 Bar = 3'-3"
 #9 Bar = 8'-7"

* Tilt #9 $b_1(E)$ and $b_3(E)$ bars as required to maintain clearance.
 ** Trim to fit

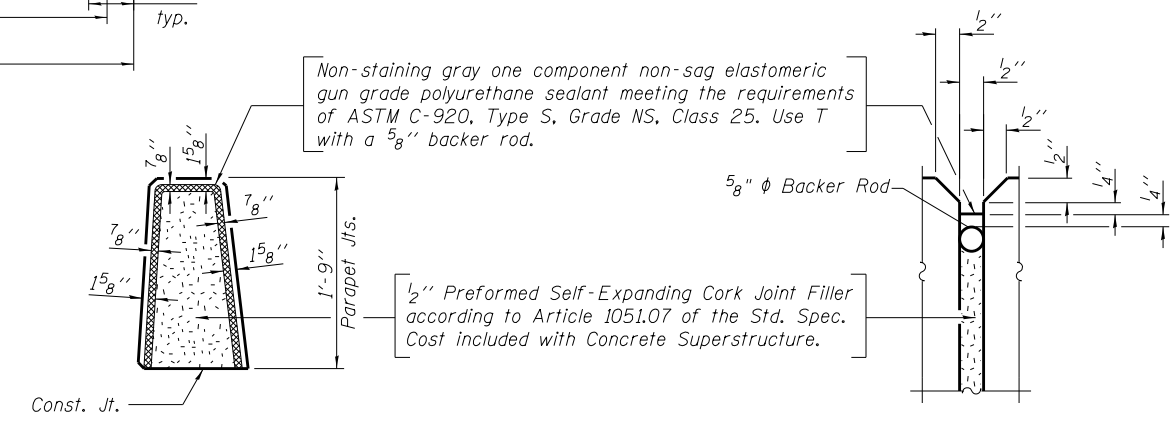
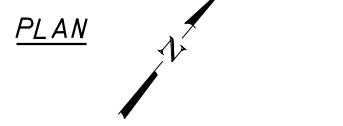

PARAPET JOINT DETAILS



David F. Maxwell, S.E. Reg. No. 081-005455
 Date: October 29, 2012
 My registration expires November 30, 2012

HRGreen
 PROJECT CONTACT: David Maxwell
 DATE PLOTTED: 10/29/2012 10:56:16 AM
 FILE NAME: 10964821-shr-Approach Slab.dgn
 PLOT DRIVER: pdfcut
 PLOT TABLE: Struct 11x17.tbl



USER NAME = whood	DESIGNED - MGH	REVISED -
	CHECKED - KJB	REVISED -
PLOT SCALE =	DRAWN - WJH	REVISED -
PLOT DATE = 10/29/2012	CHECKED - MGH	REVISED -

STATE OF ILLINOIS
 DEPARTMENT OF TRANSPORTATION

ROADWAY SLAB DETAILS
 STRUCTURE NO. 101-6110
 SHEET NO. 1 OF 3 SHEETS

F.A.P. RTE.	SECTION	COUNTY	TOTAL SHEETS	SHEET NO.
742	(32, 33) R-1	WINNEBAGO	705	549
CONTRACT NO. 64821				
ILLINOIS FED. AID PROJECT				