

F.A.U. RTE.	SECTION	COUNTY	TOTAL SHEETS	SHEET NO.
5128	D2 BRIDGE REPAIR 2013-4	WINNEBAGO	5	1
		ILLINOIS	CONTRACT NO. 64J45	

STATE OF ILLINOIS
DEPARTMENT OF TRANSPORTATION
DIVISION OF HIGHWAYS

PROPOSED HIGHWAY PLANS

FAU ROUTE 5128 (IL 251)
SECTION D2 BRIDGE REPAIR 2013-4

TYPE of IMPROVEMENT
WINNEBAGO COUNTY

C-92-040-13

INDEX OF SHEETS:

1. COVER SHEET, HIGHWAY STANDARDS
2. SUMMARY OF QUANTITY, GENERAL NOTES
3. R 29 BICYCLE RAILING
- 4-5 EXISTING BRIDGE PLANS

HIGHWAY STANDARDS:

- 701101-03 OFF-RD OPERATIONS, MULTILANE, 15' (4.5 m) TO 24" (600mm) FROM PAVEMENT EDGE
- 701106-02 OFF-RD OPERATIONS, MULTILANE, MORE THAN 15' (4.5 m) AWAY
- 701427-01 LANE CLOSURE, MULTILANE, INTERMITTENT OR MOVING OPERATIONS FOR SPEEDS < 40 MPH
- 701606-08 URBAN LANE CLOSURE, MULTILANE, 2W WITH MOUNTABLE MEDIAN
- 701801-05 SIDEWALK, CORNER OR CROSSWALK CLOSURE
- 701901-02 TRAFFIC CONTROL DEVICES
- 720011-01 METAL POSTS FOR SIGNS, MARKERS & DELINEATORS
- 728001-01 TELESCOPING STEEL SIGN SUPPORT
- 729001-01 APPLICATIONS OF TYPES A & B METAL POSTS (FOR SIGNS & MARKERS)
- 780001-03 TYPICAL PAVEMENT MARKINGS

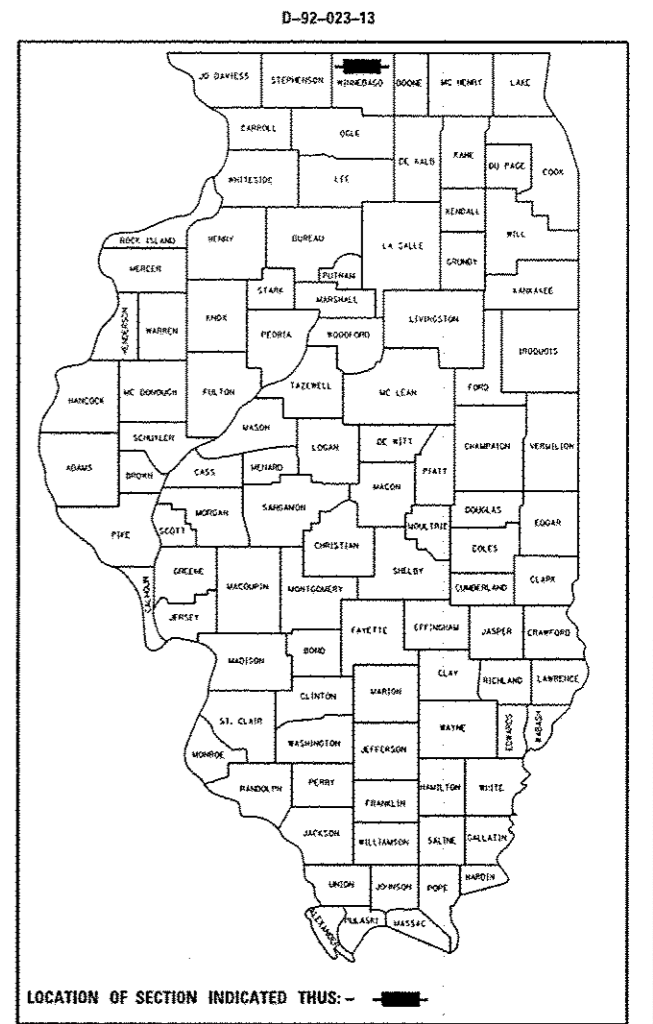

T.43N. - R.1E.

SN: 101-0163

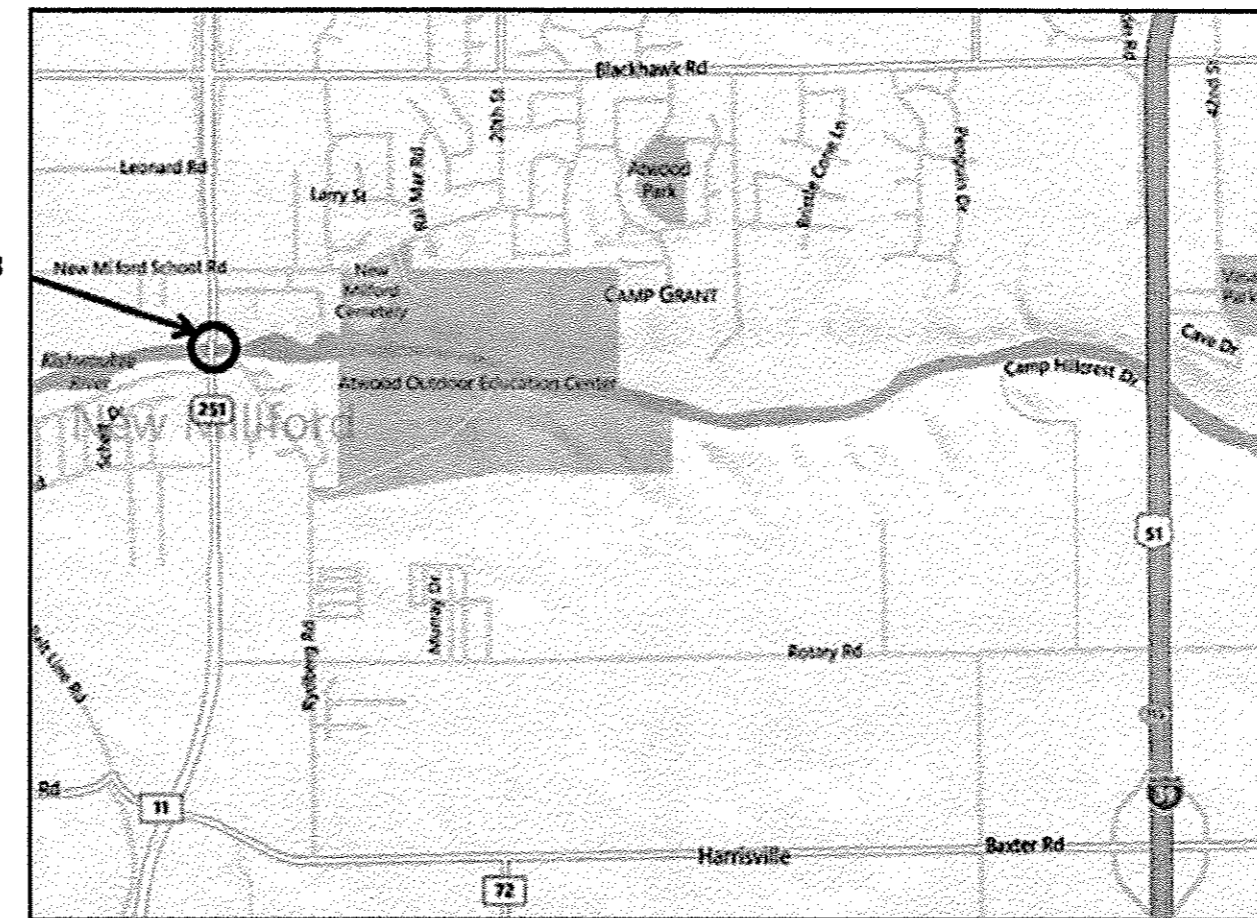

J.U.L.I.E.
JOINT UTILITY LOCATION INFORMATION FOR EXCAVATION
1-800-892-0123
OR 811

ROCKFORD TOWNSHIP, SECTIONS 23 AND 24
PROJECT MANAGER: MAHMOUD ETEMADI (815) 284-5393

CONTRACT NO. 64J45

STATE OF ILLINOIS
DEPARTMENT OF TRANSPORTATION
DIVISION OF HIGHWAYS

SUBMITTED 1-28 2013
Paul Roeter
DEPUTY DIRECTOR OF HIGHWAYS, REGION ENGINEER

Feb 1 2013
John D. Baramelli, PE
acting ENGINEER OF DESIGN AND ENVIRONMENT

Feb 1 2013
Omer Osman, PE
DIRECTOR OF HIGHWAYS, CHIEF ENGINEER

PRINTED BY THE AUTHORITY
OF THE STATE OF ILLINOIS