

**STAGE 1 CONSTRUCTION TYPICAL SECTION**  
(LOOKING EAST AT STRUCTURE)  
FOR INFORMATION ONLY

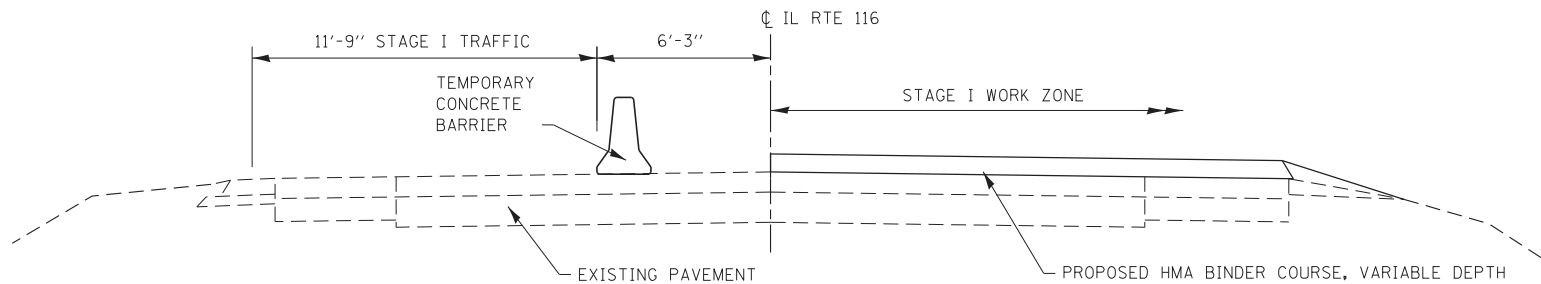

**STAGE 1, PHASE 2 CONSTRUCTION TYPICAL SECTION**  
(WEST OF STRUCTURE, LOOKING EAST &  
EAST OF STRUCTURE, LOOKING EAST)

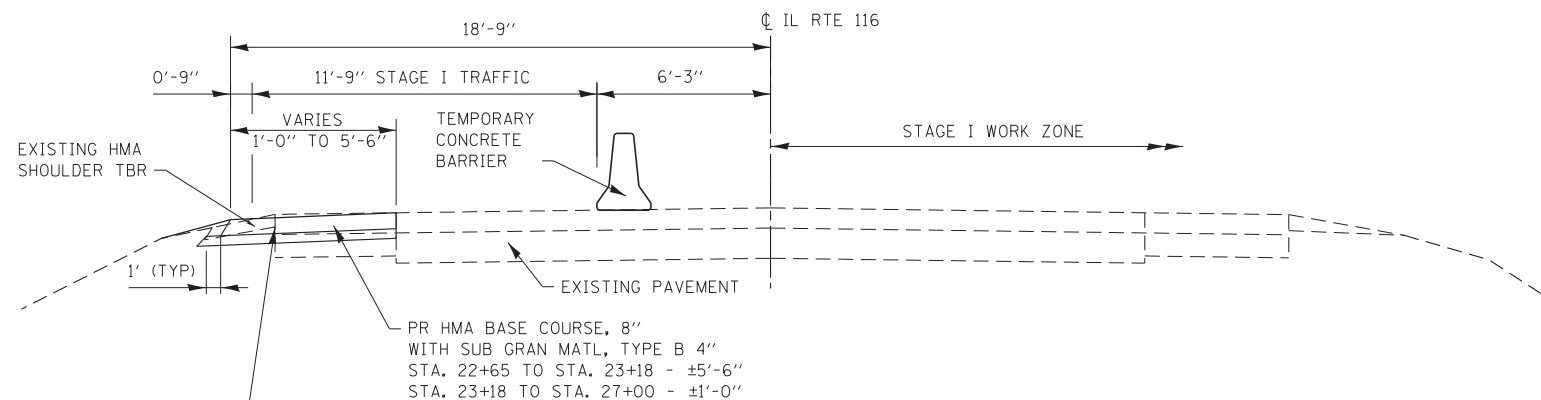

**STAGE 1, PHASE 1 CONSTRUCTION TYPICAL SECTION**  
(WEST OF STRUCTURE, LOOKING EAST &  
EAST OF STRUCTURE, LOOKING EAST)

**STAGE CONSTRUCTION GENERAL NOTES**

- ONE LANE OF TRAFFIC ON ILLINOIS ROUTE 116 SHALL BE MAINTAINED AT ALL TIMES.
- EMERGENCY ACCESS SHALL BE PROVIDED AT ALL TIMES.

**SUGGESTED STAGE CONSTRUCTION**

SUGGESTED STAGE 1

PHASE 1

- UTILIZING TRAFFIC CONTROL AND PROTECTION, STANDARD 701326, REMOVE THE EXISTING SHOULDER AND CONSTRUCT THE HMA BASE COURSE, 8" ON THE LT SIDE OF THE ROADWAY FROM STA. 22+65 TO STA. 27+00 AND CONSTRUCT THE RELOCATED FIELD ENTRANCE AT STA 21+00 LT. TRAFFIC CONTROL SURVEILLANCE SHALL BE PAID FOR THROUGHOUT THE DURATION THAT STANDARD 701326 IS UTILIZED.
- INSTALL TEMPORARY TRAFFIC SIGNALS PRIOR TO CLOSING THE RT HALF OF ROADWAY.

PHASE 2

- UTILIZING TRAFFIC CONTROL AND PROTECTION, STANDARD 701321, DIRECT TRAFFIC TO THE LT LANE OF IL ROUTE 116.
- CONSTRUCT TEMPORARY SHEET PILING AT WEST AND EAST SIDE OF EXISTING STRUCTURE AND REMOVE THE RT SIDE OF THE EXISTING STRUCTURE.
- CONSTRUCT THE RT SIDE OF THE BRIDGE AND BRIDGE APPROACH PAVEMENT.
- CONSTRUCT THE PROPOSED VARIABLE DEPTH HMA BINDER COURSE ON THE RT SIDE OF IL ROUTE 116, INCLUDING THE SHOULDER, FROM STA. 23+60 TO STA. 24+20 AND FROM STA. 25+63 TO STA. 26+70.
- CONSTRUCT TEMPORARY RAMP AT STA. 23+60, STA. 24+20, STA. 25+63, AND STA. 26+70.
- PLACE TEMPORARY AGGREGATE AT ENTRANCES, IF NECESSARY, TO MAINTAIN ACCESS.
- INSTALL GUARDRAIL ON RT SIDE OF IL ROUTE 116 AND COMPLETE DRAINAGE IMPROVEMENTS.
- INSTALL TEMPORARY PAVEMENT MARKING.

SUGGESTED STAGE 2

- UTILIZING TRAFFIC CONTROL AND PROTECTION, STANDARD 701321, DIRECT TRAFFIC TO THE RT LANE OF IL ROUTE 116.
- REMOVE THE LT SIDE OF THE EXISTING STRUCTURE.
- CONSTRUCT THE LT SIDE OF THE BRIDGE AND BRIDGE APPROACH PAVEMENT.
- CONSTRUCT THE PROPOSED VARIABLE DEPTH HMA BINDER COURSE ON THE LT SIDE OF IL ROUTE 116, INCLUDING THE SHOULDER, FROM STA. 23+25 TO STA. 24+20 AND FROM STA. 25+63 TO STA. 26+70.
- CONSTRUCT TEMPORARY RAMP AT STA. 23+25, STA. 24+20, STA. 25+63, AND STA. 26+70.
- INSTALL GUARDRAIL ON THE LT SIDE OF IL ROUTE 116 AND COMPLETE DRAINAGE IMPROVEMENTS.

SUGGESTED STAGE 3

- UTILIZING TRAFFIC CONTROL AND PROTECTION, STANDARD 701306, COMPLETE HMA SURFACE REMOVAL, VARIABLE DEPTH, FOR THE RT AND LT LANES OF IL ROUTE 116 FROM STA. 21+20 TO STA. 22+50 AND STA. 27+45 TO STA. 29+05.
- CONSTRUCT TEMPORARY RAMP AT STA. 21+20 AND STA. 29+05 IF RE-OPENED TO TRAFFIC PRIOR TO PLACING LEVELING BINDER.
- CONSTRUCT THE REMAINING PROPOSED VARIABLE DEPTH HMA BINDER COURSE / LEVELING BINDER FOR THE RT AND LT LANES AND SHOULDERS OF IL ROUTE 116 FROM STA. 22+50 TO STA. 24+20 AND STA. 25+63 TO STA. 27+45.
- CONSTRUCT THE PROPOSED 3/4" LEVELING BINDER FOR THE RT AND LT LANES OF IL ROUTE 116 FROM STA. 21+20 TO STA. 24+20 AND STA. 25+63 TO STA. 29+05. THE 3/4" LEVELING BINDER SHALL ALSO BE PLACED ON THE SHOULDERS BETWEEN STA. 21+20 (23+18 LT) TO STA. 24+20 AND STA. 25+63 TO STA. 28+28 RT.
- CONSTRUCT THE PROPOSED HMA SURFACE COURSE FOR THE RT AND LT LANES OF IL ROUTE 116 FROM STA. 21+20 TO STA. 24+20 AND STA. 25+63 TO STA. 29+05. THE HMA SURFACE COURSE SHALL ALSO BE PLACED ON THE SHOULDERS BETWEEN STA. 21+20 (23+18 LT) TO STA. 24+20 AND STA. 25+63 TO STA. 28+28 RT.
- CONSTRUCT 5' HMA SHOULDERS ON THE LT SIDE OF IL ROUTE 116 FROM STA. 21+20 TO STA. 22+65 AND FROM STA. 28+28 TO STA. 29+05 ON BOTH SIDES OF IL ROUTE 116.
- CONSTRUCT PROPOSED ENTRANCES AND ALL REMAINING IMPROVEMENTS.

FILE NAME =	USER NAME = Schwankerg	DESIGNED - RGV
*FILES*	PLOT TIME = \$TIME\$	DRAWN - RGV
	PLOT SCALE = 20.0000' / in.	CHECKED - JRR
	PLOT DATE = 12/13/2012	DATE - 8/10/12

**DATES ASSOCIATES**  
Engineering + Architecture

1100 North Dearborn Street, Suite 100  
Chicago, IL 60610  
Tel: 312.467.7000  
Fax: 312.467.7001  
www.datesassociates.com

**STATE OF ILLINOIS  
DEPARTMENT OF TRANSPORTATION**

**STAGE 1 TYPICAL SECTIONS & STAGING NOTES**

SCALE: SHEET 1 OF 6 SHEETS STA. TO STA.

F.A.P. RTE.	SECTION	COUNTY	TOTAL SHEETS	SHEET NO.
681	(113 BR)BR & (113 BR-1)BR	LIVINGSTON	123	19
			CONTRACT NO. 66832	
ILLINOIS FED. AID PROJECT				