

MATCH LINE STA 25+00

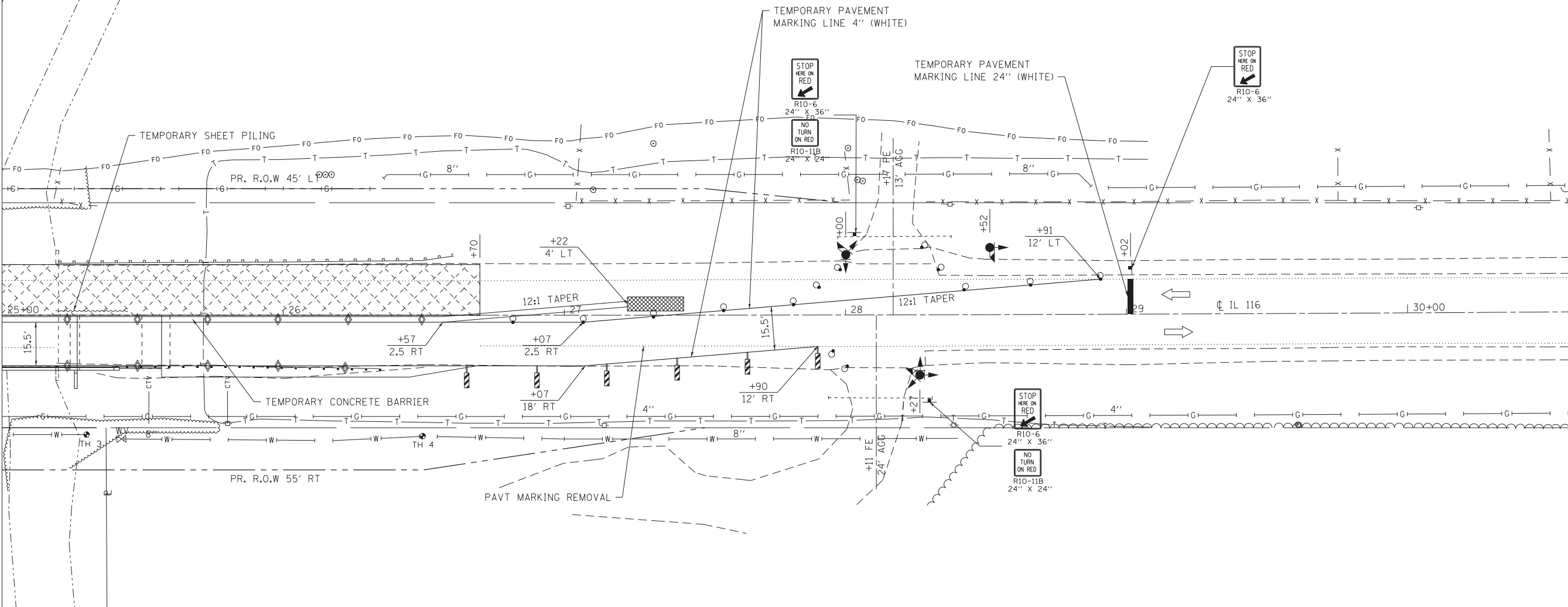

**LEGEND**

PLEASE CONTACT THE TRAFFIC SIGNAL SECTION AT 815-434-8506 72 HOURS BEFORE INSTALLING TEMPORARY TRAFFIC SIGNALS.

- TEMPORARY TRAFFIC SIGNALS WITH BACKPLATE
- TRAFFIC SIGNALS WITH BACKPLATE AND MICROWAVE DETECTORS
- TRAFFIC SIGNALS WITH BACKPLATE AND MICROWAVE DETECTORS, MAST ARM MOUNTED (SEE SPECIAL PROVISION)
- DRUM WITH STEADY BURNING LIGHT
- TEMPORARY PAVEMENT MARKING LINE, 24"
- IMPACT ATTENUATORS, TEMPORARY (NON-REDIRECTIVE) TEST LEVEL 3
- DOUBLE VERTICAL PANEL
- TYPE C BI-DIRECTIONAL REFLECTOR
- TYPE III BARRICADE WITH FLASHING LIGHTS
- STEADY BURNING LIGHTS AND DOUBLE VERTICAL PANELS
- WORK AREA
- SIGN
- HMA BASE COURSE, 8"
- DIRECTION OF TRAFFIC

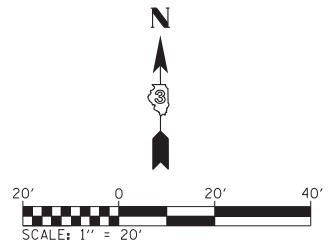

|             |                             |                |
|-------------|-----------------------------|----------------|
| FILE NAME = | USER NAME = Schwankerg      | DESIGNED - RGV |
| *FILES*     | PLOT TIME = \$TIME\$        | DRAWN - RGV    |
|             | PLOT SCALE = 20.0000' / in. | CHECKED - JRR  |
|             | PLOT DATE = 12/13/2012      | DATE - 8/10/12 |

**GATES ASSOCIATES**  
Engineering & Architecture

1140 E. Superior Street, Suite 100  
Chicago, IL 60604  
Tel: 312.467.7222  
Fax: 312.467.7223  
www.gatesassoc.com

1140 E. Superior Street, Suite 100  
Chicago, IL 60604  
Tel: 312.467.7222  
Fax: 312.467.7223  
www.gatesassoc.com

**STATE OF ILLINOIS  
DEPARTMENT OF TRANSPORTATION**

**STAGE 2 CONSTRUCTION & TRAFFIC CONTROL**

SCALE: 1"=20'    SHEET 6 OF 6 SHEETS    STA. 25+00 TO STA. 30+00

| F.A.P. RTE.               | SECTION                   | COUNTY     | TOTAL SHEETS | SHEET NO. |
|---------------------------|---------------------------|------------|--------------|-----------|
| 681                       | (113 BR)BR & (113 BR-1)BR | LIVINGSTON | 123          | 24        |
| CONTRACT NO. 66832        |                           |            |              |           |
| ILLINOIS FED. AID PROJECT |                           |            |              |           |