



The Subsurface Utility Engineering Company  
449 Munroe Falls Road  
Tallmadge, OH 44278  
(330) 794-4455

### Test Hole Certification Form Utility Quality Level A Data

ASCE C/I 38-02

Corporate Headquarters  
8397 Euclid Avenue  
Manassas Park, VA 20111  
(703) 361-6005

Control # **SIMD445**  
Test Hole # **1**  
Plan Scale **1" = 20'**  
Sheet # **1 OF 2**  
Proposed **BRIDGE**  
Date **APRIL 18, 2012**

City, County, State **PONTIAC, IL**  
Gen. Loc. **RTE 116 JUST W. OF SMITH BRANCH**  
Recorded Size/Material/Type **8" C.I. WATER LINE**  
Foreman/Truck#/Form By **E. CARROLL / 223 / T. BARRETT**

Condition of paving prior to work  
**NO PAVING**

B.M. 1 Elev. = **640.84'**  
is **GIVEN**

Description: **(BM 1) CHIS "[J]" FOUND, TOP OF NW WINGWALL, 19.09' LT OF CL STA 24+63.02, RTE 116**

So-Deep will attempt to use the BM/ HI most applicable to your design. If however, BMs differ by more than .05', resulting differences could cause design conflicts.

B.M. 2 Elev. = **640.11'**  
is **GIVEN**

Description: **(CP 500) STEEL PIN FOUND, IN GRASS ROW, 27.07' LT OF CL STA 23+32.63, RTE 116**

Benchmarks Check **BY 0.02'**  
Elevations are referenced to **B.M.#2**

Recorded Size/Type of utility **WAS FOUND**

There **WERE NOT** additional utilities in the test hole

The utility **WAS** in good condition

Paving Thickness and type **NO PAVING**

Color of ribbon installed **BLUE**

Soil Type **DARK BROWN**

Truck Location **GRAVEL LOT**

T.H. tied to **STEEL PIN**

**8 3/4" C.I. WATER LINE**  
Size/Material/Type  
Portion of pipe exposed for O.D. measurement:  
**FULL**

Remarks: **NONE**

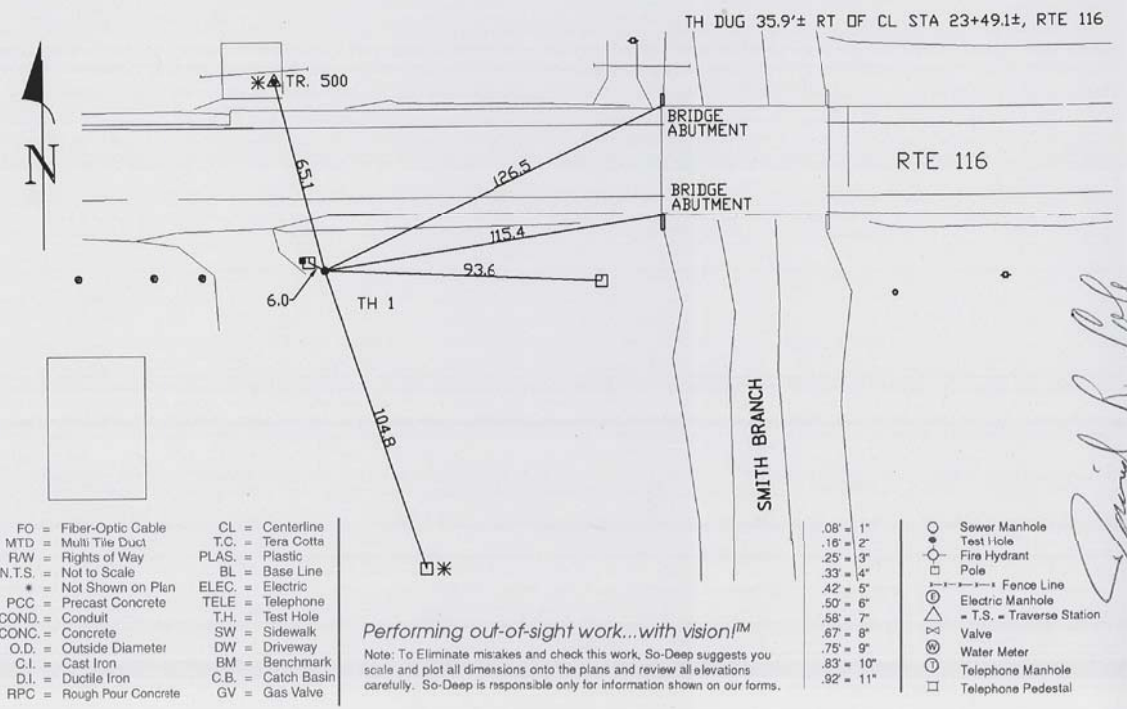
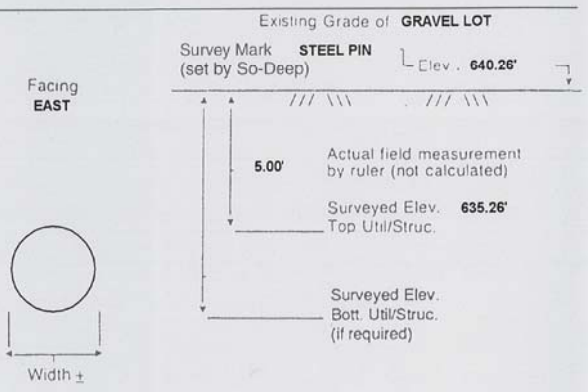

- FO = Fiber-Optic Cable
- MTD = Multi-Tile Duct
- R/W = Rights of Way
- N.T.S. = Not to Scale
- \* = Not Shown on Plan
- PCC = Precast Concrete
- COND. = Conduit
- CONC. = Concrete
- O.D. = Outside Diameter
- C.I. = Cast Iron
- D.I. = Ductile Iron
- RPC = Rough Pour Concrete
- CL = Centerline
- T.C. = Tera Cotta
- PLAS. = Plastic
- BL = Base Line
- ELEC. = Electric
- TELE = Telephone
- T.H. = Test Hole
- SW = Sidewalk
- DW = Driveway
- BM = Benchmark
- C.B. = Catch Basin
- GV = Gas Valve

Performing out-of-sight work...with vision!<sup>SM</sup>  
Note: To Eliminate mistakes and check this work, So-Deep suggests you scale and plot all dimensions onto the plans and review all elevations carefully. So-Deep is responsible only for information shown on our forms.

- .08" = 1"
- .16" = 2"
- .25" = 3"
- .33" = 4"
- .42" = 5"
- .50" = 6"
- .58" = 7"
- .67" = 8"
- .75" = 9"
- .83" = 10"
- .92" = 11"
- Sewer Manhole
- Test Hole
- Fire Hydrant
- Pole
- Fence Line
- Electric Manhole
- T.S. = Traverse Station
- Valve
- Water Meter
- Telephone Manhole
- Telephone Pedestal



The Subsurface Utility Engineering Company  
449 Munroe Falls Road  
Tallmadge, OH 44278  
(330) 794-4455

### Test Hole Certification Form Utility Quality Level A Data

ASCE C/I 38-02

Corporate Headquarters  
8397 Euclid Avenue  
Manassas Park, VA 20111  
(703) 361-6005

Control # **SIMD445**  
Test Hole # **2**  
Plan Scale **1" = 20'**  
Sheet # **1 OF 2**  
Proposed **BRIDGE**  
Date **APRIL 18, 2012**

City, County, State **PONTIAC, IL**  
Gen. Loc. **RTE 116 JUST W. OF SMITH BRANCH**  
Recorded Size/Material/Type **8" C.I. WATER LINE**  
Foreman/Truck#/Form By **E. CARROLL / 223 / T. BARRETT**

Condition of paving prior to work  
**NO PAVING**

B.M. 1 Elev. = **640.84'**  
is **GIVEN**

Description: **(BM 1) CHIS "[J]" FOUND, TOP OF NW WINGWALL, 19.09' LT OF CL STA 24+63.02, RTE 116**

So-Deep will attempt to use the BM/ HI most applicable to your design. If however, BMs differ by more than .05', resulting differences could cause design conflicts.

B.M. 2 Elev. = **640.11'**  
is **GIVEN**

Description: **(CP 500) STEEL PIN FOUND, IN GRASS ROW, 27.07' LT OF CL STA 23+32.63, RTE 116**

Benchmarks Check **BY 0.02'**  
Elevations are referenced to **B.M.#2**

Recorded Size/Type of utility **WAS FOUND**

There **WERE NOT** additional utilities in the test hole

The utility **WAS** in good condition

Paving Thickness and type **NO PAVING**

Color of ribbon installed **BLUE**

Soil Type **DARK BROWN**

Truck Location **WOODED ROW**

T.H. tied to **HUB**

**8 3/4" C.I. WATER LINE**  
Size/Material/Type  
Portion of pipe exposed for O.D. measurement:  
**FULL**

Remarks: **NONE**

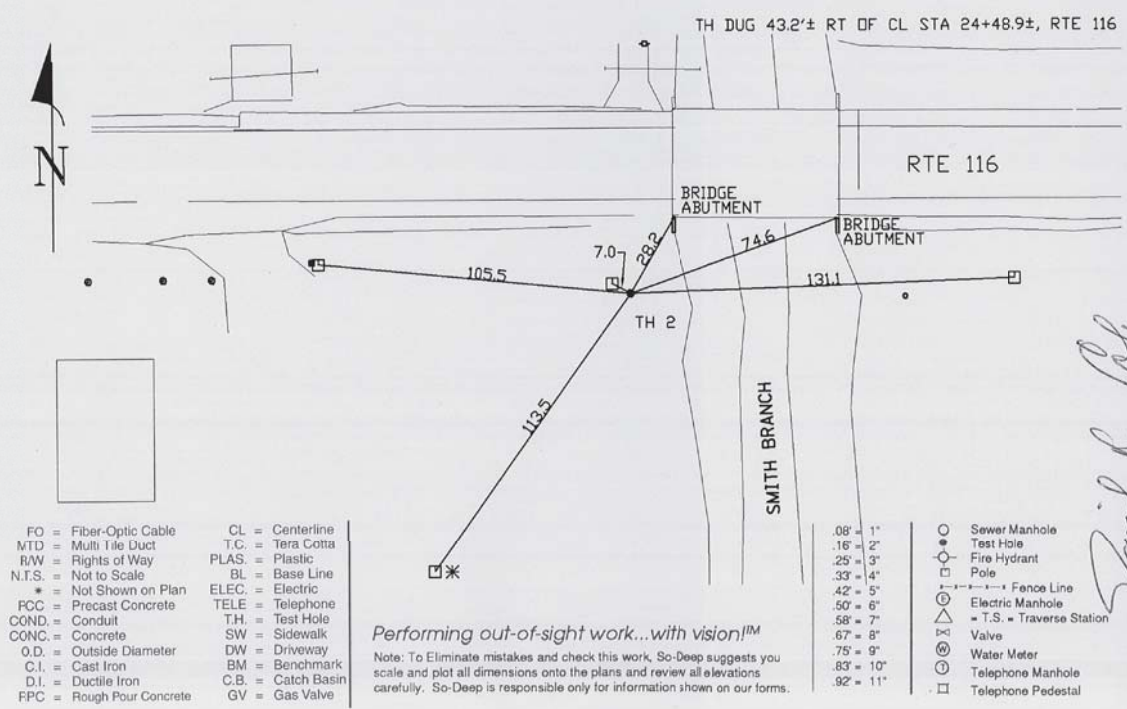
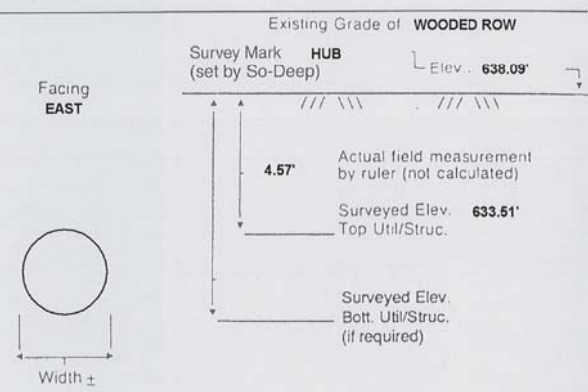

- FO = Fiber-Optic Cable
- MTD = Multi-Tile Duct
- R/W = Rights of Way
- N.T.S. = Not to Scale
- \* = Not Shown on Plan
- PCC = Precast Concrete
- COND. = Conduit
- CONC. = Concrete
- O.D. = Outside Diameter
- C.I. = Cast Iron
- D.I. = Ductile Iron
- RPC = Rough Pour Concrete
- CL = Centerline
- T.C. = Tera Cotta
- PLAS. = Plastic
- BL = Base Line
- ELEC. = Electric
- TELE = Telephone
- T.H. = Test Hole
- SW = Sidewalk
- DW = Driveway
- BM = Benchmark
- C.B. = Catch Basin
- GV = Gas Valve

Performing out-of-sight work...with vision!<sup>SM</sup>  
Note: To Eliminate mistakes and check this work, So-Deep suggests you scale and plot all dimensions onto the plans and review all elevations carefully. So-Deep is responsible only for information shown on our forms.

- .08" = 1"
- .16" = 2"
- .25" = 3"
- .33" = 4"
- .42" = 5"
- .50" = 6"
- .58" = 7"
- .67" = 8"
- .75" = 9"
- .83" = 10"
- .92" = 11"
- Sewer Manhole
- Test Hole
- Fire Hydrant
- Pole
- Fence Line
- Electric Manhole
- T.S. = Traverse Station
- Valve
- Water Meter
- Telephone Manhole
- Telephone Pedestal

FILE NAME =	USER NAME = <b>Schwankerg</b>	DESIGNED =
*FILES*	PLOT TIME = \$TIME\$	DRAWN =
	PLOT SCALE = <b>20.0000</b> / in.	CHECKED =
	PLOT DATE = <b>12/13/2012</b>	DATE =



STATE OF ILLINOIS  
DEPARTMENT OF TRANSPORTATION

UTILITY BORINGS

SCALE: NTS SHEET 1 OF 2 SHEETS STA. TO STA.

F.A.P. RTE.	SECTION	COUNTY	TOTAL SHEETS	SHEET NO.
681	(113 BR/BR & (113 BR-1)BR	LIVINGSTON	123	27
CONTRACT NO. 66832				
ILLINOIS FED. AID PROJECT				