

WEST FACE OF PARAPET

| Location | Station | Offset | Theoretical Grade Elevation | Theoretical Grade Elevation Adjusted for Dead Load Deflection |
|----------------------|----------|--------|-----------------------------|---|
| N. End of South Apr. | 58+27.61 | -18.50 | 649.10 | 649.10 |
| ☉ Piles South Abut. | 58+28.40 | -18.43 | 649.10 | 649.10 |
| A | 58+38.78 | -18.75 | 649.08 | 649.09 |
| ☉ Pier No. 1 | 58+50.45 | -19.20 | 649.06 | 649.06 |
| B | 58+60.84 | -19.39 | 649.05 | 649.05 |
| C | 58+71.24 | -19.37 | 649.05 | 649.05 |
| ☉ Pier No. 2 | 58+80.59 | -19.17 | 649.06 | 649.06 |
| D | 58+90.96 | -18.77 | 649.08 | 649.09 |
| ☉ Piles North Abut. | 59+01.60 | -18.43 | 649.10 | 649.10 |
| S. End of North Apr. | 59+02.39 | -18.50 | 649.10 | 649.10 |

☉ ROADWAY & PROFILE GRADE LINE (P.G.L.)

| Location | Station | Offset | Theoretical Grade Elevation | Theoretical Grade Elevation Adjusted for Dead Load Deflection |
|----------------------|----------|--------|-----------------------------|---|
| N. End of South Apr. | 58+28.97 | 0.00 | 650.21 | 650.21 |
| ☉ Piles South Abut. | 58+29.72 | 0.00 | 650.21 | 650.21 |
| A | 58+39.74 | 0.00 | 650.21 | 650.21 |
| ☉ Pier No. 1 | 58+51.00 | 0.00 | 650.21 | 650.21 |
| B | 58+61.00 | 0.00 | 650.21 | 650.21 |
| C | 58+71.00 | 0.00 | 650.21 | 650.21 |
| ☉ Pier No. 2 | 58+80.00 | 0.00 | 650.21 | 650.21 |
| D | 58+90.01 | 0.00 | 650.21 | 650.21 |
| ☉ Piles North Abut. | 59+00.28 | 0.00 | 650.21 | 650.21 |
| S. End of North Apr. | 59+01.03 | 0.00 | 650.21 | 650.21 |

EAST FACE OF PARAPET

| Location | Station | Offset | Theoretical Grade Elevation | Theoretical Grade Elevation Adjusted for Dead Load Deflection |
|----------------------|----------|--------|-----------------------------|---|
| N. End of South Apr. | 58+30.31 | 19.74 | 651.39 | 651.39 |
| ☉ Piles South Abut. | 58+31.02 | 19.56 | 651.38 | 651.38 |
| A | 58+40.63 | 18.70 | 651.33 | 651.33 |
| ☉ Pier No. 1 | 58+51.48 | 18.28 | 651.31 | 651.31 |
| B | 58+61.14 | 18.11 | 651.30 | 651.30 |
| C | 58+70.79 | 18.13 | 651.30 | 651.30 |
| ☉ Pier No. 2 | 58+79.48 | 18.31 | 651.31 | 651.31 |
| D | 58+89.13 | 18.69 | 651.33 | 651.33 |
| ☉ Piles North Abut. | 58+98.97 | 19.56 | 651.38 | 651.38 |
| S. End of North Apr. | 58+99.69 | 19.74 | 651.39 | 651.39 |

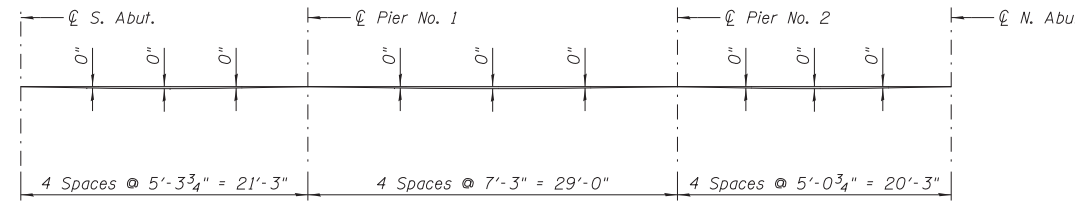

DEAD LOAD DEFLECTION DIAGRAM

(Includes weight of concrete only)

The above deflections are not for use in the field if the Engineer is working from the "Theoretical Grade Elevations Adjusted for Dead Load Deflection."

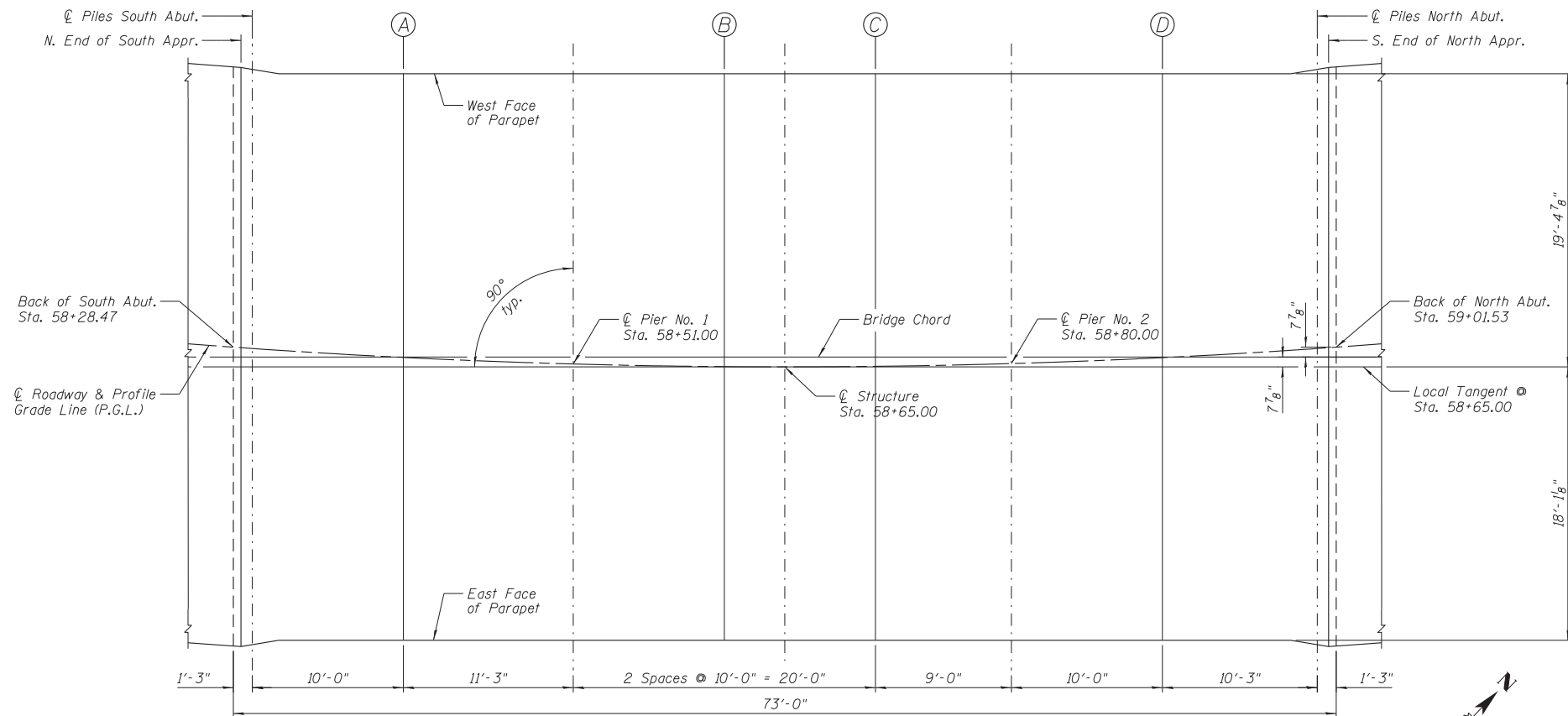

PLAN

