

SOUTH APPROACH PLAN

* Tilt #9 bg(E) bars as required to maintain clearance.

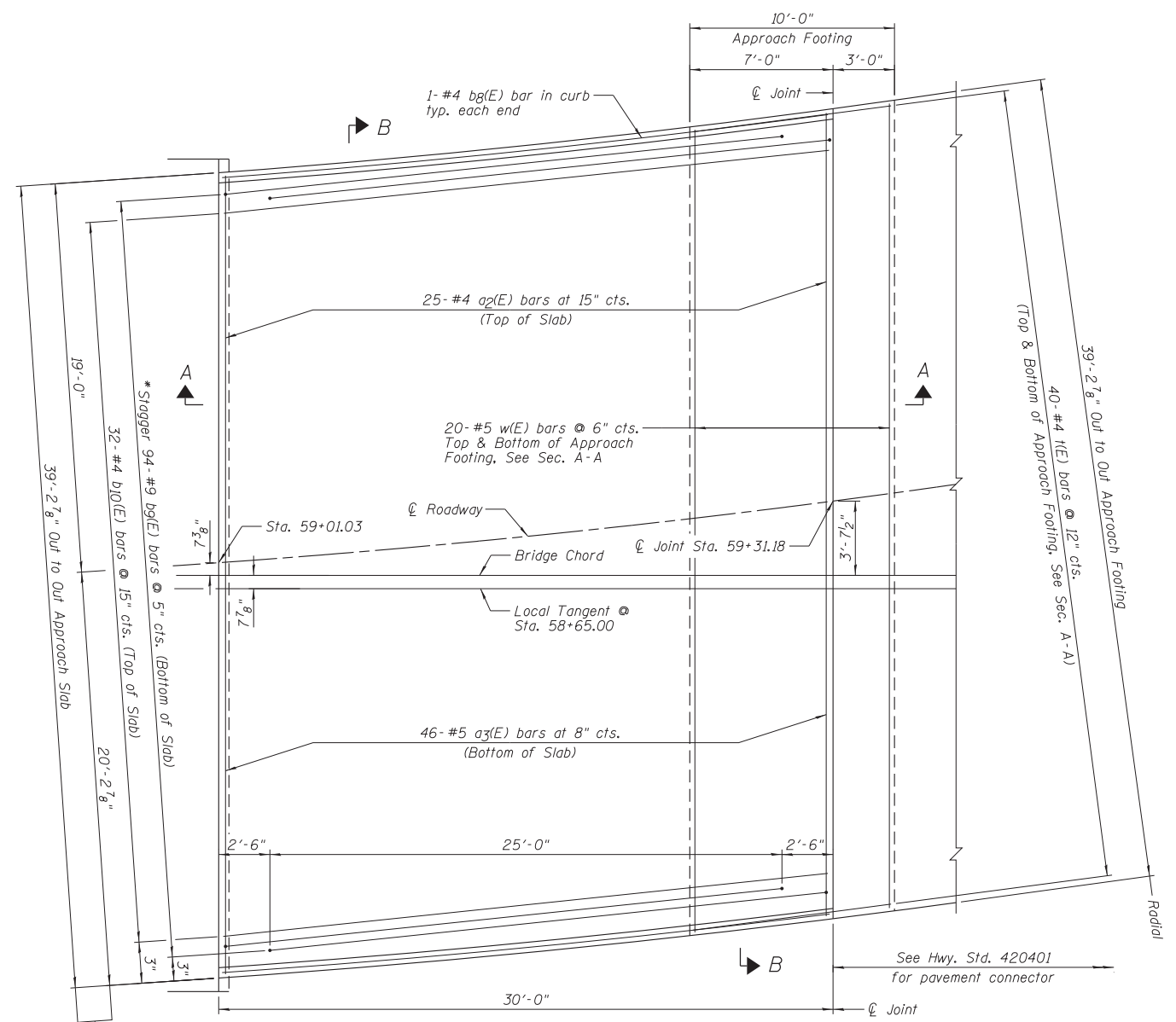

NORTH APPROACH PLAN

* Tilt #9 bg(E) bars as required to maintain clearance.

NOTES:

- 1.) See Sheet B9 for Sections A-A and B-B.
- 2.) a2(E) and a3(E) bar spacings measured along Local Tangent.

Farnsworth GROUP, INC.
2709 McGraw Drive
Bloomington, Illinois 61704
309/663-8435, 309/663-1571 fax

DESIGNED - TCR	REVISION
CHECKED - JML	REVISION
DRAWN - JWK	REVISION
CHECKED - MSW	REVISION
DATE - 11/27/12	

DESIGNED - TCR	REVISION
CHECKED - JML	REVISION
DRAWN - JWK	REVISION
CHECKED - MSW	REVISION

**STATE OF ILLINOIS
DEPARTMENT OF TRANSPORTATION**

**BRIDGE APPROACH SLAB DETAILS
STRUCTURE NO. 053-0191**

SHEET NO. 88 OF 17 SHEETS

F.A.P. RTE.	SECTION	COUNTY	TOTAL SHEETS	SHEET NO.
681	(113 BR)BR & (113 BR-1)BR	LIVINGSTON	123	96
CONTRACT NO. 66832				

ILLINOIS FED. AID PROJECT