

PLAN

SYMBOLS

- ↑ ARROW BOARD
- ▨ WORK AREA
- ⊥ SIGN
- TRAFFIC CONTROL DRUM WITH STEADY BURN MONODIRECTIONAL LIGHT
- FLAGGER
- ▬ TEMPORARY CONCRETE BARRIER
- ◁ MONODIRECTIONAL BARRIER WALL/GUARDRAIL MARKER
- ▩ IMPACT ATTENUATOR

- R2-1106-3618 MINIMUM 500X FINE
- W2-1113(O)-3612 BEGINS
- R2-1-3648 45 SPEED LIMIT
- W2-1115(O)-3618 WORK ZONE

- G20-1103(O)-3660 END WORK ZONE SPEED LIMIT
- R2-1106-3618 MINIMUM 500X FINE
- W2-1113(O)-3612 BEGINS
- R2-1-3648 55 SPEED LIMIT
- W2-1115(O)-3618 WORK ZONE

GENERAL NOTES

THIS STANDARD IS USED WHERE AT ANY TIME ANY VEHICLE, EQUIPMENT, WORKERS OR THEIR ACTIVITIES WILL ENCROACH ON THE PAVEMENT OR ON THE SHOULDER WITHIN 24 INCHES OF THE EDGE OF PAVEMENT FOR DAYLIGHT OPERATION EXCEEDING ONE DAY AND WHERE TEMPORARY CONCRETE BARRIER IS UTILIZED.

THIS STANDARD MUST BE USED IN COMBINATION WITH STANDARD 701400 (SPECIAL).

WHEN WORK IS BEING PERFORMED IN THE LEFT LANE, THE SET UP WOULD BE A MIRROR IMAGE TO WHAT IS SHOWN.

FLAGGER, FLAGGER SIGNS AND SPEED LIMIT SIGNS SHALL BE REQUIRED WHENEVER TEMPORARY CONCRETE BARRIER IS NOT IN PLACE. WHEN TEMPORARY CONCRETE BARRIER IS IN PLACE, THE FLAGGER SIGNS SHALL BE REMOVED OR COVERED AND THE FLAGGER NOT REQUIRED.

TEMPORARY CONCRETE BARRIER SHALL BE ACCORDING TO STANDARD 704001.

- ① TEMPORARY PAVEMENT MARKING
- ② EXISTING PAVEMENT MARKING

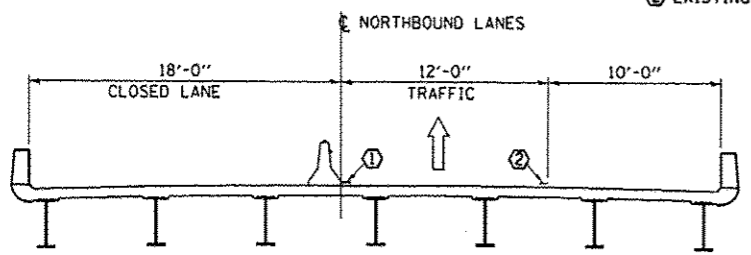

LEFT LANE CLOSURE
LOOKING IN DIRECTION OF TRAFFIC

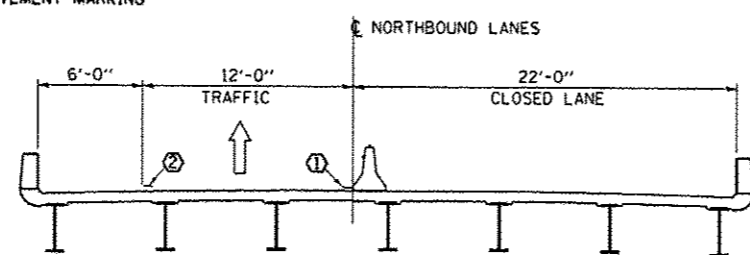

RIGHT LANE CLOSURE
LOOKING IN DIRECTION OF TRAFFIC

NOTE: TRAFFIC CONTROL AND PROTECTION FOR TWO-LANE ROADS SHALL BE ACCORDING TO STANDARD 701201.

| | | | |
|--|----------------------------|---------------|-----------|
| FILE NAME = | USER NAME = woodshankr1 | DESIGNED - RW | REVISED - |
| c:\pwork\pwork\woodshankr1\d8319821\066601-sht-details.dgn | | DRAWN - RW | REVISED - |
| #MODELNAME# | PLOT SCALE = 1/80.0000 "/> | CHECKED - | REVISED - |
| | PLOT DATE = 11/15/2012 | DATE - | REVISED - |

STATE OF ILLINOIS
DEPARTMENT OF TRANSPORTATION

TRAFFIC CONTROL AND PROTECTION
STANDARD 701402 (SPECIAL)

| | | | | |
|-----------------------------|--------------|---------|--------------|-----------|
| F.A.T. RTE. # | SECTION | COUNTY | TOTAL SHEETS | SHEET NO. |
| 57 | (38-5HB-3)BP | IROUOIS | 8 | 6 |
| CONTRACT NO. 66C61 | | | | |
| [ILLINOIS] FED. AID PROJECT | | | | |

SCALE: SHEET 1 OF 1 SHEETS STA. TO STA.