

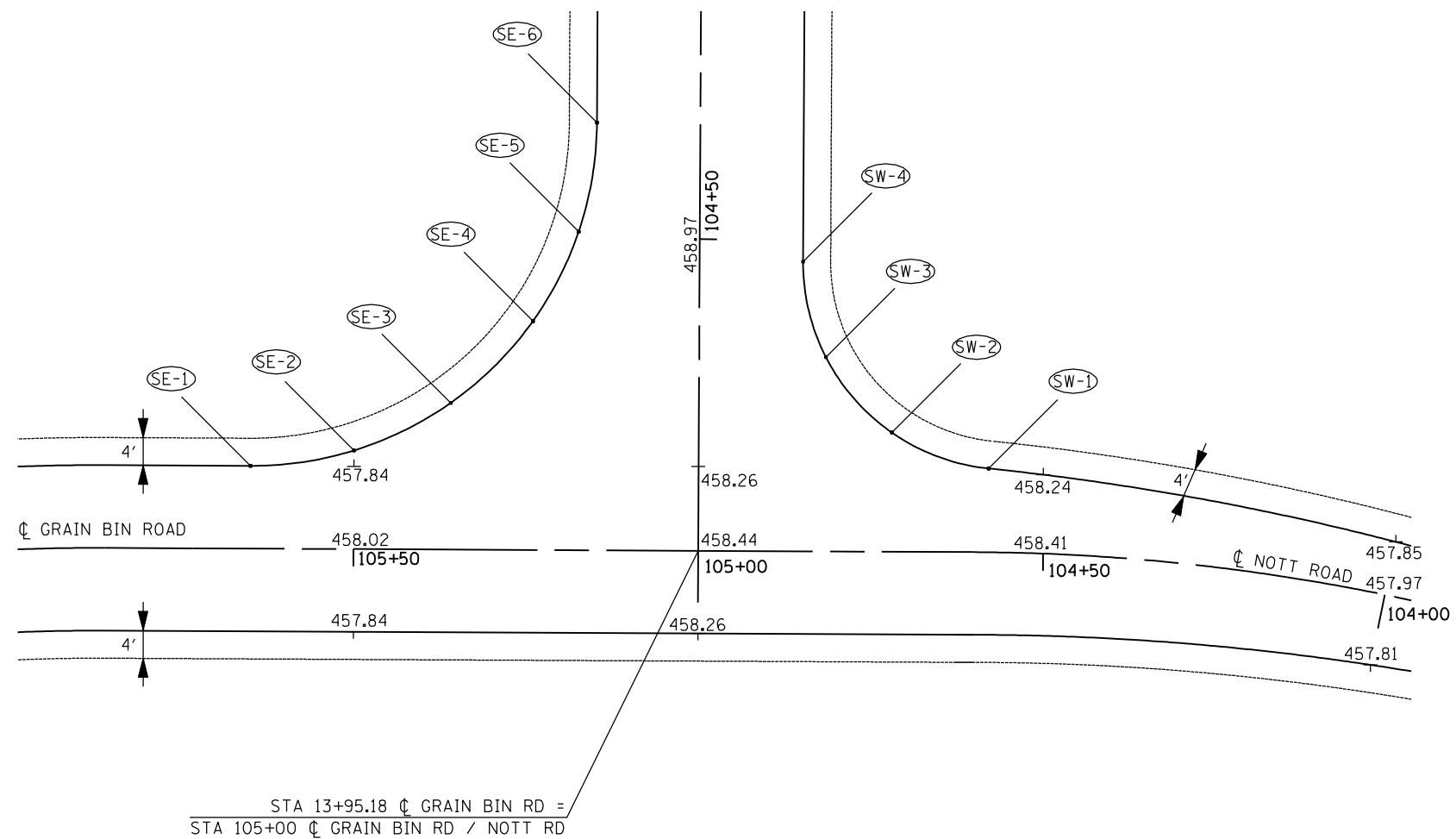

SOUTH EAST				
POINT	STATION	OFFSET	RADIUS_EOP_ELEVATION	EXTENDED_EOP_ELEVATION
POINTS ALONG GRAIN BIN RD/NOTT RD				12' OFFSET
SE-1	105+65.00	12.0	457.69	457.69
SE-2	105+50.00	14.3	457.81	457.84
SE-3	105+36.00	21.3	457.84	457.98
POINTS ALONG GRAIN BIN RD				15' OFFSET
SE-4	13+62.00	24.1	458.53	458.59
SE-5	13+49.00	17.6	458.83	458.85
SE-6	13+33.84	15.0	459.16	459.16

SOUTH WEST				
POINT	STATION	OFFSET	RADIUS_EOP_ELEVATION	EXTENDED_EOP_ELEVATION
POINTS ALONG GRAIN BIN RD/NOTT RD				12' OFFSET
SW-1	104+58.00	12.0	458.27	458.27
SW-2	104+72.00	17.3	458.22	458.30
POINTS ALONG GRAIN RD				15' OFFSET
SW-3	13+67.00	18.4	458.48	458.50
SW-4	13+53.85	15.0	458.66	458.66



FILE NAME =  
SFILES

**SDI** STRUCTURE DESIGNS, INCORPORATED  
ARCHITECTS & ENGINEERS  
PH: (312) 561-9780 www.structuredesignsinc.com

USER NAME = *USER*	DESIGNED - JL / RY	REVISED -
	DRAWN - JL / RY	REVISED -
PLOT SCALE = *SCALE*	CHECKED - JES	REVISED -
PLOT DATE = *DATE*	DATE - 12-17-2012	REVISED -

**STATE OF ILLINOIS  
DEPARTMENT OF TRANSPORTATION**

**INTERSECTION DETAILS  
US RTE 24 OVER BIG SISTER CREEK & LITTLE SISTER CREEK**

SCALE: SHEET NO. 2 OF 3 SHEETS STA. TO STA.

F.A.P. RTE.	SECTION	COUNTY	TOTAL SHEETS	SHEET NO.
317	(137BR, BR-1) BR	FULTON	118	37
CONTRACT NO. 68699				
ILLINOIS FED. AID PROJECT				