

# DETOUR RAMP D

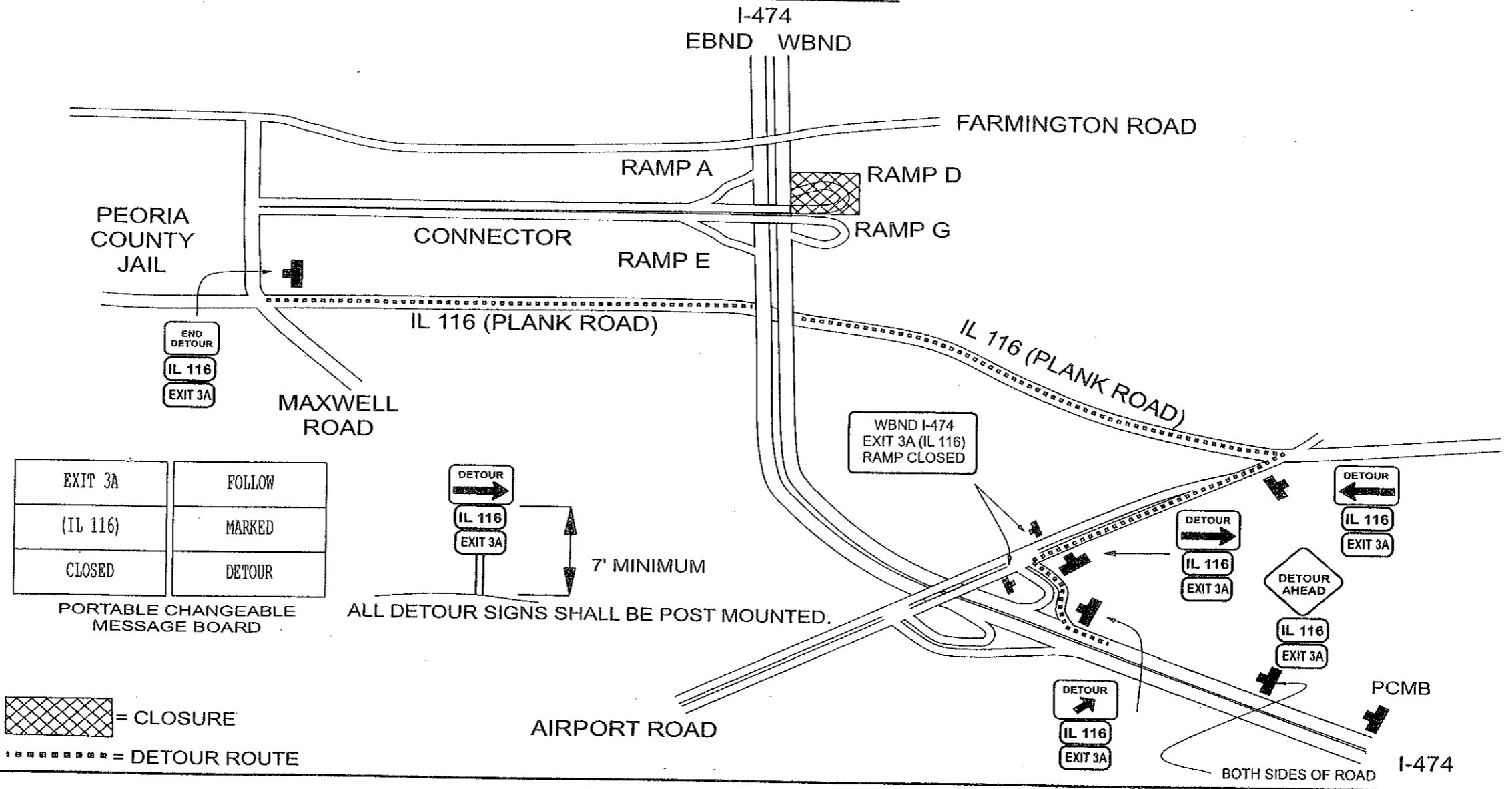

EXIT 3A	FOLLOW
(IL 116)	MARKED
CLOSED	DETOUR

PORTABLE CHANGEABLE MESSAGE BOARD

DETOUR  
IL 116  
EXIT 3A  
7' MINIMUM  
ALL DETOUR SIGNS SHALL BE POST MOUNTED.

= CLOSURE  
 = DETOUR ROUTE

**NOTES:**  
 ALL DETOUR SIGNAGE SHALL BE A MINIMUM OF 7' ABOVE GROUND.  
 SIGNS SHALL BE PLACED A MINIMUM OF 250' PRIOR TO TURNS.  
 THIS DISTANCE SHALL BE 500' ON I-474. SIGNS MAY BE ADJUSTED IF THERE ARE CONFLICTS.

FILE NAME : D:\68883-Sht-Closed-plan.dgn	USER NAME : jonesae	DESIGNED -	REVISED -
Default	PLOT SCALE = 1/8" = 1'	DRAWN -	REVISED -
	PLOT DATE = 12/11/2012	CHECKED -	REVISED -
		DATE -	REVISED -

STATE OF ILLINOIS  
DEPARTMENT OF TRANSPORTATION

DETOUR RAMP G	
SCALE:	SHEET OF SHEETS STA. TO STA.

F.A.I. RTE.	SECTION	COUNTY	TOTAL SHEETS	SHEET NO.
474	172-348-11L 1-1	PEORIA	89	14
MAXWELL RD. CONN. OVER I-474		CONTRACT NO. 68883		ILLINOIS FED. AID PROJECT