

Notes:
 See sheet 38 of 62 for Sections C-C & D-D and View E-E.
 $a_{20}(E)$, $a_{21}(E)$, $a_{22}(E)$, and $a_{23}(E)$ bar spacings measured along \varnothing Rdwy.
 Increase lap $a_{20}(E)$, $a_{21}(E)$, $a_{22}(E)$, and $a_{23}(E)$ bars to fit end post and taper.

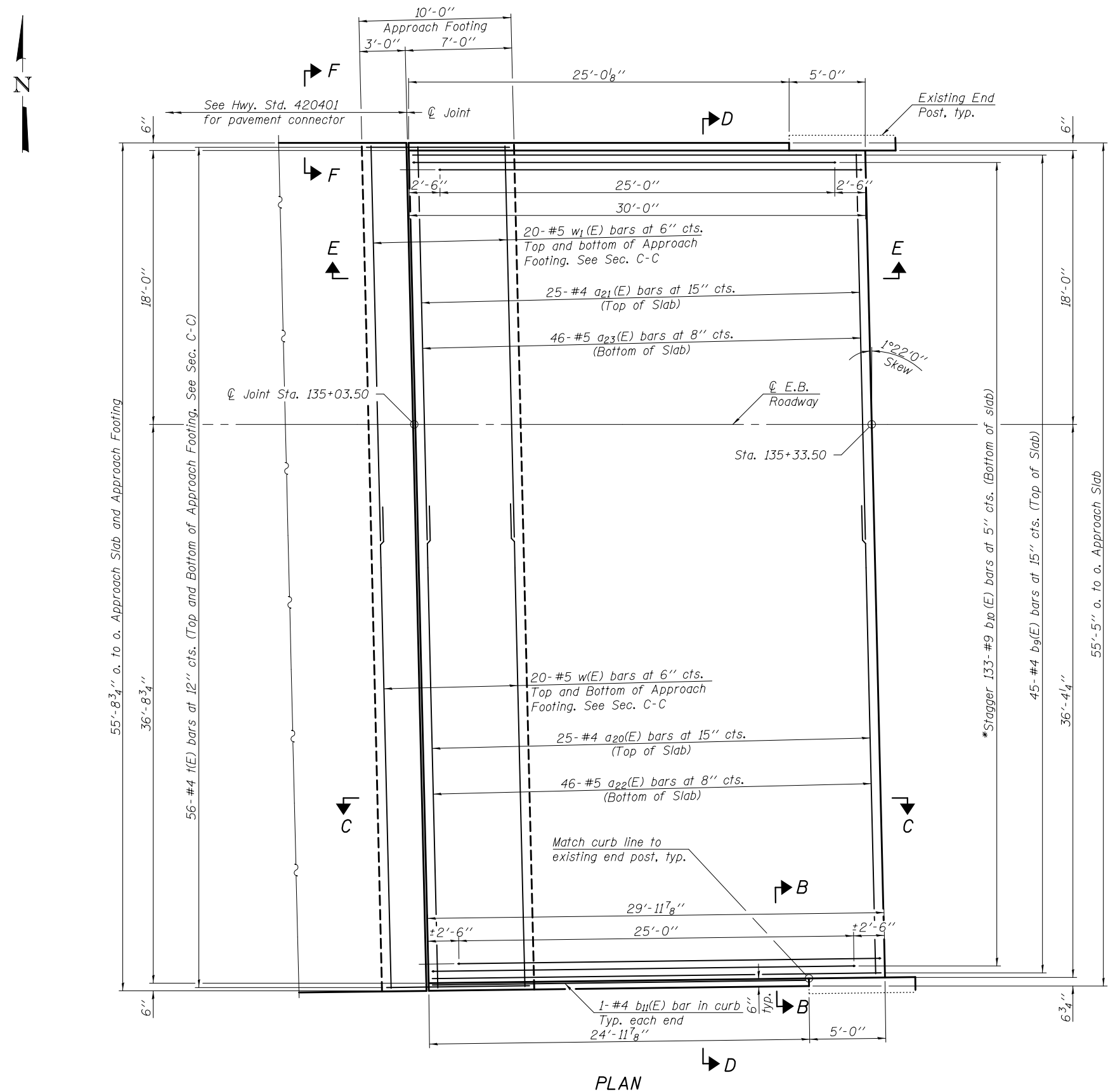

PLAN

* Tilt #9 $b_{10}(E)$ bars as required to maintain clearance.

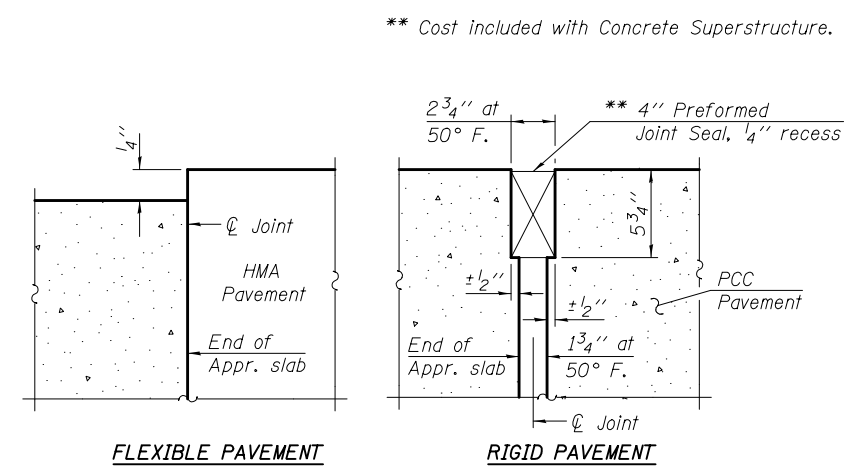

DETAIL A

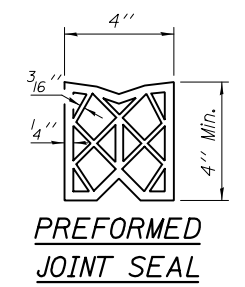

PREFORMED JOINT SEAL

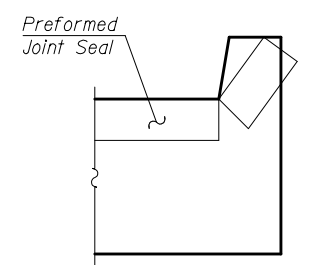

VIEW F-F

Angle Preformed Joint Seal at 45° at curbs when req'd for drainage.

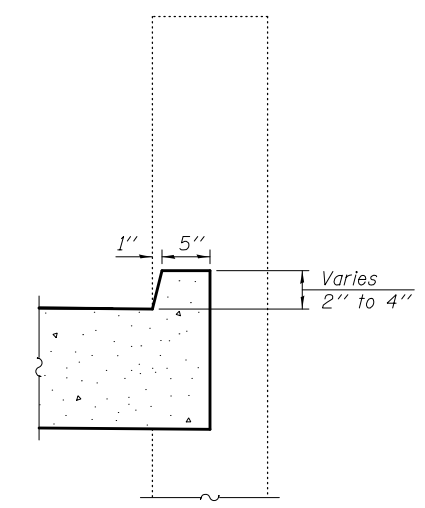

VIEW B-B

MIN. BAR LAPS

#4 bar = 2'-7"
 #5 bar = 3'-3"

(Sheet 1 of 2)

FILE NAME =	USER NAME = #USER*	DESIGNED K.A. KLUES	REVISED - 12/17/12 DHC/JKS	STATE OF ILLINOIS DEPARTMENT OF TRANSPORTATION	HORNER & SHIRIN, INC. ENGINEERS	WEST APPROACH SLAB DETAILS (E.B.) STRUCTURE NOS. 072-0119 (E.B.) & 072-0120 (W.B.)	F.A.I. RTE.	SECTION	COUNTY	TOTAL SHEETS	SHEET NO.
FILE		CHECKED E.M. LAGEMANN	Del. Staging (IDOT)				474	(72-3HB-1),I	PEORIA	88	53
PLOT SCALE =		DRAWN K.A. KLUES	REVISED -				CONTRACT NO. 68883				
PLOT DATE = #DATE*		CHECKED E.M. LAGEMANN	REVISED -	SHEET NO. 37 OF 62 SHEETS				ILLINOIS FED. AID PROJECT			