

STATE OF ILLINOIS  
DEPARTMENT OF TRANSPORTATION  
DIVISION OF HIGHWAYS

**PROPOSED  
HIGHWAY PLANS**

FAP ROUTE 63 (US 24 & IL 96), FAP 506 (IL 96)  
SECTION (1)N,TS-2,RS-5&(78)RS-3  
PROJECT FHSIP-0005(915)  
RESURFACING (SMART), INTERSECTION  
IMPROVEMENT, & TRAFFIC SIGNALS  
ADAMS COUNTY  
C-96-059-11

F.A.P. RTE.	SECTION	COUNTY	TOTAL SHEETS	SHEET NO.
*	(1)N,TS-2RS-5&(78)RS-3	ADAMS	194	1
ILLINOIS		CONTRACT NO. 72E31		
* FAP 63 (US 24) FAP 63 (US 24/IL 96) FAP 506 (IL 96)				

D-96-059-11

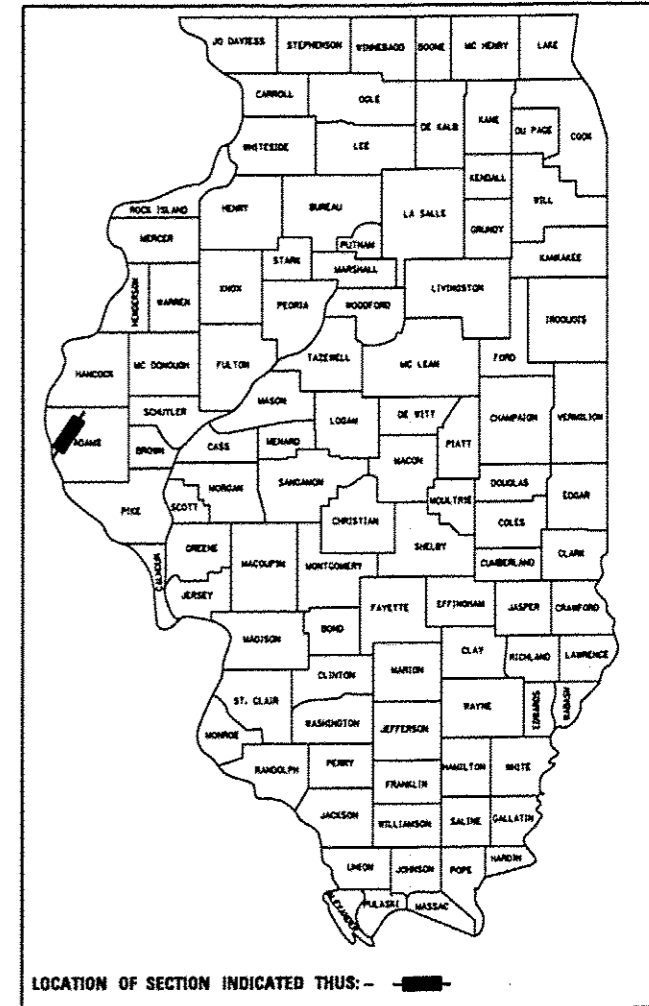

FOR INDEX OF SHEETS, SEE SHEET NO. 2

HIGHWAY CLASSIFICATION

F.A.P. ROUTE 63 (US 24) & (IL 96)

0.3 MI. S. OF IL 96 (S) TO 0.4 MI. N. OF US 24/IL 96 (N)

CLASSIFICATION: MINOR ARTERIAL

ADT: 5,424 (2011) PV = 92.0%

ADT: 8,060 (2031) SU = 2.5%

DESIGN SPEED: 60 MPH MU = 5.5%

POSTED SPEED: 55 MPH

LIMITS OF IMPROVEMENT  
SECTION (1)N,TS-2RS-5&(78)RS-3  
ENDS AT STA. 20+20.41

STATION EQUATION  
STA. 353+82.07 BK. =  
STA. 15+64.80 AH.

STATION EQUATION  
STA. 298+01.63 BK. =  
STA. 298+20.65 AH.

LIMITS OF IMPROVEMENT  
SECTION (1)N,TS-2RS-5&(78)RS-3  
BEGINS AT STA. 285+50.00

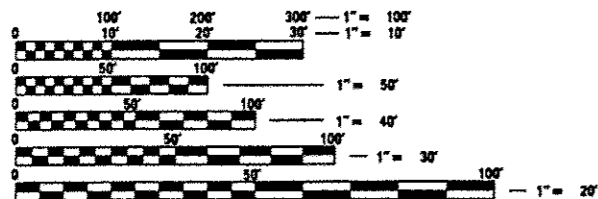
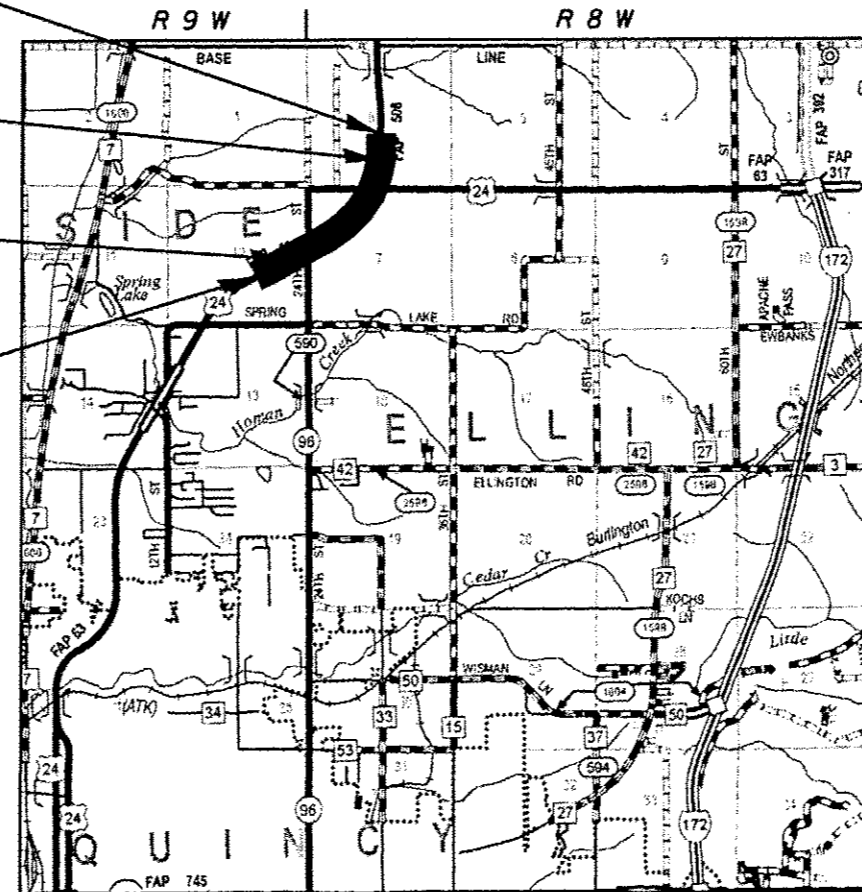

FULL SIZE PLANS HAVE BEEN PREPARED USING STANDARD ENGINEERING SCALES. REDUCED SIZED PLANS WILL NOT CONFORM TO STANDARD SCALES. IN MAKING MEASUREMENTS ON REDUCED PLANS, THE ABOVE SCALES MAY BE USED.

J.U.L.I.E.  
JOINT UTILITY LOCATION INFORMATION FOR EXCAVATION  
1-800-892-0123  
OR 811

SENIOR TEAM ENGINEER: MARK DUST 785-0597  
TEAM ENGINEER: RENE CABRERA 557-9062

CONTRACT NO. 72E31

GROSS LENGTH = 7268.66 FT. = 1.377 MILE  
NET LENGTH = 7268.66 FT. = 1.377 MILE

STATE OF ILLINOIS  
DEPARTMENT OF TRANSPORTATION  
DIVISION OF HIGHWAYS

SUBMITTED December 4, 2012  
Reg 2 Duval  
DEPUTY DIRECTOR OF HIGHWAYS, REGION ENGINEER

Feb 1, 2013  
John D. Baranzoni, P.E.  
acting ENGINEER OF DESIGN AND ENVIRONMENT

Feb 1, 2013  
Omer Osman, P.E.  
DIRECTOR OF HIGHWAYS, CHIEF ENGINEER

PRINTED BY THE AUTHORITY  
OF THE STATE OF ILLINOIS