

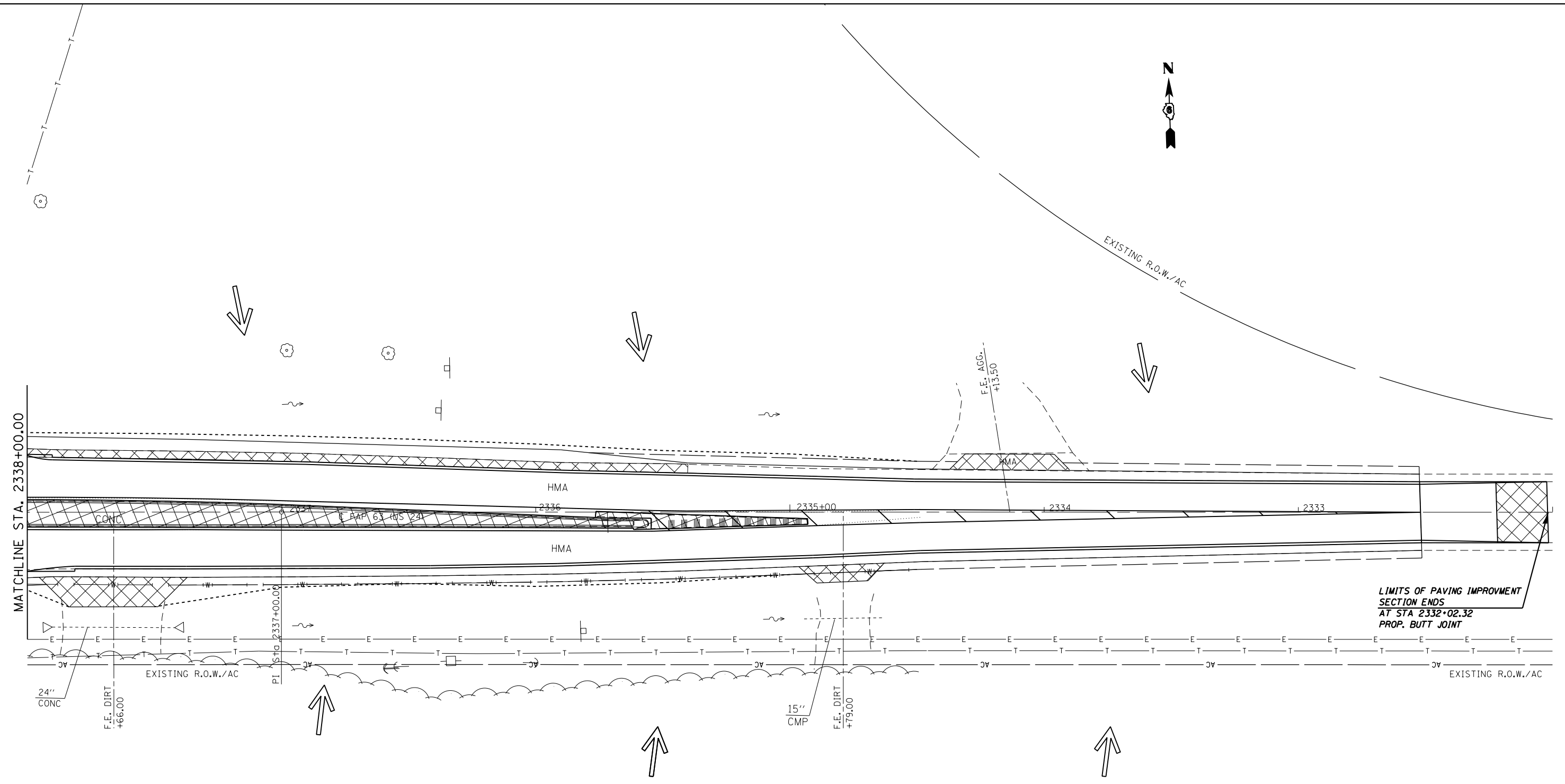

EXISTING R.O.W./AC



LIMITS OF PAVING IMPROVEMENT  
SECTION ENDS  
AT STA 2332+02.32  
PROP. BUTT JOINT

FILE NAME =	USER NAME = sparksgw	DESIGNED -	REVISED -
ci:\pw\work\p\id\sparksgw\0259630\067	PE31-sht-swpplan.i20.dgn	DRAWN -	REVISED -
PLANS	PLOT SCALE = 40.0000' / in.	CHECKED -	REVISED -
	PLOT DATE = Dec-14-2012 04:04:37PM	DATE -	REVISED -

STATE OF ILLINOIS  
DEPARTMENT OF TRANSPORTATION

STORM WATER POLLUTION  
PREVENTION PLAN

SCALE: 20 SHEET 18 OF 18 SHEETS STA. 2338+00.00 TO STA. 2332+02.32

F.A.P. RTE.	SECTION	COUNTY	TOTAL SHEETS	SHEET NO.
	(1)N,TS-2RS-5&(7)RS-3	ADAMS	194	101
CONTRACT NO. 72E31			ILLINOIS FED. AID PROJECT	

• FAP 63 (US 24); FAP 63 (US 24/IL 96); FAP 506 (IL 96)