

POINT	STATION	OFFSET	PR. ELEV.	EX. ELEV.	DESCRIPTION
18	337+35.51	3.59' LT.	653.43	653.27	EDGE OF PAVMENT
19	338+07.07	9.09' LT.	653.74	653.22	CORNER OF MEDIAN
20	338+07.10	17.09' LT.	653.77	653.30	CORNER OF MEDIAN
21	338+34.68	6.08' RT.	653.54	652.88	CORNER OF MEDIAN
22	339+17.49	8.74' RT.	653.02	652.32	CORNER OF MEDIAN
23	339+17.97	16.49' RT.	652.98	653.18	CORNER OF MEDIAN

POINT	STATION	OFFSET	PR. ELEV.	EX. ELEV.	DESCRIPTION
24	337+61.33	49.62' RT.	654.29	653.53	CORNER OF ISLAND
25	338+82.32	49.59' RT.	654.32	653.65	CORNER OF ISLAND
26	337+91.73	71.62' RT.	654.28	653.59	CORNER OF ISLAND
27	337+88.13	73.21' RT.	654.26	653.52	CORNER OF ISLAND
28	337+61.33	53.62' RT.	654.27	653.47	CORNER OF ISLAND
29	338+35.15	49.15' RT.	654.27	653.74	CORNER OF ISLAND
30	338+64.96	49.17' RT.	654.20	653.57	CORNER OF ISLAND
31	338+64.96	53.17' RT.	654.19	653.53	CORNER OF ISLAND
32	338+47.39	68.64' RT.	654.25	653.69	CORNER OF ISLAND
33	338+40.74	66.94' RT.	654.25	653.76	CORNER OF ISLAND

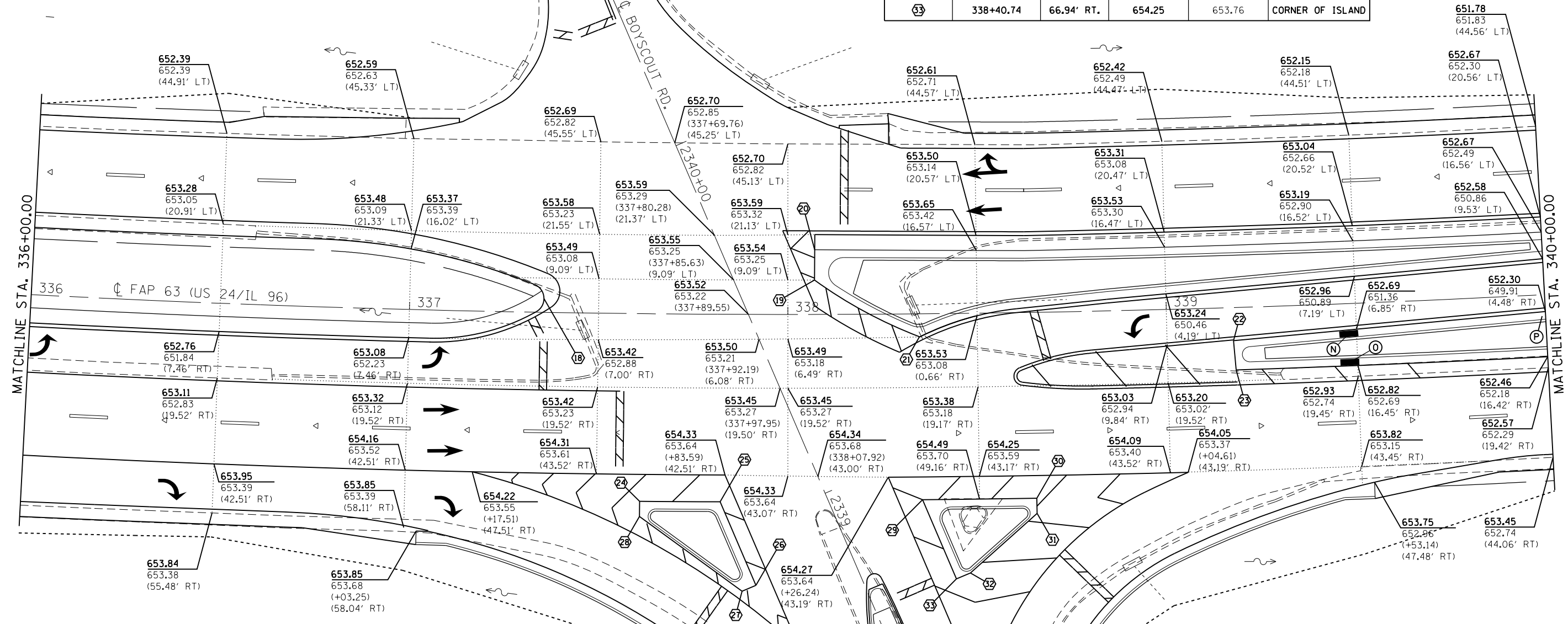
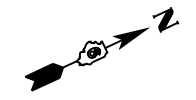

NOTE: SEE SHEET XX FOR EB US 24 ELEVATION DETAILS

LEGEND

PR. ELEV.
EX. ELEV.
(OFFSET)

POINT	STATION	OFFSET	PR. ELEV.	DESCRIPTION
(N)	339+48.00	7.96' RT.	652.57	TOP OF INLET (R)
(O)	339+48.00	15.45' RT.	652.70	TOP OF INLET (R)
(P)	340+00.00	5.49' RT.	652.18	TOP OF INLET (R)

FILE NAME =	USER NAME = sparksgw	DESIGNED -	REVISED -
c:\pw\work\p\d0259630\067	PE31-shr-elevplan.(20).dgn	DRAWN -	REVISED -
Default	PLOT DATE = Dec-14-2012 03:45:42PM	CHECKED -	REVISED -
		DATE -	REVISED -

**STATE OF ILLINOIS
DEPARTMENT OF TRANSPORTATION**

ELEVATION DETAILS

SCALE: NTS SHEET 8 OF 12 SHEETS STA. 336+00.00 TO STA. 340+00.00

• FAP 63 (US 24); FAP 63 (US 24/IL 96); FAP 506 (IL 96)				
F.A.P. RTE.	SECTION	COUNTY	TOTAL SHEETS	SHEET NO.
	(1)N,TS-2RS-5&(7)RS-3	ADAMS	194	115
CONTRACT NO.			72E31	
ILLINOIS FED. AID PROJECT				