

TRAFFIC SIGNAL QUANTITIES

LOCATION: US 24 @ IL 96

QUANTITY	UNIT	ITEM
-	SQ FT	SIGN PANEL, TYPE 2
120.0	FOOT	UNDERGROUND CONDUIT, PVC, 1 1/2" DIA.
190.0	FOOT	UNDERGROUND CONDUIT, PVC, 2" DIA.
180.0	FOOT	UNDERGROUND CONDUIT, PVC, 2 1/2" DIA.
55.0	FOOT	UNDERGROUND CONDUIT, PVC, 3" DIA.
12.0	FOOT	UNDERGROUND CONDUIT, PVC, 4" DIA.

1	EACH	INTERSECTION MONITOR UNIT
1	EACH	FULL-ACTUATED CONTROLLER AND TYPE V CABINET
1	EACH	TRANSCEIVER - FIBER OPTIC
1696	FOOT	ELECTRIC CABLE IN CONDUIT, SIGNAL NO. 14, 5C
1165	FOOT	ELECTRIC CABLE IN CONDUIT, SIGNAL NO. 14, 7C
95	FOOT	ELECTRIC CABLE IN CONDUIT, SIGNAL NO. 14, 9C
13	FOOT	ELECTRIC CABLE IN CONDUIT, SERVICE NO. 6, 2C

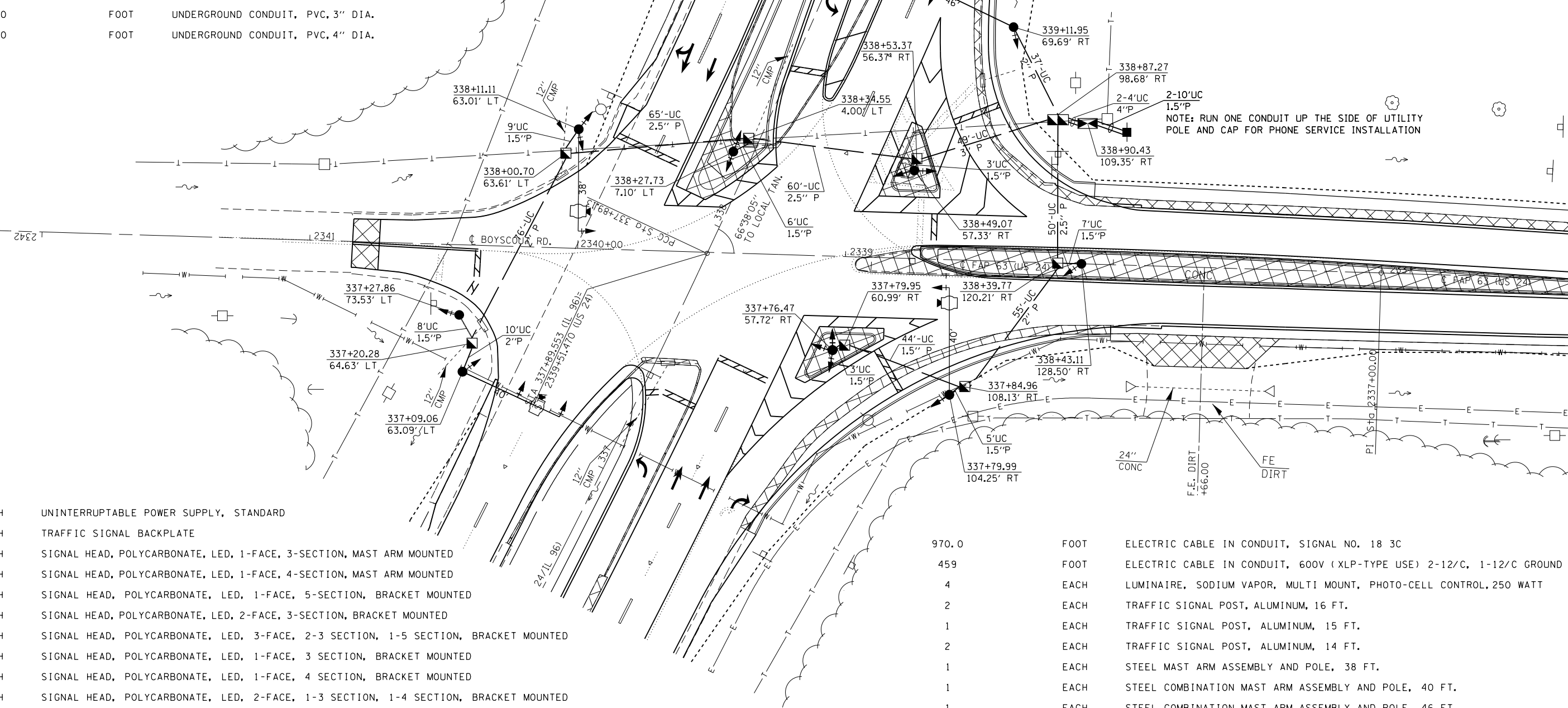

NOTE: RUN ONE CONDUIT UP THE SIDE OF UTILITY POLE AND CAP FOR PHONE SERVICE INSTALLATION

1	EACH	UNINTERRUPTABLE POWER SUPPLY, STANDARD	
20	EACH	TRAFFIC SIGNAL BACKPLATE	
4	EACH	SIGNAL HEAD, POLYCARBONATE, LED, 1-FACE, 3-SECTION, MAST ARM MOUNTED	
2	EACH	SIGNAL HEAD, POLYCARBONATE, LED, 1-FACE, 4-SECTION, MAST ARM MOUNTED	
2	EACH	SIGNAL HEAD, POLYCARBONATE, LED, 1-FACE, 5-SECTION, BRACKET MOUNTED	
2	EACH	SIGNAL HEAD, POLYCARBONATE, LED, 2-FACE, 3-SECTION, BRACKET MOUNTED	
1	EACH	SIGNAL HEAD, POLYCARBONATE, LED, 3-FACE, 2-3 SECTION, 1-5 SECTION, BRACKET MOUNTED	
2	EACH	SIGNAL HEAD, POLYCARBONATE, LED, 1-FACE, 3 SECTION, BRACKET MOUNTED	
1	EACH	SIGNAL HEAD, POLYCARBONATE, LED, 1-FACE, 4 SECTION, BRACKET MOUNTED	
1	EACH	SIGNAL HEAD, POLYCARBONATE, LED, 2-FACE, 1-3 SECTION, 1-4 SECTION, BRACKET MOUNTED	
4	EACH	CAMERA MOUNTING ASSEMBLY	
1	EACH	SERVICE INSTALLATION, TYPE A	
7	EACH	HANDHOLE	
1	EACH	DOUBLE HANDHOLE	
1	EACH	VIDEO VEHICLE DETECTION, 4 CAMERAS	
645	FOOT	ELECTRIC CABLE IN CONDUIT, EQUIPMENT GROUNDING CONDUCTOR, NO 6, 1C	
970.0	FOOT	ELECTRIC CABLE IN CONDUIT, SIGNAL NO. 18 3C	
459	FOOT	ELECTRIC CABLE IN CONDUIT, 600V (XLP-TYPE USE) 2-12/C, 1-12/C GROUND	
4	EACH	LUMINAIRE, SODIUM VAPOR, MULTI MOUNT, PHOTO-CELL CONTROL, 250 WATT	
2	EACH	TRAFFIC SIGNAL POST, ALUMINUM, 16 FT.	
1	EACH	TRAFFIC SIGNAL POST, ALUMINUM, 15 FT.	
2	EACH	TRAFFIC SIGNAL POST, ALUMINUM, 14 FT.	
1	EACH	STEEL MAST ARM ASSEMBLY AND POLE, 38 FT.	
1	EACH	STEEL COMBINATION MAST ARM ASSEMBLY AND POLE, 40 FT.	
1	EACH	STEEL COMBINATION MAST ARM ASSEMBLY AND POLE, 46 FT.	
1	EACH	STEEL MAST ARM ASSEMBLY AND POLE, 40 FT.	
15.0	FOOT	CONCRETE FOUNDATION, TYPE A	
50.0	FOOT	CONCRETE FOUNDATION, TYPE E, 36" DIA.	
3.0	FOOT	CONCRETE FOUNDATION, TYPE C	

FILE NAME =	USER NAME = sparksgw	DESIGNED -	REVISED -
et:\pw\work\p\idot\sparksgw\0259630\0672E31-sht-TS.dgn		DRAWN -	REVISED -
PLOT SCALE = 40.0000' / in.		CHECKED -	REVISED -
PLOT DATE = Dec-14-2012 03:45:56PM		DATE -	REVISED -

STATE OF ILLINOIS
DEPARTMENT OF TRANSPORTATION

TRAFFIC SIGNAL PLAN

SCALE: 20 SHEET 1 OF 1 SHEETS STA. TO STA.

F.A.P. RTE.	SECTION	COUNTY	TOTAL SHEETS	SHEET NO.
63	(1)N,TS-2RS-5&(7B)RS-3	ADAMS	194	135
				CONTRACT NO. 72E31
ILLINOIS FED. AID PROJECT				